

**THIS PRODUCT MANUFACTURED
WITH LEAD-FREE PROCESSING**

**DESIGNED & DIMENSIONED
IN MILLIMETERS[INCHES]**

DO NOT
SCALE FROM
THIS PRINT

TNC-P-C-XX-SR-C10

GENDER
-P: PLUG

TYPE
-C: CABLE

TERMINATION
-C10: CCA-058
CABLE

ORIENTATION
-SR: STRAIGHT,
REVERSE POLARITY

PLATING SPECIFICATION
(VALUES GIVEN ARE IN MICRO-INCHES)
-GN: GOLD/NICKEL
10 Au / 50 Ni MIN ON CENTER CONTACT
100 Ni MIN ON OUTER CONTACT
(SEE TABLE 1)

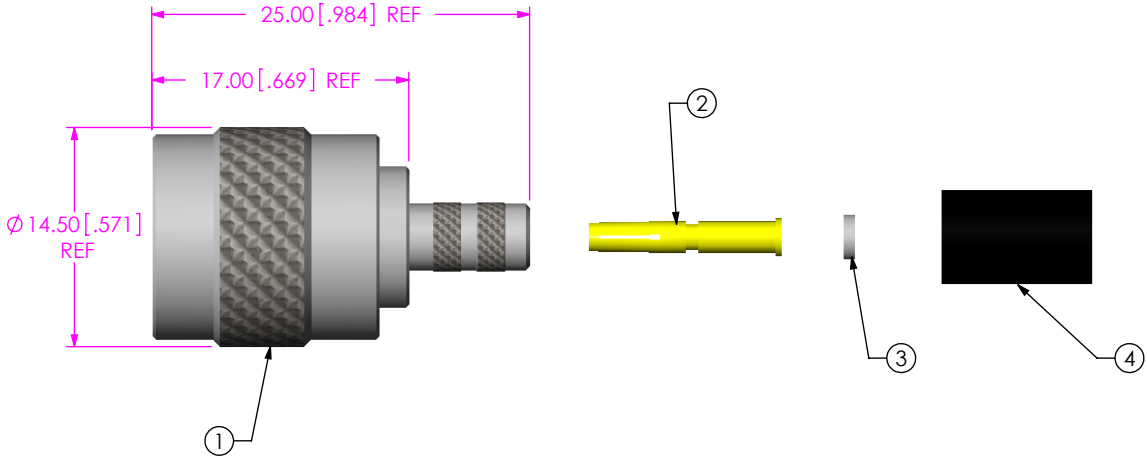

TABLE 1		
ITEM	COMPONENT	-GN
1	SUB ASSEMBLY	SUB-TNC-P-C-N-SR-C10
2	SOCKET	TNC-SKT-002-G
3	INSULATOR	TNC-INS-002
4	FERRULE	TNC-FER-003-N

- NOTES:
1. (C) REPRESENTS A CRITICAL DIMENSION.
 2. CENTER CONTACT PUSHOUT FORCE: 26.69 N [6LB] MIN
 3. NOTE DELETED
 4. NOTE DELETED
 5. PRODUCT TO BE PACKAGED PER PACKAGING STANDARD CO-HD-WI-3040-M
 6. NOTE DELETED
 7. NOTE DELETED
 8. NOTE DELETED

C:\EnterpriseVault\DWG\MISC\MKTG\TNC-P-C-XX-SR-C10-MKT.SLDDRW

UNLESS OTHERWISE SPECIFIED,
DIMENSIONS ARE IN MILLIMETERS [INCHES]

TOLERANCES ARE:

DECIMALS	ANGLES
.X: ±0.3 [.01]	2 °
.XX: ±0.13 [.005]	
.XXX: ±0.051 [.0020]	

PROPRIETARY NOTE

THIS DOCUMENT CONTAINS INFORMATION
CONFIDENTIAL AND PROPRIETARY TO
SAMTEC, INC. AND SHALL NOT BE REPRODUCED
OR TRANSFERRED TO OTHER DOCUMENTS OR
DISCLOSED TO OTHERS OR USED FOR ANY
PURPOSE OTHER THAN THAT WHICH IT WAS
OBTAINED WITHOUT THE EXPRESSED WRITTEN
CONSENT OF SAMTEC, INC.

MATERIAL: DO NOT SCALE DRAWING SHEET SCALE: 2:1

SHELL, FERRULE: BRASS
CONTACT: COPPER ALLOY
DIELECTRIC: PTFE
GASKET: SILICON



520 PARK EAST BLVD, NEW ALBANY, IN 47150
PHONE: 812-944-6733 FAX: 812-948-5047
e-Mail: info@SAMTEC.com code: 55322

DESCRIPTION:
TNC STRAIGHT REVERSE POLARITY CABLE PLUG, RG58 - 50 OHM

DWG. NO.
TNC-P-C-XX-SR-C10

BY: R MUSSER 12/19/2007 SHEET 1 OF 2



IN-PROCESS 1
STRIP AND TIN INNER CONDUCTOR

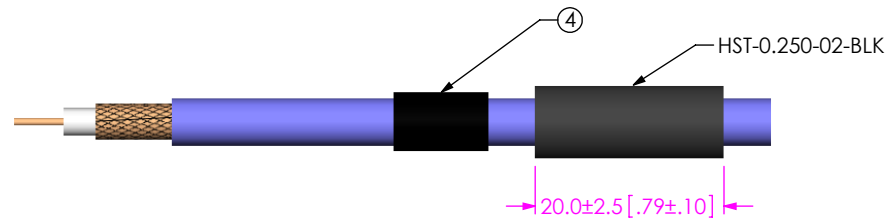

IN-PROCESS 2
ADD HEAT SHRINK TUBE AND FERRULE

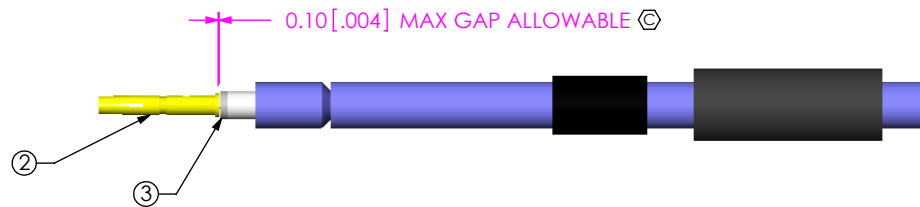

IN-PROCESS 3
ADD INSULATOR, SOLDER CONTACT

$0.10^{+0.10}_{-0.15} [.004^{+.004}_{-.006}]$
TO CENTER CONTACT

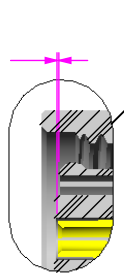

DETAIL 'A'
SCALE 2.5:1

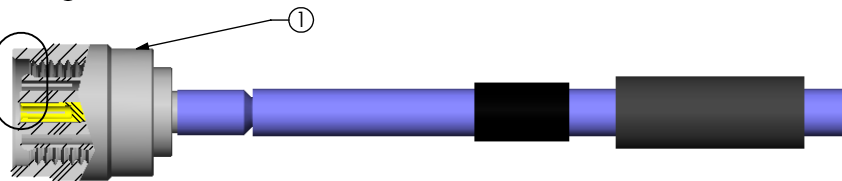

IN-PROCESS 4
ADD SUB-ASSEMBLY

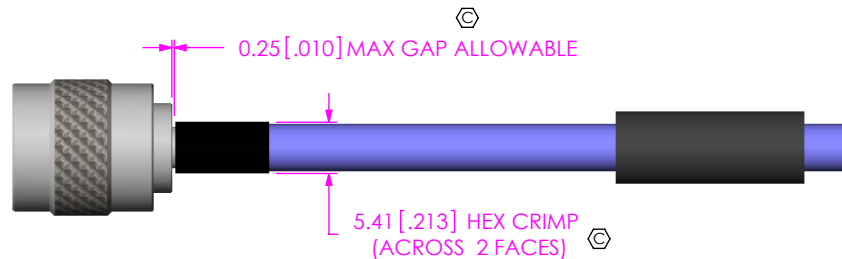

IN-PROCESS 5
CRIMP FERRULE
(USE RF CRIMP HAND TOOL #CAT-HT-126667-21 OR EQUIVALENT)
(USE .213" HEX DIE)

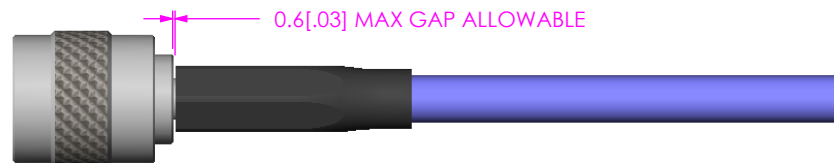

IN-PROCESS 6
APPLY HEAT SHRINK TUBE

K

C:\EnterpriseVault\DWG\MISC\MKTG\TNC-P-C-XX-SR-C10-MKT.SLDDRW

PROPRIETARY NOTE
THIS DOCUMENT CONTAINS INFORMATION
CONFIDENTIAL AND PROPRIETARY TO
SAMTEC, INC. AND SHALL NOT BE REPRODUCED
OR TRANSFERRED TO OTHER DOCUMENTS OR
DISCLOSED TO OTHERS OR USED FOR ANY
PURPOSE OTHER THAN THAT WHICH IT WAS
OBTAINED WITHOUT THE EXPRESSED WRITTEN
CONSENT OF SAMTEC, INC.

DO NOT SCALE DRAWING

SHEET SCALE: 1.25:1

samtec

520 PARK EAST BLVD, NEW ALBANY, IN 47150
PHONE: 812-944-6733 FAX: 812-948-5047
e-Mail: info@SAMTEC.com code: 55322

DESCRIPTION:
TNC STRAIGHT REVERSE POLARITY CABLE PLUG, RG58 - 50 OHM

DWG. NO.
TNC-P-C-XX-SR-C10

BY: R MUSSER 12/19/2007 SHEET 2 OF 2