

REVISIONS				
REV	ECO	DESCRIPTION	DATE	BY APPR
A1	-	RELEASED DRAWING	Nov-9-17	Rookie Tommy
A2	-	ADD THE GS PART NUMBER	Jan-28-19	Blink Tommy
A3	-	CHANGE HAND CRIMPER	Nov-8-19	Flan Tommy

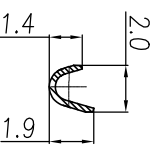
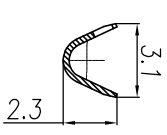
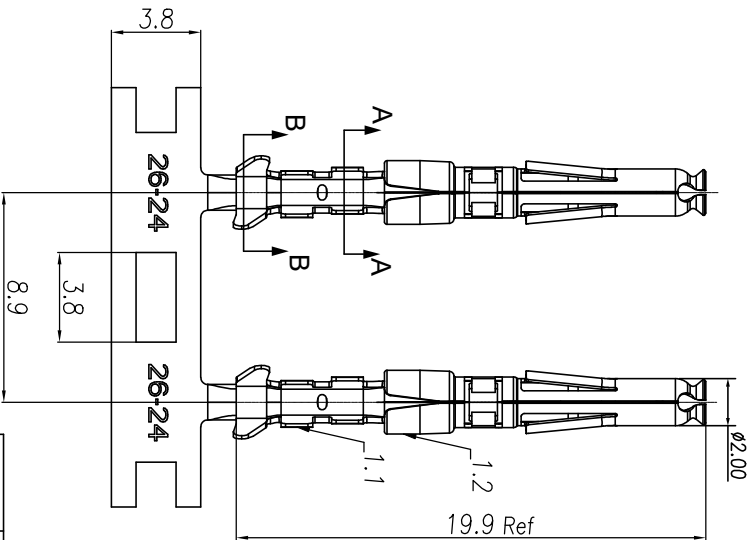
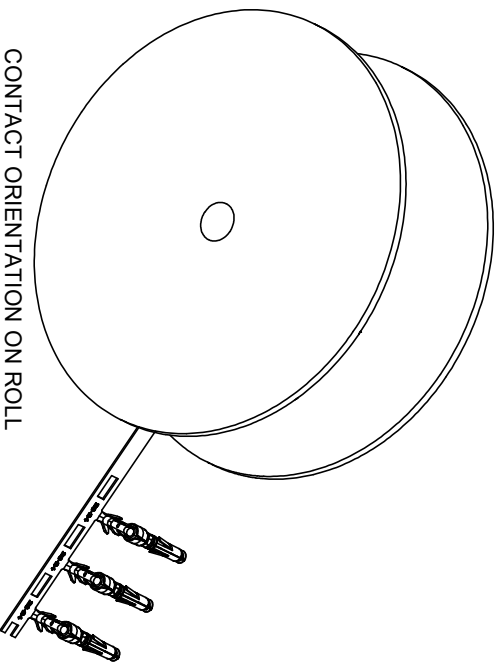

- CONTACT ORIENTATION ON ROLL
 NOTES: (UNLESS OTHERWISE SPECIFIED)
- MATERIAL:
 - CONTACT BODY: COPPER ALLOY.
 - OUTER SPRING: STAINLESS STEEL.
 - SPECIFICATIONS:
 - CURRENT RATING: 5A MAX.
 - TERMINATION TYPE: CRIMPING.
 - WIRE RANGE: 26~24AWG.
 - WIRE INSULATION DIA(MAX): $\phi 2.2\text{mm}$.
 - ROHS COMPLIANT.
 - ALL DIMENSIONS ARE FOR REFERENCE USE ONLY.
 - AVAILABLE TOOLS:
 - HAND CRIMPER: MFX-3958. A3
 - CRIMP APPLICATOR: MFX-3957.
 - EXTRACTION TOOL: QXRT20.

P/N	CONTACT PLATING(MATING AREA)
SS24W2T	TIN PLATING OVER NICKEL.
SS24W2N	NICKEL PLATING OVER COPPERIZE.
SS24W2F	GOLD FLASH PLATING OVER NICKEL.
SS24W2G5	5 μ " GOLD PLATING OVER NICKEL.
SS24W2G10	10 μ " GOLD PLATING OVER NICKEL.
SS24W2G15	15 μ " GOLD PLATING OVER NICKEL.
SS24W2G30	30 μ " GOLD PLATING OVER NICKEL.

QUANTITY	PART NUMBER	DESCRIPTION	ITEM
		MATERIALS LIST	
<p>UNLESS OTHERWISE SPECIFIED 1) All dimensions are in millimeters. 2) Tolerances are as follows: 1 Pt. DEC 0.030 Fractions 1/164 3 Pt. DEC 0.015 Angles 30' 3) Note reference = △</p>			
SIGNATURES		DATE	
DRAWN: Ril	CHECKED: Mih	Nov-8-19	
ENGINEER: Tommy	APPROVE: Tommy	Nov-8-19	
CUSTOMER:		CUSTOMER:	
MATERIAL SPECIFICATIONS:		MATERIAL SPECIFICATIONS:	
PROCESS SPECIFICATIONS:		PROCESS SPECIFICATIONS:	
NEXT ASBY:		NEXT ASBY:	
SCALE: NONE		SCALE: NONE	
SHEET 1 OF 1		SHEET 1 OF 1	
<p>Amphenol</p> <p>Sine Systems - www.amphenol-sine.com 44724 Montey Drive Clinton Township, MI 48038</p> <p>ECO-MATE SOCKET CONTACT, STAMPED, 24-26AWG, SIZE 20</p>			
TITLE: ECO-MATE SOCKET CONTACT, STAMPED, 24-26AWG, SIZE 20		DWG NO.: SS24W2XX	
REV: A3		SH: 1	
OF: 1		OF: 1	