

REVISIONS					
REV	ECO	DESCRIPTION	DATE	BY	APPR
A3	--	RELEASE NEW DWG FORMAT	04JAN14	JARRY	TOMMY
A4	--	UPDATE VIEW	02/AUG/23	HARRIS	TOMMY

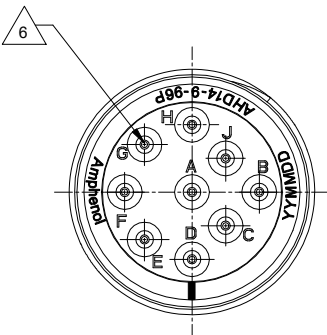
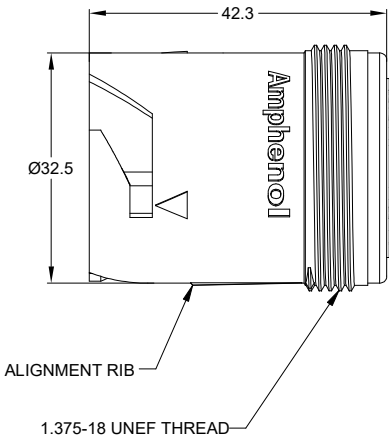
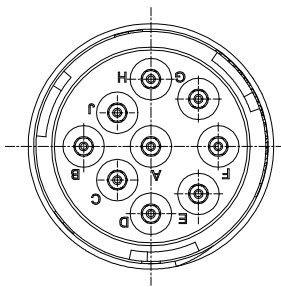

NOTES: UNLESS OTHERWISE SPECIFIED

1. MATERIAL:  
HOUSING: THERMOPLASTIC; GREY  
SEAL: SILICONE RUBBER
2. MODIFICATIONS: IN-LINE THREADED
3. SPECIFICATIONS:
- 3.1 CURRENT RATING: 13 AMPS
  - 3.2 OPERATING TEMPERATURE: -55°C TO +125°C.
  - 3.3 DIELECTRIC WITHSTANDING VOLTAGE: LESS THAN 2 MILLIAMPS CURRENT LEAKAGE @ 1500 VOLTS AC.
  - 3.4 INSULATION RESISTANCE: 1000 MEGOHM MIN @ 25°C.
  - 3.5 MOISTURE RESISTANCE:  
IP68(IM OF WATER FOR A PERIOD OF 24 HOURS,MATED CONDITION);
  - 3.6 MATING CYCLE DURABILITY: 100 CYCLES
  - 3.7 RoHS COMPLIANT
4. MATING PART: AHD16-9-96S\*  
( \* = AVAILABLE MODIFICATIONS )

5. ALL DIMENSIONS ARE FOR REFERENCE USE ONLY.

6 CONTACT SIZE AND WIRE RANGE:

CONTACT SIZE	MIN. INSUL O.D.	MAX. INSUL O.D.	WIRE RANGE
16	2.54mm (.100 in)	3.81 mm (.150 in)	14 - 20 AWG (2.0-0.5mm²)

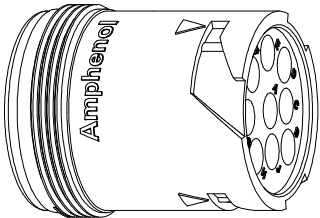

AHD14-9-96P		REF: HD14-9-96P	
PART NUMBER		DESCRIPTION	
QUANTITY		ITEM	
<b>MATERIALS LIST</b>			
<b>UNLESS OTHERWISE SPECIFIED</b> 1) All dimensions are in metric(mm). 2) Tolerances are as follows: 1 PL DEC ±0.30 2 PL DEC ±0.15 3 PL DEC ±0.05 3) Note reference =		<b>SIGNATURES</b> DRAWN: HARRIS CHECKED: ORION ENGINEER: APPROVAL: TOMMY DATE: 02/AUG/23 03/AUG/23 04/AUG/23	
WEIGHT: 37.9g		<b>Amphenol</b> Sine Systems - www.amphenol-sine.com 44724 Morley Drive Clinton Township, MI 48036	
PROCESS SPECIFICATIONS:		THIS DRAWING IS SUPPLIED FOR INFORMATION ONLY. DESIGN FEATURES, SPECIFICATIONS AND PERFORMANCE DATA SHOWN HEREON ARE THE PROPERTY OF THE AMPHENOL CORPORATION. NO RIGHTS OF REPRODUCTION ARE IMPLIED. ALL DIMENSIONS ARE SUBJECT TO NORMAL MANUFACTURING VARIATIONS.	
NEXT ASSY:		RECEPTACLE, 9 POSITION, AHD SERIES IN-LINE THREADED REAR	
SCALE: NONE		SIZE: B C- DWG NO: AHD14-9-96P REVISION: A4	
		SHEET 1 OF 1	

TITLE: RECEPTACLE 9 POSITION AHD SERIES IN-LINE THREADED REAR  
DWG NO: AHD14-9-96P  
REV: A4  
SH: 1  
OF: 1