

- 1.CIRCUIT : ON/OFF
- 2." \bigcirc "DENOTES CRITICAL DIMENSIONS.
- 3.Operation force : 800±300gf
- 4.RATING:16A 125/250VAC 3/4HP 125/250VAC(CUL)
 - 16(4)A 125/250V~ T125/55(ENEC17;NEMKO;CB)
 - 16(4)A 250~ T125/55(CQC)
 - C-UL APPROVAL FILE NO.E153399
 - ENEC17 CERTIFICATE NO.3689
 - NEMKO CERTIFICATE NO.P10213218/A2
 - CQC CERTIFICATE NO.CQC10002051908
 - CB APPROVAL FILE NO.60225/A1/M1

- 5.Contact resistance : <50mΩ
- 6.Insulation resistance : >100MΩ(500VDC between open contacts)
- 7.Dielectric strength : >1500Vac 0.5mA 1 minute
- 8.ACTUATOR COLOR:WHITE
HOUSING COLOR:WHITE
BASE COLOR:BLACK
- 9.ALL MATERIALS ARE ROHS COMPLIANT

TEL: 0769-82310511-867

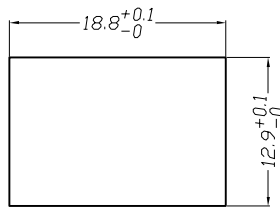
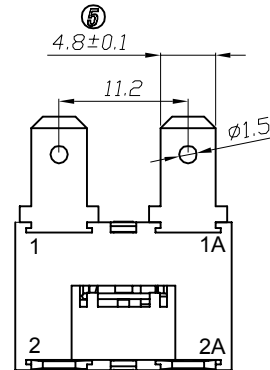
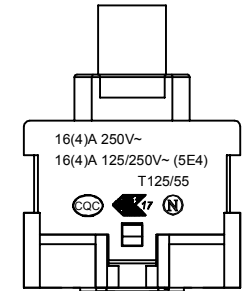
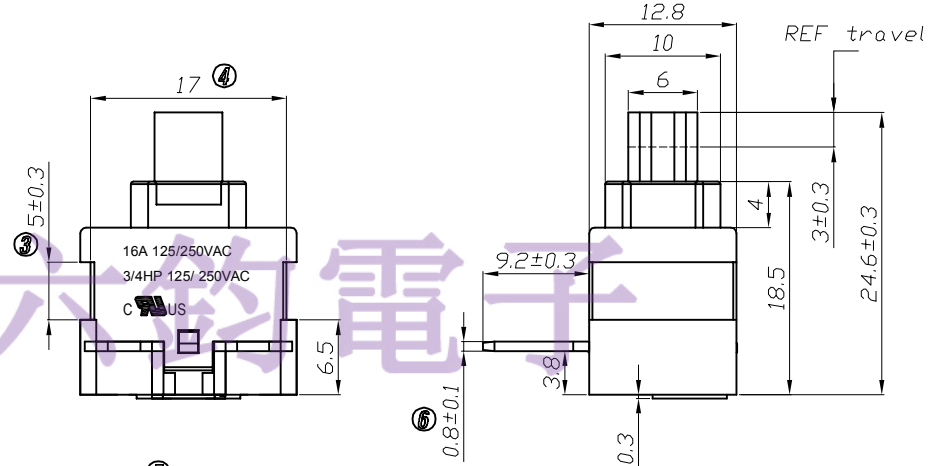
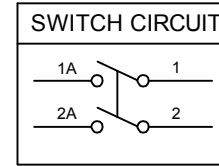
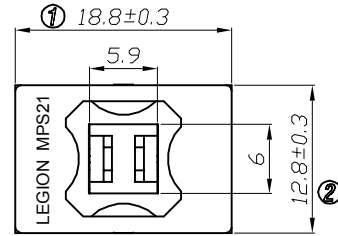
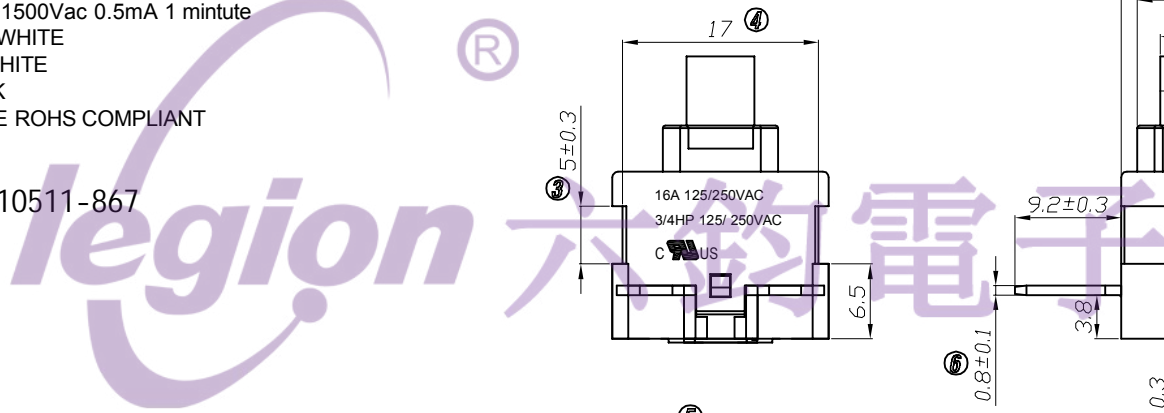

PANEL CUTOUT DIMENSION:

NO	DESCRIPTION	NO	DESCRIPTION	DIMENSIONAL TOLERANCES		APPROVED	CHECKED	DESIGN	DRAWN	ALL SIZE ARE IN		DRAWING NO. REV.	
				RANGE	TOLERANCE					MM	NO	MATERIAL NO.	*****
5	→	10	→	X	±0.3	LMC 2018.01.16			LMC 2017.05.24	SCALE	MM	MPS21-WWBCB-S1M-A	*****
4	→	9	→	X.X	±0.2					MATERIAL NO.	NO		
3	→	8	→	X.XX	±0.1					MATERIAL NO.	***		
2	→	7	→	ANGLES	±1°					MATERIAL NO.			
1	→	6	→							MATERIAL NO.			

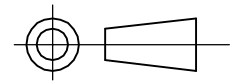

LEGION ELECTRONIC & HARDWARE CO., LTD.