

Technical Index:  
 1. Temperature range:  $-25^{\circ}\text{C}\sim 85^{\circ}\text{C}$ .  
 2. Rated voltage: 200V DC/AC(rms).  
 3. Rated current: 2.0A.  
 4. Contact resistance:  $\leq 25\text{m}\Omega$ .  
 5. Withstanding voltage: 500V AC/minute.  
 6. Insulation resistance:  $\geq 1000\text{M}\Omega$ .

| Part No               | Pin | A     | B     |
|-----------------------|-----|-------|-------|
| WAfer-PH2.0-2PWZ-H62  | 2   | 2.00  | 6.00  |
| WAfer-PH2.0-3PWZ-H62  | 3   | 4.00  | 8.00  |
| WAfer-PH2.0-4PWZ-H62  | 4   | 6.00  | 10.00 |
| WAfer-PH2.0-5PWZ-H62  | 5   | 8.00  | 12.00 |
| WAfer-PH2.0-6PWZ-H62  | 6   | 10.00 | 14.00 |
| WAfer-PH2.0-7PWZ-H62  | 7   | 12.00 | 16.00 |
| WAfer-PH2.0-8PWZ-H62  | 8   | 14.00 | 18.00 |
| WAfer-PH2.0-9PWZ-H62  | 9   | 16.00 | 20.00 |
| WAfer-PH2.0-10PWZ-H62 | 10  | 18.00 | 22.00 |
| WAfer-PH2.0-11PWZ-H62 | 11  | 20.00 | 24.00 |
| WAfer-PH2.0-12PWZ-H62 | 12  | 22.00 | 26.00 |
| WAfer-PH2.0-13PWZ-H62 | 13  | 24.00 | 28.00 |
| WAfer-PH2.0-14PWZ-H62 | 14  | 26.00 | 30.00 |
| WAfer-PH2.0-15PWZ-H62 | 15  | 28.00 | 32.00 |
| WAfer-PH2.0-16PWZ-H62 | 16  | 30.00 | 34.00 |
| WAfer-PH2.0-17PWZ-H62 | 17  | 32.00 | 36.00 |
| WAfer-PH2.0-18PWZ-H62 | 18  | 34.00 | 38.00 |
| WAfer-PH2.0-19PWZ-H62 | 19  | 36.00 | 40.00 |
| WAfer-PH2.0-20PWZ-H62 | 20  | 38.00 | 42.00 |

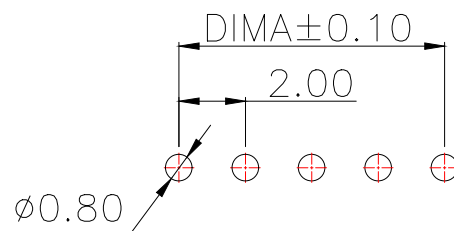
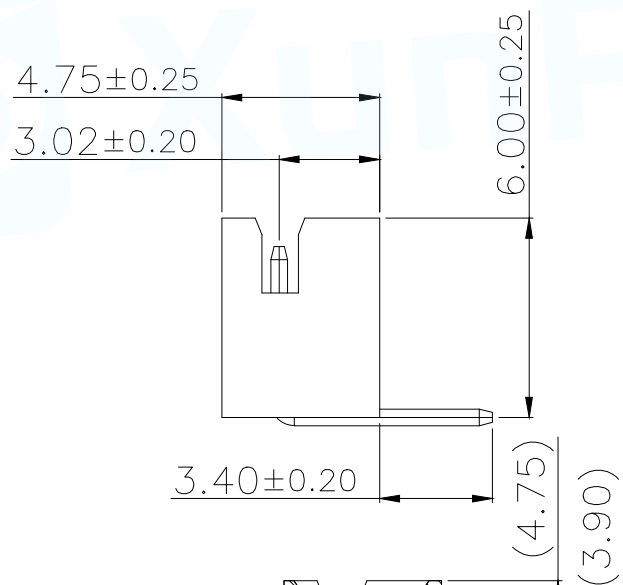
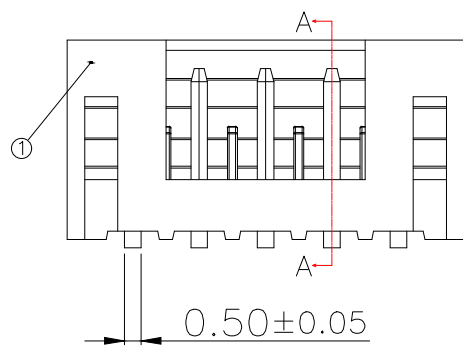

适用线路板(PCB LAYOUT)

| 序号 | 品名          | 材质                           |
|----|-------------|------------------------------|
| 1  | PH2.0 直针 胶芯 | PA66 UL94V-2 Yellow          |
| 2  | PH2.0 弯针 端子 | Copper Alloy/<br>Tin Plating |

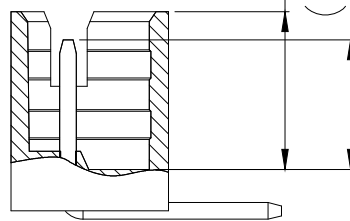

SECTION A-A

|                                       |            |   |                             |
|---------------------------------------|------------|---|-----------------------------|
| MANUFACTURE DWG                       |            | 东莞市讯普电子科技有限公司<br>DongGuan XunPu Electronics Co.,Ltd |                             |
| UNLESS OTHERWISE SPECIFIED TOLERANCES |            |   | TITLE:<br>PH2.0 弯针          |
| DECIMALS:                             | ANGLES:    |   | PAR<br>WAfer-PH2.0-NPWZ-H62 |
| X.:±0.50                              | X'::±5°    |   | DWN                         |
| .X:±0.20                              | X.X'::±3°  |   | CHKD                        |
| .XX:±0.10                             | X.XX'::±1° | APVD  | SCALE:1:1 UNIT:MM           |
| CUSTOMER COPY                         |            | SIZE:A4   | UNIT:MM                     |
|                                       |            | SHEET:1F1   | REV:A                       |