

RECOMMENDED FFC/FPC DIM.

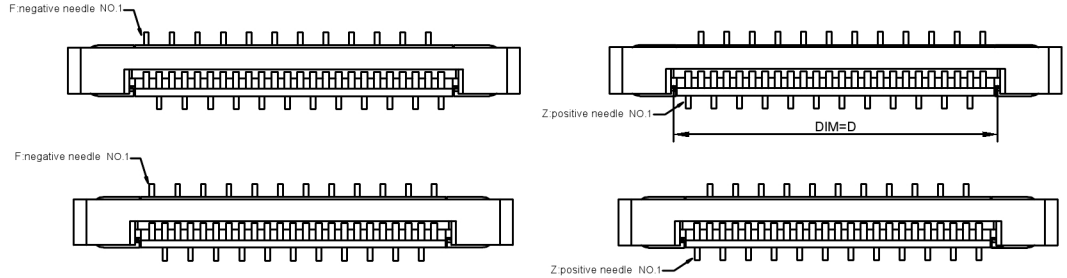

Pin	DIM A	DIM B	DIM C	DIM D	DIM E
34	22.60	21.50	16.50	17.60	4.4
33	22.10	21.00	16.00	17.10	
32	21.60	20.50	15.50	16.60	
31	21.10	20.00	15.00	16.10	
30	20.60	19.50	14.50	15.60	
29	20.10	19.00	14.00	15.10	
28	19.60	18.50	13.50	14.60	
27	19.10	18.00	13.00	14.10	
26	18.60	17.50	12.50	13.60	
25	18.10	17.00	12.00	13.10	
24	17.60	16.50	11.50	12.60	
23	17.10	16.00	11.00	12.10	
22	16.60	15.50	10.50	11.60	
21	16.10	15.00	10.00	11.10	
20	15.60	14.50	9.50	10.60	
19	15.10	14.00	9.00	10.10	
18	14.60	13.50	8.50	9.60	
17	14.10	13.00	8.00	9.10	
16	13.60	12.50	7.50	8.60	
15	13.10	12.00	7.00	8.10	
14	12.60	11.50	6.50	7.60	
13	12.10	11.00	6.00	7.10	
12	11.60	10.50	5.50	6.60	
11	11.10	10.00	5.00	6.00	
10	10.60	9.50	4.50	5.60	
09	10.10	9.00	4.00	5.10	
08	9.60	8.50	3.50	4.60	
07	9.10	8.00	3.00	4.10	
06	8.60	7.50	2.50	3.60	
05	8.10	7.00	2.00	3.10	
04	7.60	6.50	1.50	2.60	

Pin	DIM A	DIM B	DIM C	DIM D	DIM E
67	39.10	38.00	33.00	34.10	4.9
60	35.60	34.50	29.50	30.60	
59	35.10	34.00	29.00	30.10	
58	34.60	33.50	28.50	29.60	
57	34.10	33.00	28.00	29.10	
56	33.60	32.50	27.50	28.60	
55	33.10	32.00	27.00	28.10	
54	32.60	31.50	26.50	27.60	
53	32.10	31.00	26.00	27.10	
52	31.60	30.50	25.50	26.60	
51	31.10	30.00	25.00	26.10	
50	30.60	29.50	24.50	25.60	
49	30.10	29.00	24.00	25.10	
48	29.60	28.50	23.50	24.60	
47	29.10	28.00	23.00	24.10	
46	28.60	27.50	22.50	23.60	
45	28.10	27.00	22.00	23.10	
44	27.60	26.50	21.50	22.60	
43	27.10	26.00	21.00	22.10	
42	26.60	25.50	20.50	21.60	
41	26.10	25.00	20.00	21.10	
40	25.60	24.50	19.50	20.60	
39	25.10	24.00	19.00	20.10	
38	24.60	23.50	18.50	19.60	
37	24.10	23.00	18.00	19.10	
36	23.60	22.50	17.50	18.60	
35	23.10	22.00	17.00	18.10	

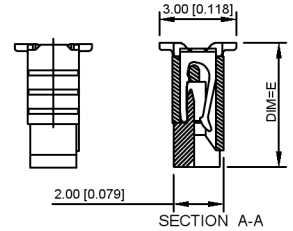

1.FPC NOT MATING CONDITION BANNED CLOSURE  
2.PART NO. LEGEND:

- X05C20 XX X X  
① ② ③ ④
- ① Series Name : X05C20=0.5 mm Pitch(H=2.0mm)
  - ② Number of terminals : XX=04-67PIN
  - ③ Plating : T: Tin Over Nickel G: Gold Flash Over Nickel
  - ④ Z: positive needle F: negative needle

- 3.PERFORMANCE
- CURRENT RATING:0.5A/PIN.
  - VOLTAGE RATING: 50V (AC/DC)
  - CONTACT RESISTANCE: INITIAL VALUE 30mOHM Max
  - INSULATION RESISTANCE: 500MOHM Min.
  - DIELECTRIC WITHSTANDING VOLTAGE: 250V AC FOR 1MINUTE
  - DURABILITY: 20 TIMES Min
  - OPERATING TEMPERATURE: -40℃~+85℃  
OPERATING HUMIDITY RANGE:20% TO 85%

Material Description:  
Terminal: Phosphor Bronze Tin-Leadplated  
Fitting Nail: Brass Tin-plated  
Housing: Thermoplastic(UL94V-0)  
Slider: Thermoplastic(UL94V-0)

DSND		DATE	SCALE: N/A	MODEL TYPE: FPC CONNECTOR
DWN		DATE	VIEW:	PART NO.:
CHKD		DATE	UNIT: mm/in	DWG NO.:
APPD		DATE	SIZE: A4	X05C20XXXX
XKB INDUSTRIAL PRECISION CO.,LIMITED				WEIGHT 1.0g
				SHEET 1/1
				REVISION A0

广东星坤科技股份有限公司

文件工程章

REVISIONS

UNSPECIFIED TOLERANCES

www.xk-dg.cn www.helloxkb.com www.helloxkb.cn

MARK	DESCRIPTION	DATE	REVISED	APPROVED	ANGLAR	
Δ					±5°	
Δ×					±0.2	
Δ×					±0.3	
Δ×					±0.4	
					±0.5	