

立创商城

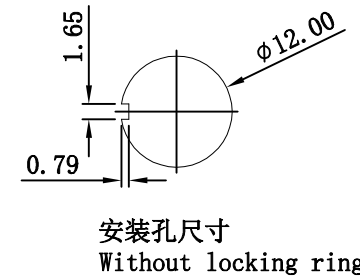
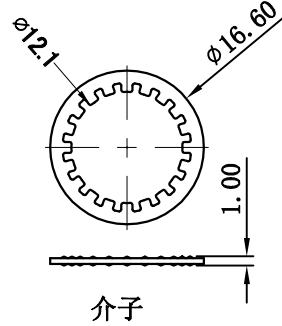
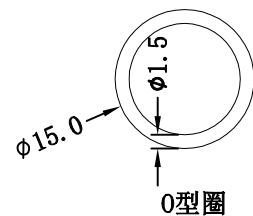
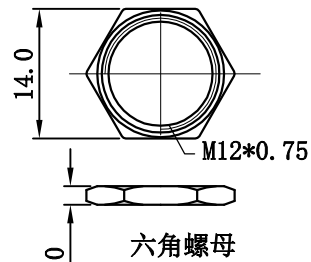
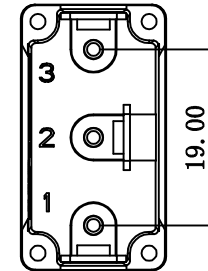
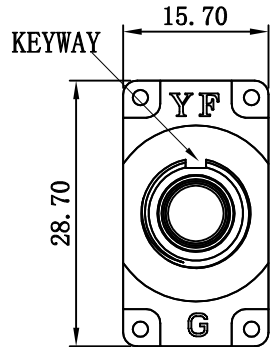
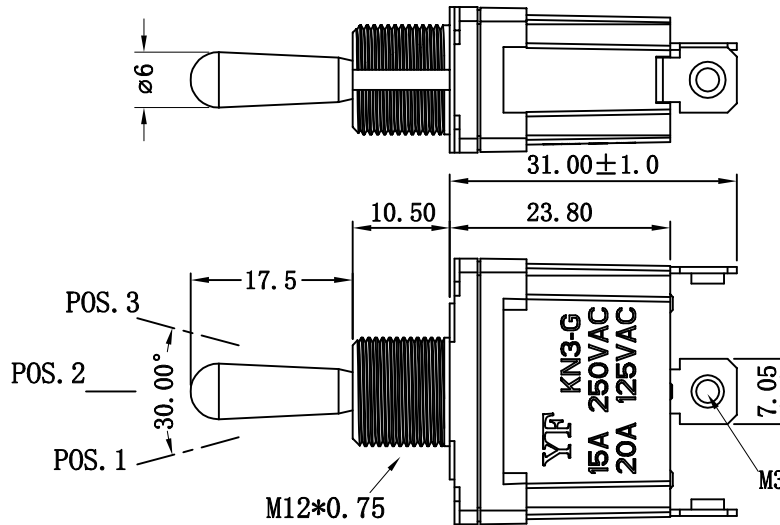
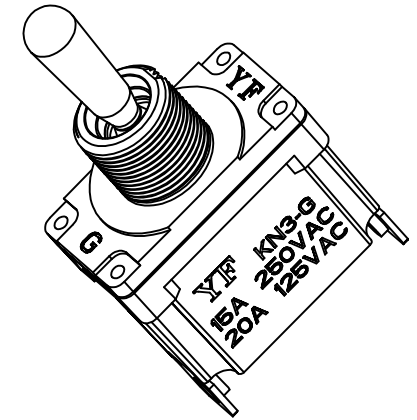

手柄位置及导通端子示意图

	POS. 1	POS. 2	POS. 3
Model	KEYWAY		
NO.			
102	ON	NONE	ON
SCHEMATIC		N/A	

Technical characteristics

SPECIFICATION: 15 A max. @ 250 VAC.
 MECHANICAL LIFE: 100,000 make-and-break cycles.
 CONTACT RESISTANCE: 20mΩ max. initial @2-4VDC
 100mA for both silver.
 INSULATION RESISTANCE: 1000 MΩ min.
 DIELECTRIC STRENGTH: 1500 VAC min.
 OPERATING TEMPERATURE: -30°C to +85°C.
 DEGREE OF PROTECTION: IP67/IP68

Materials

CASE: Zamac alloy
 HOUSING: PA66
 ACTUATOR: Copper Alloy, chrome plated.
 CONTACT/TERMINALS: Copper alloy .
 RoHS

源丰电子(深圳)有限公司
 Yuenfung Electronic Limited

工程编号: YF-ENG-F-33544		公差 TOLERANCES		.X± 0.5 .XX± 0.25		角度 ± 5°		UNIT 单位 mm	SCALE 1:1	
版本 VERSION		AO		比例尺 SCALE		NONE		TITLE 图名		TOGGLE SWITCH
日期 DATE		2022. 10. 28		日期 DATE		2022. 10. 28		DWG NO. 料号		
核准 APPROVED BY		X Y F		核对 CHECKED BY		绘图 DRAWN BY		PART NO. 型号		TW1-0-102-A00A0-M00-A-WP
版本 VER.	变更说明 CHANGE DESCRIPTION	日期 DATE	ECN NO.	核准 APPROVED BY	核对 CHECKED BY	绘图 DRAWN BY	X Y F	PART NO. 型号	TW1-0-102-A00A0-M00-A-WP	



SPECIFICATION 规格书		承认书编号	
WRITTEN 制定		雷艳平	
		版本	A/0
		页次	第1页 共2页
		确认日期	2023/6/1
		审核	
		APP'D审批	
MODEL SERIES NAME 系列名称:		High Current Sealed Toggle Switch	
MODEL NO 产品型号:		TW1 系列	
1.RATING 额定值:		15A 250VAC 20A 125V	
2.FUNCTION 接触型式:			
3. CIRCUITRY TRAIT:			
4.ELECTRICAL CHARACTERISTICS 电气性能规格:			
ITEM 项目	TEST CONDITIONS 测试条件		PERFORMANCE 表现
4.1	CONTACT RESISTANCE 接触电阻	MEASURED AT SMALL CURRENT(100mA OR LESS)1000Hz 在微小电流(100mA)以下测试.	初始值20mΩ MAX 20毫欧以下
4.2	INSULATION RESISTANCE 绝缘电阻	APPLY A VOLTAGE OF 500V DC FOR 1 MIN.TO FOLLOWING PORTIONS AFTER WHICH MEASUREMENT SHALL BE MADE: (1)BETWEEN BODY AND CONDUCTOR. (2)BETWEEN CONDUCTORS NOT TO BE CONTACT. 输入500V DC电压1分钟,按以下接触方法测试: (1)接触端子之间. (2)塑胶体与端子之间.	1000MΩ MIN 1000兆欧以上
4.3	DIELECTRIC STRENGTH 耐电压	AC1500V (50-60Hz)FOR 1 MIN : (1)BETWEEN TERMINALS. (2)BETWEEN INDIVIDUAL TERMINALS AND FRAME. 输入AC1500V (50-60Hz)电压1分钟,按以下接触方法测试: (1)接触端子之间.(2)塑胶体与端子之间.	NO DAMAGE TO PARTS ARCING,OR BREAKDOWN ETC. 没有绝缘破坏等异常.
5	PRACTICAL TEMPERATURE RANGE 使用温度范围	A-30℃~+85℃ 在-30℃~+85℃温度内使用	
6	STANDARD ATMOSPHERIC CONDITIONS 测试标准状态	UNLESS OTHERWISE SPECIFIED. THE STANDARD RANGE OF ATMOSPHERIC CONDITIONS FOR MAKING MEASUREMENTS AS FOLLOWS: (1)AMBIENT TEMPERATURE:5℃TO35℃. (2)RELATIVE HUMIDITY:45%TO85%. 在没有指定的情况下测试温度,湿度如下: (1)温度为5℃-35℃.(2)湿度为45%-85%.	
7.MECHANICAL CHARACTERISTICS 机械性能规格:			
ITEM 项目	TEST CONDITIONS 测试条件		PERFORMANCE 表现
7.1	TERMINAL STRENGTH 端子强度	A STATIC LOAD OF 300gf SHALL BE APPLIED TO THE TIP OF THE TERMINAL FOR 1 MIN,IN ANY DIRECTION 在任意一个方向的先端加上300gf力度测试,时间为1分钟.	ELECTRICAL CHARACTERISTICS SHALL BE SATISFIED WITHOUT DAMAGE OR EXCESSIVE LOOSENESS OF TERMINALS 在排脚中没有裂开,松动等异常,满足于机械,电器性能.



SPECIFICATION 规格书		承认书编号	
		版本	A/0
		页次	第2页 共2页
		确认日期	2023/6/1
WRITTEN 制定	雷艳平	审 核	
		APP'D审批	
ITEM项目	TEST CONDITIONS 测试条件		PERFORMANCE 表现
7.2	LIFE TEST 寿命测试	1.ENDURANCE WITHOUT LOADING:THE TEST SHOULD BE TAKEN AT A SPEED OF 6-8 CYCLES FOR 1 MIN;1.5 TIMES OF THE STANDARD FORCE 无负荷:每分钟6-8回速度测试压力不得超过标准力度1.5倍.进行测试 2.ENDURANCE WITH LOADING: THE TEST SHOULD BE TAKEN AT A SPEED OF 6-8 CYCLES FOR 1 MIN; OPERATE PRESSURE SHOULD BE UNDER THE1.5 TIMES OF THE STANDARD FORCE 负荷:在负荷的条件下以每分钟6-8回的速度压力不得超过标准力度1.5倍.进行测试	(1).100,000CYCLESCONTACT AT WITHOUT LOADING.在无负荷下100,000次接触 (2).10,000CYCLESMECHANICAL AND ELECTRICAL CHARACTERISTICS SHALL BE SATISFIED10,000次满足于机械, 电器性能:
8.DURABILITY 耐久性:			
ITEM项目	TEST CONDITIONS 测试条件		PERFORMANCE 表现
8.1	SOLDERABILITY TEST 可焊性试验	THE TOP OF THE TERMINALS SHALL BE DIPPED 2mmINTHE SOLDER BATH OF 230±10°C FOR 3±0.5 SECONDS. 端子顶部被浸入锡焊池中2mm深,温度为230±10°C,时间为3±0.5秒.	THE AREA OF SOLDERING, SHOULD BE OVER75%. 焊接面积要有75%以上.
8.2	RESISTANCE TO SOLDERING HEAT TEST 耐焊性试验	SOLDER BATH METHOD: 1. SOLDER TEMPERATURE260±5°C,IMMERSION TIME 3±0.5 SEC,IMMERSION DRPTH UP TO THE SURFACE OF THE BOARD THICKNESS OF PRINTED WIRING BOARD 1.6mmDIMENSIONS OF COMPONENT HOLES IN THE PRINTED WIRING BOARD SHALL BE ACCRDANCE TO THE SPECIFCATION 锡炉焊接的时候温度控制在260±5°C, 过炉时间为3±0.5秒,于基板厚度应为1.6mm; 2.SOLDERING IRON METHOD: BIT TEMPERATURE 360°C±5°C, APPLICATION TIME OF SOLDERING IRON3±0.5SEC HOWEVR EXCESSIVE PRESSURE SHALL NOT BE APPLIED TO THE TERMINAL.手焊接的时候温度控制在360°C±5°C, 时间为3±0.5秒, 但不能在排脚上施加异常压力	WITHOUT DEFORMATION OF CASE OR EXCESSIVE LOOSENESS OF TEMINALS ELECTRICAL CHARACTERISTICS SHALL BE SATISFIED. 本体无变形,能满足于机械,电器性能.
8.3	HEAT TEST 耐热试验	THE SWTICH SHALL BE STORED AT A TEMPERATURE OF 85±2°C FOR 96 HOURS.THEN THE SWITCH SHALLBE MAINTAINED AT STANDARD ATMOSPHERICCONDITION FOR 1 HOUR AFTER WHICHMEASUREMENT SHALL BE MADE. 放置在温度85±2°C中测试96小时后,再放置正常室温中1小时来测定.	THERE SHALL BE NO DEFORMATION OR CRACKSINMOLDED PART 外观无异常,满足于机械,电器性能.
8.4	COLD TEST 耐冷试验	THE SWITCH SHALL BE STORED AT A TEMPERATURE OF -25±3°C FOR 96 HOURS,THEN THE SWITCH SHALL BE MAINTAINED AT STANDARD ATMOSPHERIC CONDITION FOR 1 HOUR AFTER WHICH MEASUREMENT SHALL BE MADE. 放置在温度-25±3°C中96小时后,再放置常温中1小时来进行测试.	
8.5	HUMIDITY TEST 潮湿试验	THE SWITCH SHALL BE STORED AT A TEMPERATURE OF 40±2°C AND A HUMIDITY OF 90%TO95% FOR 96 HOURS.THEN THE SWITCH SHALL BE MAINTAINED AT STANDARD ATMOSPHERE CONDITION FOR 1 HOUR AFTER WHICH MEASUREMENT SHALL BE MADE. 放置40±2°C试验的相对湿度为90%-95%环境中96小时后,再将样板放在正常环境1小时后进行测试.	
8.6	WATERPROOF TEST 防水试验	短时浸水试验,试样放进浸水箱后,样品底部到水面的距离至少为1m,试样顶部到水面距离至少为0.15m 试验时间:30 min	