

3D View

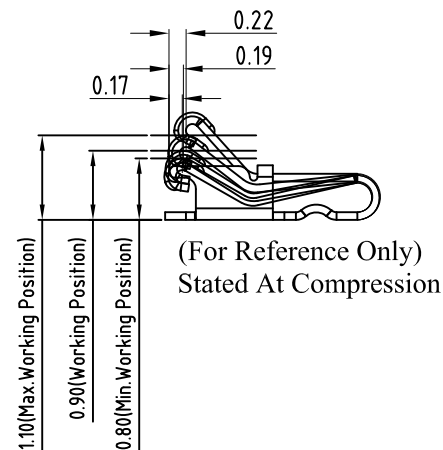
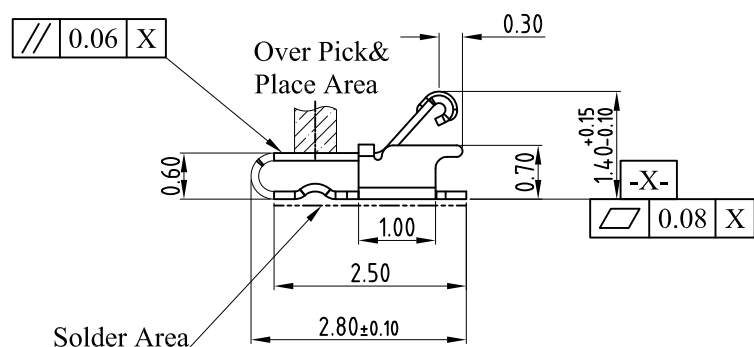
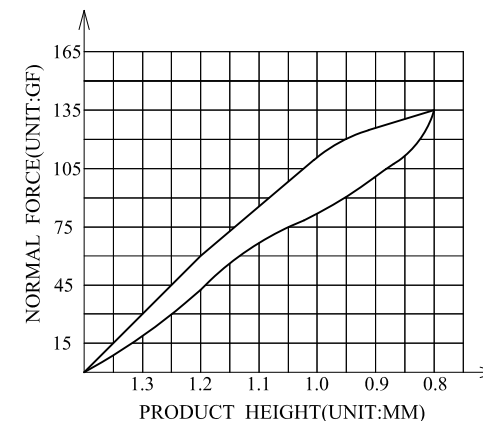

NOTES:

1:MATERIAL

1-1: SUS-304 THICKNE=0.10MM

2:SPECIFICATIONS

2-1: RATED CURRENT: 1.0A

2-2: VOLTAGE RATING: 1.5V

2-3: CONTACT RESISTANCE: 80mΩ/MAX

2-4: WELDING THRUST: ≥3KG

2-5: OPERATING TEMPERATURE: -40°C~+85°C

3:DURABILITY: 1500 CYCLES

4:SALT SPRAY TIME: 24H

5:ELECTROPLATE: THE NICKEL-PLATED SUBSTRATE IS 50u" MIN

6:REQUIREMENTS

6-1: TERMINAL TO EAT FULL TIN, NOT PEELING, WELDING OBVIOUS COLOR AND OTHER ADVERSE

6-2: ROHS, REACH, HF HALOGEN ADVERSE OF DOMESTIC AND INTERNATIONAL ENVIRONMENTAL REQUIREMENTS

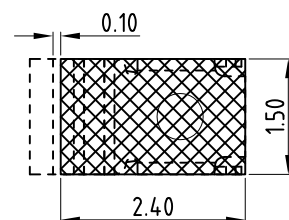

RECOMMENDED PCB LAYOUT

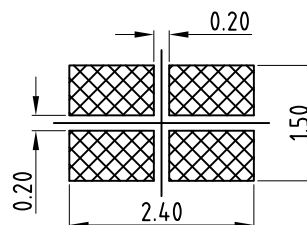
TOLERANCE: ±0.05MM
(FOR REFERENCE ONLY)

METAL MASK T=0.08

TOLERANCE: ±0.05MM
(FOR REFERENCE ONLY)

深圳市华宇创精密电子有限公司

| | | | | |
|---|--------------------|----------------------|---------------------------------------|---------------------|
| TOLERANCE: X.X ±0.30 X.XX ±0.25 X.XXX ±0.15 X' ±2" X.X' ±0.5" | DRAWN BY : 陈一鸣 | DATE : 2014-02-23 | PART NAME: 天线弹片 L2. 80*W1. 5*H1. 4 | |
| | CHECKED BY: 马跃 | DATE : 2014-02-23 | PART NO. HYCW-TXT281514AD | MOLD NO. |
| UNIT: mm [inch] SCALE: 1:1 SIZE: A4 | APPROVED BY: 邱敏 | DATE : 2014-02-23 | DRAW NO: HYC-24060061511 | SHEET NO. 1 OF 1 |