

**Kinghelm®**

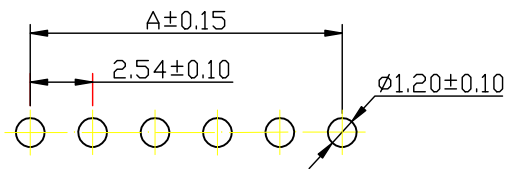
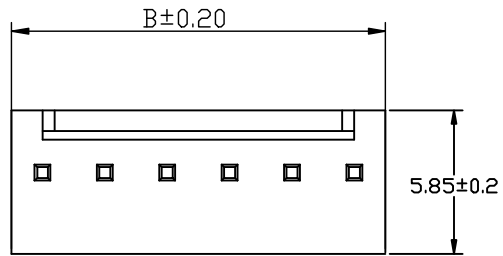
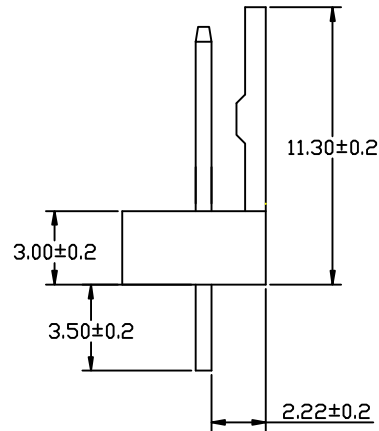
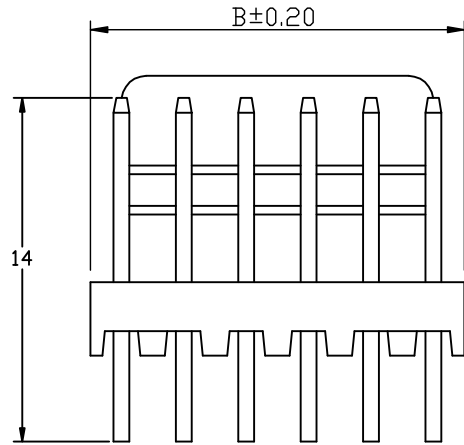

SUGGESTED PCB LAYOUT  
(COMPONENT SIDE)

**SPECIFICATION**

- 1 Material:  
 Insulator: PA66 (UL94V-0)  
 Contacts: Brass, Gold-plated
- 2 Contact resistance:  $\leq 20\text{m}\Omega$
- 3 Insulation resistance:  $\geq 1000\text{M}\Omega$
- 4 Rated voltage: 250 V AC DC
- 5 Rated current: 2.5 A AC DC
- 6 Withstand Voltage: 800V AC/minute
- 7 Temperature Range:  $-25\text{ }^{\circ}\text{C} \sim +85\text{ }^{\circ}\text{C}$
- 8 Six deleterious substance content meet the environmental protection requirement

						<b>TOLERANCE</b>	<b>SCALE:</b>	<b>2510-A</b>			
						*.* $\pm 0.25$	UNIT: mm			<b>TITLE:</b> 2.54mm PITCH 90° WAFER	<b>PART NO:</b>
						*.** $\pm 0.15$	VIEW:				
						*.*** $\pm 0.05$					
						<b>DRAW</b>					
						<b>CHECK</b>					
<b>A</b>	<b>NEW RELEASE</b>					<b>APPRO</b>					
<b>REV</b>	<b>DESCRIPTION</b>	<b>REV. DRAWN</b>	<b>DATE</b>					深圳市金航标电子有限公司	www.kinghelm.com.cn		
								KH-HX2.54-04Z	0755-28190160		