

Kinghelm®

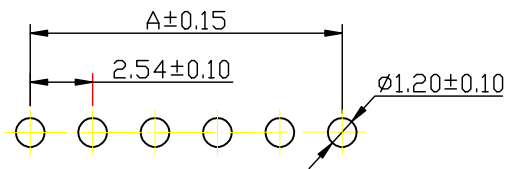
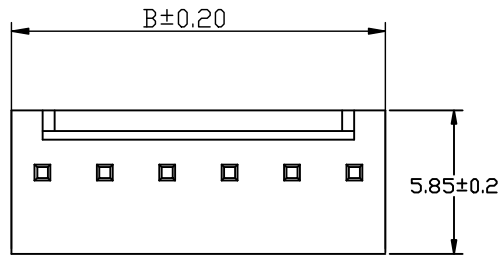
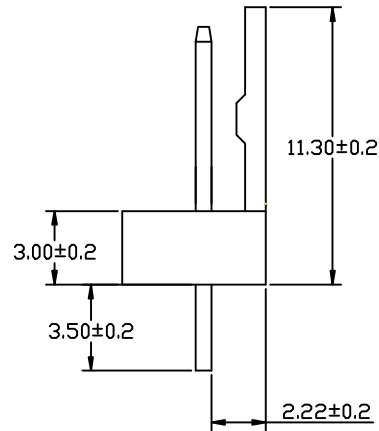
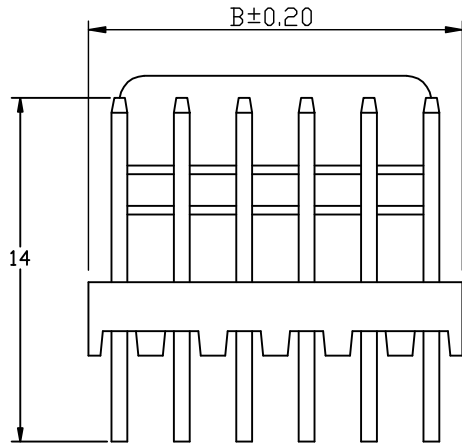

SUGGESTED PCB LAYOUT
(COMPONENT SIDE)

SPECIFICATION

- 1 Material:
 Insulator: PA66 (UL94V-0)
 Contacts: Brass, Gold-plated
- 2 Contact resistance: $\leq 20\text{m}\Omega$
- 3 Insulation resistance: $\geq 1000\text{M}\Omega$
- 4 Rated voltage: 250 V AC DC
- 5 Rated current: 2.5 A AC DC
- 6 Withstand Voltage: 800V AC/minute
- 7 Temperature Range: $-25\text{ }^{\circ}\text{C} \sim +85\text{ }^{\circ}\text{C}$
- 8 Six deleterious substance content meet the environmental protection requirement

				TOLERANCE	SCALE:	2510-A			
				. ± 0.25	UNIT: mm			TITLE:	PART NO:
				*.** ± 0.15	VIEW:			2.54mm PITCH	
				*.*** ± 0.05					
				DRAW					
				CHECK					
A	NEW RELEASE			APPRO		深圳市金航标电子有限公司	www.kinghelm.com.cn		
REV	DESCRIPTION	REV. DRAWN	DATE			KH-HX2.54-02Z	0755-28190160		