



# BZX884B series Silicon Planar Zener Diodes

## Features

- Total power dissipation: 250mW max
- Leadless ultra small plastic package suitable for surface-mounted design
- Small package size for high density applications
- Wide zener reverse voltage range: 2.4V to 75V

DFN1x0.6-2L

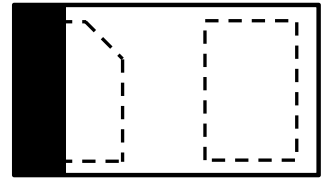

## Absolute Maximum Ratings at $T_A = 25\text{ }^\circ\text{C}$

Parameter	Symbols	Value	Unit
Maximum Power Dissipation	$P_D$	250	mW
Junction Temperature	$T_J$	150	$^\circ\text{C}$
Storage Temperature Range	$T_{STG}$	-65 to +150	$^\circ\text{C}$

## Electrical Characteristics at $T_A = 25\text{ }^\circ\text{C}$

Parameter	Symbols	Value	Unit
Forward Current	$I_F$	200	mA
Forward Voltage at $I_F = 10\text{ mA}$	$V_F$	0.9	V



# BZX884B series

## Silicon Planar Zener Diodes

### Electrical Characteristics at $T_A = 25\text{ }^\circ\text{C}$

( $T_A=25^\circ\text{C}$ , unless otherwise noted,  $V_F < 0.9\text{ V}$  at  $I_F = 10\text{ mA}$ )

Type	Marking Code	Zener Voltage Range <sup>Note1</sup>			$I_{ZT}$	Dynamic Impedance	Reverse Current	
		$V_{ZT}$ at $I_{ZT}$				$Z_{ZT}$ at $I_{ZT}$	$I_R$	at $V_R$
		Min.(V)	Nom.(V)	Max.(V)	(mA)	Max.( $\Omega$ )	Max.( $\mu\text{A}$ )	(V)
BZX884B2V4	A1	2.35	2.4	2.45	5	100	50	1
BZX884B2V7	A2	2.65	2.7	2.75	5	100	20	1
BZX884B3V0	A3	2.94	3	3.06	5	95	10	1
BZX884B3V3	A4	3.23	3.3	3.37	5	95	5	1
BZX884B3V6	A5	3.53	3.6	3.67	5	90	5	1
BZX884B3V9	A6	3.82	3.9	3.98	5	90	3	1
BZX884B4V3	A7	4.21	4.3	4.39	5	90	3	1
BZX884B4V7	A8	4.61	4.7	4.79	5	80	3	2
BZX884B5V1	A9	5.00	5.1	5.20	5	60	2	2
BZX884B5V6	AA	5.49	5.6	5.71	5	40	1	2
BZX884B6V2	AB	6.08	6.2	6.32	5	10	3	4
BZX884B6V8	AC	6.66	6.8	6.94	5	15	2	4
BZX884B7V5	AD	7.35	7.5	7.65	5	15	1	5
BZX884B8V2	AE	8.04	8.2	8.36	5	15	0.7	5
BZX884B9V1	AF	8.92	9.1	9.28	5	15	0.5	6
BZX884B10	AG	9.80	10	10.20	5	20	0.2	7
BZX884B11	AH	10.78	11	11.22	5	20	0.1	8
BZX884B12	AJ	11.76	12	12.24	5	25	0.1	8
BZX884B13	AK	12.74	13	13.26	5	30	0.1	8
BZX884B15	AL	14.70	15	15.30	5	30	0.05	10.5
BZX884B16	C1	15.68	16	16.32	5	40	0.05	11.2
BZX884B18	C2	17.64	18	18.36	5	45	0.05	12.6
BZX884B20	C3	19.60	20	20.40	5	55	0.05	14
BZX884B22	C4	21.56	22	22.44	5	55	0.05	15.4
BZX884B24	C5	23.52	24	24.48	5	70	0.05	16.8
BZX884B27	C6	26.46	27	27.57	2	80	0.05	18.9
BZX884B30	C7	29.40	30	30.60	2	80	0.05	21
BZX884B33	C8	32.34	33	33.66	2	80	0.05	23.1
BZX884B36	C9	35.28	36	36.72	2	90	0.05	25.2
BZX884B39	CA	38.22	39	39.78	2	130	0.05	27.3
BZX884B43	CB	42.14	43	43.86	2	150	0.05	30.1
BZX884B47	CC	46.06	47	47.94	2	170	0.05	32.9
BZX884B51	CD	49.98	51	52.02	2	180	0.05	35.7
BZX884B56	CE	54.88	56	57.12	2	200	0.05	39.2
BZX884B62	CF	60.76	62	63.24	2	215	0.05	43.4
BZX884B68	CG	66.64	68	69.36	2	240	0.05	47.6
BZX884B75	CH	73.50	75	76.50	2	255	0.05	52.5

Note: 1.  $V_{ZT}$  is tested with 20ms pulse.



## Typical Characteristic Curves

Zener Reverse Voltage : 2.4V

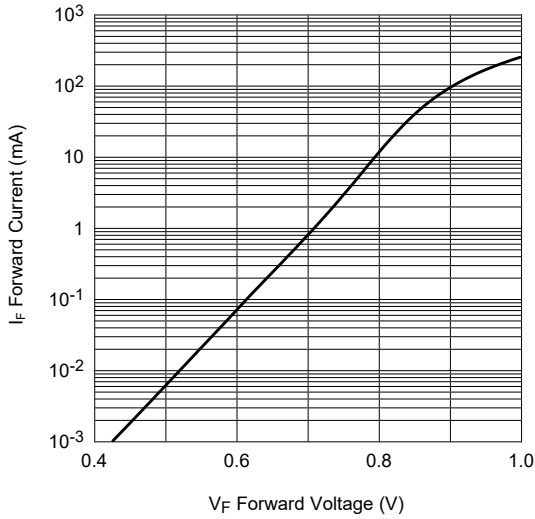

Zener Reverse Voltage : 6.8V

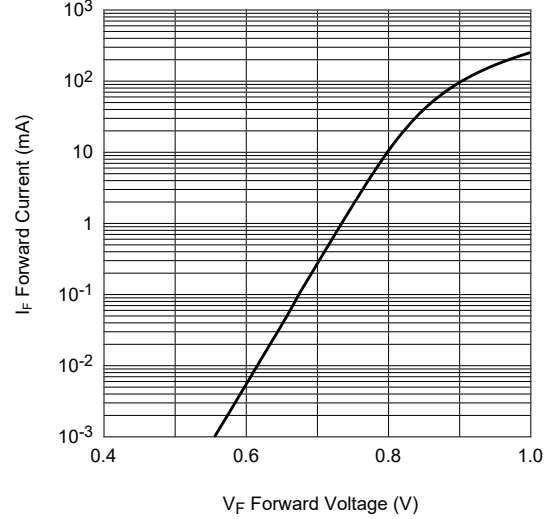

Zener Reverse Voltage : 7.5V

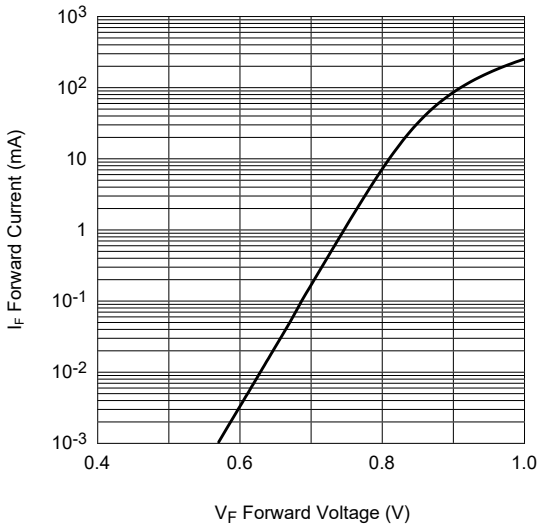

Zener Reverse Voltage : 75V

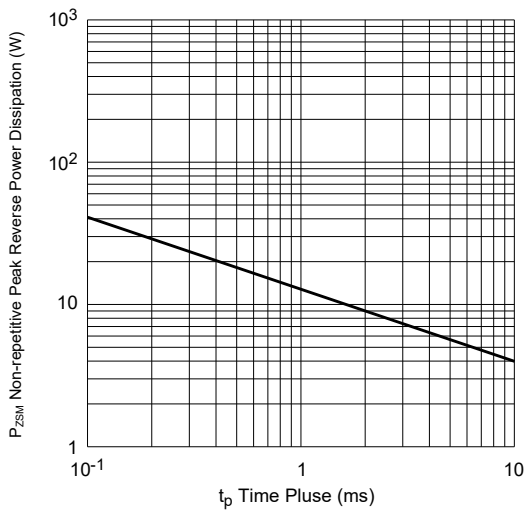
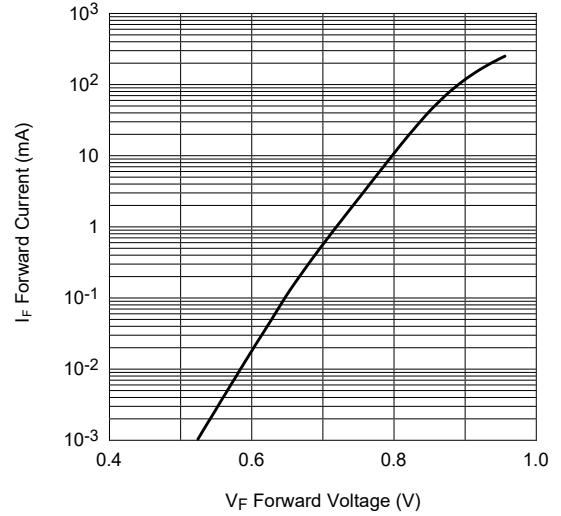



# BZX884B series Silicon Planar Zener Diodes

Zener Reverse Voltage Range : 2.4V~6.8V

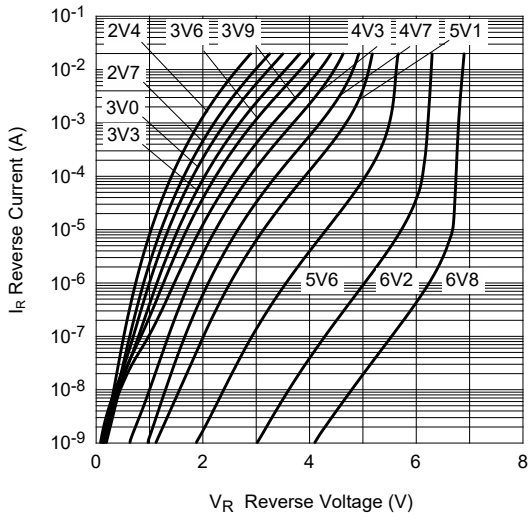

Zener Reverse Voltage Range : 7.5V~24V

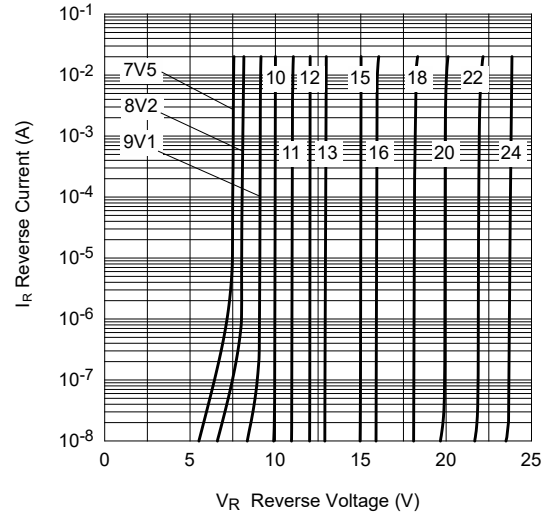

Zener Reverse Voltage Range : 27V~75V

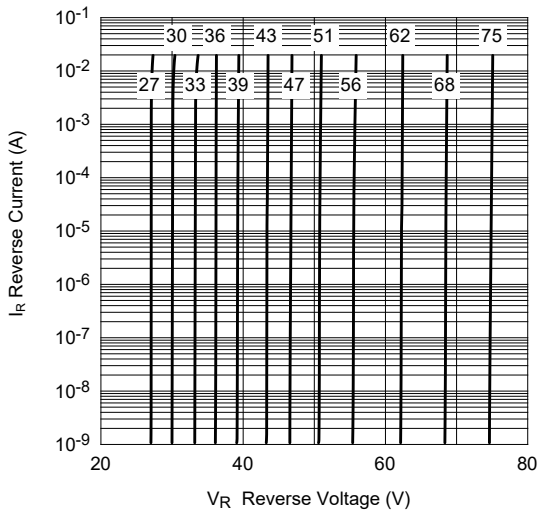



# BZX884B series Silicon Planar Zener Diodes

## Package Outline

DFN1x0.6-2L-0011

Dimensions in mm

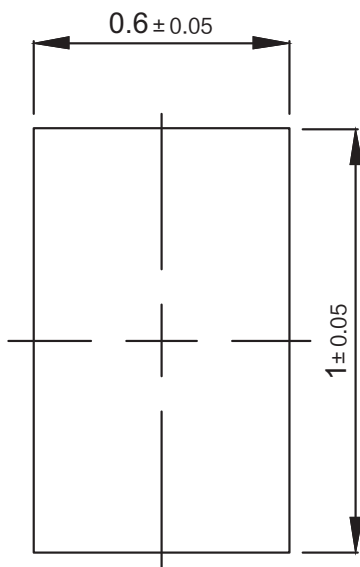

TOP VIEW

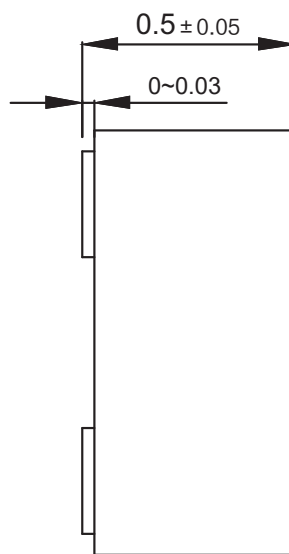

SIDE VIEW

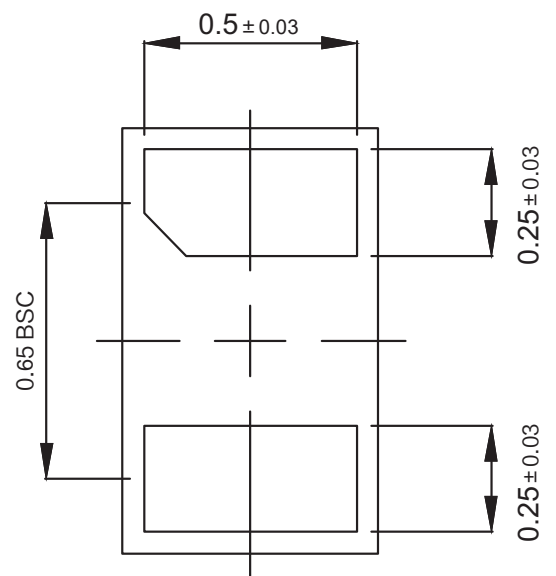

BOTTOM VIEW

## Ordering Information

Device	Package	Shipping
BZX884B series	DFN1x0.6-2L	10,000PCS/Reel&7inches