

REV.	DESCRIPTION	APPD.	DATE
A	INITIAL RELEASED	Chen	2021/04/09

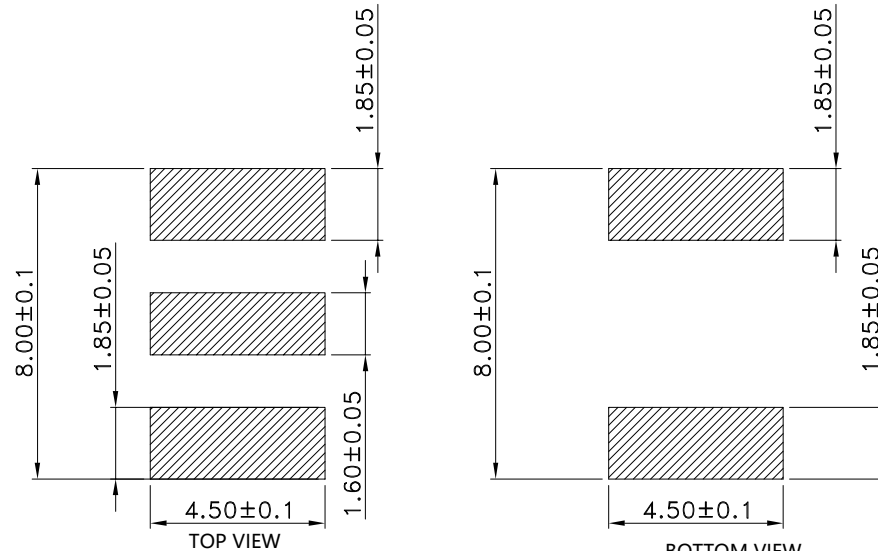
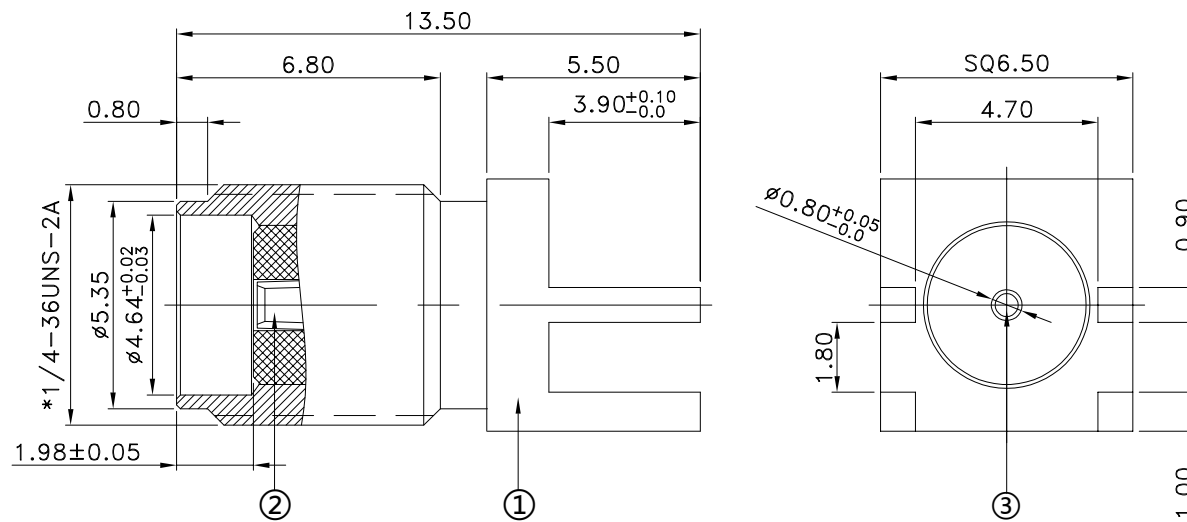

TYPICAL SPECIFICATIONS

1.0.ELECTRICAL

- 1.1.FREQUENCY RANGE: DC-6GHZ
- 1.2.NOMINAL IMPEDANCE: 50 Ohm
- 1.3.WORKING VOLTAGE:335V MAX.
- 1.4.PROOF VOLTAGE:750V
- 1.5.VSWR:1.5MAX.
- 1.6.INSULATION RESISTANCE: 1000 Mohm
- 1.7.CONTACT RESISTANCE: CENTER CONTACT:5 mohm
- 1.8.OUTER CONTACT: ≤2.5 mohm
- 1.9.Thread torque: 15 in-lbs MIN.

- 2.0.Mechanical damage resistance: plug/unplug 500 times

2.0.ENVIRONMENTAL

- 2.1.OPERATING TEMPERATURE RANGE: -55°C TO +125°C
- 2.2.SALT SPRAY:48HOURS
- 2.3.RoHS COMPLIANT

RECOMMENDED PCB LAYOUT

DIMENSIONS ARE IN MILLIMETERS  
UNLESS OTHERWISE SPECIFIED  
TOLERANCES  
ANGLES = ±3°  
UP TO 6 = ±0.1  
6-40 = ±0.2  
40-120 = ±0.6  
120-315 = ±1.0  
ABOVE 315 = ±1.6

CUS P/N:  
A-SMA-KE-13.5A  
PART NO.:  
M04-0100770R0A

**MyAntenna**<sup>®</sup>  
TITLE:  
SMA JCAK S/T FOR PCB

APPD: 陈建坊  
CHKD: 陈建坊  
DR: 董清廷

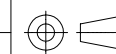

SCALE SHEET REV.  
1:1 1/1 V01

ITEM	DRAWING NO.	PART NAME	DESCRIPTION	QTY
③	SMA014114G-3323	CENTER PIN	GOLD-PLATED BRASS (GOLDEN)	1PCS
②	SMA418072I-1751	INSULATOR	PTFE (WHITE)	1PCS
①	SMA065135G-3545	BODY	GOLD-PLATED BRASS (GOLDEN)	1PCS