

NOTES:

1:MATERIAL

1-1: SUS-301 THICKNE=0.15MM

2:SPECIFICATIONS

2-1: CONTACT RESISTANCE: 80mΩ/MAX

2-2: RATED CURRENT: 1.0A

2-3: VOLTAGE RATING: 1.5V

2-4: WELDING THRUST: ≥3KG

2-5: CLAMPING FORCE:60-120g

2-6: OPERATING TEMPERATURE: -40°C~+85°C

3:DURABILITY: 200 CYCLES

4:SALT SPRAY TIME: 24H

5:ELECTROPLATE: THE NICKEL-PLATED SUBSTRATE IS 50u" MIN

6:REQUIREMENTS

6-1:TERMINAL TO EAT FULL TIN,NOTPEELING,

WELDING OBVIOUS COLOR AND OTHED ADVERSE

6-2:ROHS.REACH.HF HALOGER ADVERSE OF DOMESTIC

AND INTERNATIONAL ENVIRONMNTAL REQUIREMENTS

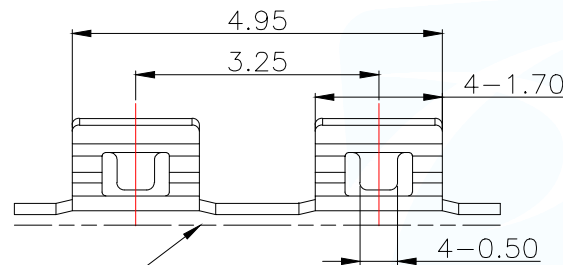

Solder Area

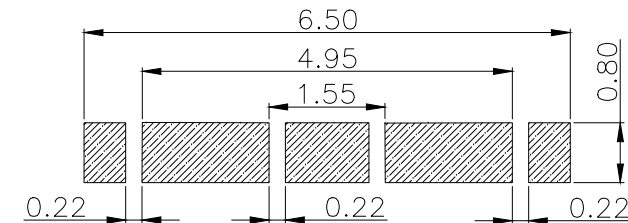

METAL MASK T=0.08

TOLERANCE:±0.05MM
(FOR REFERENCE ONLY)

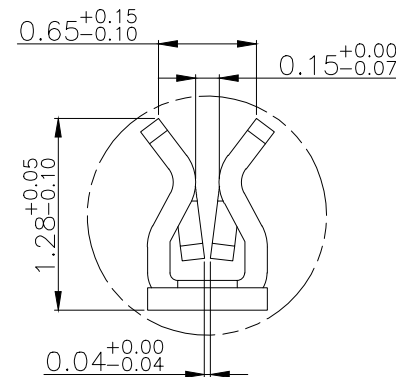
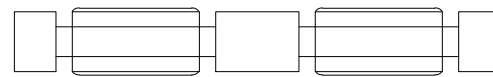

Detail I
Scale 2:1

| | | | |
|---------------------------------------|-------------|---|--------------------------------|
| MANUFACTURE DWG | | 东莞市讯普电子科技有限公司 DongGuan XunPu Electronics Co.,Ltd | |
| UNLESS OTHERWISE SPECIFIED TOLERANCES | | | TITLE: H1.28 SHIELDING CLIP |
| | | | PAR ASP-X1208-CB1 |
| DECIMALS: | ANGLES: | | DWN Lucas |
| X.:±0.30 | X':±2' | | CHKD Ethan |
| X.X:±0.20 | X.X':±1' | APVD Jacob | SCALE1:1 UNIT:MM |
| X.XX:±0.15 | X.XX':±0.5' | CUSTOMER COPY | SIZE:A4 SHEET:1F1 REV:A |

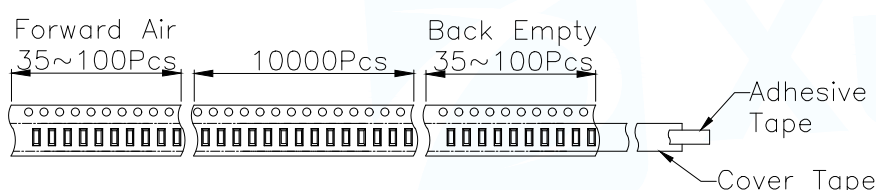
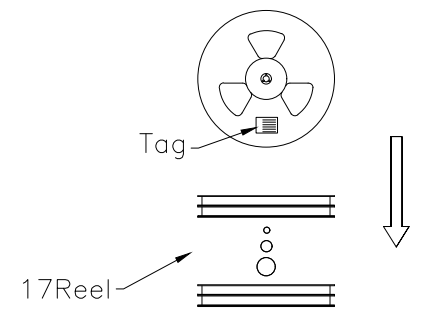
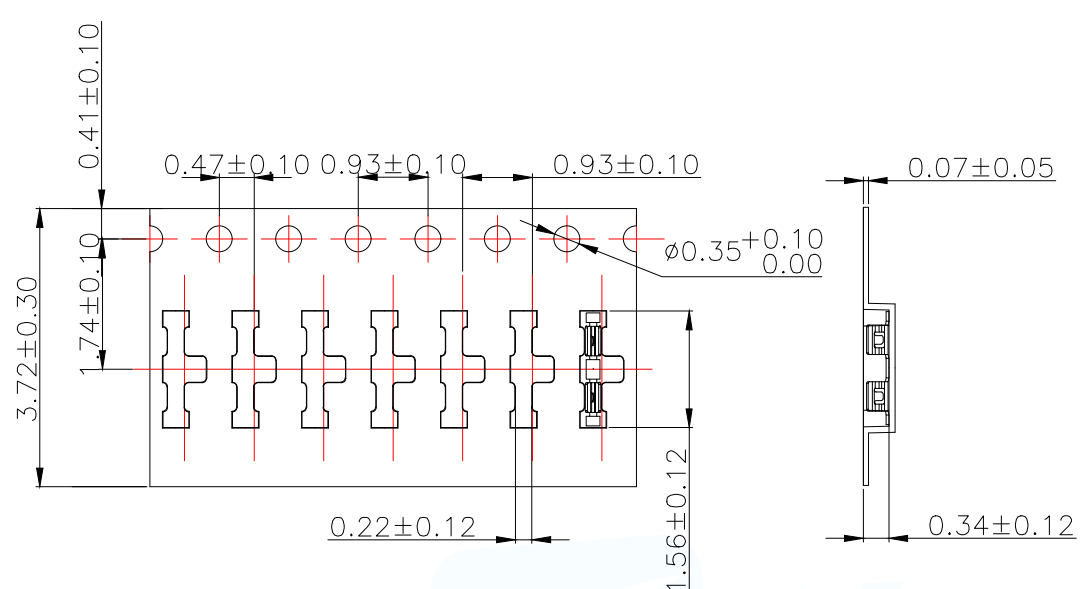

Customer To Use Direction Pull Out Direction (出料方向)

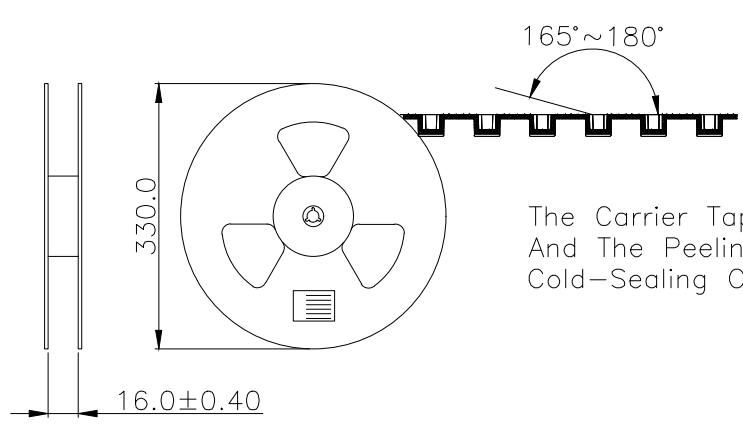

Carton Size 290*330*4 K3K

Carton Size 345*345*360 K=K

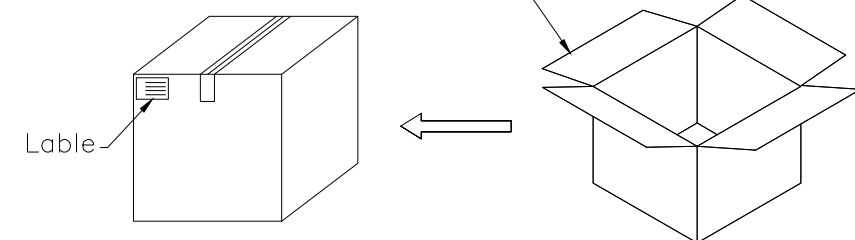

| | | | |
|---------------------------------------|-------------|---|---------------|
| MANUFACTURE DWG | | 东莞市讯普电子科技有限公司 DongGuan XunPu Electronics Co.,Ltd | |
| UNLESS OTHERWISE SPECIFIED TOLERANCES | | TITLE: H1.28 SHIELDING CLIP | |
| | | PAR | ASP-X1208-CB1 |
| DECIMALS: | | DWN | Lucas |
| ANGLES: | | CHKD | Ethan |
| X.:±0.30 | X.':±2' | APVD | Jacob |
| X.X:±0.20 | X.X':±1' | SCALE:1:1 | UNIT:MM |
| X.XX:±0.15 | X.XX':±0.5' | SIZE:A4 | SHEET:1F1 |
| CUSTOMER COPY | | | REV:A |