

3D View

NOTES:

- 1:MATERIAL  
1-1: SUS-304 THICKNE=0.10MM
- 2:SPECIFICATIONS  
2-1: RATED CURRENT: 1.0A  
2-2: VOLTAGE RATING: 1.5V  
2-3: CONTACT RESISTANCE: 80mΩ/MAX  
2-4: WELDING THRUST: ≥3KG  
2-5: OPERATING TEMPERATURE: -40°C~+85°C
- 3:DURABILITY: 1500 CYCLES
- 4:SALT SPRAY TIME: 24H
- 5:ELECTROPLATE: THE NICKEL-PLATED SUBSTRATE IS 50u" MIN
- 6:REQUIREMENTS  
6-1:TERMINAL TO EAT FULL TIN,NOTPEELING, WELDING OBVIOUS COLOR AND OTHED ADVERSE  
6-2:ROHS.REACH.HF HALOGER ADVERSE OF DOMESTIC AND INTERNATIONAL ENVIRONMNTAL REQUIREMENTS

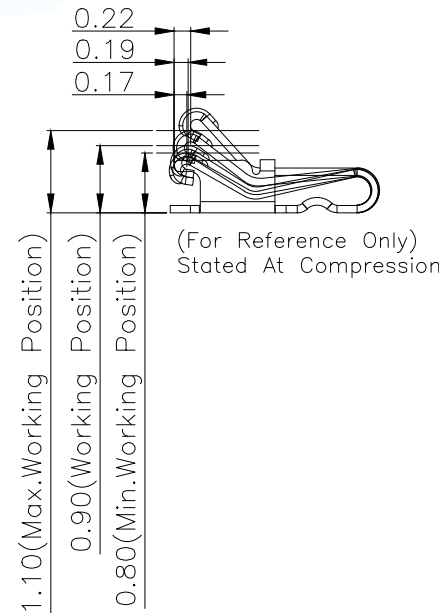
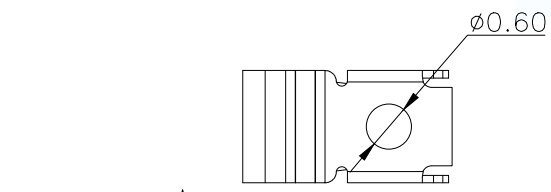
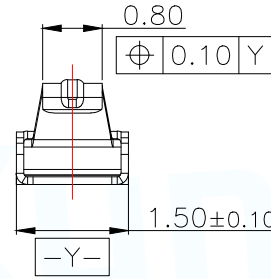
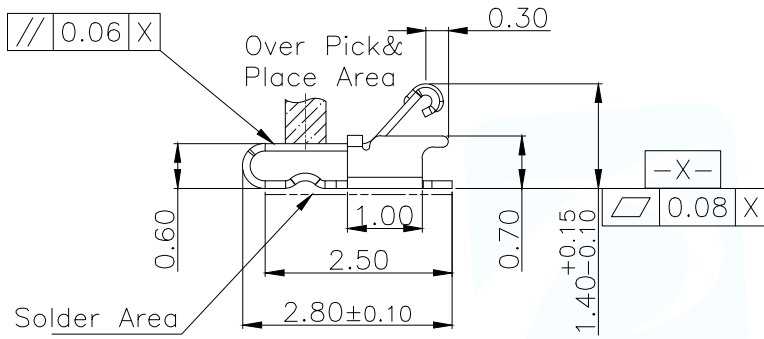

(For Reference Only)  
Stated At Compression

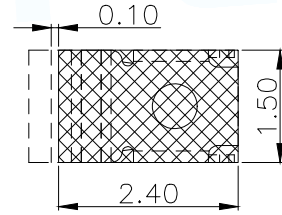

RECOMMENDED PCB LAYOUT  
TOLERANCE:±0.05MM  
(FOR REFERENCE ONLY)

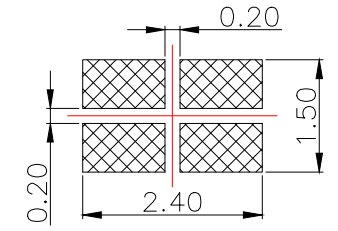

METAL MASK T=0.08  
TOLERANCE:±0.05MM  
(FOR REFERENCE ONLY)

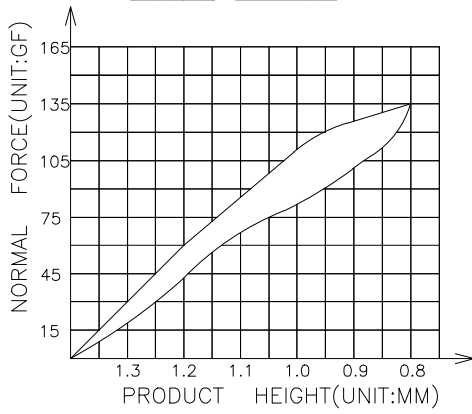

MANUFACTURE DWG		东莞市讯普电子科技有限公司 DongGuan XunPu Electronics Co.,Ltd	
UNLESS OTHERWISE SPECIFIED TOLERANCES			TITLE: 天线弹片 L2.80*W1.50*H1.40
			PAR ASP-D1401-B01
DECIMALS:	ANGLES:		DWN Lucas
X.:±0.30	X.':±2°		CHKD Ethan
X.X:±0.20	X.X':±1°		APVD Jacob
X.XX:±0.15	X.XX':±0.5°	CUSTOMER COPY	SCALE1:1 UNIT:MM
		SIZE:A4	UNIT:MM
		SHEET:1F1	REV:A

12	13	14	15
MAPX	MODIFICATION	DATE	APPROVE

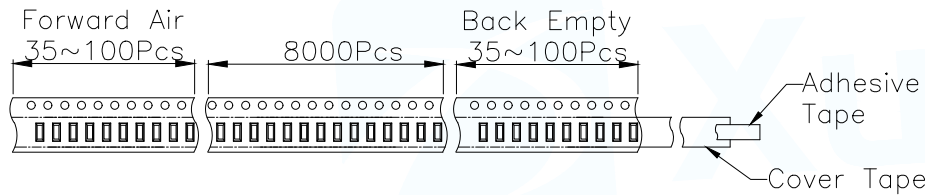
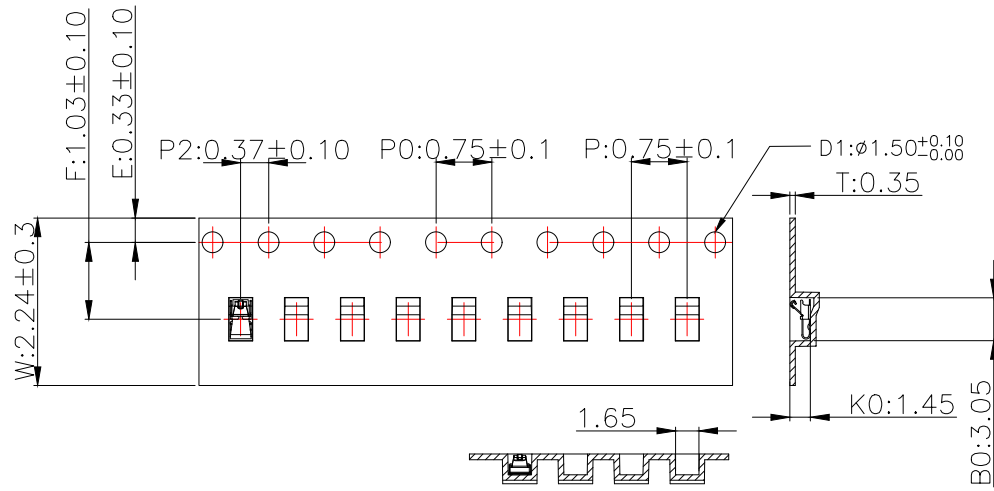

Customer To Use Direction Pull Out Direction (出料方向)

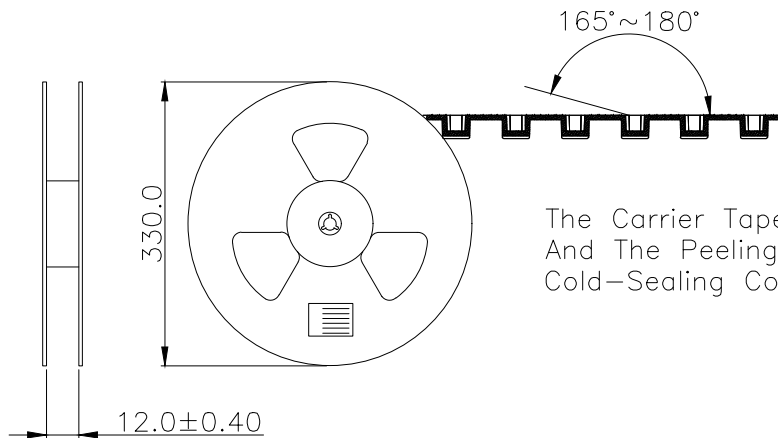

The Carrier Tape Is Cold-Sealed And The Peeling Angle Of The Cold-Sealing Cover Tape Is 165°~180°.

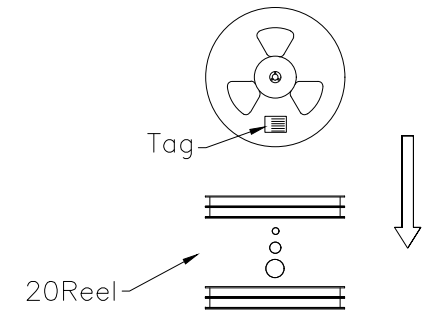

Carton Size 290\*330\*4 K3K

Carton Size 345\*345\*360 K=K

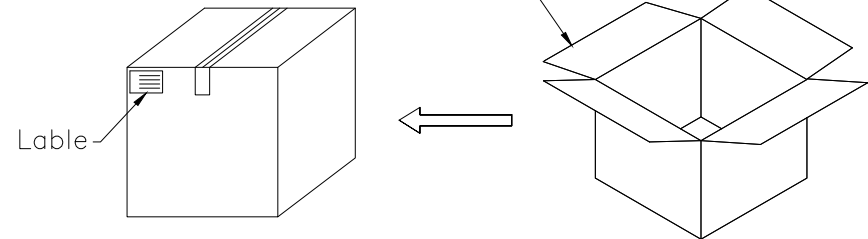

MANUFACTURE DWG		东莞市讯普电子科技有限公司 DongGuan XunPu Electronics Co.,Ltd	
UNLESS OTHERWISE SPECIFIED TOLERANCES		TITLE: 天线弹片 L2.80*W1.50*H1.40	
		PAR	ASP-D1401-B01
DECIMALS:	ANGLES:	DWN	Lucas
X.:±0.30	X.':±2'	CHKD	Ethan
X.X:±0.20	X.X':±1'	APVD	Jacob
X.XX:±0.15	X.XX':±0.5'	SCALE:1:1	UNIT:MM
CUSTOMER COPY		SIZE:A4	SHEET:1F1
			REV:A