

3D View

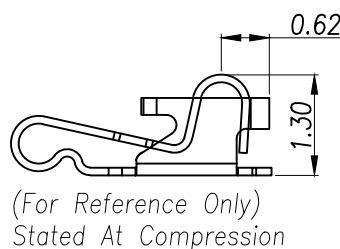

(For Reference Only)
Stated At Compression

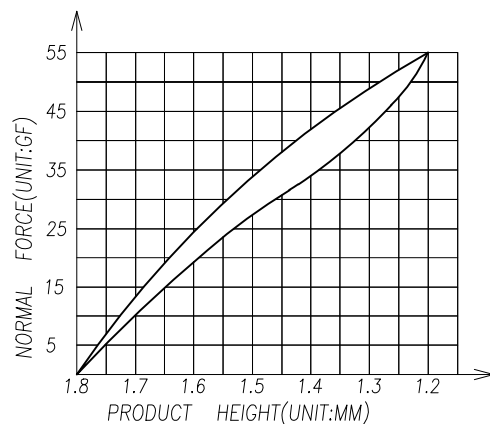
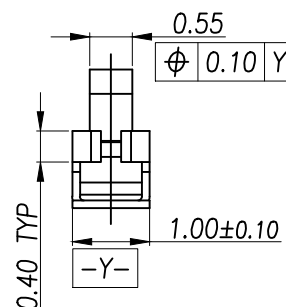
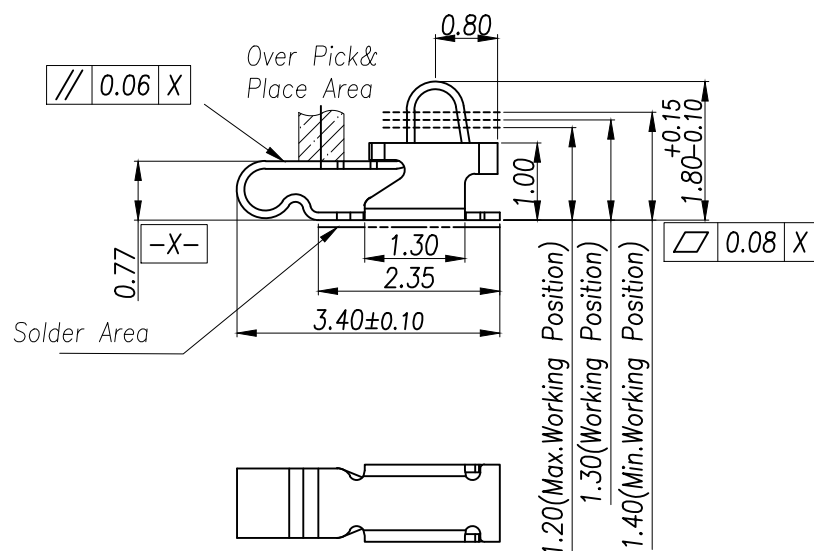
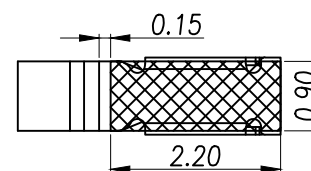

RECOMMENDED PCB LAYOUT
TOLERANCE: ±0.05MM
(FOR REFERENCE ONLY)

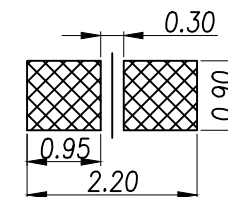

METAL MASK T=0.08
TOLERANCE: ±0.05MM
(FOR REFERENCE ONLY)

NOTES:

1:MATERIAL

1-1: SUS-304 THICKNE=0.10MM

2:SPECIFICATIONS

2-1: RATED CURRENT: 1.0A

2-2: VOLTAGE RATING: 1.5V

2-3: CONTACT RESISTANCE: 80mΩ/MAX

2-4: WELDING THRUST: ≥3KG

2-5: OPERATING TEMPERATURE: -40°C~+85°C

3:DURABILITY: 1500 CYCLES

4:SALT SPRAY TIME: 24H

5:ELECTROPLATE: THE NICKEL-PLATED SUBSTRATE IS 50u" MIN

6:REQUIREMENTS

6-1: TERMINAL TO EAT FULL TIN, NOT PEELING,
WELDING OBVIOUS COLOR AND OTHER ADVERSE

6-2: ROHS, REACH, HF, HALOGEN ADVERSE OF DOMESTIC
AND INTERNATIONAL ENVIRONMENTAL REQUIREMENTS

GENERAL TOLERANCES
(UNLESS SPECIFIED)

DISTANCE ANGLE
X. ±0.30 X.* ±2.0°
.X ±0.20 .X* ±1.0°
.XX ±0.15 .XX* ±0.5°

DRAFT WHERE APPLICABLE APPROVED BY
MUST REMAIN
WITHIN DIMENSIONS

SCALE: 1:1
UNIT: MM

DRAWN BY

LUDAH

CHECKED BY

/

LUJIAH



瑾珩精密

TITLE: 天线弹片
L3.40*W1.00*H1.80

PART NO.
TP-T0-1811

MANUFACTURE DWG

SCALE
N:A

SHEET
1:2

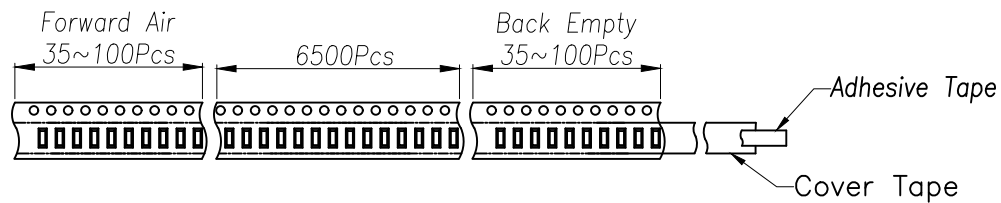
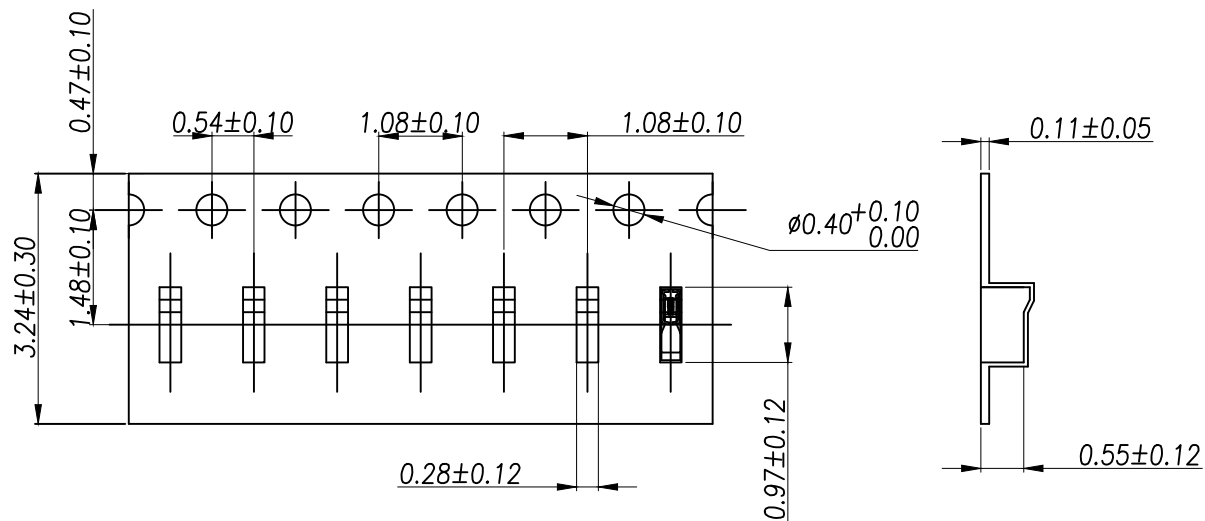

Customer To Use Direction

Pull Out Direction
(出料方向)

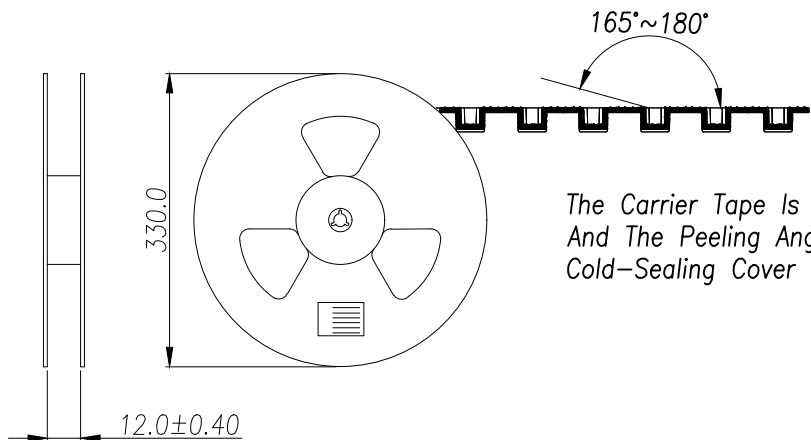

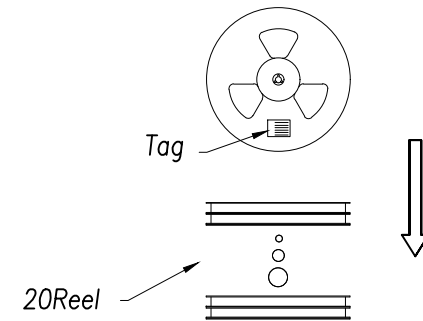

The Carrier Tape Is Cold-Sealed
And The Peeling Angle Of The
Cold-Sealing Cover Tape Is 165°~180°.

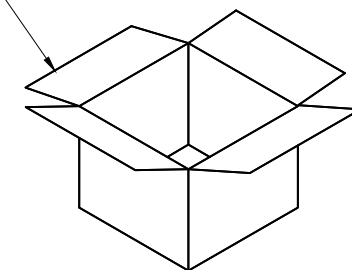
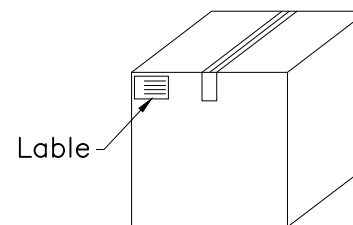

Carton Size
290*330*4 K3K

Carton Size
345*345*360 K=K



GENERAL TOLERANCES (UNLESS SOECIFIED)	SCALE: 1:1 UNIT: MM		<div> 瑾珩精密</div>			
DISTANCE ANGLE X. ±0.30 X.* ±2.0° .X ±0.20 .X* ±1.0° .XX ±0.15 .XX* ±0.5°	DRAWN BY		TITLE: 天线排片 L3.40*W1.00*H1.80			
	LUDAH					
	CHEVKED BY		MANUFACTURE DWG			
	/					
DRAFT WHERE APPLICABLE APPROVED BY MUST REMAIN WITHIN DIMENSIONS			PART NO. TP-T0-1811		SCALE	SHEET
	LUJIAH				N:A	2:2