

RoHS

NOTES:

- 1.Rated voltage : 250V(Max)
- 2.Current Rating: 3.0 AMP (Max.)
- 3.Contact Resistance: 30mΩ (Max.)
- 4.Withstanding voltage : 1000V AC/Minute
- 5.Insulation Resistance: 1000MΩ (Min)
- 6.Operation Temperature: -40°C to +105°C

MATERIAL:

- 1.Housing : PBT (UL94V-0)
- 2.Contact : Copper Alloy, Au/Sn over Ni Plating
- 3.Shell : Steel, Ni or Sn Plated
- 4.Screw : SWRCH, Ni Plated
- 5.Harpoon : Copper Alloy, Tin Plated

REVISION RECORD				
REV	ECN	DESCRIPTION	DRFT	DATE
A0		NEW	R.Q	2021.12.15

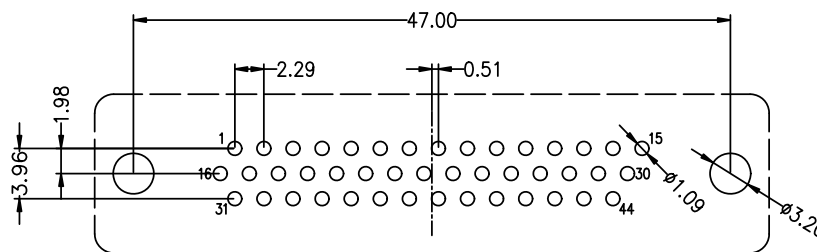
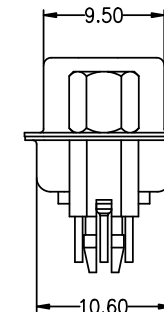
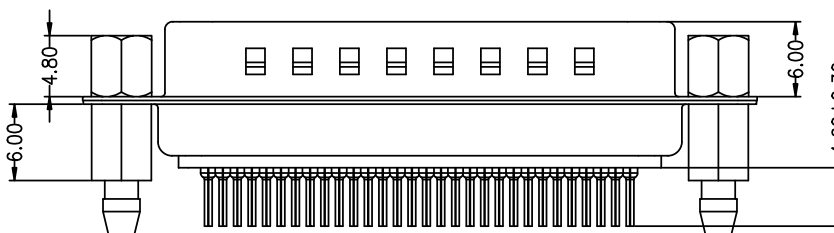
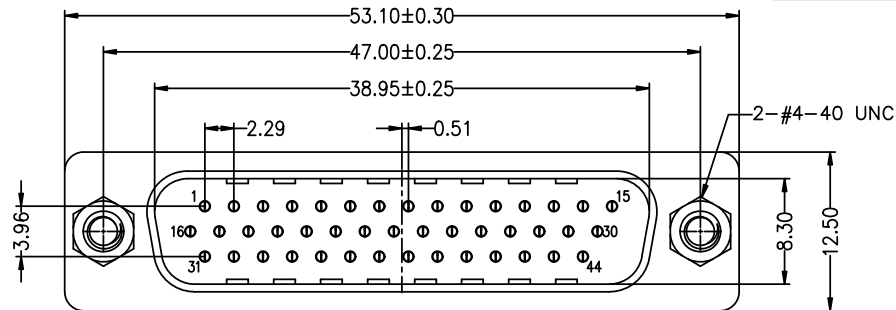

Recommended P. C. B Layout
Top View
Tolerance: ±0.05mm

Ordering Information

6235-03 **M** **44** **XX** **S** **X** **A** **XX**

Connector Type: F=Female, M=Male
No. of Pins: 15,26, 44P
Contact Plating: S0:Gold Flash/Tin, G0:Gold Flash, G2:2u" Gold, G3:3u" Gold, G4:5u" Gold
Color: B=Black, W=White, U=Blue
Packing: A=Tray
Serial code

DRAW		OPERATION	SCALE	FIT	东莞市锦凌电子有限公司 DONGGUAN JINLING ELECTRONIC CO.,LTD	
		X.X	±0.30	UNIT		mm
		CHECK	X.XX	±0.20		SIZE
APPROVE		X.XXX	±0.10	SHEET	1/1	
		Angle	±3'	PROJ.		
PART NO.		6235-03M44XXSXAXX				
TITLE:		HDP-44P公/柳鱼叉锁螺丝				