

1 2 3 4 5 6 7 8 9 10

ROHS

MAPX	MODIFICATION	DRW	DATE

Specifications / 技术规格:

Current rating: 3A
额定电流: 3A

Voltage rating: 250V AC, DC
额定电压: 250V AC, DC

Insulation Resistance: 1000MΩ Min.
绝缘电阻: 最小1000MΩ

Dielectric Withstanding: 1000V AC 1Min
耐电压: 1000V AC 1分钟

Contact Resistance: 20mΩ Max.
接触电阻: 最大20mΩ

Operating Temperature: -25°C to +85°C
工作温度: -25°C 到85°C

Materials / 材料:

Contact Material: Brass(plating Sn)
接触端子材料: 黄铜(镀锡)

Insulation Material: PA66, UL94V-0/2
绝缘基材: PA66 UL94 V-0/2

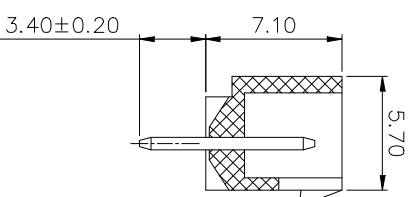
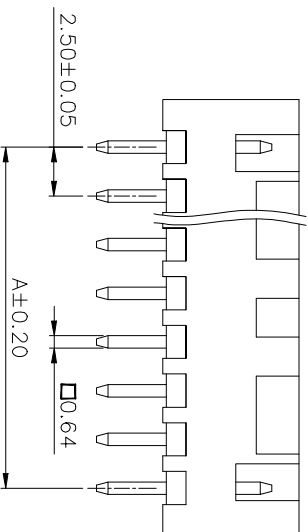
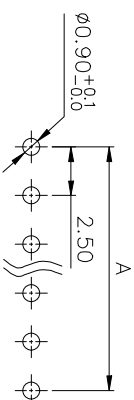
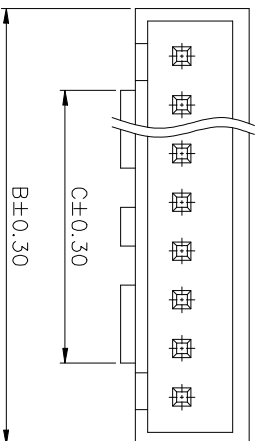

孔数	型号	尺寸 (mm)		
		A	B	C
2	XHB-2A	2.5	7.5	1.70
3	XHB-3A	5.0	10.0	2.40
4	XHB-4A	7.5	12.5	4.80
5	XHB-5A	10.0	15.0	5.85
6	XHB-6A	12.5	17.5	8.10
7	XHB-7A	15.0	20.0	10.6
8	XHB-8A	17.5	22.5	11.7
9	XHB-9A	20.0	25.0	13.7
10	XHB-10A	22.5	27.5	
11	XHB-11A	25.0	30.0	
12	XHB-12A	27.5	32.5	
13	XHB-13A	30.0	35.0	14.7
14	XHB-14A	32.5	37.5	
15	XHB-15A	35.0	40.0	
16	XHB-16A	37.5	42.5	

产品图

PRODUCT CHART DWG

深圳市精拓金电子有限公司
Shenzhen Jing Tuo Jin Electronics Co., Ltd.

公差一览表 TOLERANCE UNLESS OTHERWISE		单位 UNITS	制图 DRAWING	制图料号 PRODUCT PART NO.
X	±0.35	X	±5.°	L-S-S
X	±0.25	X	±2.°	G-2-F
XX	±0.20	XX	±1.°	黄国荣
XXX	±0.05	XXX	±0.5°	
DATE	2021-03-10	核准 APPD		版本 VER
				A0

您正在使用 ZWCAD 2022 个人版, 不得用于商业用途, 详情请咨询4007-182-588.

G F E D C B A

1 2 3 4 5 6 7 8 9 10