

THIS IS A C.A.D. GENERATED DRAWING
DO NOT MAKE MANUAL REVISIONS TO MASTER.

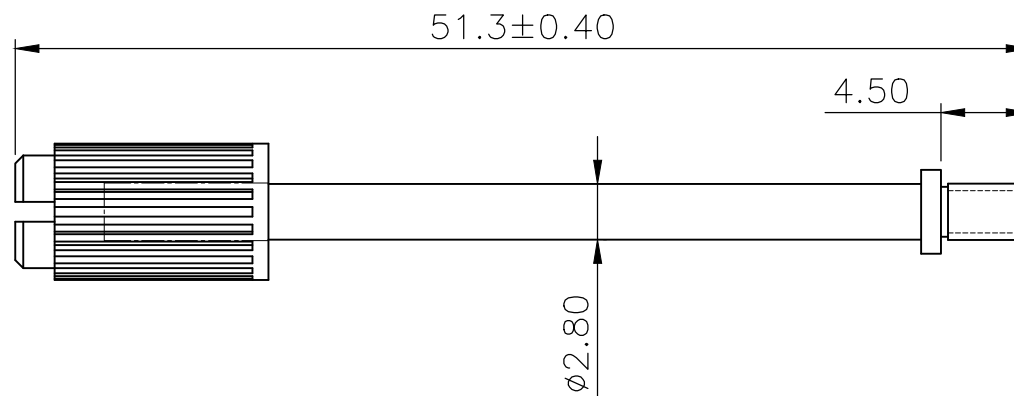

* UNLESS OTHERWISE SPECIFIED TOLERANCES
ON DECIMAL IS: ANGLE $\pm 1^\circ$
UNIT: MM .X ± 0.38
.XX ± 0.25

ISSUE NUMBER
ORIGINAL ①



MH PN	KNOB COLOR	THREAD
6718-0101-01	BLACK	4-40 UNC
6718-0102-01	GREY	4-40 UNC

NOTES:

1. MATERIAL:
KNOB: PLASTIC.
SHAFT: STEEL.
2. PLATING:
SHAFT: COMMERCIAL ZINC PLATING.
3. OTHER COLOURS ON KNOBS ARE AVAILABLE UPON REQUEST.
4. M3,M2.5 THREAD ARE AVAILABLE UPON REQUEST.
5. ROHS & REACH COMPLIANT.

THESE DRAWINGS AND SPECIFICATIONS ARE THE PROPERTY OF MH CONNECTORS AND SHALL NOT BE REPRODUCED, COPIED OR USED AS THE BASIS FOR THE MANUFACTURE OR SALE OF APPARATUS WITHOUT WRITTEN PERMISSION.

DRAWN Johnny	DATE 07-01-24
-----------------	------------------

APPROVED Victor Lin	DATE 07-01-24
------------------------	------------------



THIS SERIES FULLY CONFORMS TO THE
EUROPEAN UNION DIRECTIVES 2015/863/EU
AND 2011/65/EU FOR RoHS COMPLIANCY.



**MH CONNECTORS ,
DIVISION OF EDAC**

SCALE 1 : 1	SHEET OF 1 OF 1	REV: 1.0
----------------	--------------------	-------------

DRAWING No
6718-010X-01