

- Family of 2-wire Common Mode Chokes
- Low profile surface mount package
- Range suited for many DSL and Telecom applications
- Operating Temperature: -40°C to +85°C
- Current rating : 200mAAC Max 50MHZ( $\Delta T \leq 40^\circ\text{C}$ )



PTG0405-04

Electrical Specification @25°C	
Inductance:	PIN1-4 = PIN2-3 = 4.7mH +50%/-30% @10KHz/0.1V,100mVAC,1-4,Ls
Turn Ratio:	(1-4):(2-3)=1:1±1%
Hi-POT :	1500VAC, 1minute test by applying 1875VAC for 1 second between 1-2
D.C.R:	(1-4 ),0.65ohms Max.
D.C.R:	(2-3 ), 0.65ohms Max.

### Dimensions

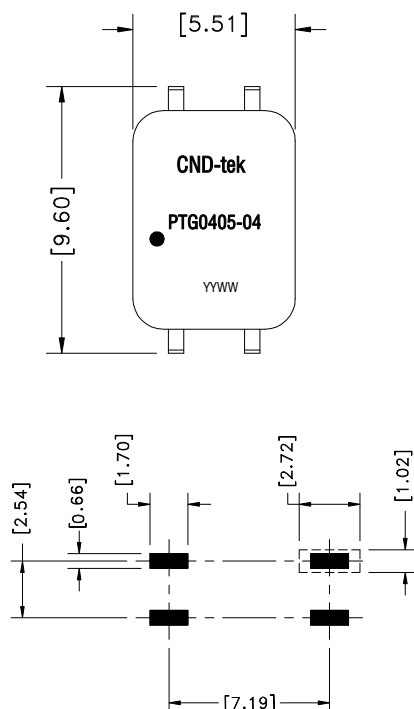
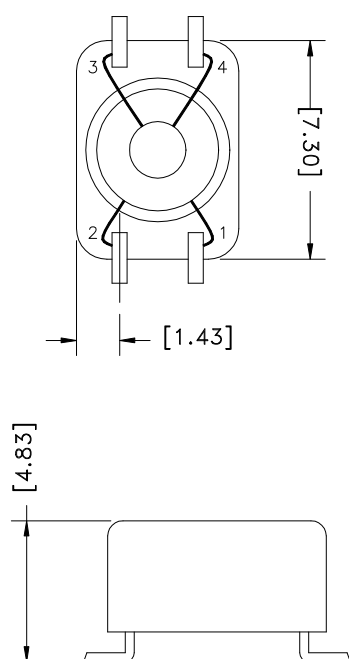

### Schematic

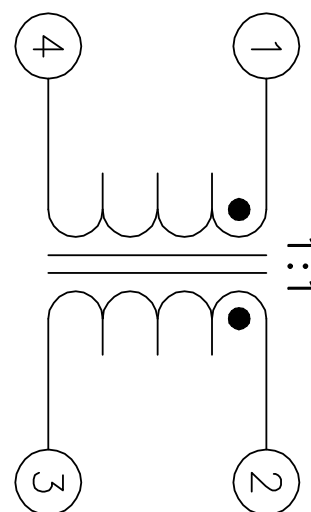

CUSTOMER TO DETERMINE LAND LAYOUT

1. units/reel:1650PCS
2. reel/carton:5PCS
3. units/carton :8250PCS

(Units: mm,Unless otherwise specified, all tolerances are  $\pm 0.05\text{mm}$ )