

# 1. FIGURE AND DIMENSIONS (视图及尺寸)

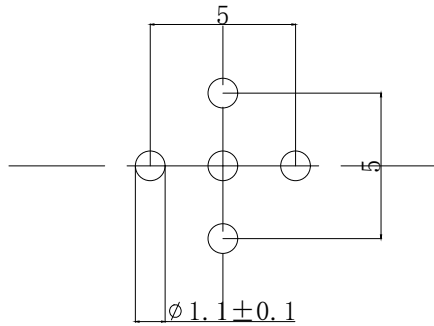

PCB板开板尺寸

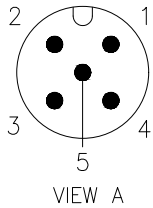
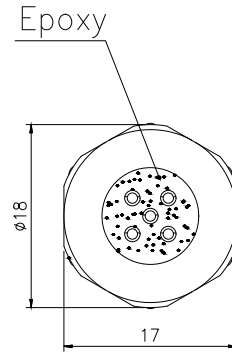
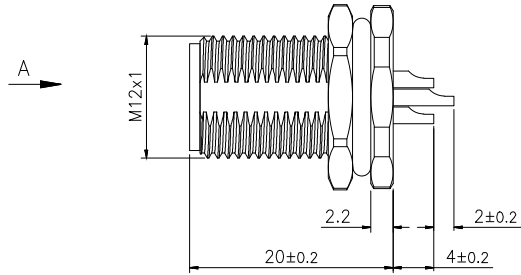
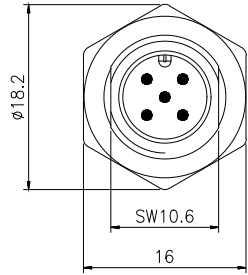
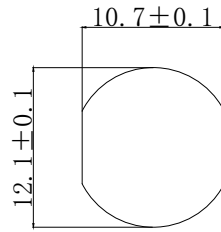

面板开孔尺寸

Main technical indicators (主要技术指标)	
1. Mating (插拔次数)	500
2. Working Temperature (温度)	-40~+80°
3. IP Rating (防护级别)	IP 67
5. Rated voltage (额定电压)	60V
6. Rated Current (额定电流)	5
7. Shell material (壳体材质)	Brass is nickel-plated/黄铜镀镍
8. Pin Material (插针材料)	Copper gilding (铜镀金)
9. Insulation resistance (绝缘电阻)	>100MΩ
10. Insulator material (绝缘体材料)	橡胶黑色
11. Salt spray test (盐雾测试)	>48H

Sum up (总结)	
Series (系列)	M12
Shell style/model (外壳样式/型号)	GX12:Fixed socket, front and rear panel mount type/固定式插座, 前后面板安装型
Button (按键)	1 button (1个按键)
Termination type (终止类型)	Male solder (公板接)
Line diameter awg (线材直径)	-
Cable diameterφ (电缆直径)	-
Match plug (匹配插头)	-

版本			
REVA4			
REVA3			
REVA2			
REVA1			
DRAW		DATE	
CHECK		DATE	
APPR' D		DATE	

TITLE	
PART NO.	
USE	

DRAWING NO.		REV.
TGA. M12. P05. NPA. 12		A0
UNIT	mm	
SCALE	Free	
SHEET	10F N	

XKB INDUSTRIAL PRECISION CO., LIMITED