

| REVISIONS | | | | | |
|-----------|---------|----------|------------------|------------|--------|
| REV. | ECN NO. | LOCATION | DESCRIPTION | DATE | DESIGN |
| A0 | N/A | | INITIAL RELEASE | | |
| A1 | N/A | | 产品图面变更, 图面升级整理图面 | 2024.08.19 | 阿树 |

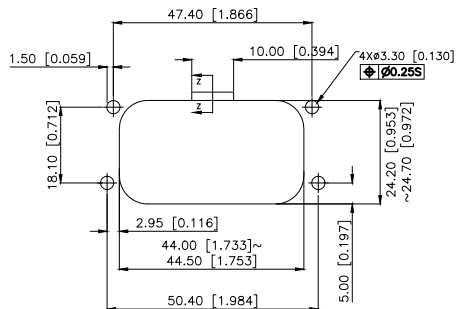
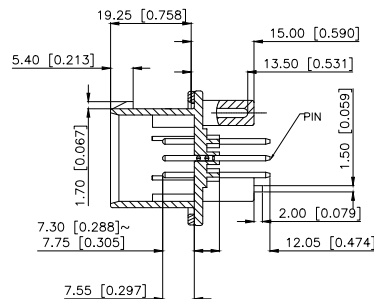
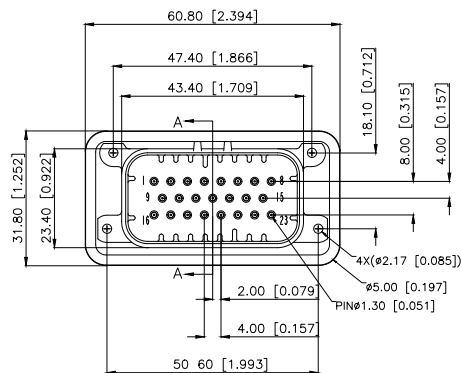

Voltage rating(额定电压):250V AC DC
Temperature range(使用温度):-40℃~+85℃

PART NO.:
K 776280 W V-XX-PT XX X
① ② ③ ④ ⑤ ⑥ ⑦

- 1.K:XKBTEK-Car Connector
- 2.XKB Series No
- 3.Category:W-Wafer
- 4.Welding Board Angle:V-Straight 180°
- 5.Row No.Pin No:XX-35 Pin
- 6.Material:PT-PBT
- 7.Palting:V01-Gold Flash ;SN-Plated Tin
- 8.Color:X-B-Black; W-White ;GY-Gray ;BL-Blue

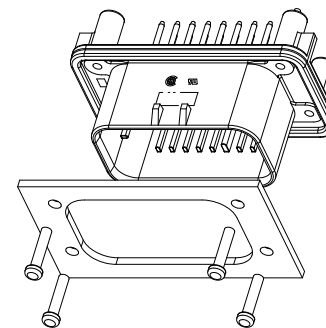
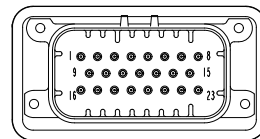
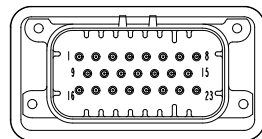
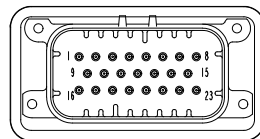
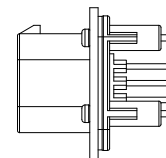
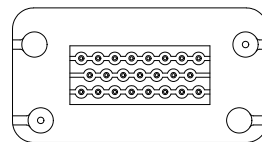
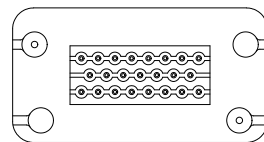
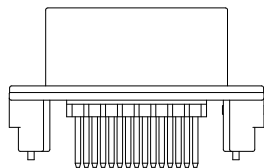

| | | | |
|--------------------|----------|---------------|----------------------|
| K776280WV-XX-PTXXX | PBT | Brass | K776280H |
| PART NO | Material | Material(Pin) | Suitable XKB Housing |

| | |
|------------------------|-------|
| ANGLAR | ±5° |
| X. | ±0.40 |
| X.x | ±0.30 |
| X.xx | ±0.20 |
| X.xxx | ±0.15 |
| UNSPECIFIED TOLERANCES | |



| | |
|----------|----|
| DESIGN | 阿树 |
| CHECKED | |
| APPROVED | |

| | |
|-------|-------|
| VIEW: | |
| UNIT: | mm/in |
| SIZE: | A4 |

MODEL TYPE:
4.0mm automotive connector
PART NO.:
K776280WV-XX-PTXXX
DWG NO.:

XKB INDUSTRIAL PRECISION CO.,LIMITED

| | | |
|-------|------|----------|
| SCALE | PAGE | REVISION |
| N/A | 1/1 | A1 |