

1

2

3

4

5

6

7

8

9

10

ROHS

MAPX

MODIFICATION

DRW

DATE

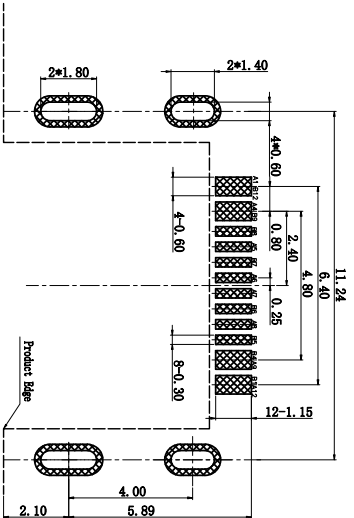
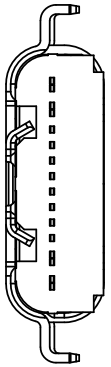

RECOMMENDED PCB LAYOUT
TOLERANCE UNSPECIFIED ±0.05mm

- 备注:
- 1.材料:
 - 1.1.胶芯: LCP+30%G.F
 - 1.2.端子: C2680-H, T=0.15mm; 镍底, 镀金1U"
 - 1.3.外壳: S1S201-1/2H, T=0.30mm; 整体镀镍
 - 1.4.中夹片: S1S201-1/2H, T=0.15mm
 - 2.主要特性:
 - 2.1.额定电流: 3A
 - 2.2.接触阻抗: 40mΩ MAX
 - 2.3.绝缘阻抗: 100MΩ MIN 250V DC
 - 2.4.耐压测试: 100V AC
 - 2.5.沾锡性: 温度250±5℃, 时间5±0.5s
 - 2.6.整体插入力: 2.0kgf MAX
 - 耐久前整体拔出力: 0.8kgf MIN
 - 2.7.使用寿命: 10000次
 - 2.8.工作温度: -30℃~+80℃

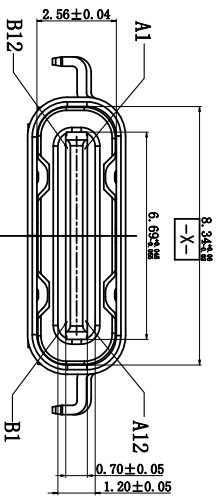
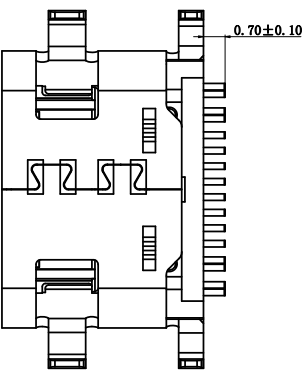
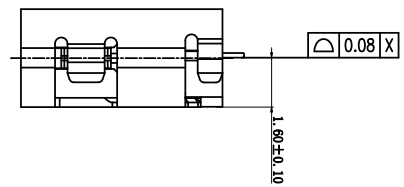
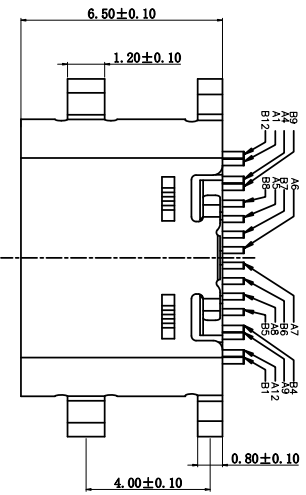

Pin	Signal Name	Description	Pin	Signal Name	Description
A1	GN0	Ground return	B12	GN0	Ground return
A2	SST01	Positive half of first differential TX	B11	SST01	Positive half of first differential RX
A3	SST01	Negative half of first differential TX	B10	SST01	Negative half of first differential RX
A4	Vns	Bus Power	B9	Vns	Bus Power
A5	CC1	Configuration Channel	B8	S202	Standalone Use (S20)
A6	Dp1	Positive half of the USB 2.0 differential pair-Position 1	B7	Dp2	Negative half of the USB 2.0 differential pair-Position 2
A7	Dn1	Negative half of the USB 2.0 differential pair-Position 1	B6	Dp2	Positive half of the USB 2.0 differential pair-Position 2
A8	S201	Standalone Use (S20)	B5	CC2	Configuration Channel
A9	Vns	Bus Power	B4	Vns	Bus Power
A10	SST02	Negative half of second SuperSpeed RX differential pair	B3	SST02	Negative half of second SuperSpeed TX differential pair
A11	SST02	Positive half of second SuperSpeed RX differential pair	B2	SST02	Positive half of second SuperSpeed TX differential pair
A12	GN0	Ground return	B1	GN0	Ground return

产品图
PRODUCT CHART DWG

深圳市精拓金电子有限公司
Shenzhen Jing Tuo Jin Electronics Co., Ltd.

公差一览表		单位		制图		制料号	
TOLERANCE UNLESS OTHERWISE	UNITS	MM	DRAWING	L-S-S	PRODUCT PART NO.	918-418K2024S40025	TRF-cs.1.18P SMT插板.6母连接器6.5LCP盖胶壳
X	±0.35	X	±5.°	郭治富	产品名称		
X	±0.25	X	±2.°	审核	比例	1:1	
XX	±0.20	XX	±1.°	日期	2021-03-10		
XXX	±0.05	XXX	±0.5°	核准	黄国荣		
				角法			
				版本	A0		

您正在使用 ZWCAD2022 个人版, 不得用于商业用途, 详情请咨询4007-182-5884