

GT-BT P 127 XX - 0170 B - 013 A

G-Switch

Series  
BT: Battery

Type  
P: Plug

Pitch  
127=1.27

Pin Q' PY  
02~07

Height  
0170=1.70

Serial code

Detail  
B:No olumn

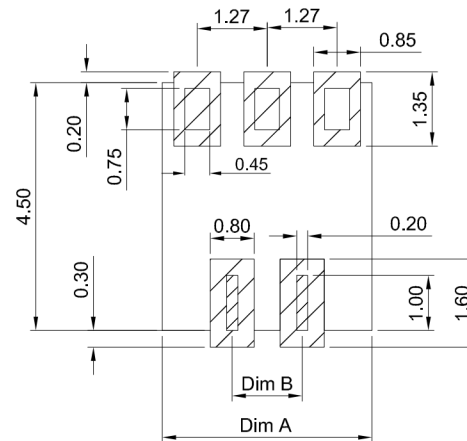
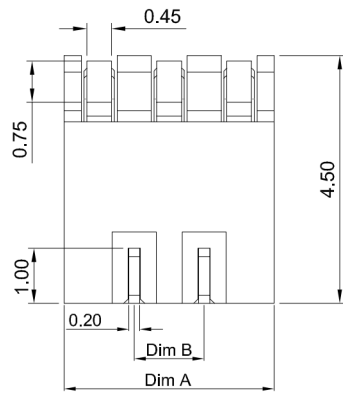

RECOMMENDED PCB LAYOUT  
TOLERANCE:±0.05

**G-Switch Specification:**

- 1.Current rating: 3A
- 2.Rated Voltage: 12V DC
- 3.Insulation resistance: 500MΩ min
- 4.Contact resistance: 30mΩ max
- 5.Dielectric strength: 250V RMS
- 6.Durability: 10,000cycles
- 7.Operating temperature range: -40°C ~ +85°C

NO.	PART NAME	MATERIAL	REMARK
3	FIXED FEET	COPPER ALLOY	Tin OVERALL
2	CONTACT	PHOSPHOR BRONZE	Au ON CONTACT AREA
1	HOUSING	LCP,94V-0	BLACK

**Ordering Information:**

Circuit	Dimensions(mm)	
	A	B
02P	2.54	-
03P	3.81	1.27
04P	5.08	2.54
05P	6.35	3.81
06P	7.62	5.08
07P	8.89	6.35



SCALE: 1:1 UNIT: mm  
SIZE: A4

Unless otherwise  
General Tolerance:  
X ±0.35  
X.x ±0.25  
X.xx ±0.15  
X.xxx ±0.05  
X\* ±3°

Title: Vertical Pitch1.27 Battery Conn  
SMT A×4.5×H1.70mm

Molde Code: GT-BTP127XX-0170B-013A

DRAWN	CHECKED	APPROVED	DATE
Xia	Chen	Chen	2023.12.28



REV: A0 SHEET: 1/1