

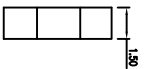

REV.	ECN NO.	DESCRIPTION	DATE	DESIGN

- 备注:
- 1.材质: LCP+30%G.F. UL94V-0 .黑色.
  - 2.产品不可有缩水, 起泡、变形、划伤、缺胶、毛刺、刮伤端子等外观不良.
  - 3.未标注C角为C0.15,毛边0.03MM MAX,功能区不可有毛边.
  - 4.需实配判定贴板.
  - 5.产品模穴号为沉胶凸字, 字体不可高出塑胶面
  - 6.进胶点不能凸出塑胶平面、影响功能性毛边.
  - 7.包装方式: REEL包装.

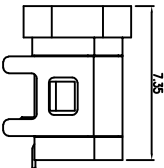
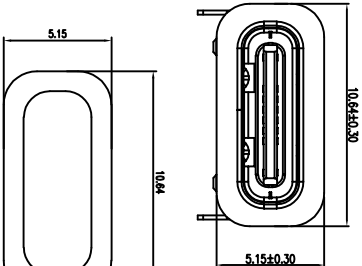
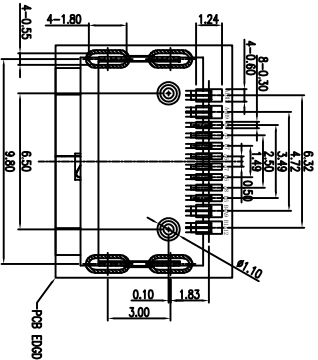
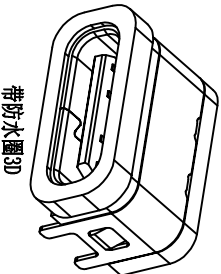
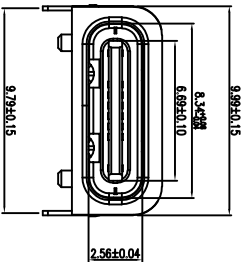
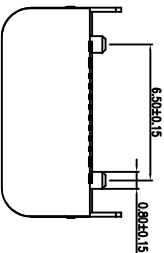
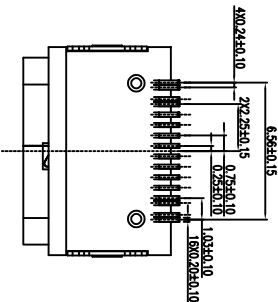
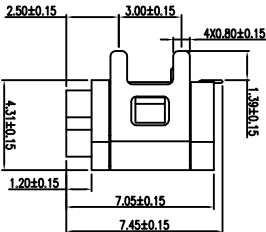
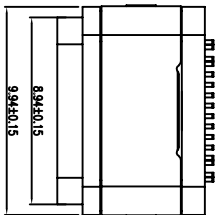

带防水圈示意图

规格	
SUS 301亮镍40u", 48H.	A10
SHELL SUS 304 亮镍40u", 48H.	A11
Molding LCP 黑色 C7025 镀金G/F"	A12

TOLERANCE	NAME(INTENDED USE)
X.X ±0.30 X." ±10"	PART NO.
.XX ±0.20 .X" ± 8"	CUSTOMER DRAWING
.XXX ±0.10 .XX" ± 5"	DESIGN: ZXW
UNITS mm	CHED:
MATERILA -----	APPD:
FINISH -----	

PCB LAYOUT  
TOLERANCE SIZE: ±0.05

SCALE	SHEET	REV.
1:1	1/2	A

CUSTOMER

REV.	ECN NO.	DESCRIPTION	DATE	DESIGN

① 产品入载带示意图

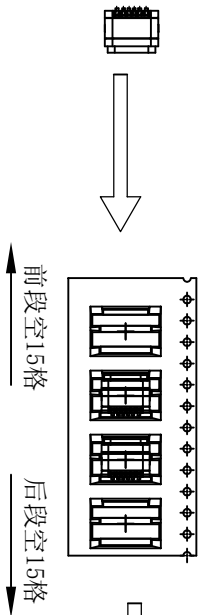

② 卷盘贴标签示意图

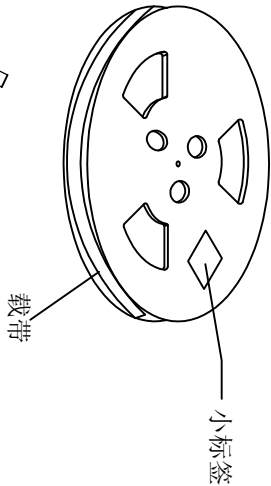

NOTE:

1. QUANTITY/REEL: 700 PCS

數量/卷: 700 PCS

QUANTITY/INNER CARTON: 700 X 10

= 7000 PCS

數量/箱 : 700 X 10 = 7000 PCS

2. FREE 19 CAVE IN THE FRONT

CARRIER ADN FREE

19 CAVE IN THE END CARRIER.

載帶前段空19格,后段空19格

④ 产品入外箱示意图

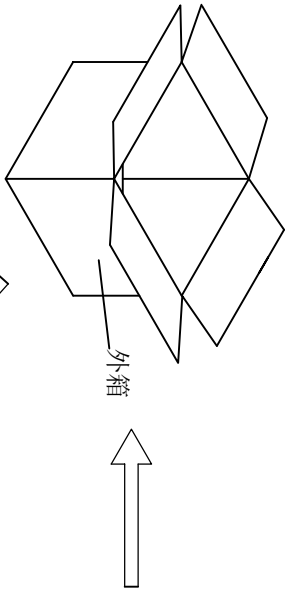

③ 10盘产品叠层示意图

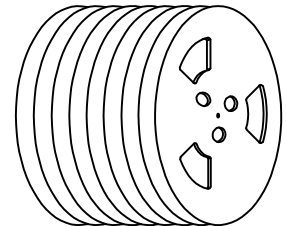

⑤ 外箱封箱示意图

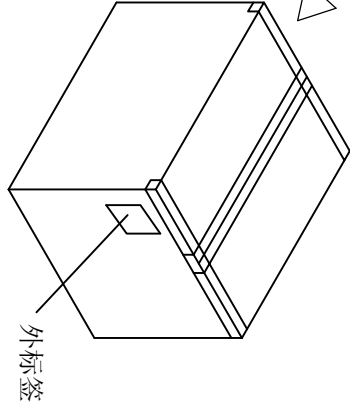

TOLERANCE				NAME(INTENDED USE)			
X.X	±0.30	X."	±10"	CUSTOMER DRAWING			
.XX	±0.20	.X"	± 8"	PART NO.			
.XXX	±0.10	.XX"	± 5"	F723-09TC161F1705-02			
UNITS	mm			DESIGN: ZXM			
MATERILA	----			CHED:			
FINISH	-----			APPD:			

FUYOU 广东富盈兴业精密科技实业有限公司  
Guangdong FUYOU Precision Electronic Technology Co., Ltd.

TITLE: TYPE C 16P防水母座板上7.45L全塑

DRAWG NO. F723-09TC161F1705-02

SCALE SHEET REV.

1:1 1/2 A