

GT-BT P 160 XX - 0220 B - 014 C

**G-Switch**  
**Series**  
 BT: Battery  
**Type**  
 P: Plug  
**Pitch**  
 160=1.60  
**Pin Q' PY**  
 03-04Pin  
**Height**  
 0220=2.20  
**Detail**  
 FP:1.9mm  
**Serial code**  
**Detail**  
 B:No olumn

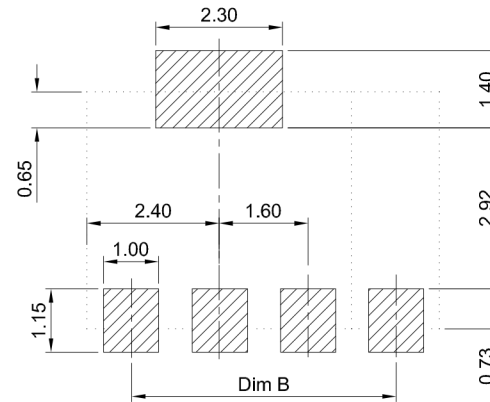
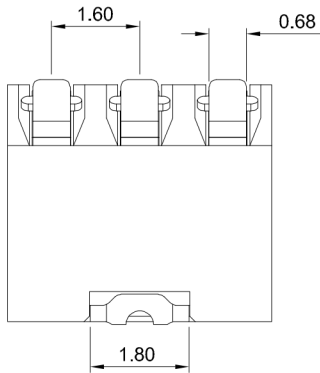

**G-Switch Specification:**

- 1.Current rating: 3A
- 2.Rated Voltage: 12V DC
- 3.Insulation resistance: 500MQ min
- 4.Contact resistance: 30mΩ max
- 5.Dielectric strength: 250V RMS
- 6.Durability: 10,000cycles
- 7.Operating temperature range: -40°C ~ +85°C

NO.	PART NAME	MATERIAL	REMARK
3	FIXED FEET	COPPER ALLOY	Tin OVERALL
2	CONTACT	PHOSPHOR BRONZE	Au ON CONTACT AREA
1	HOUSING	LCP,94V-0	BLACK

**Ordering Information:**

Circuit	Dimensions(mm)	
	A	B
03P	4.80	3.20
04P	6.40	4.80

RECOMMENDED PCB LAYOUT  
 TOLERANCE:±0.05 3&4PIN



SCALE: 1:1 UNIT: mm  
 SIZE: A4

Unless otherwise  
 General Tolerance:  
 X ±0.35  
 X.x ±0.25  
 X.xx ±0.15  
 X.xxx ±0.05  
 X\* ±3°

Title: Vertical Pitch1.6 Battery Conn  
 SMT A×4.3×H2.20mm

Molde Code: GT-BTP160XX-0220B-014C

DRAWN	CHECKED	APPROVED	DATE
Xia	Chen	Chen	2023.12.28



REV: A0 SHEET: 1/1