

TYPE:A (右前左后)

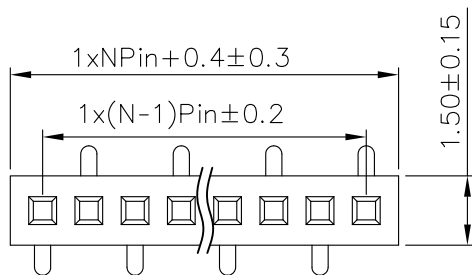

TYPE:B (左前右后)

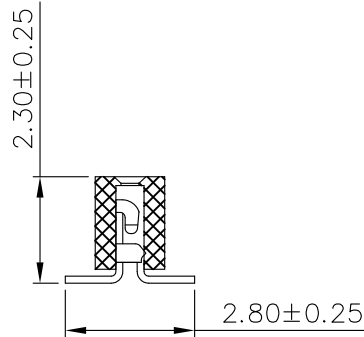
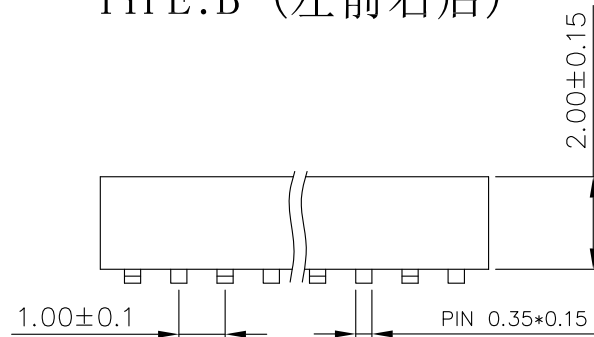

## SPECIFICATIONS

Current Rating: 0.75 Amps  
 Withstanding Voltage: AC 500V  
 Insulation Resistance: 1000M $\Omega$  Min  
 Contact Resistance: 20m $\Omega$  Max  
 Operation Temperature: -40° to +105°  
 Insulator Material: Polyester (UL94V-0)  
 Contact Material: Phosphor bronze  
 Standard: PA6T  
 Contact Plating: Gold Flash  
 Max. Processing Temp: 240° C for 30-60 seconds  
 (260° C for 5 seconds)

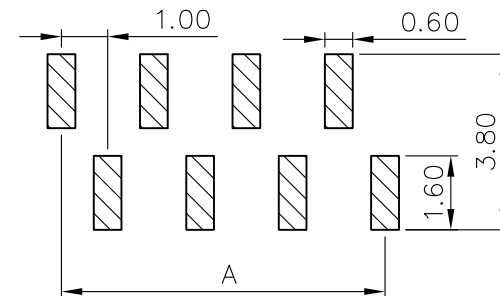

RECOMMEND P. C. B LAYOUT  
 PCB TOLERANCE:  $\pm 0.05$  (TOP VIEW)

TYPE:A (右前左后)

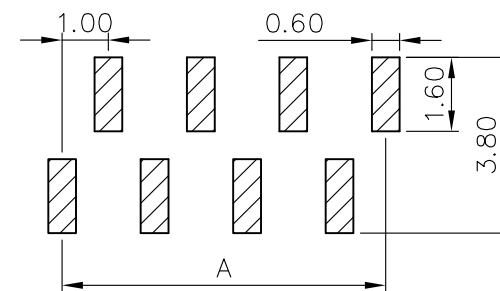

RECOMMEND P. C. B LAYOUT  
 PCB TOLERANCE:  $\pm 0.05$  (TOP VIEW)

TYPE:B (左前右后)



深圳市韩下电子有限公司

UNLESS OTHERWISE SPECIFIED TOLERANCE

X :  $\pm 0.30$  X° :  $\pm 5^\circ$   
 X.X :  $\pm 0.25$  X.X° :  $\pm 1^\circ$   
 X.XX :  $\pm 0.20$  X.XX° :  $\pm 0.5^\circ$

DRAWN NAME:

HX PM1.0-1x7P TP-YQ

SIZE

A4

SCALE

N:1

PROUCT NO.

REV

A

UNIT

mm

PROJECT

PAGE

1/1

DRAWN : 黄彬 2020.6.24

CHECKED :

张伟

2020.6.24

APPROVED :

罗小春

2020.6.24

| of | DIM. A | DIM. B | No. of | DIM. A | DIM. B | No. of | DIM. A | DIM. B | No. of | DIM. A | DIM. B |
|----|--------|--------|--------|--------|--------|--------|--------|--------|--------|--------|--------|
| 1  | 0.00   | 1.00   | 11     | 10.00  | 11.00  | 21     | 20.00  | 21.00  | 31     | 30.00  | 31.00  |
| 2  | 1.00   | 2.00   | 12     | 11.00  | 12.00  | 22     | 21.00  | 22.00  | 32     | 31.00  | 32.00  |
| 3  | 2.00   | 3.00   | 13     | 12.00  | 13.00  | 23     | 22.00  | 23.00  | 33     | 32.00  | 33.00  |
| 4  | 3.00   | 4.00   | 14     | 13.00  | 14.00  | 24     | 23.00  | 24.00  | 34     | 33.00  | 34.00  |
| 5  | 4.00   | 5.00   | 15     | 14.00  | 15.00  | 25     | 24.00  | 25.00  | 35     | 34.00  | 35.00  |
| 6  | 5.00   | 6.00   | 16     | 15.00  | 16.00  | 26     | 25.00  | 26.00  | 36     | 35.00  | 36.00  |
| 7  | 6.00   | 7.00   | 17     | 16.00  | 17.00  | 27     | 26.00  | 27.00  | 37     | 36.00  | 37.00  |
| 8  | 7.00   | 8.00   | 18     | 17.00  | 18.00  | 28     | 27.00  | 28.00  | 38     | 37.00  | 38.00  |
| 9  | 8.00   | 9.00   | 19     | 18.00  | 19.00  | 29     | 28.00  | 29.00  | 39     | 38.00  | 39.00  |
| 10 | 9.00   | 10.00  | 20     | 19.00  | 20.00  | 30     | 29.00  | 30.00  | 40     | 39.00  | 40.00  |