

Circuit diagram  
Normal: 1-2 on 4-5 on  
Press: 2-3 on 5-6 on

**NOTES:**

1. Rated current: 100mA 30V DC
2. Contact resistance:  $\leq 200 \text{ m}\Omega$
3. Press:  $250 \pm 50 \text{ gf}$
4. Maximum travel:  $2.0 \pm 0.2 \text{ mm}$
5. Insulation resistance:  $\geq 100 \text{ m}\Omega$
6. Life : 10000

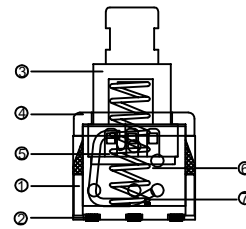
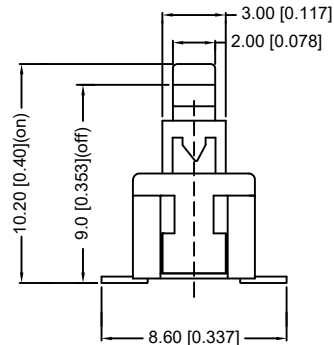
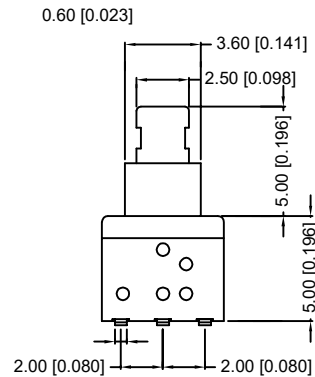

NO.	PAPT NAME	MATERIAL	PLATING\$COLOP
1	HOUSING	PPA	GRAY
2	BUTTON	H62 T=0.3mm	AG
3	HANDLE	PA6T	WHITE
4	COVER	PPA	BLACK
5	CONTACT SPRING	SILVER	
6	SPRING	SUS	
7	HANGER	SUS	

PAPT	XKB5858-X-TP
OPERATION	W:NO LOCK Z:LOCK

MARK	DESCRIPTION	DATE	REVISED	APPROVED	ANGLAR	
ΔX					$\pm 5^\circ$	
ΔX					$L \leq 4$	$\pm 0.2$
ΔX					$4 < L \leq 16$	$\pm 0.3$
					$16 < L \leq 63$	$\pm 0.4$
					$L > 63$	$\pm 0.5$
REVISIONS					UNSPECIFIED TOLERANCES	
www.helloxkb.com www.helloxkb.cn www.xk-dg.cn						



XKB INDUSTRIAL PRECISION CO., LIMITED

DSND	SCALE: N/A	MODEL TYPE:
DWN	VIEW:	PART NO.: XKB5858-X-TP
CHKD	UNIT: mm/in	DWG NO.: X-XKB5858-X-TP
APPD	SIZE: A4	
	WEIGHT	SHEET
		1/1
	REVISION	A0