

### SPECIFICATIONS

Current Rating: 3Amps  
 Insulation Resistance: 1000MΩ Min  
 Contact Resistance: 20mΩ Max  
 Withstanding Voltage: AC 1000V  
 Operation Temperature: -40° to +105°  
 Contact Material: Brass  
 Standard: PA6T  
 Insulator Material: Polyester (UL 94V-0)  
 Contact Plating: Gold Flash  
 Max. Processing Temp: 240° C for 30-60 seconds  
 (260° C for 5 seconds)

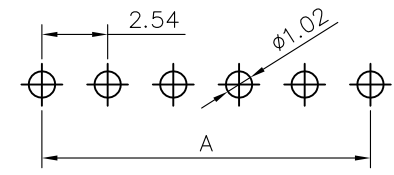

RECOMMEND P. C. B LAYOUT  
 PCB TOLERANCE:  $\pm 0.05$  (TOP VIEW)

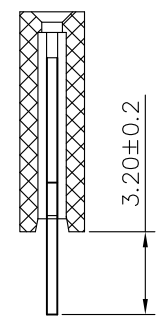
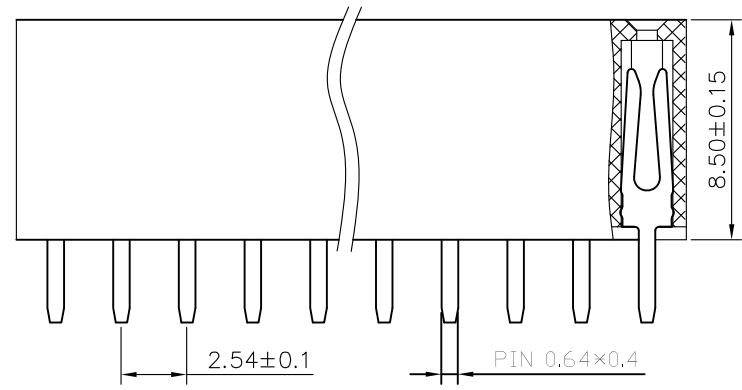
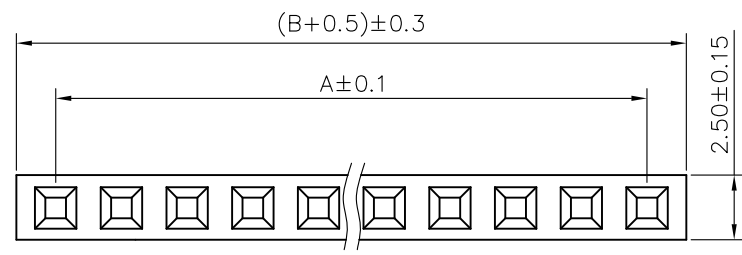

## 深圳市韩下电子有限公司

UNLESS OTHERWISE SPECIFIED TOLERANCE  
 X :  $\pm 0.30$  X° :  $\pm 5^\circ$   
 X.X :  $\pm 0.25$  X.X° :  $\pm 1^\circ$   
 X.XX :  $\pm 0.20$  X.XX° :  $\pm 0.5^\circ$

DRAWN NAME: HX PM2.54-1x19P ZC  
 SIZE A4 SCALE N:1 PROUCT NO.  
 REV A UNIT mm PROJECT PAGE 1/1

DRAW: 黄彬 2022/04/29 CHECKED: 张伟 2022/04/29 APPROVED: 罗小春 2022/04/29

| No. of | DIM. A | DIM. B | No. of | DIM. A | DIM. B | No. of | DIM. A | DIM. B | No. of | DIM. A | DIM. B |
|--------|--------|--------|--------|--------|--------|--------|--------|--------|--------|--------|--------|
| 1      | 0.00   | 2.54   | 11     | 25.40  | 27.94  | 21     | 50.80  | 53.34  | 31     | 76.20  | 78.74  |
| 2      | 2.54   | 5.08   | 12     | 27.94  | 30.48  | 22     | 53.34  | 55.88  | 32     | 78.74  | 81.28  |
| 3      | 5.08   | 7.62   | 13     | 30.48  | 33.02  | 23     | 55.88  | 58.42  | 33     | 81.28  | 83.82  |
| 4      | 7.62   | 10.16  | 14     | 33.02  | 35.56  | 24     | 58.42  | 60.96  | 34     | 83.82  | 86.36  |
| 5      | 10.16  | 12.70  | 15     | 35.56  | 38.10  | 25     | 60.96  | 63.50  | 35     | 86.36  | 88.90  |
| 6      | 12.70  | 15.24  | 16     | 38.10  | 40.64  | 26     | 63.50  | 66.04  | 36     | 88.90  | 91.44  |
| 7      | 15.24  | 17.78  | 17     | 40.64  | 43.18  | 27     | 66.04  | 68.58  | 37     | 91.44  | 93.98  |
| 8      | 17.78  | 20.32  | 18     | 43.18  | 45.72  | 28     | 68.58  | 71.12  | 38     | 93.98  | 96.52  |
| 9      | 20.32  | 22.86  | 19     | 45.72  | 48.26  | 29     | 71.12  | 73.66  | 39     | 96.52  | 99.06  |
| 10     | 22.86  | 25.40  | 20     | 48.26  | 50.80  | 30     | 73.66  | 76.20  | 40     | 99.06  | 101.60 |