

DO NOT
SCALE FROM
THIS PRINT

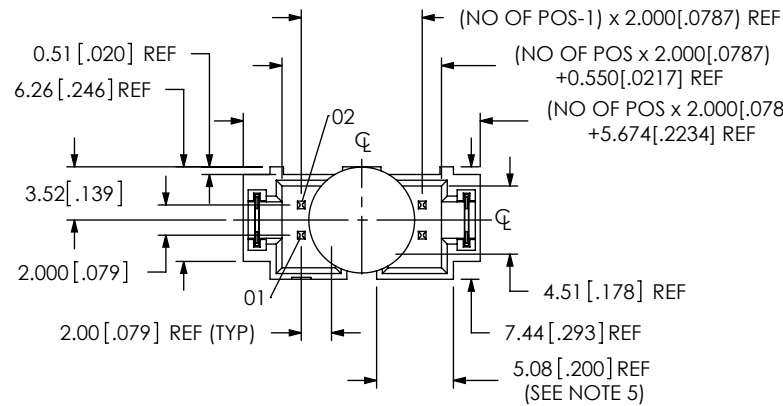

No OF POSITIONS
**-02, **-04, -05, -07, -10, -15,
-20, -25, & -30 (PER ROW)
AVAILABLE AS STANDARD;
OTHER SIZES BETWEEN -05
THRU -50 AVAILABLE AS ASO

LEAD STYLE
-01

PLATING SPECIFICATION
-L: 15μ" SELECTIVE GOLD IN CONTACT
AREA, MATTE TIN ON TAIL
(USE T-1S13-XX-L-2)
-S: 30μ" SELECTIVE GOLD IN CONTACT
AREA, MATTE TIN ON TAIL
(USE T-1S13-XX-S-2)

ROW SPECIFICATION
-D: DOUBLE ROW

OPTION
-DS: DUAL SCREW DOWN (SEE FIG 6, SHT 3)
(FOR 1.57mm [.062] PCB)
(AVAILABLE 5-30 POSITIONS ONLY)
(NOT AVAILABLE WITH -RA, -WT OPTIONS)
(USE T-1S13-04-X-2 WITH TH OPTION
AND TI-M2-4-VFSM-T,
USE T-1S13-20-X-2 WITH SM OPTION
AND TI-M2-4-VFSM-T)
-K: POLYIMIDE FILM (-SM OPTION ONLY)
(USE K-500-300, SEE FIG 4)
(NOT AVAILABLE IN -02 OR -04 POSITIONS)
-TR: TAPE & REEL (-SM OPTION ONLY)
(NOT AVAILABLE IN -02 OR -04 POSITIONS)
-WT: WELD TAB : (USE WT-25-07-T);
(-SM, SEE FIG 3, SHT 2)
(-TH, SEE FIG 5, SHT 2)
-RA: (USE WT-81-01-T)

OPTION
-TH: THROUGH HOLE (SEE FIG 1)
-RA: RIGHT ANGLE (SEE FIG 2)
-SM: SURFACE MOUNT (SEE FIG 3, SHT 2)

** = ONLY AVAILABLE WITH -SM-WT OR -RA-WT OPTIONS

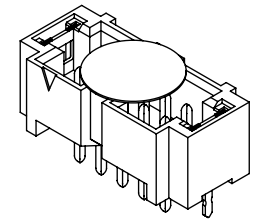
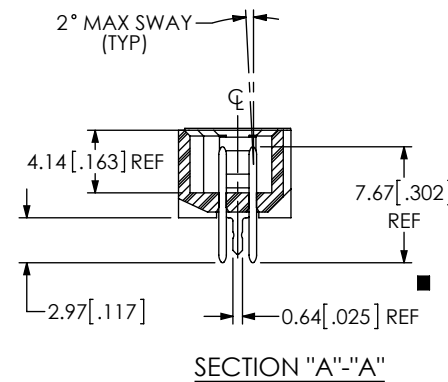
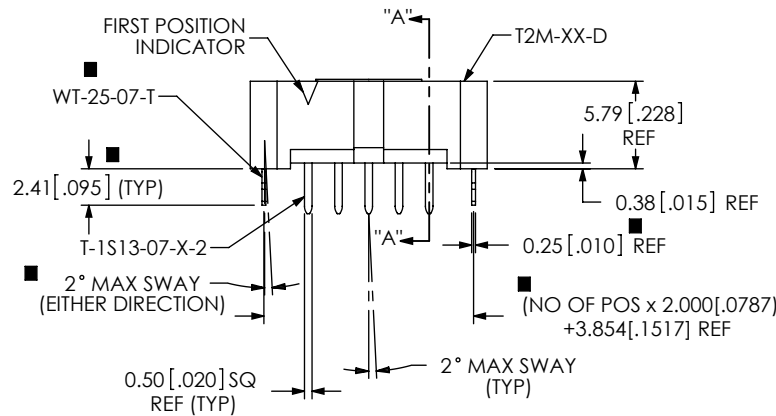

FIG 1
T2M-105-01-X-D-TH-XX
(■ = ONLY APPLICABLE WITH -WT OPTION)

NOTES:

1. Ⓢ REPRESENTS A CRITICAL DIMENSION.
2. MINIMUM PUSHOUT FORCE: 4.44N[1.0 LB].
3. POST HEIGHT VARIATION BETWEEN ANY TWO PINS: 0.13[.005] MAXIMUM.
4. MAXIMUM PIN ROTATION IN BODY TO BE 2°.
5. DUAL POLARIZATION SLOT NOT AVAILABLE ON CONNECTOR WITH LESS THAN 5 POSITIONS.

UNLESS OTHERWISE SPECIFIED,
DIMENSIONS ARE IN MILLIMETERS.
TOLERANCES ARE:
DECIMALS ANGLES
X.X: ±0.3 [.01] 2°
X.XX: ±0.13 [.005]
X.XXX: ±0.051 [.0020]

PROPRIETARY NOTE

THIS DOCUMENT CONTAINS INFORMATION
CONFIDENTIAL AND PROPRIETARY TO
SAMTEC, INC. AND SHALL NOT BE REPRODUCED
OR TRANSFERRED TO OTHER DOCUMENTS OR
DISCLOSED TO OTHERS OR USED FOR ANY
PURPOSE OTHER THAN THAT WHICH IT WAS
OBTAINED WITHOUT THE EXPRESSED WRITTEN
CONSENT OF SAMTEC, INC.

MATERIAL: DO NOT SCALE DRAWING
INSULATOR: LCP, COLOR: BLACK
TERMINAL: PHOS BRONZE
WELD TAB: PHOS BRONZE
KAPTON: POLYIMIDE FILM

SHEET SCALE: 2:1

samtec

520 PARK EAST BLVD, NEW ALBANY, IN 47150
PHONE: 812-944-6733 FAX: 812-948-5047
e-Mail: info@SAMTEC.com code 55322

DESCRIPTION:
2mm SHROUDED TERMINAL STRIP

DWG. NO.
T2M-1XX-XX-X-D-XX-XX

BY: J. BORGELT 3/23/09 SHEET 1 OF 3

2° MAX SWAY
(TYP)

FIG 3
T2M-105-01-X-D-SM-WT SHOWN
(SAME AS FIG 1, EXCEPT AS SHOWN)



SECTION "C"-"C"

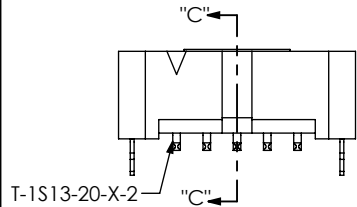
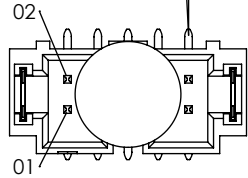
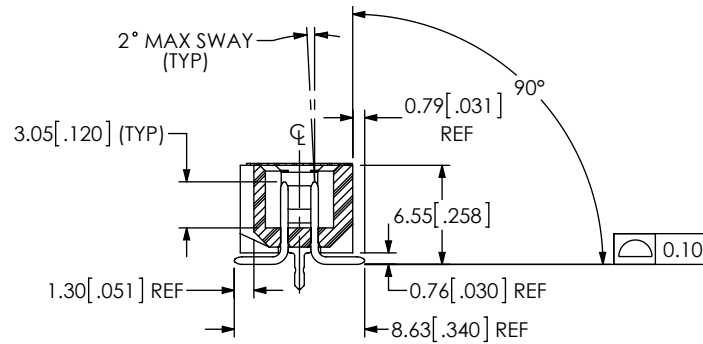
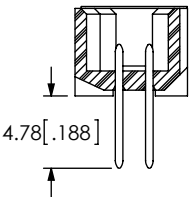

-SM IN PROCESS 1

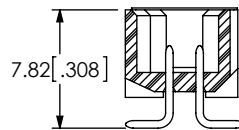

-SM IN PROCESS 2



-SM IN PROCESS 3

FIG 2
T2M-105-01-X-D-RA-XX
(SAME AS FIG 1, EXCEPT AS SHOWN)

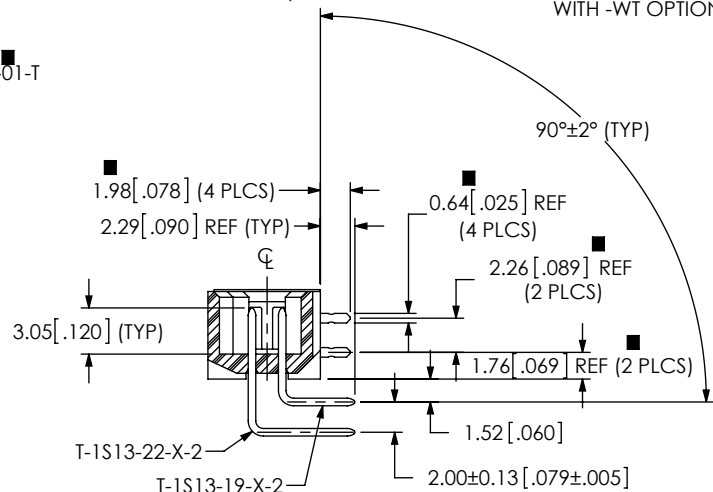
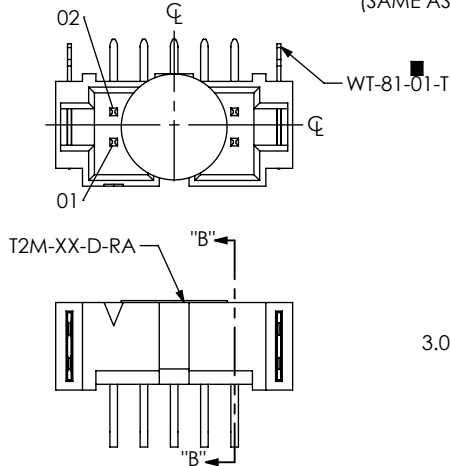
■ = ONLY APPLICABLE
WITH -WT OPTION

SECTION "B"-"B"

F:\DWG\MISC\MKTG\T2M-1XX-XX-X-D-XX-XX-MKT.SLDDRW

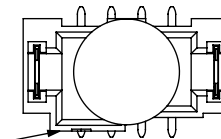

(SEE NOTE 5)

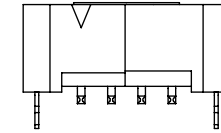
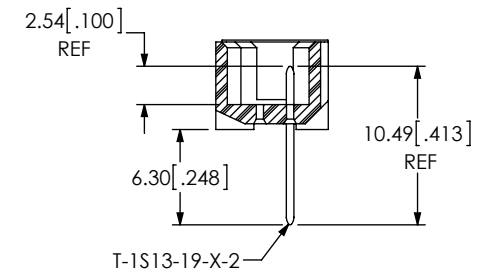
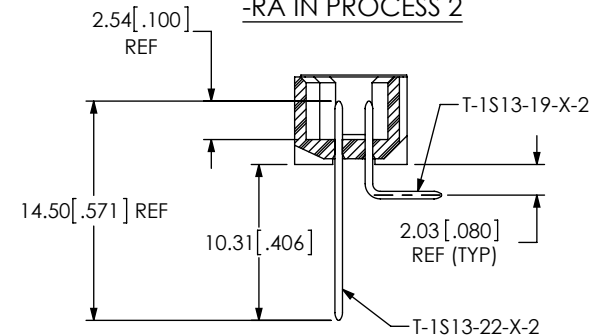

FIG 5
T2M-104-01-X-D-SM-WT
(SAME AS FIG 1, EXCEPT AS SHOWN)
(T2M-102-01-X-D-SM-WT SIMILAR)

-RA IN PROCESS 1



-RA IN PROCESS 2



PROPRIETARY NOTE

THIS DOCUMENT CONTAINS INFORMATION
CONFIDENTIAL AND PROPRIETARY TO
SAMTEC, INC. AND SHALL NOT BE REPRODUCED
OR TRANSFERRED TO OTHER DOCUMENTS OR
DISCLOSED TO OTHERS OR USED FOR ANY
PURPOSE OTHER THAN THAT WHICH IT WAS
OBTAINED WITHOUT THE EXPRESSED WRITTEN
CONSENT OF SAMTEC, INC.

DO NOT SCALE DRAWING

SHEET SCALE: 2:1

samtec

520 PARK EAST BLVD. NEW ALBANY, IN 47150
PHONE: 812-944-6733 FAX: 812-948-5047
e-Mail: info@SAMTEC.com code 55322

DESCRIPTION:

2mm SHROUDED TERMINAL STRIP

DWG. NO.

T2M-1XX-XX-X-D-XX-XX

BY: J. BORGELT

3/23/09

SHEET 2 OF 3

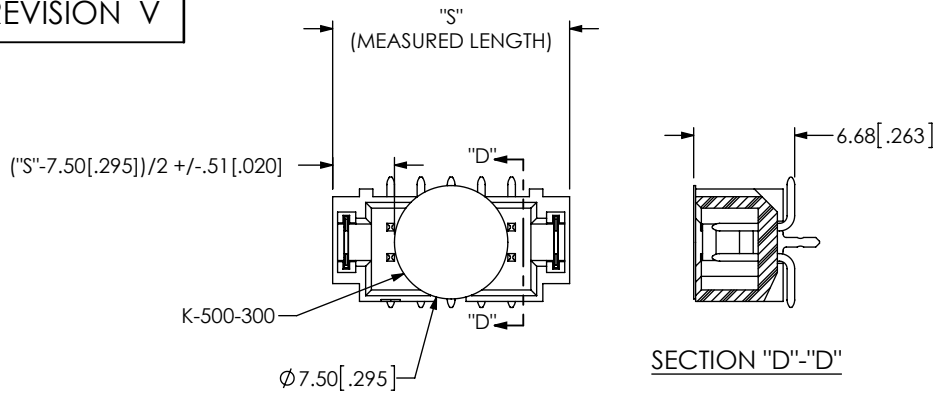
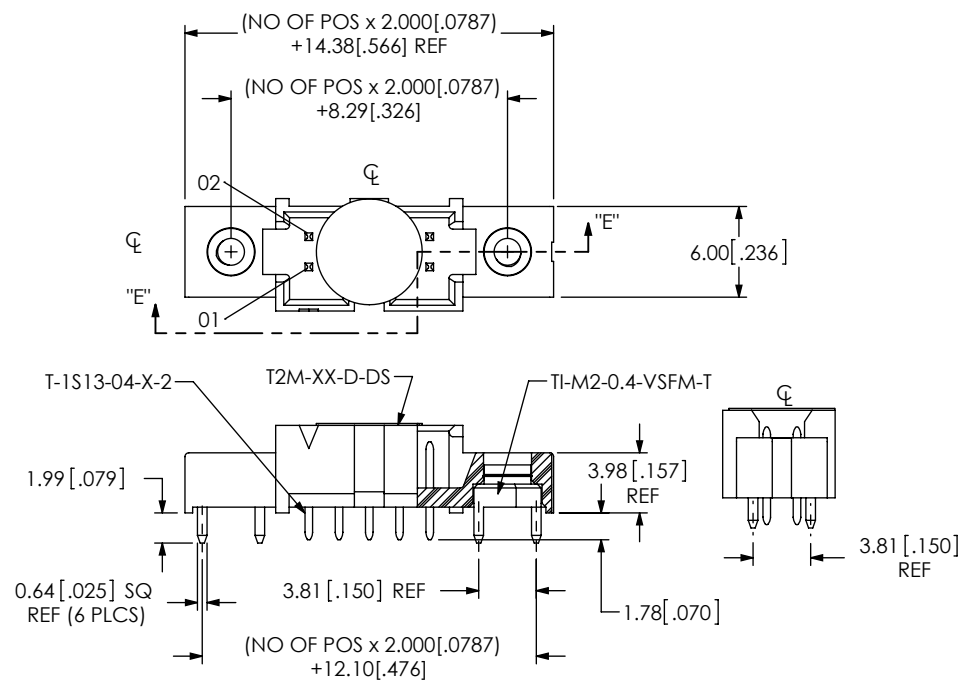

FIG 4
T2M-105-01-X-D-SM-K SHOWN
(FOR SURFACE MOUNT OPTION ONLY)



SECTION "E"-"E"

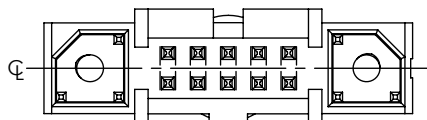

FIG 6
T2M-105-01-X-D-TH-DS SHOWN
(SAME AS FIG 1, EXCEPT AS SHOWN)
(ONLY AVAILABLE WITH -TH & -SM OPTION)

PACKAGING
ALL PARTS ARE LOADED WITH POSITIONS 1
TOWARDS ARROW

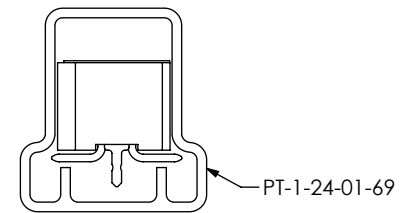
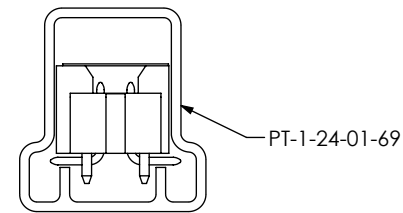
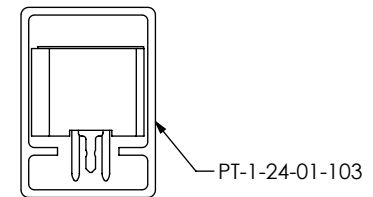
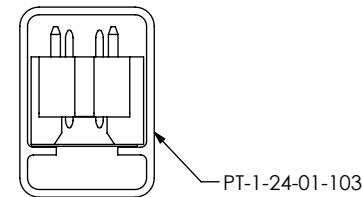
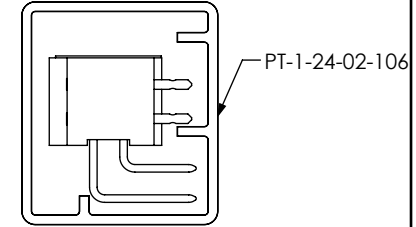

TABLE 1		
OPTIONS	PACKAGING TUBE	PLUG
-TH, -TH-WT	PT-1-24-01-103	TP-09
-SM, -SM-WT	PT-1-24-01-69	TP-09
-RA, -RA-WT	PT-1-24-02-106	TP-07
-TH-DS	PT-1-24-01-103	TP-09
-SM-DS	PT-1-24-01-69	TP-09

PROPRIETARY NOTE

THIS DOCUMENT CONTAINS INFORMATION
CONFIDENTIAL AND PROPRIETARY TO
SAMTEC, INC. AND SHALL NOT BE REPRODUCED
OR TRANSFERRED TO OTHER DOCUMENTS OR
DISCLOSED TO OTHERS OR USED FOR ANY
PURPOSE OTHER THAN THAT WHICH IT WAS
OBTAINED WITHOUT THE EXPRESSED WRITTEN
CONSENT OF SAMTEC, INC.

DO NOT SCALE DRAWING

SHEET SCALE: 2:1

samtec

520 PARK EAST BLVD, NEW ALBANY, IN 47150
PHONE: 812-944-6733 FAX: 812-948-5047
e-Mail: info@SAMTEC.com code 55322

DESCRIPTION:
2mm SHROUDED TERMINAL STRIP
DWG. NO. T2M-1XX-XX-X-D-XX-XX

BY: J. BORGELT 3/23/09 SHEET 3 OF 3