

DO NOT
SCALE FROM
THIS PRINT

DESIGNED & DIMENSIONED
IN MILLIMETERS[INCHES]

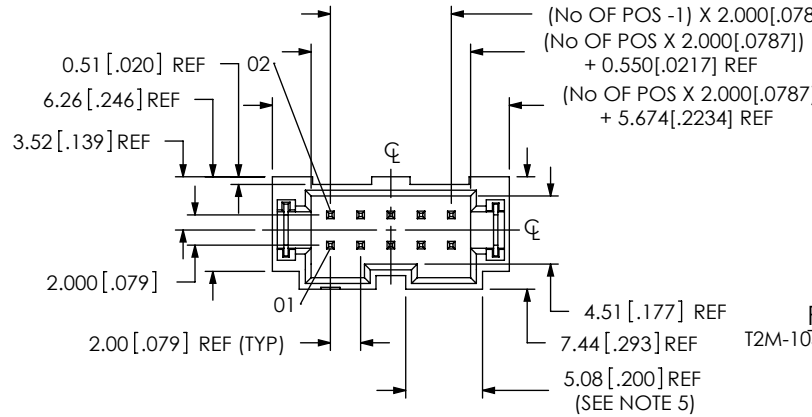
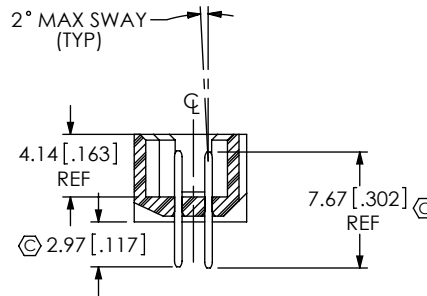

FIG 1
T2M-105-01-XX-D-TH



SECTION "A"-"A"

T2M-1XX-XX-XX-D-XX-XX

NO OF POSITIONS
-05, -07, -10, -15, -20, -25, & -30
(PER ROW) AVAILABLE AS
STANDARD; OTHER SIZES BETWEEN
-05 THRU -50 AVAILABLE AS ASO

LEAD STYLE
-01: 3.05 [.120] POST HEIGHT

PLATING SPECIFICATION
-L: LIGHT SELECTIVE (USE T-1S13-XX-L-2)
-S: SELECTIVE (USE T-1S13-XX-S-2)

ROW SPECIFICATION
-D: DOUBLE ROW

OPTION
-K: POLYIMIDE FILM (-SM OPTION
ONLY)
(USE K-500-300, SEE FIG. 4)
-TR: TAPE & REEL (-SM OPTION ONLY)

OPTION
-TH: THROUGH HOLE (SEE FIG 1, SHEET 1)
-RA: RIGHT ANGLE (SEE FIG 2, SHEET 1)
-SM: SURFACE MOUNT (SEE FIG 3, SHEET 2)
-WT: WELD TAB : (USE WT-25-07-T);
(-SM, SEE FIG 3, SHEET 2)
(-TH, SEE FIG 5, SHEET 2)
-RA: (USE WT-25-05-T)

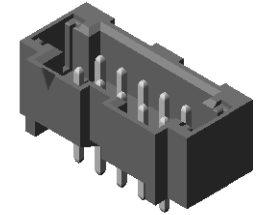

NOTES:

1. Ⓢ REPRESENTS A CRITICAL DIMENSION.
2. MINIMUM PUSHOUT FORCE: 4.44N [1.0 LB].
3. POST HEIGHT VARIATION BETWEEN ANY TWO PINS: 0.13 [.005] MAXIMUM.
4. MAXIMUM PIN ROTATION IN BODY TO BE 2°.
5. DUAL POLARIZATION SLOT NOT AVAILABLE ON CONNECTOR WITH LESS THAN 5 POSITIONS.

FIG 2
T2M-105-01-XX-D-RA-WT
(SAME AS FIG 1, EXCEPT AS SHOWN)

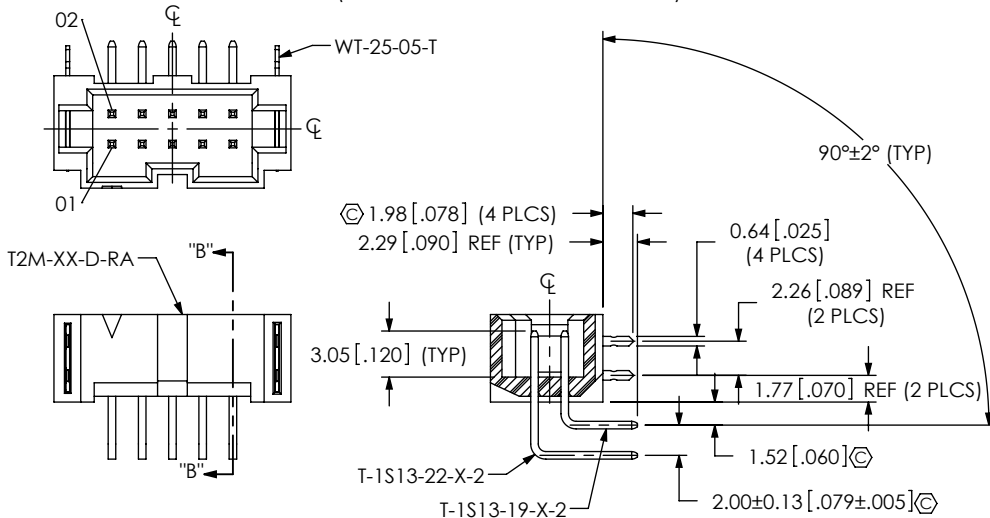

SECTION "B"-"B"

-RA IN PROCESS 1

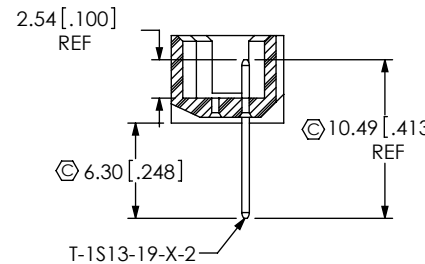

-RA IN PROCESS 2

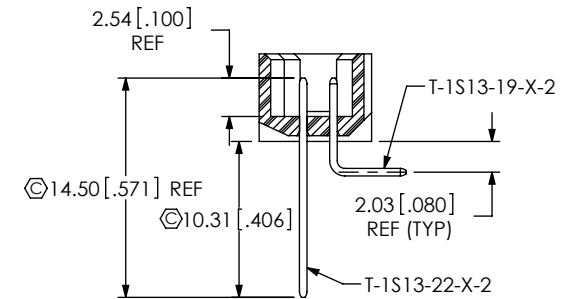

UNLESS OTHERWISE SPECIFIED,
DIMENSIONS ARE IN MILLIMETERS.
TOLERANCES ARE:
DECIMALS ANGLES
X.X: ±0.3 [.01]
X.XX: ±0.13 [.005]
X.XXX: ±0.051 [.0020]

PROPRIETARY NOTE

THIS DOCUMENT CONTAINS INFORMATION
CONFIDENTIAL AND PROPRIETARY TO
SAMTEC, INC. AND SHALL NOT BE REPRODUCED
OR TRANSFERRED TO OTHER DOCUMENTS OR
DISCLOSED TO OTHERS OR USED FOR ANY
PURPOSE OTHER THAN THAT WHICH IT WAS
OBTAINED WITHOUT THE EXPRESSED WRITTEN
CONSENT OF SAMTEC, INC.

MATERIAL: DO NOT SCALE DRAWING
INSULATOR: LCP, COLOR: BLACK
TERMINAL: PHOS BRONZE
WELD TAB: PHOS BRONZE
KAPTON: POLYIMIDE FILM

SHEET SCALE: 2:1

samtec

520 PARK EAST BLVD, NEW ALBANY, IN 47150
PHONE: 812-944-6733 FAX: 812-948-5047
e-Mail: info@SAMTEC.com code 55322

DESCRIPTION:
2mm SHROUDED TERMINAL STRIP

DWG. NO.
T2M-1XX-XX-XX-D-XX-XX

BY: J. BORGELT 3/23/09 SHEET 1 OF 2

REVISION F

2° MAX SWAY
(TYP)

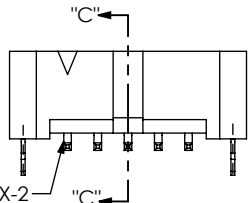
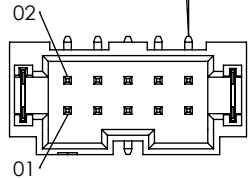
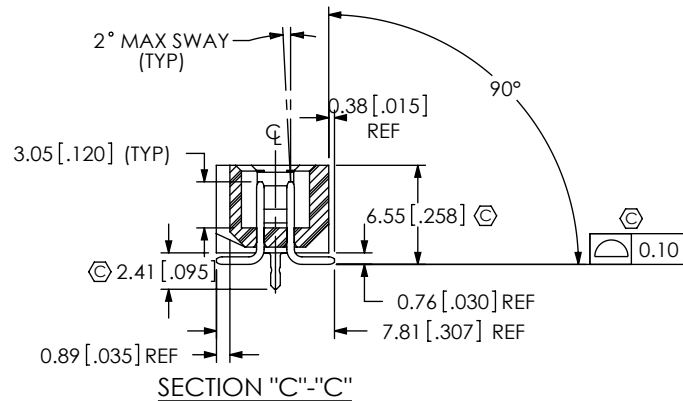
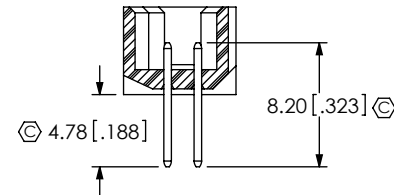

FIG 3
T2M-105-01-XX-D-SM-WT SHOWN
(SAME AS FIG 1, EXCEPT AS SHOWN)



-SM IN PROCESS 1



-SM IN PROCESS 2

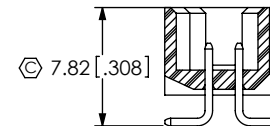
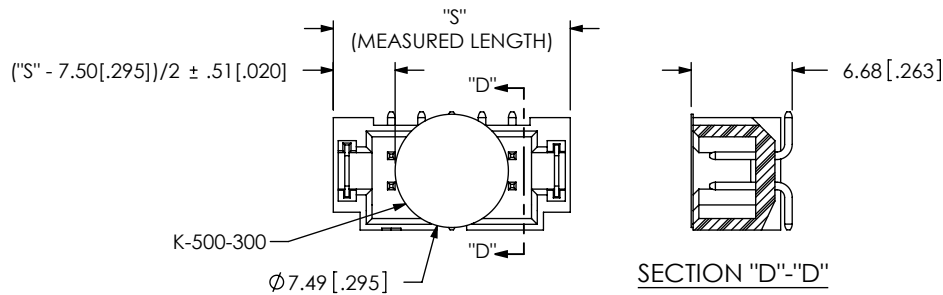
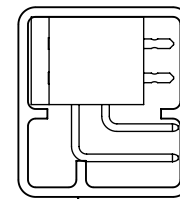

FIG 4
T2M-105-01-XX-D-SM-K SHOWN
(FOR SURFACE MOUNT OPTION ONLY)



PACKAGING
ALL PARTS ARE LOADED WITH POSITIONS 1
TOWARDS ARROW



PT-1-24-01-125

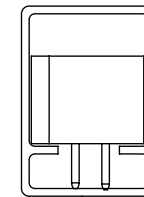

PT-1-24-01-103

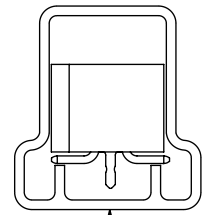

PT-1-24-01-69

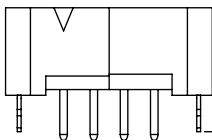
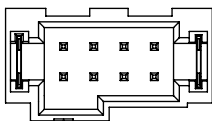

2.41 [.095] ⌀

FIG 5
T2M-104-01-XX-D-TH-WT SHOWN
(SAME AS FIG 1, EXCEPT AS SHOWN)

TABLE 1

OPTIONS	PACKAGING TUBE	PLUG
-TH, -TH-WT	PT-1-24-01-103	TP-09
-SM, -SM-WT	PT-1-24-01-69	TP-09
-RA, -RA-WT	PT-1-24-01-125	TP-09

PROPRIETARY NOTE

THIS DOCUMENT CONTAINS INFORMATION
CONFIDENTIAL AND PROPRIETARY TO
SAMTEC, INC. AND SHALL NOT BE REPRODUCED
OR TRANSFERRED TO OTHER DOCUMENTS OR
DISCLOSED TO OTHERS OR USED FOR ANY
PURPOSE OTHER THAN THAT WHICH IT WAS
OBTAINED WITHOUT THE EXPRESSED WRITTEN
CONSENT OF SAMTEC, INC.

DO NOT SCALE DRAWING

SHEET SCALE: 2:1

samtec

520 PARK EAST BLVD, NEW ALBANY, IN 47150
PHONE: 812-944-6733 FAX: 812-948-5047
e-Mail: info@SAMTEC.com code 55322

DESCRIPTION:

2mm SHROUDED TERMINAL STRIP

DWG. NO.

T2M-1XX-XX-XX-D-XX-XX

BY: J. BORGELT

3/23/09

SHEET 2 OF 2