

HC-HPR-B06-HHWH-1STM20-EM-BK - Housing



1411878

<https://www.phoenixcontact.com/us/products/1411878>

Please be informed that the data shown in this PDF document is generated from our online catalog. Please find the complete data in the user documentation. Our general terms of use for downloads are valid.



HEAVYCON B6 sleeve housing, HPR series, with screw locking, with M20 thread, lateral outlet, for increased environmental and EMC requirements

Your advantages

- Vibration and shock: IEC 61373/EN 50155, category 1, class 1B

Commercial data

Item number	1411878
Packing unit	1 pc
Minimum order quantity	1 pc
Sales key	BF60
Product key	BF7AAI
Catalog page	Page 626 (C-4-2015)
GTIN	4046356944250
Weight per piece (including packing)	497.2 g
Weight per piece (excluding packing)	497.2 g
Customs tariff number	85389099
Country of origin	CN

HC-HPR-B06-HHWH-1STM20-EM-BK - Housing



1411878

<https://www.phoenixcontact.com/us/products/1411878>

Technical data

Notes

General	For contact inserts HC-B6, BB10, DD24, M Tall housings for extra large wiring space
---------	---

Product properties

Product type	Housing with screw locking
Housing type	Sleeve housing
Product family	HC-HPR-B
Series	HPR-B6
Application	Railway applications
Type	B6
No. of cable outlets	1
Type of the screw connection	1x M20
Type	Tall design
Protective cover	no
Cable outlet	lateral
Pg screw connection	none

Data management status

Article revision	01
------------------	----

Dimensions

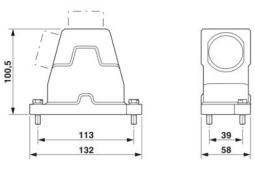
Dimensional drawing	
Width	58 mm
Height	100.5 mm
Length	132 mm

Material specifications

Housing material	Die-cast aluminum
Housing surface material	Powder-coated, black
Locking latch material	Stainless steel

Environmental and real-life conditions

Ambient conditions

Degree of protection	IP66
	IP68 (0.5 bar / 24 h)
	IP69 (ISO 20653:2013-02)

HC-HPR-B06-HHWH-1STM20-EM-BK - Housing



1411878

<https://www.phoenixcontact.com/us/products/1411878>

Impact strength	IK09
Ambient temperature (operation)	-40 °C ... 125 °C

Mechanical properties

Mechanical data

Type of the screw connection	1x M20
Locking type	Screw

Mounting

Assembly note	M6 locking screw, slotted hexagon head screw (SW10), tightening torque: 4 Nm
---------------	---

HC-HPR-B06-HHWH-1STM20-EM-BK - Housing

1411878

<https://www.phoenixcontact.com/us/products/1411878>



Drawings

Dimensional drawing

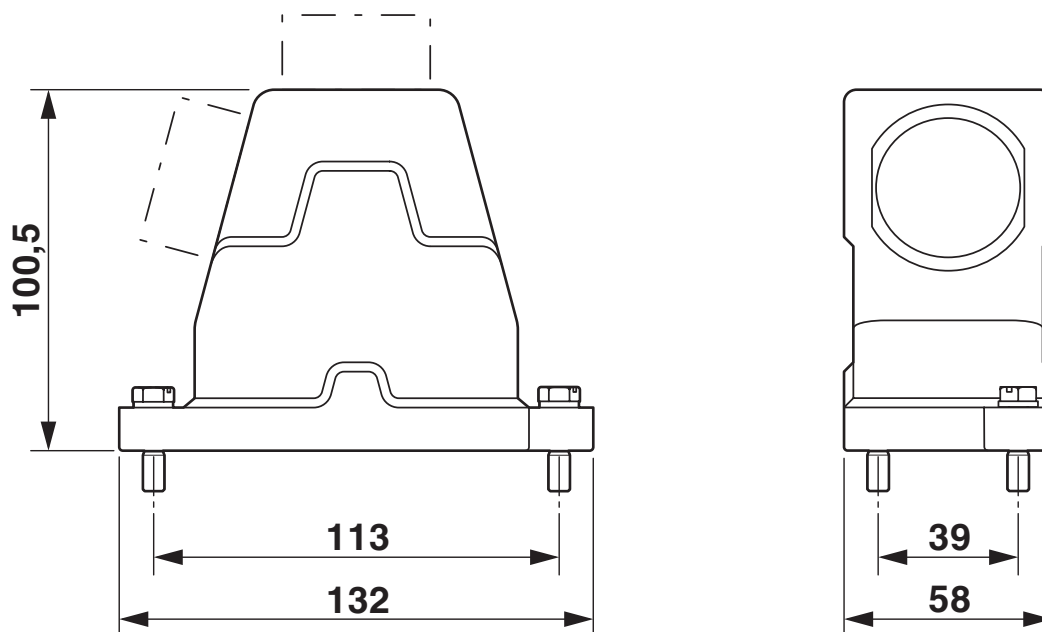

Dimensional drawing

Approvals

To download certificates, visit the product detail page: <https://www.phoenixcontact.com/us/products/1411878>



Approval ID: TAE000037S



Approval ID: RU C-DE.AI30.B.01102



Approval ID: RU C-DE.BL08.B.00511

HC-HPR-B06-HHWH-1STM20-EM-BK - Housing



1411878

<https://www.phoenixcontact.com/us/products/1411878>

Classifications

ECLASS

ECLASS-11.0	27440202
ECLASS-12.0	27440202
ECLASS-13.0	27440202

ETIM

ETIM 9.0	EC000437
----------	----------

UNSPSC

UNSPSC 21.0	31261500
-------------	----------

Environmental product compliance

EU RoHS	
Fulfills EU RoHS substance requirements	Yes, No exemptions
China RoHS	
Environment friendly use period (EFUP)	EFUP-E
	No hazardous substances above the limits
EU REACH SVHC	
REACH candidate substance (CAS No.)	No substance above 0.1 wt%

Phoenix Contact 2024 © - all rights reserved
<https://www.phoenixcontact.com>

Phoenix Contact USA
586 Fulling Mill Road
Middletown, PA 17057, United States
(+717) 944-1300
info@phoenixcon.com