

Actuator

704.075.310



<https://eao.com/p/704.075.310>

Your product:



704.075.310 Actuator

FRONT

Front bezel material:	Aluminium
Front bezel colour:	Black
Front dimension:	Ø 40 mm

MOUNTING

Design:	flush
---------	-------

OPERATING-/INDICATION PART

Lens illumination:	non illuminative
Lens optics:	opaque
Lens shape:	mushroom-head
Lens colour:	Red
Lens material:	Plastic

ELECTRICAL CHARACTERISTICS

Standards:	The switches comply with the "Standards for low-voltage switching devices" DIN EN 60947-1
------------	---

MECHANICAL CHARACTERISTIC

Mechanical lifetime:	≤50 000 cycles of operation
Operating force:	8 N
Weight:	0.048 kg
Operating Travel:	ca. 5.8 mm ± 0.2 mm

Switching action: Maintained

AMBIENT CONDITION

IP Protection: IP65 front side

Storage temperature: $-40\text{ }^{\circ}\text{C} \dots +85\text{ }^{\circ}\text{C}$

Operating temperature: - 40 °C ... + 55 °C

OTHER

Marking: Stop

max. number of switching elements:	3
------------------------------------	---

Short Description: Actuator, Ø 40 mm, mushroom-head, non illuminative, Red, Plastic, opaque, Black, Aluminium, anodised. Maintained

Dimension drawings:

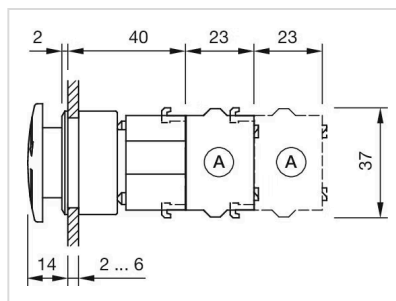

A = Screw terminal

Mounting cut-outs:

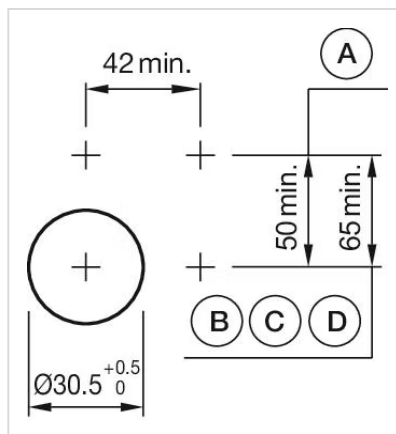

A = Screw terminal
B = Push-in terminal (PIT)
C = Plug-in terminal 6.3 mm x 0.8 mm
D = Double plug-in terminal 6.3 mm x 0.8 mm

Wiring diagrams:



Mouser Electronics

Authorized Distributor

Click to View Pricing, Inventory, Delivery & Lifecycle Information:

[EAO:](#)

[704.075.310](#)