

PRODUCT NUMBER
98401-XXX-XXLF

RoHS COMPATIBLE, SEE NOTE 7
TOTAL NB OF POSITIONS, 6 TO 54
PACKAGING TYPE, NOTE 3

PLATING

- 1 = 0.76µm GOLD/GXT ON CONTACT AREA, 2µm TIN MIN ON TAILS
4 = 2.0µm TIN MIN FULL PLATED
5 = 0.25µm GOLD/GXT ON CONTACT AREA, 2µm TIN MIN ON TAILS
8 = 0.38µm GOLD/GXT ON CONTACT AREA, 2µm TIN MIN ON TAILS
1.27µm NICKEL MIN UNDERLAYER FOR ALL PLATING VERSIONS

PIN STYLE	MATING	DIM"A"	OAH
01	5.84	9.6	10.2
02	8.08	11.8	12.4
03	13.00	16.8	17.4
06	10.50	14.3	14.9
07	14.50	18.3	18.9
08	7.30	11.1	11.7

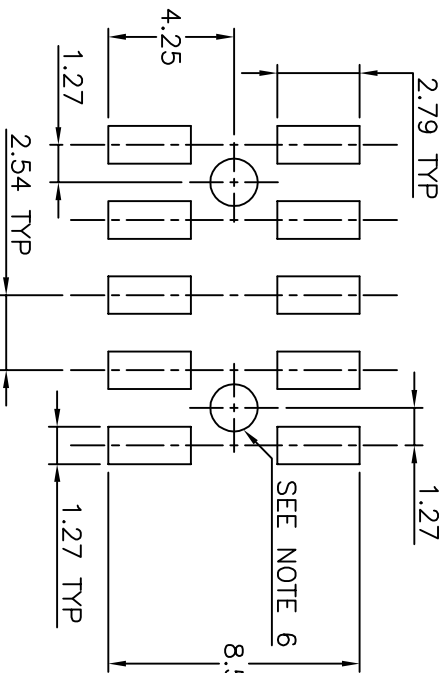
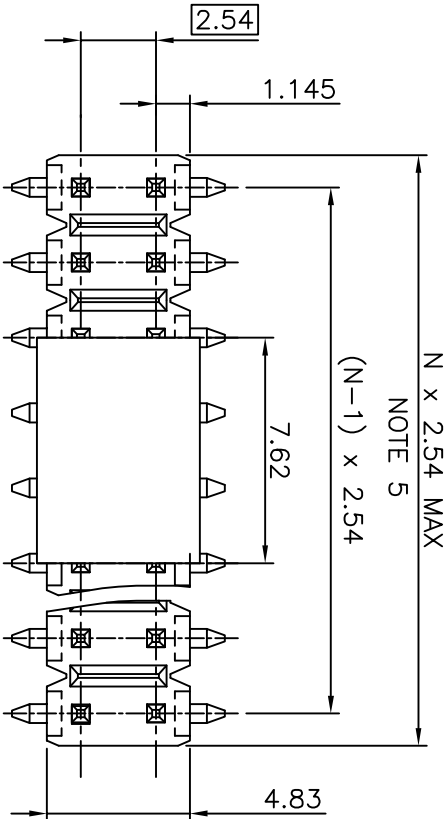

RECOMMENDED PAD LAYOUT

NOTES:

1. HOUSING MAT'L : HIGH TEMPERATURE THERMOPLASTIC. UL94V-0 COLOR: BLACK
2. PIN MATERIAL : PHOSPHOR BRONZE
3. PACKAGING :

- = POLY BAGS
A = TAPE & REEL WITH PICK UP CAP, AS AVAILABLE
AV = TAPE & REEL WITH PICK UP CAP FOR CUSTOMER DEDICATED PART
TV = TUBE WITHOUT PICK UP CAP FOR CUSTOMER DEDICATED PART
K = TAPE & REEL WITHOUT PICK-UP CAP, AS AVAILABLE.

4. 9N MIN RETENTION IN EITHER DIRECTION
5. TO DETERMINE DIMENSIONS :
N = NUMBER OF POSITIONS PER ROW
EXAMPLE : 8 POS N x 2.54 = 20.32mm
6. HOLE DIMENSION TO BE $\phi 1.6 \pm 0.03$ FOR INTERFERENCE FIT APPLICATIONS.
HOLE DIMENSIONS TO BE $\phi 1.95 \pm 0.05$ FOR LOCATION APPLICATION WITH AUTOMATIC PICK AND PLACE MACHINES.

7. RoHS COMPATIBLE PRODUCT SPECIFICATIONS

a - PLATING:

- "LF" MEANS THE PRODUCT IS LEAD-FREE, 2µm MINIMUM MATTE TIN OVER 1.27µm MINIMUM NICKEL UNDERPLATE.

b - MANUFACTURING PROCESS COMPATIBILITY

- THE HOUSING WILL WITHSTAND EXPOSURE TO 260°C PEAK TEMPERATURE FOR 30 SECONDES IN A CONVECTION, INFRA-RED OR VAPOR PHASE REFLOW OVEN.

c - LABELING:

- MEETS PACKAGING SPECS AS PER GS-14-920

d - LEGAL STATEMENT: SEE GS-47-0004

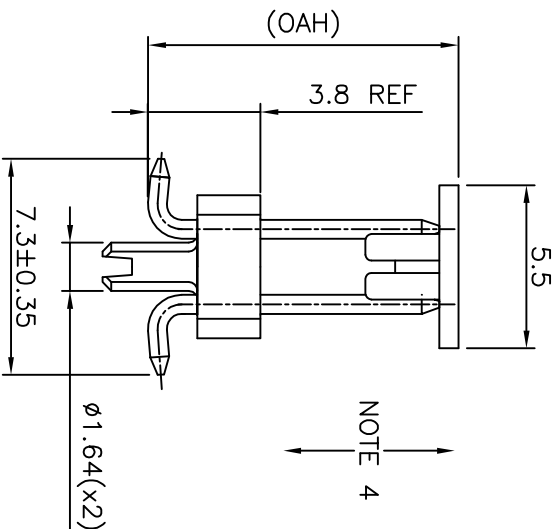
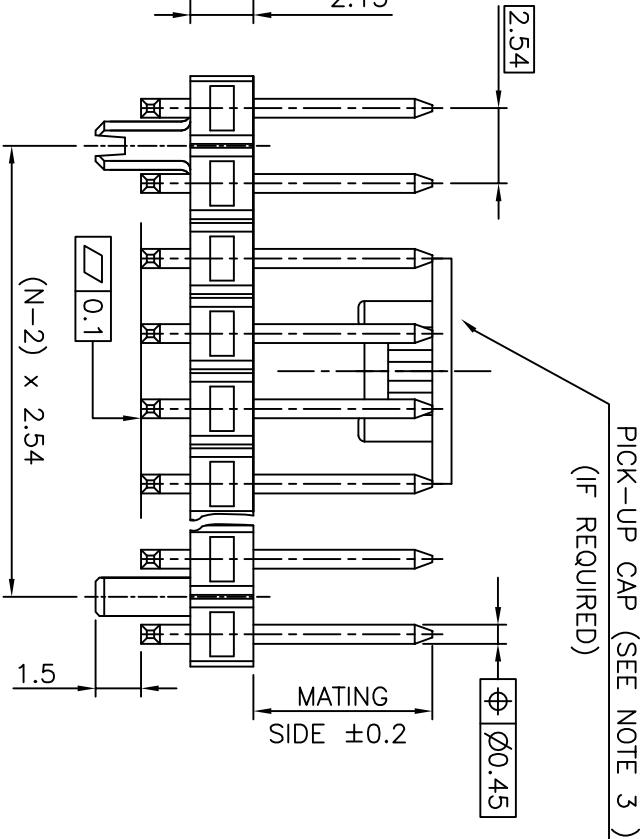
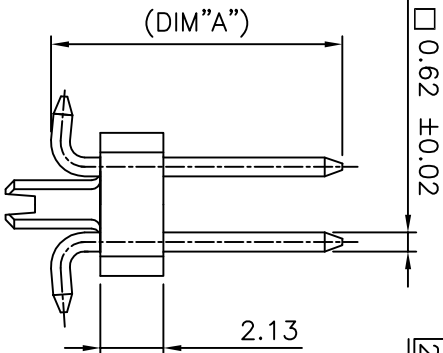

mat'l. code				surface		tolerance		projection		product family	
SEE NOTES				ISO 1302	ISO 1302	ISO 406	ISO 1101	mm	mm	BERGSTIK	
lfr	ecn no	dr	date	tolerances unless otherwise specified	angles	linear	x.x ± 0.3	mm	mm	UNSHR.HEADER DR SMT	
Y	F-25055	JDA	16.09.28				x.x ± 0.3				
T	B-19704	BVE	14.12.11				x.xxx ± 0.05				
U	F-21501	AMA	15.07.23	dr		D.LE	01.01.24				
V	F-23055	AMA	16.01.15	engr		JM.C	01.01.24			98401	
W	F-23416	JUJ	02.03.16	chr		JM.C	01.01.24				
X	F-24422	AMA	16.06.30	dppd		JF.N	01.01.24				
sheet index	revision	sheet								type	CUSTOMER
										Drawing	



FCIconnect.com

Copyright FCI

form: A3

Mouser Electronics

Authorized Distributor

Click to View Pricing, Inventory, Delivery & Lifecycle Information:

[FCI / Amphenol:](#)

[98401-107A12LF](#) [98401-801A50LF](#) [98401-507-12LF](#) [98401-501A30LF](#) [98401-107A08LF](#) [98401-507A12LF](#)