

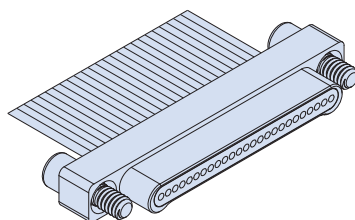

SERIES 89 Single Row Connectors



Plug and Receptacle Connectors with Insulated Wire How to Order



Glenair Insulated Wire Nano Connectors feature gold alloy TwistPin contacts. Contacts are precision-crimped to insulated, stranded wire. These nanominiature connectors offer premium performance and reliability for demanding applications, available in 8 arrangements. Contact spacing is .025 inches. 1 amp current rating, DWV rating 250 volts AC. Wire gages #30 and #32 AWG.

TwistPin Contact System assures premium performance in demanding environments. The gold/platinum alloy contacts will stand up to years of exposure without corrosion.

Typical Applications include UAV's, satellites, missile systems and geophysical instruments.

How To Order

Sample Part Number		890-002	-25S	A2	-0	B	7	-12	T
Series	890-001 = Plug, Pin Contacts, Single Row Nanominiature 890-002 = Receptacle, Socket Contacts, Single Row Nanominiature								
Insert Arrangement/ Contact Type	Plugs (890-001): 5P, 9P, 15P, 21P, 25P, 31P, 37P, 51P Receptacles (890-002): 5S, 9S, 15S, 21S, 25S, 31S, 37S, 51S								
Shell Material and Finish	A1 = Aluminum Shell, Cadmium Plating A2 = Aluminum Shell, Electroless Nickel Plating S = Stainless Steel Shell, Passivated T = Titanium Shell, Unplated								
Wire Gage	0 = #30 AWG 2 = #32 AWG								
Wire Type	A = Ultra Lightweight XLETFE Insulation, Silver Coated Ultra High Strength Copper. (Not available in #32 AWG) B = Extruded PTFE Insulation, Silver Coated Copper NEMA HP3-ETX (MIL-W-16878/6) C = Cross Linked Modified ETFE Insulation, Silver Coated High Strength Copper. MIL-W-22759/33 (Not available in #32 AWG)								
Wire Color Code	1 = White 2 = Yellow 7 = 10 Color Repeating (wire type A is striped, types B and C are solid colors)								
Wire Length	12 = 12.00 + 1.00 Inches; as required in one inch increments.								
Hardware	J = Hex Head Jackscrew, #0-80 UNF-2A T = Female Thread, #0-80 UNF-2B Female threads are available on plug connectors only if the shell material is titanium or stainless steel.								

Plug (Pin) Connector

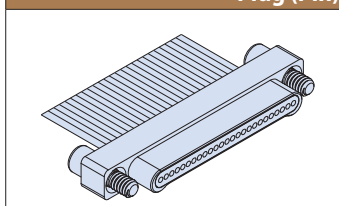

J - Jackscrew Option

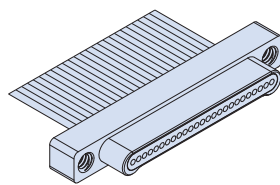

T - Female Thread Option

Receptacle (Socket) Connector

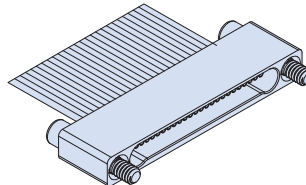

J - Jackscrew Option

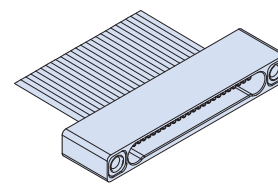

T - Female Thread Option

NOTES

- Material and finish:
 - Shell: see part number breakdown
 - Insulator: LCP N/A
 - Contacts: Gold alloy per ASTM B477 and ASTM B541
 - Wire: see part number breakdown
 - Hardware: stainless steel, passivated
- Inspect and Test IAW MIL-DTL-32139
- Interface dimensions per MIL-DTL-32139/1 & MIL-DTL-32139/2

Dimensions						
890-001 Plug (Pin) Connector			890-002 Receptacle (Socket) Connector			
Layout	A		B BSC.		C BSC.	
	In.	mm.	In.	mm.	In.	mm.
5P	.400	10.16	.295	7.49	.184	4.67
5S	.400	10.16	.295	7.49	.185	4.70
9P	.500	12.70	.395	10.03	.284	7.21
9S	.500	12.70	.395	10.03	.285	7.24
15P	.650	16.51	.545	13.84	.434	11.02
15S	.650	16.51	.545	13.84	.435	11.05
21P	.800	20.32	.695	17.65	.584	14.83
21S	.800	20.32	.695	17.65	.585	14.86
25P	.900	22.86	.795	20.19	.684	17.37
25S	.900	22.86	.795	20.19	.685	17.40
31P	1.050	26.67	.945	24.00	.834	21.18
31S	1.050	26.67	.945	24.00	.835	21.21
37P	1.200	30.48	1.095	27.81	.984	24.99
37S	1.200	30.48	1.095	27.81	.985	25.02
51P	1.550	39.37	1.445	36.70	1.334	33.88
51S	1.550	39.37	1.445	36.70	1.335	33.91

Mouser Electronics

Authorized Distributor

Click to View Pricing, Inventory, Delivery & Lifecycle Information:

Glenair:

[890002-15SA2-0B7-18J](#) [890-001-5PA2-0B7-12J](#) [890-002-25SA2-0C7-10T](#) [890-002-9SA2-0C7-6J-566](#) [890-001-9PA2-0B7-14J](#) [890-001-9PA2-0B7-10J](#) [890-002-15SA2-0B7-18J](#) [890-001-9PA2-0C7-5J-566A](#) [890-001-9PA2-0B7-12J](#)
[890-002-9SA2-0B7-12J](#) [890-002-9SA2-0B7-12T](#)