

# HC-HPR-B16-HHWH-1STM32-EM-BK - Housing



1411058

<https://www.phoenixcontact.com/us/products/1411058>

Please be informed that the data shown in this PDF document is generated from our online catalog. Please find the complete data in the user documentation. Our general terms of use for downloads are valid.



HEAVYCON B16 sleeve housing, HPR series, with screw locking, with M32 thread, lateral outlet, for increased environmental and EMC requirements

## Your advantages

- Vibration and shock: IEC 61373/EN 50155, category 1, class 1B

## Commercial data

|                                      |                     |
|--------------------------------------|---------------------|
| Item number                          | 1411058             |
| Packing unit                         | 1 pc                |
| Minimum order quantity               | 1 pc                |
| Sales key                            | BF60                |
| Product key                          | BF7AAI              |
| Catalog page                         | Page 628 (C-4-2015) |
| GTIN                                 | 4046356921596       |
| Weight per piece (including packing) | 639.6 g             |
| Weight per piece (excluding packing) | 626.28 g            |
| Customs tariff number                | 85389099            |
| Country of origin                    | CN                  |

1411058

<https://www.phoenixcontact.com/us/products/1411058>

Technical data

Notes

|         |   |
|---------|---|
| General | For contact inserts HC-B16, BB32, BBB40, D40, DD72, HS6, M, K |
|---------|---|

Product properties

|                              |                            |
|------------------------------|----------------------------|
| Product type                 | Housing with screw locking |
| Housing type                 | Sleeve housing             |
| Product family               | HC-HPR-B                   |
| Series                       | HPR-B16                    |
| Application                  | Railway applications       |
| Type                         | B16                        |
| No. of cable outlets         | 1                          |
| Type of the screw connection | 1x M32                     |
| Type                         | Tall design                |
| Protective cover             | no                         |
| Cable outlet                 | lateral                    |
| Pg screw connection          | none                       |

Data management status

|                  |    |
|------------------|----|
| Article revision | 01 |
|------------------|----|

Dimensions

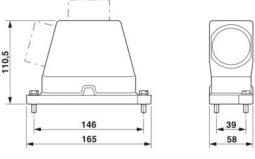
|                     |  |
|---------------------|--|
| Dimensional drawing |  |
| Width               | 59.2 mm  |
| Height              | 110.5 mm   |
| Length              | 166.2 mm   |

Material specifications

|                           |                      |
|---------------------------|----------------------|
| Material Protective cover | Die-cast aluminum    |
| Housing material          | Die-cast aluminum    |
| Housing surface material  | Powder-coated, black |
| Material of locking screw | Stainless steel      |

Environmental and real-life conditions

Ambient conditions

|                      |                       |
|----------------------|-----------------------|
| Degree of protection | IP66                  |
|                      | IP68 (0.5 bar / 24 h) |

# HC-HPR-B16-HHWH-1STM32-EM-BK - Housing



1411058

<https://www.phoenixcontact.com/us/products/1411058>

|                                 |                          |
|---------------------------------|--------------------------|
|                                 | IP69 (ISO 20653:2013-02) |
| Impact strength                 | IK09                     |
| Ambient temperature (operation) | -40 °C ... 125 °C        |

## Mechanical properties

### Mechanical data

|                              |        |
|------------------------------|--------|
| Type of the screw connection | 1x M32 |
| Locking type                 | Screw  |

## Mounting

|               |   |
|---------------|---|
| Assembly note | M6 locking screw, slotted hexagon head screw (SW10),<br>tightening torque: 4 Nm |
|---------------|---|

# HC-HPR-B16-HHWH-1STM32-EM-BK - Housing

1411058

<https://www.phoenixcontact.com/us/products/1411058>



## Drawings

Dimensional drawing

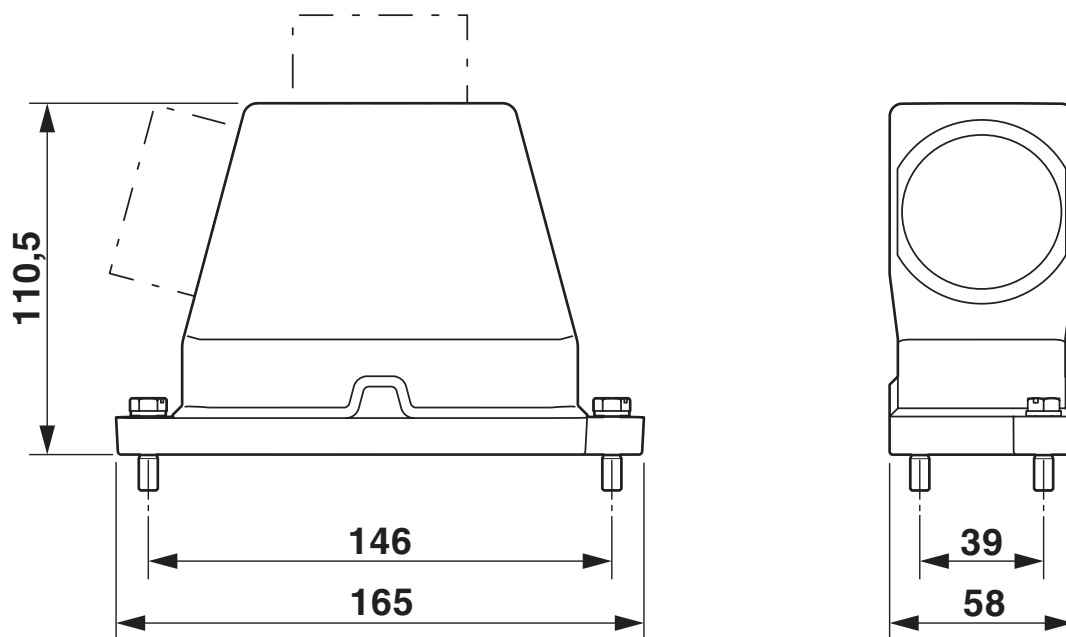

Dimensional drawing

1411058

<https://www.phoenixcontact.com/us/products/1411058>

## Approvals

🔗 To download certificates, visit the product detail page: <https://www.phoenixcontact.com/us/products/1411058>

### DNV

Approval ID: TAE000037S



### EAC

Approval ID: RU C-DE.AI30.B.01102



### EAC

Approval ID: RU C-DE.BL08.B.00511

# HC-HPR-B16-HHWH-1STM32-EM-BK - Housing



1411058

<https://www.phoenixcontact.com/us/products/1411058>

## Classifications

### ECLASS

|             |          |
|-------------|----------|
| ECLASS-11.0 | 27440202 |
| ECLASS-12.0 | 27440202 |
| ECLASS-13.0 | 27440202 |

### ETIM

|          |          |
|----------|----------|
| ETIM 9.0 | EC000437 |
|----------|----------|

### UNSPSC

|             |          |
|-------------|----------|
| UNSPSC 21.0 | 31261500 |
|-------------|----------|

Environmental product compliance

|   |  |
|---|--|
| EU RoHS                                 |  |
| Fulfills EU RoHS substance requirements | Yes, No exemptions                       |
| China RoHS                              |  |
| Environment friendly use period (EFUP)  | EFUP-E                                   |
|   | No hazardous substances above the limits |
| EU REACH SVHC                           |  |
| REACH candidate substance (CAS No.)     | No substance above 0.1 wt%               |