

# IPD W 3P2,5 F M25 BK - Panel feed-through



1088684

<https://www.phoenixcontact.com/us/products/1088684>

Please be informed that the data shown in this PDF document is generated from our online catalog. Please find the complete data in the user documentation. Our general terms of use for downloads are valid.



Panel feed-through, for connectors, product family: IPD, connection method: Push-in connection, number of positions: 2+PE, M25, Socket, 0.5 mm<sup>2</sup> ... 2.5 mm<sup>2</sup>, 500 V, 20 A, PA, black, coding: P

## Your advantages

- Easy distribution of power, as components are plugged directly
- Simple, time-saving wiring in the field with Push-Lock connection
- Reliable installation in harsh environments with IP66, IP68, and IP69K throughout the entire system
- Secure, tool-free locking even in particularly difficult installation situations
- Fast commissioning with preassembled cable assemblies

## Commercial data

Item number	1088684
Packing unit	1 pc
Minimum order quantity	1 pc
Sales key	BF51
Product key	BF6LAA
GTIN	4055626890999
Weight per piece (including packing)	37.5 g
Weight per piece (excluding packing)	37.5 g
Customs tariff number	85366990
Country of origin	CN

# IPD W 3P2,5 F M25 BK - Panel feed-through



1088684

<https://www.phoenixcontact.com/us/products/1088684>

## Technical data

### Product properties

Product type	Panel feed-through
Product family	IPD
Number of positions	3
Connection profile	2+PE
Position marking	L, N, PE
Number of connections per position	1
Type	for connectors
Coding	P

### Data management status

Article revision	03
------------------	----

### Insulation characteristics

Overvoltage category	III
Degree of pollution	3

### Connection data

#### Connection technology

Connection method On the device side	Push-in connection
--------------------------------------	--------------------

#### Conductor connection

Conductor cross section flexibel	0.5 mm <sup>2</sup> ... 2.5 mm <sup>2</sup>
Conductor cross section solid	0.5 mm <sup>2</sup> ... 2.5 mm <sup>2</sup>
Conductor cross section with ferrule	0.5 mm <sup>2</sup> ... 2.5 mm <sup>2</sup>
Connection cross section AWG	20 ... 14

### Dimensions

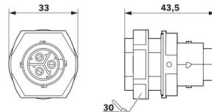
Dimensional drawing	
Width	33 mm
Height	33 mm
Length	43.5 mm

### Electrical properties

Rated surge voltage (III/3)	6 kV
Rated current	20 A
Rated voltage (III/3)	500 V
Nominal voltage U <sub>N</sub>	500 V AC 500 V DC

# IPD W 3P2,5 F M25 BK - Panel feed-through



1088684

<https://www.phoenixcontact.com/us/products/1088684>

Nominal current $I_N$	20 A
-----------------------	------

## Mechanical properties

### Mechanical data

Insertion/withdrawal cycles	50 (IP66/IP68/IP69K)
	100 (IP66)

## Material specifications

Color (Housing)	black (RAL 9005)
Material Housing	PA
Material Seal	EPDM
Flammability rating according to UL 94	V0
Contact material	Cu
Contact surface material	Ni/Ag/Sn

## Cable/line

Position marking	L, N, PE
------------------	----------

## Mounting

Mounting type	M25
---------------	-----

## Environmental and real-life conditions

### Ambient conditions

Degree of protection	IP66
	IP68 (2 m / 24 h)
	IP69K
	Touch-proof when not plugged in (IP2X)
Impact strength	IK07
Ambient temperature (operation)	-30 °C ... 100 °C
Temperature when conductor connected	-5 °C ... 50 °C
Ambient temperature (storage/transport)	-30 °C ... 100 °C
Resistance to UV radiation	yes

## Drawings

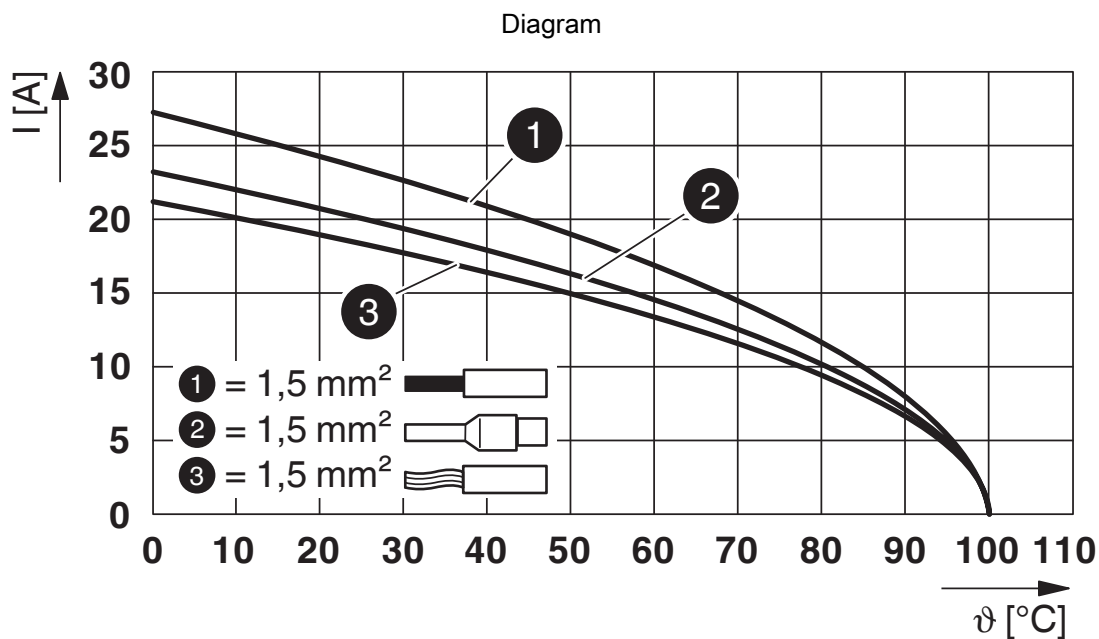

Derating diagram for 1.5 mm<sup>2</sup>

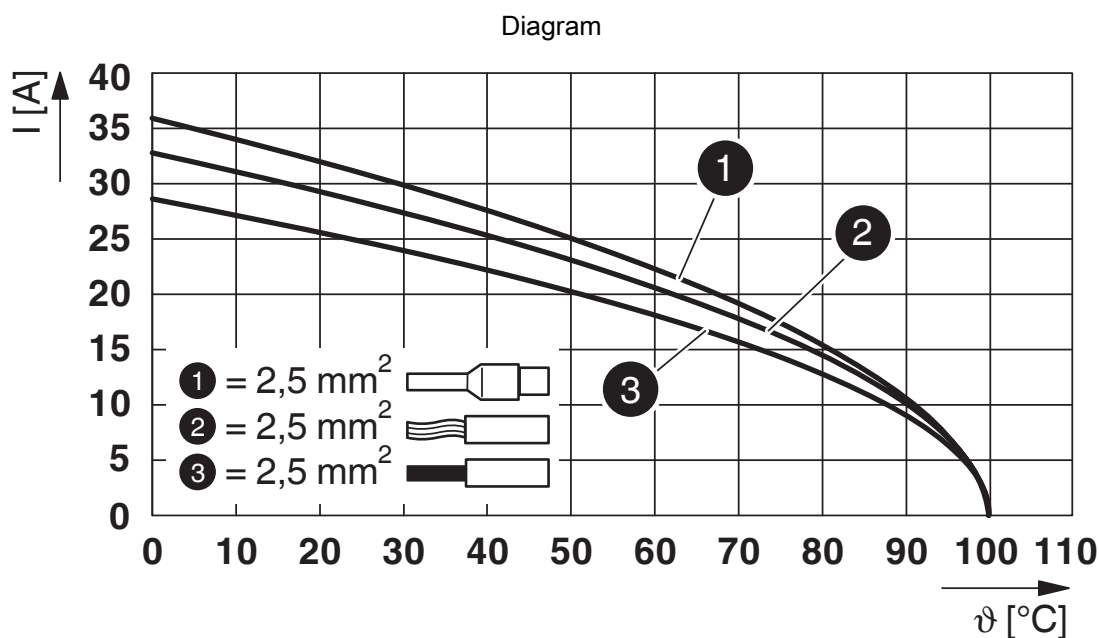

Derating diagram for 2.5 mm<sup>2</sup>

# IPD W 3P2,5 F M25 BK - Panel feed-through

1088684

<https://www.phoenixcontact.com/us/products/1088684>

Dimensional drawing

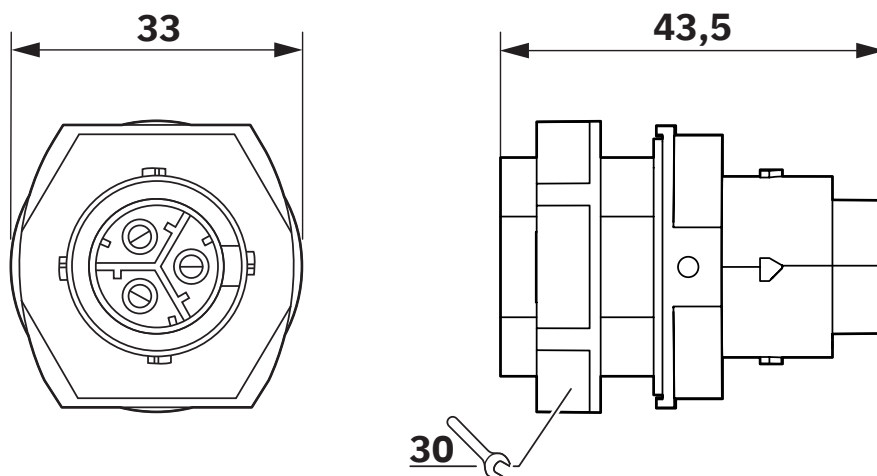

Diagram

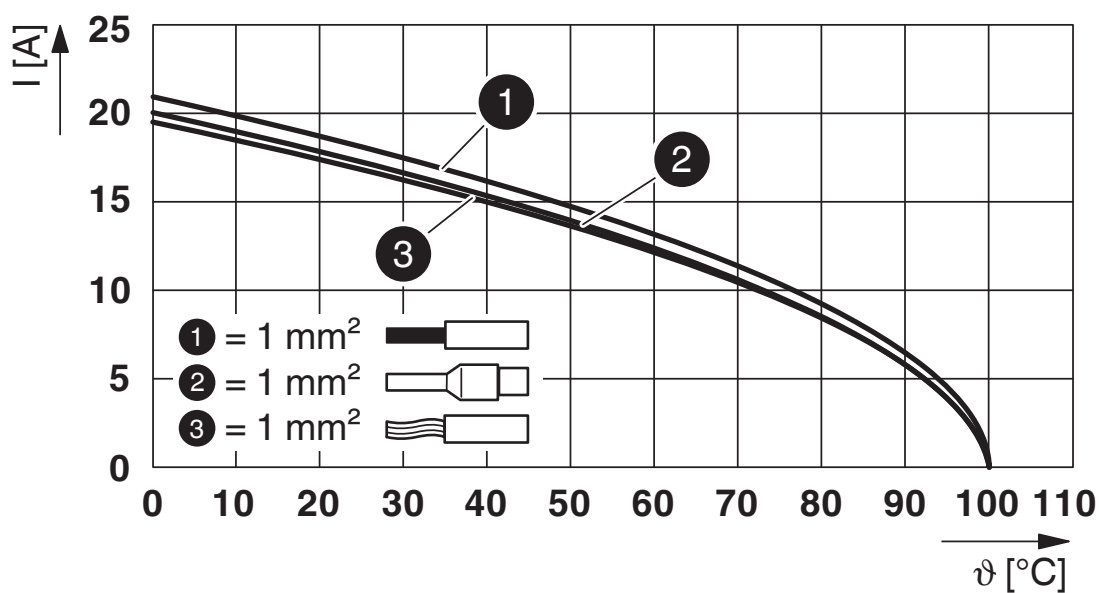

Derating diagram for 1.0 mm<sup>2</sup>

# IPD W 3P2,5 F M25 BK - Panel feed-through



1088684

<https://www.phoenixcontact.com/us/products/1088684>

## Classifications

### ECLASS

ECLASS-11.0	27440602
ECLASS-12.0	27440602
ECLASS-13.0	27440602

### ETIM

ETIM 9.0	EC002566
----------	----------

### UNSPSC

UNSPSC 21.0	39121500
-------------	----------

# IPD W 3P2,5 F M25 BK - Panel feed-through



1088684

<https://www.phoenixcontact.com/us/products/1088684>

## Environmental product compliance

EU RoHS	
Fulfills EU RoHS substance requirements	Yes, No exemptions
China RoHS	
Environment friendly use period (EFUP)	EFUP-E
	No hazardous substances above the limits
EU REACH SVHC	
REACH candidate substance (CAS No.)	No substance above 0.1 wt%

# IPD W 3P2,5 F M25 BK - Panel feed-through



1088684

<https://www.phoenixcontact.com/us/products/1088684>

## Mandatory accessories

### IPD PL 3P2,5 M BK - Connector

1088664

<https://www.phoenixcontact.com/us/products/1088664>



Connector, product family: IPD, connection method: Push-lock connection, number of positions: 2+PE, Pin, 0.5 mm<sup>2</sup> ... 2.5 mm<sup>2</sup>, 500 V, 20 A, PA, black, coding: P, external cable diameter: 6 mm ... 9 mm and 8 mm ... 13 mm

---

### IPD PL 3P2,5 M A0,5 PVC GY - Connecting cable

1526861

<https://www.phoenixcontact.com/us/products/1526861>



Connecting cable, product family: IPD/ Push-lock connection, number of positions: 2+PE, Pin, 0.5 mm<sup>2</sup> ... 2.5 mm<sup>2</sup>, 450 V, 16 A, PA, light gray, coding: P, 2.5 mm<sup>2</sup>, cable length: 0.5 m, Male straight, on free cable end



# IPD W 3P2,5 F M25 BK - Panel feed-through



1088684

<https://www.phoenixcontact.com/us/products/1088684>

## IPD PL 3P2,5 M A1,0 PVC GY - Connecting cable

1526862

<https://www.phoenixcontact.com/us/products/1526862>



Connecting cable, product family: IPD/ Push-lock connection, number of positions: 2+PE, Pin, 0.5 mm<sup>2</sup> ... 2.5 mm<sup>2</sup>, 450 V, 16 A, PA, light gray, coding: P, 2.5 mm<sup>2</sup>, cable length: 1 m, Male straight, on free cable end

---

## IPD PL 3P2,5 M A3,0 PVC GY - Connecting cable

1526863

<https://www.phoenixcontact.com/us/products/1526863>



Connecting cable, product family: IPD/ Push-lock connection, number of positions: 2+PE, Pin, 0.5 mm<sup>2</sup> ... 2.5 mm<sup>2</sup>, 450 V, 16 A, PA, light gray, coding: P, 2.5 mm<sup>2</sup>, cable length: 3 m, Male straight, on free cable end

# IPD W 3P2,5 F M25 BK - Panel feed-through



1088684

<https://www.phoenixcontact.com/us/products/1088684>

## IPD PL 3P2,5 M A5,0 PVC GY - Connecting cable

1526864

<https://www.phoenixcontact.com/us/products/1526864>



Connecting cable, product family: IPD/ Push-lock connection, number of positions: 2+PE, Pin, 0.5 mm<sup>2</sup> ... 2.5 mm<sup>2</sup>, 450 V, 16 A, PA, light gray, coding: P, 2.5 mm<sup>2</sup>, cable length: 5 m, Male straight, on free cable end

---

## IPD PL 3P2,5 M A0,5 F PVC GY - Connecting cable

1526872

<https://www.phoenixcontact.com/us/products/1526872>



Connecting cable, product family: IPD/ Push-lock connection, number of positions: 2+PE, Socket/pin, 0.5 mm<sup>2</sup> ... 2.5 mm<sup>2</sup>, 450 V, 16 A, PA, light gray, coding: P, 2.5 mm<sup>2</sup>, cable length: 0.5 m, Male straight, on Socket straight

# IPD W 3P2,5 F M25 BK - Panel feed-through



1088684

<https://www.phoenixcontact.com/us/products/1088684>

## IPD PL 3P2,5 M A1,0 F PVC GY - Connecting cable

1526873

<https://www.phoenixcontact.com/us/products/1526873>



Connecting cable, product family: IPD/ Push-lock connection, number of positions: 2+PE, Socket/pin, 0.5 mm<sup>2</sup> ... 2.5 mm<sup>2</sup>, 450 V, 16 A, PA, light gray, coding: P, 2.5 mm<sup>2</sup>, cable length: 1 m, Male straight, on Socket straight

---

## IPD PL 3P2,5 M A3,0 F PVC GY - Connecting cable

1526874

<https://www.phoenixcontact.com/us/products/1526874>



Connecting cable, product family: IPD/ Push-lock connection, number of positions: 2+PE, Socket/pin, 0.5 mm<sup>2</sup> ... 2.5 mm<sup>2</sup>, 450 V, 16 A, PA, light gray, coding: P, 2.5 mm<sup>2</sup>, cable length: 3 m, Male straight, on Socket straight

# IPD W 3P2,5 F M25 BK - Panel feed-through

1088684

<https://www.phoenixcontact.com/us/products/1088684>



## IPD PL 3P2,5 M A5,0 F PVC GY - Connecting cable

1526875

<https://www.phoenixcontact.com/us/products/1526875>



Connecting cable, product family: IPD/ Push-lock connection, number of positions: 2+PE, Socket/pin, 0.5 mm<sup>2</sup> ... 2.5 mm<sup>2</sup>, 450 V, 16 A, PA, light gray, coding: P, 2.5 mm<sup>2</sup>, cable length: 5 m, Male straight, on Socket straight

---

## Accessories

### ZBF 4:UNBEDRUCKT - Zack Marker strip, flat

0808587

<https://www.phoenixcontact.com/us/products/0808587>



Zack Marker strip, flat, Strip, white, unlabeled, can be labeled with: CMS-P1-PLOTTER, PLOTMARK, mounting type: latching, for terminal block width: 4 mm, Number of individual labels: 10, text field height: 5.2 mm, text field width: 4.2 mm

# IPD W 3P2,5 F M25 BK - Panel feed-through



1088684

<https://www.phoenixcontact.com/us/products/1088684>

## UC-TMF 4 - Marker for terminal blocks

0818166

<https://www.phoenixcontact.com/us/products/0818166>

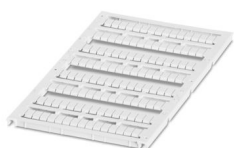

Marker for terminal blocks, Sheet, white, unlabeled, can be labeled with: BLUEMARK ID COLOR, BLUEMARK ID, BLUEMARK CLED, PLOTMARK, CMS-P1-PLOTTER, mounting type: latching, for terminal block width: 4.2 mm, Number of individual labels: 120, text field height: 5.1 mm, text field width: 3.6 mm

---

## UCT-TMF 4 - Marker for terminal blocks

0828742

<https://www.phoenixcontact.com/us/products/0828742>



Marker for terminal blocks, Sheet, white, unlabeled, can be labeled with: TOPMARK NEO, TOPMARK LASER, BLUEMARK ID COLOR, BLUEMARK ID, BLUEMARK CLED, THERMOMARK PRIME, THERMOMARK CARD 2.0, THERMOMARK CARD, mounting type: latching, for terminal block width: 4.2 mm, Number of individual labels: 90, text field height: 4.7 mm, text field width: 3.4 mm

## IPD W 3P2,5 F M25 BK - Panel feed-through

1088684

<https://www.phoenixcontact.com/us/products/1088684>



## IPD PL CAP W26 WP GY - Protective cap

1088707

<https://www.phoenixcontact.com/us/products/1088707>



Protective cap, IPD, with locking element, IP66, IP68, IP69K, width: 26 mm, color: gray, for IPD P 3P2,5..., IPD W 3P2,5..., IPD H 3P,5..., IPD Y 3P2,5

---

## SZF 1-0,6X3,5 - Screwdriver

1204517

<https://www.phoenixcontact.com/us/products/1204517>



Actuation tool, for ST terminal blocks, also suitable for use as a bladed screwdriver, size: 0.6 x 3.5 x 100 mm, 2-component grip, with non-slip grip

# IPD W 3P2,5 F M25 BK - Panel feed-through



1088684

<https://www.phoenixcontact.com/us/products/1088684>

## CRIMPFOX CENTRUS 6S - Crimping pliers

1213144

<https://www.phoenixcontact.com/us/products/1213144>



Crimping pliers, for uninsulated and insulated ferrules, DIN 46228 Part 1 and 4, from 0.14 mm<sup>2</sup> ... 6 mm<sup>2</sup>, also for TWIN ferrules up to 2 x 4 mm<sup>2</sup>, automatic cross section adjustment, lateral insertion, equipped with fall protection

---

## CRIMPFOX VARIO 4S - Crimping pliers

1108766

<https://www.phoenixcontact.com/us/products/1108766>



Crimping pliers, contact connection type: Insulated and uninsulated ferrules, min. cross section: 0.25 mm<sup>2</sup>, max. cross section: 4 mm<sup>2</sup>, compression: Square crimp, weight 401, black/green

---

Phoenix Contact 2024 © - all rights reserved  
<https://www.phoenixcontact.com>

Phoenix Contact USA  
586 Fulling Mill Road  
Middletown, PA 17057, United States  
(+717) 944-1300  
[info@phoenixcon.com](mailto:info@phoenixcon.com)