

Customer Information Sheet

DRAWING No.: M52-510XX45

SHEET 2 OF 2

IF IN DOUBT - ASK

(C)

NOT TO SCALE

THIRD ANGLE PROJECTION

ALL DIMENSIONS IN mm

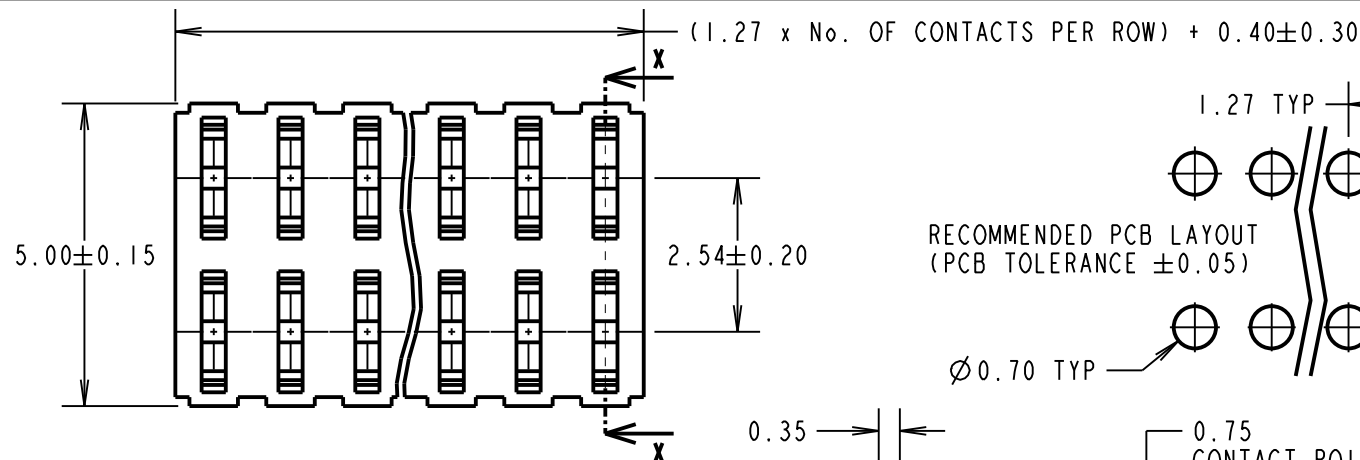

RECOMMENDED PCB LAYOUT
(PCB TOLERANCE ± 0.05)

$\varnothing 0.70$ TYP

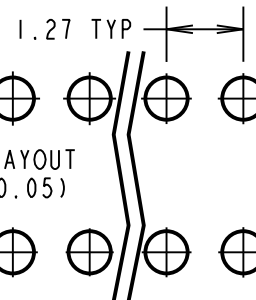

SPECIFICATIONS:

MATERIAL:

MOULDING = NYLON 6T UL94V-0, BLACK
CONTACT = PHOSPHOR BRONZE

FINISH:

CONTACT = GOLD OVER NICKEL

ELECTRICAL:

CURRENT RATING = 1A
DIELECTRIC WITHSTAND VOLTAGE = 500V AC
FOR ONE MINUTE

CONTACT RESISTANCE = $30m\Omega$ MAX
INSULATION RESISTANCE = $1000M\Omega$ MIN

MECHANICAL:

INSERTION FORCE = IN MAX PER PIN
WITHDRAWAL FORCE = 0.12N MIN PER PIN
DURABILITY = 300 CYCLES

ENVIRONMENTAL:

OPERATING TEMPERATURE = -40°C TO $+105^{\circ}\text{C}$

PACKING:

TUBE

OBSOLETE

No. of contacts per row = 02, 11, 13,
14, 15 to 19, 21 to 24, 26 to 29, 31 to 39
Last Time Buy = 15th June 2018

NOTES:

1. ALL TOLERANCES ARE ± 0.25 UNLESS OTHERWISE STATED.

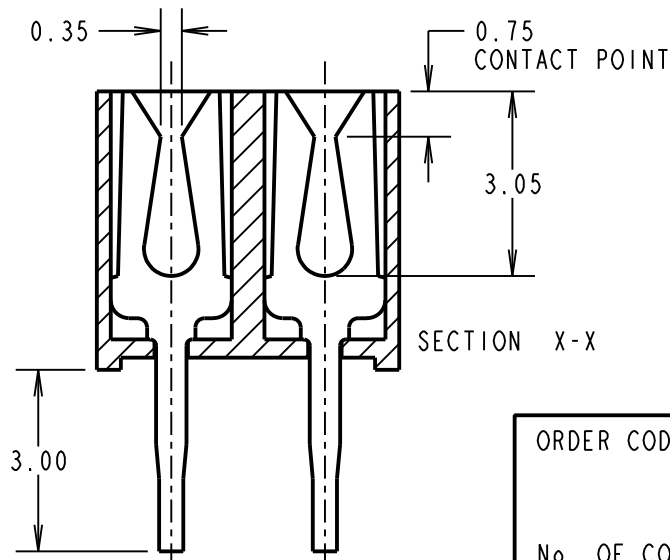
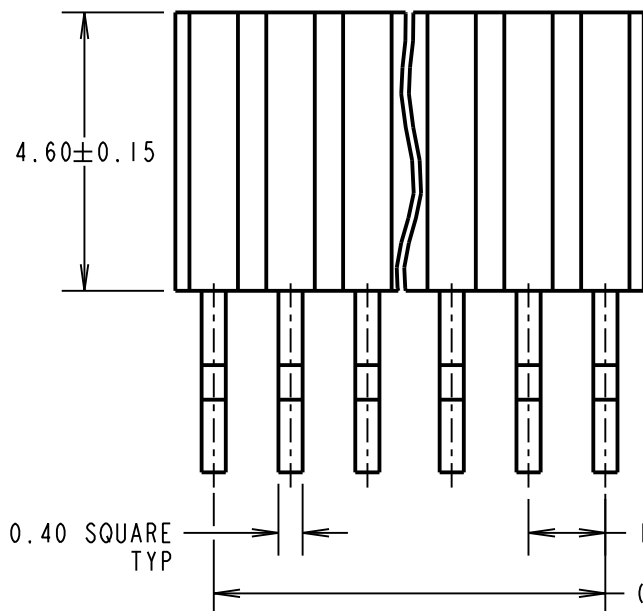

SECTION X-X

ORDER CODE:

M52-510XX45

No. OF CONTACTS PER ROW:
03 to 10, 12, 15, 20, 25, 30, 40

FINISH:
GOLD

SB	10	17.12.13	11905
NAME	ISS.	DATE	C/NOTE
APPROVED:	S.BENNETT		
CHECKED:	S.FLOWER		
DRAWN:	J. ENRIGHT		
CUSTOMER REF.:			
ASSEMBLY DRG:			

HARWIN

www.harwin.com
technical@harwin.com

THIS DRAWING AND ANY INFORMATION OR DESCRIPTIVE MATTER SET OUT HEREON ARE CONFIDENTIAL AND COPYRIGHT PROPERTY OF THE HARWIN GROUP AND MUST NOT BE DISCLOSED, LOANED, COPIED OR USED FOR MANUFACTURING, TENDERING OR FOR ANY OTHER PURPOSE WITHOUT THEIR WRITTEN PERMISSION.

TOLERANCES

X = $\pm 1\text{mm}$
X.X = $\pm 0.25\text{mm}$
X.XX = $\pm 0.10\text{mm}$
X.XXX = $\pm 0.01\text{mm}$
ANGLES = $\pm 5^{\circ}$
UNLESS STATED

MATERIAL:

SEE ABOVE

FINISH: SEE ABOVE

S/AREA: mm²

TITLE:

1.27mm PITCH DIL
VERTICAL PC TAIL SOCKET ASSY

DRAWING NUMBER:

M52-510XX45

SHT
2 OF 2

Mouser Electronics

Authorized Distributor

Click to View Pricing, Inventory, Delivery & Lifecycle Information:

Harwin:

[M52-5103345](#) [M52-5103145](#) [M52-5103945](#) [M52-5103545](#) [M52-5100945](#) [M52-5100545](#) [M52-5100345](#) [M52-5100745](#) [M52-5100645](#) [M52-5100845](#) [M52-5100445](#) [M52-5102045](#) [M52-5102845](#) [M52-5102445](#) [M52-5102245](#) [M52-5102645](#) [M52-5102545](#) [M52-5101645](#) [M52-5101245](#) [M52-5101845](#) [M52-5101045](#) [M52-5101445](#) [M52-5101345](#) [M52-5101745](#) [M52-5102945](#) [M52-5011145](#) [M52-5102145](#) [M52-5101545](#) [M52-5102745](#) [M52-5102345](#) [M52-5101145](#) [M52-5101945](#) [M52-5104045](#) [M52-5103245](#) [M52-5103645](#) [M52-5103445](#) [M52-5103045](#) [M52-5103845](#) [M52-5103745](#)