

ACCORDING TO : ANSI/TIA-568-C.2
 ISO/IEC 11801
 IEC 60603-7
 IEEE 802.3at Power over Ethernet Plus (PoE+) application
 IEC 60512-99-001 Mating and un-mating connectors under electrical load

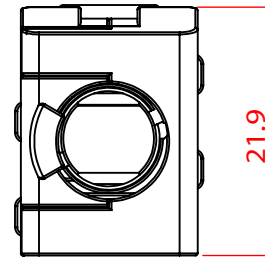

SUGGESTED MOUNTING CUTOUT

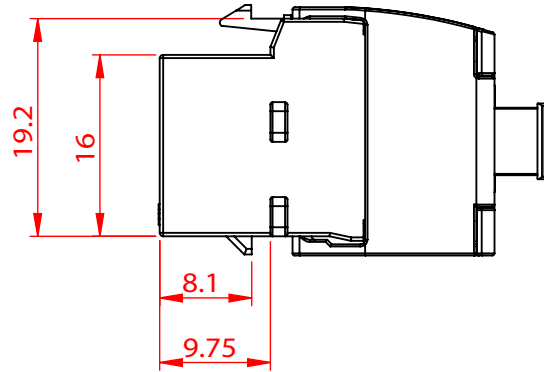
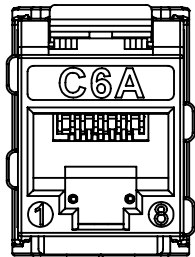
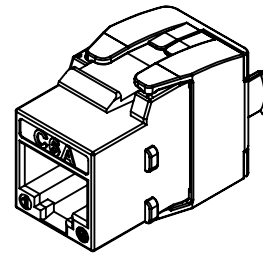
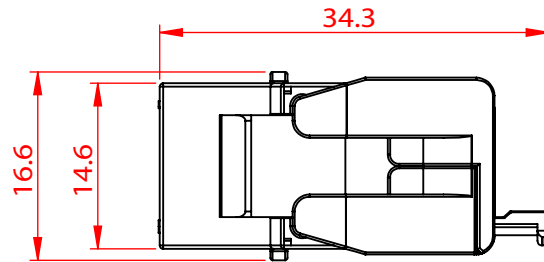
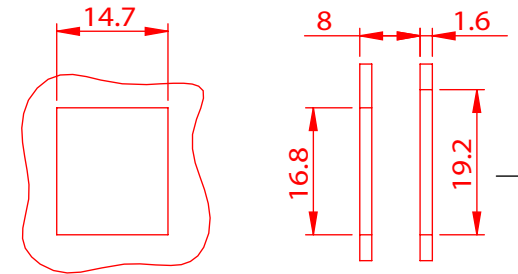

MATERIAL

KEYSTONE JACK HOUSING : PC+ABS+STAINLESS STEEL,UL94V-0.
 REAR HOUSING : ZINC ALLOY,NICKEL PLATED.
 KEYSTONE JACK LATCH : PC+ABS,UL94V-0.
 CONTACT HOLDER : PC,UL94V-0.
 JACK CONTACTS : PHOSPHOR BRONZE,50U" GOLD PAINTING.
 IDC PLASTIC : PC,UL94V-0.
 IDC TERMINALS : PHOSPHOR BRONZE,TIN OVER NICKEL UNDERCOAT.

PHYSICAL CHARACTERISTICS

INSERTION LIFE : 750 MATING CYCLES WITH FCC COMPLIANT 8P PLUG.
 CONTACT FORCE : 100 GRAMS WITH FCC COMPLIANT 8P PLUG.
 PLUG RETENTION FORCE : 11 LBF MIN.
 DURABILITY : 30 TERMINATION CYCLES.
 CONTACT COMPATIBILITY : ACCOMMODATES 22 TO 24 AWG SOLID.
 OPERATING TEMPERATURE RANGE : -10 °C TO 60 °C.
 STORAGE TEMPERATURE RANGE : -40 °C TO 68 °C.
 HUMIDITY : 10%~90%RH.

ELECTRICAL

INSULATION RESISTANCE : 500 MΩ.
 DIELECTRIC WITHSTANDING VOLTAGE : 1000 V AC.
 DC CURRENT RATING : 1.5 Amps.
 DC RESISTANCE : 0.1Ω.
 CONTACT RESISTANCE : 20mΩ.

NOTE

1 ONLY ACCEPT RJ-45 8P8C PLUG.

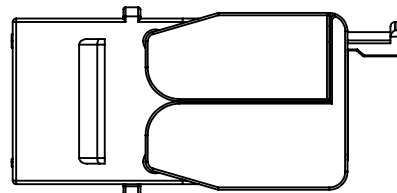

ENCLOSURE
 IDC CAP X 1 PC

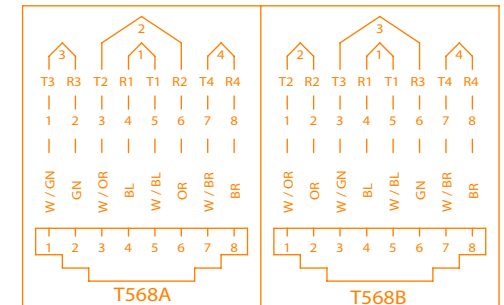

Scale	3:2	Title	
3rd Angle Projection		CAT6A POE++ UTP KEYSTONE JACK, RJ45 180 DEG TOOLESS, 568A/B	
Unit	mm	Part No.	
Date	2017/9/11	NKJ-75XX	
Tolerance		Drawn by	Checked by
~20	~50	Roy	
~150	150~		
±0.2	±0.4		
±0.5	±1.5		
ANGLE	±2°		