

Generation 6

CLM-22 COB Arrays

White LED

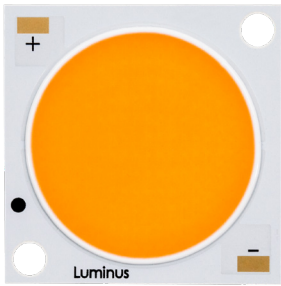

Features

- High lumen output and efficacy typical
- Over 5485 lm, 158 LPW @ 3000K, 90CRI, Tj = 85°C
- Over 5740 lm, 165LPW @ 5000K, 90CRI, Tj = 85°C
- CCT range 2200K, 2400K, 2700K, 3000K, 3500K, 4000K, 5000K and 6500K
- 3 SDCM color binning standard, 2 SDCM binning standard
- Excellent optical emission uniformity and color over angle consistency
- Superior thermal conductivity for uniform heat spreading
- Environmentally friendly: RoHS and REACH compliant
- ENEC certification



Table of Contents

Part Number Nomenclature	2
CCT, CRI & R9 Specification.....	2
Chromaticity Bin Structure.....	3
Ordering Part Numbers.....	4
Operating Characteristics	7
Optical and Electrical Characteristics	8
Typical Spectrum	9
Radiation Pattern	9
Mechanical Dimension	10
Shipping Container	10
Label Information.....	10
Technology Review	11
Test Specifications	11
Handling Notes	12
Chemical Compatibility	13

Applications

- Spotlights/Track Lights
 - Downlights
 - Shop Lighting
 - Hospitality Lighting
- Architectural and Specialty
 - Street Lighting
 - Parking Lot and Area Lighting
 - Tunnel Lighting



Part Number Nomenclature

All Luminus COB products are packaged and labeled with part numbers as outlined in the table on page 4. Luminus may include any smaller chromaticity bin that is contained in the larger bin as part of the ordered part. When shipped, each package will contain only a single flux and chromaticity bin. The part number designation is as follows:

CLM	—	22	—	NN	—	XX	—	VV	—	QQPP	—	FG	—	W
Product Family		LES ¹		CCT ²		Min. CRI ³		Typical Voltage		Package Configurator ⁴		Flux Bin		Chromaticity Bin ⁵
Chip on Board, Multi-die		22mm LES diameter		See Note 2 below		CRI See Table Below		Volts (V)		TC60		Lumens		See page 3 for bins

- Notes:
- 1. Light Emitting Surface (LES) Diameter.
 - 2. Correlated Color Temperature (CCT), NN nomenclature corresponds to the following:
22 = 2200K
24 = 2400K
27 = 2700K
30 = 3000K
35 = 3500K
40 = 4000K
50 = 5000K
65 = 6500K
 - 3. Minimum Color Rendering Index (CRI).
 - 4. TC is a standard substrate with sulfur resistance process; 6 means Generation 6 COB products, 0 means a product with chromaticity on the BBL.
 - 5. Luminus part numbers may be accompanied by prefixes or suffixes. The most common is the "Rev01" suffix indicating a part is fully released and carries a full warranty. These additional characters may appear on shipping labels, packing slips and invoices. In all cases the basic part number described above will always be included.

CCT, CRI and R9 Values

Correlated Color Temperatures	XX Value	CRI	*R9
2700K, 3000K, 3500K, 4000K, 5000K, 6500K	80	>80	>0
2200K, 2400K, 2700K, 3000K, 3500K, 4000K, 5000K, 6500K	90	>90	>50
2700K, 3000K	95	>95	>80
3500K, 4000K, 5000K			>70

Note: R9 values have a tolerance of +/- 5%



Chromaticity Bin Structure- (On BBL)

Chromaticity Bins: 1931 CIE Color Space

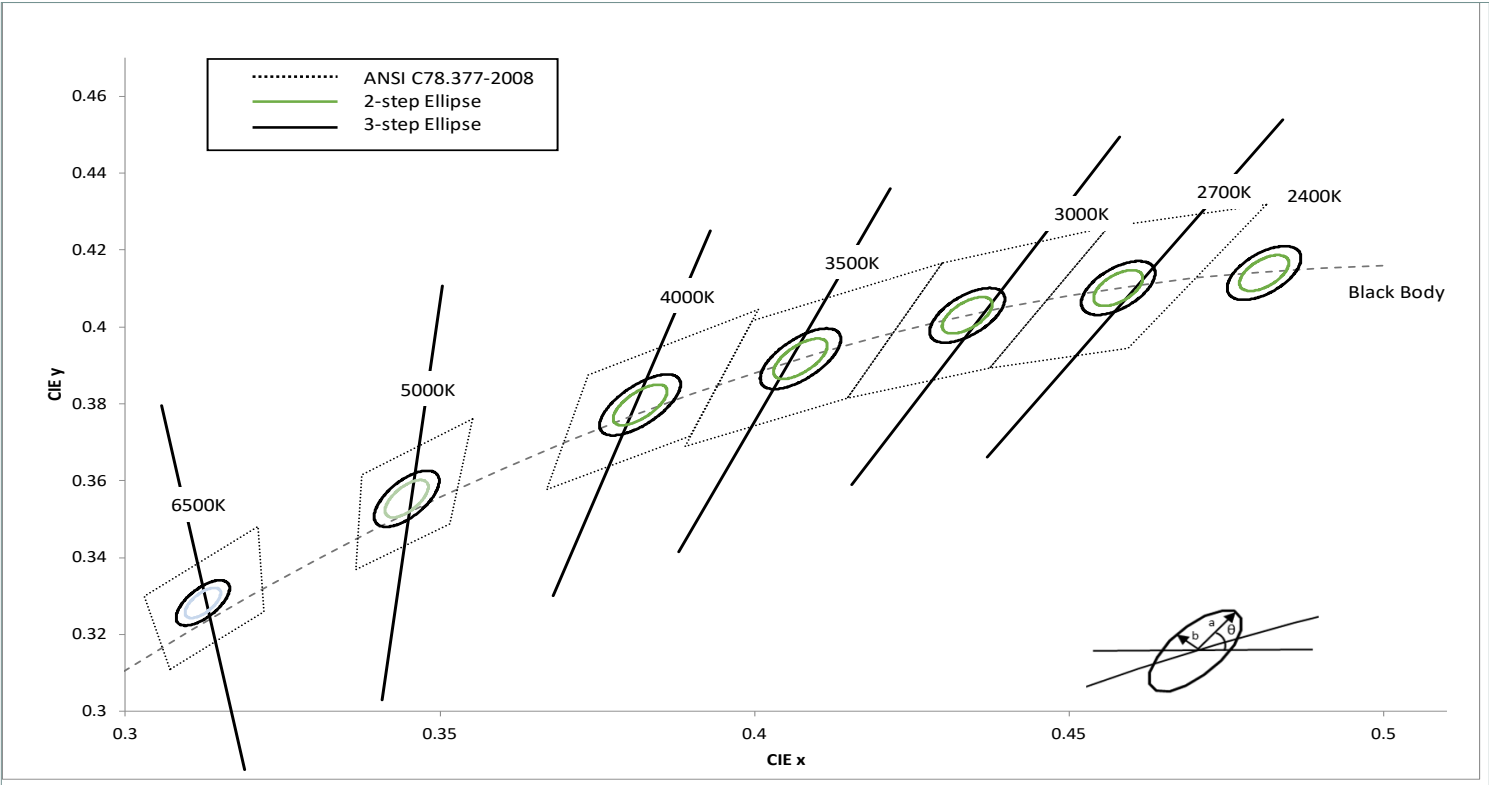

The following tables describe the chromaticity bin center points, the orientation angle for the MacAdam ellipse (θ°), and the maximum radii for the ellipses. The ANSI Bin is provided for reference.

CCT	Center Point		Angle	3-step Bin		2-step Bin	
	CIE _x	CIE _y		a	b	a	b
2200K	0.5014	0.4153	53.7	0.0081	0.0042	0.0054	0.0028
2400K	0.4810	0.4140	53.7	0.0081	0.0042	0.0054	0.0028
2700K	0.4578	0.4101	53.7	0.0081	0.0042	0.0054	0.0028
3000K	0.4338	0.4030	53.2	0.0083	0.0041	0.0056	0.0027
3500K	0.4073	0.3917	54.0	0.0093	0.0041	0.0062	0.0028
4000K	0.3818	0.3797	53.7	0.0094	0.0040	0.0063	0.0027
5000K	0.3447	0.3553	59.6	0.0082	0.0035	0.0056	0.0024
6500K	0.3123	0.3282	58.6	0.0067	0.0029	0.0046	0.0019

Note: Luminus maintains a +/- 0.005 tolerance on chromaticity (CIE_x and CIE_y) measurements



Ordering Part Numbers-(TC60)

The following tables lists products typical flux and minimum flux measured at 1,050mA and specified at $T_j = 85^\circ\text{C}$. The values at 25°C are calculated and shown for reference only.

CCT	Output Flux (lm)			Color Rendering Index (min.)	Ordering Part Number	
	Typ. (85°C)	Min. (85°C)	Calculated Typ. (25°C)		3-SDCM Chromaticity	2-SDCM Chromaticity
2200K	4510	4195	4960	90	CLM-22-22-90-36-TC60-F7-3	CLM-22-22-90-36-TC60-F7-2
2400K	4900	4560	5390	90	CLM-22-24-90-36-TC60-F7-3	CLM-22-24-90-36-TC60-F7-2
2700K	5955	5540	6550	80	CLM-22-27-80-36-TC60-F7-3	CLM-22-27-80-36-TC60-F7-2
	5290	4920	5820	90	CLM-22-27-90-36-TC60-F7-3	CLM-22-27-90-36-TC60-F7-2
	4430	4120	4875	95	CLM-22-27-95-36-TC60-F7-3	CLM-22-27-95-36-TC60-F7-2
3000K	6285	5845	6915	80	CLM-22-30-80-36-TC60-F7-3	CLM-22-30-80-36-TC60-F7-2
	5485	5100	6035	90	CLM-22-30-90-36-TC60-F7-3	CLM-22-30-90-36-TC60-F7-2
	4675	4345	5140	95	CLM-22-30-95-36-TC60-F7-3	CLM-22-30-95-36-TC60-F7-2
3500K	6405	5955	7045	80	CLM-22-35-80-36-TC60-F7-3	CLM-22-35-80-36-TC60-F7-2
	5625	5230	6185	90	CLM-22-35-90-36-TC60-F7-3	CLM-22-35-90-36-TC60-F7-2
	4880	4540	5370	95	CLM-22-35-95-36-TC60-F7-3	CLM-22-35-95-36-TC60-F7-2
4000K	6545	6085	7200	80	CLM-22-40-80-36-TC60-F7-3	CLM-22-40-80-36-TC60-F7-2
	5750	5350	6330	90	CLM-22-40-90-36-TC60-F7-3	CLM-22-40-90-36-TC60-F7-2
	5145	4785	5660	95	CLM-22-40-95-36-TC60-F7-3	CLM-22-40-95-36-TC60-F7-2
5000K	6650	6180	7315	80	CLM-22-50-80-36-TC60-F7-3	CLM-22-50-80-36-TC60-F7-2
	5740	5340	6315	90	CLM-22-50-90-36-TC60-F7-3	CLM-22-50-90-36-TC60-F7-2
	5395	5015	5930	95	CLM-22-50-95-36-TC60-F7-3	CLM-22-50-95-36-TC60-F7-2
6500K	6445	5995	7090	80	CLM-22-65-80-36-TC60-F7-3	CLM-22-65-80-36-TC60-F7-2
	5765	5360	6340	90	CLM-22-65-90-36-TC60-F7-3	CLM-22-65-90-36-TC60-F7-2

Note: Luminus maintains a +/- 6% tolerance on flux measurements.
Luminus maintains a +/- 2% tolerance on CRI measurements.



Chromaticity Bin Structure - Sensus, For Points Below the Black Body Locus (BBBL)

Chromaticity Bins: 1931 CIE Color Space

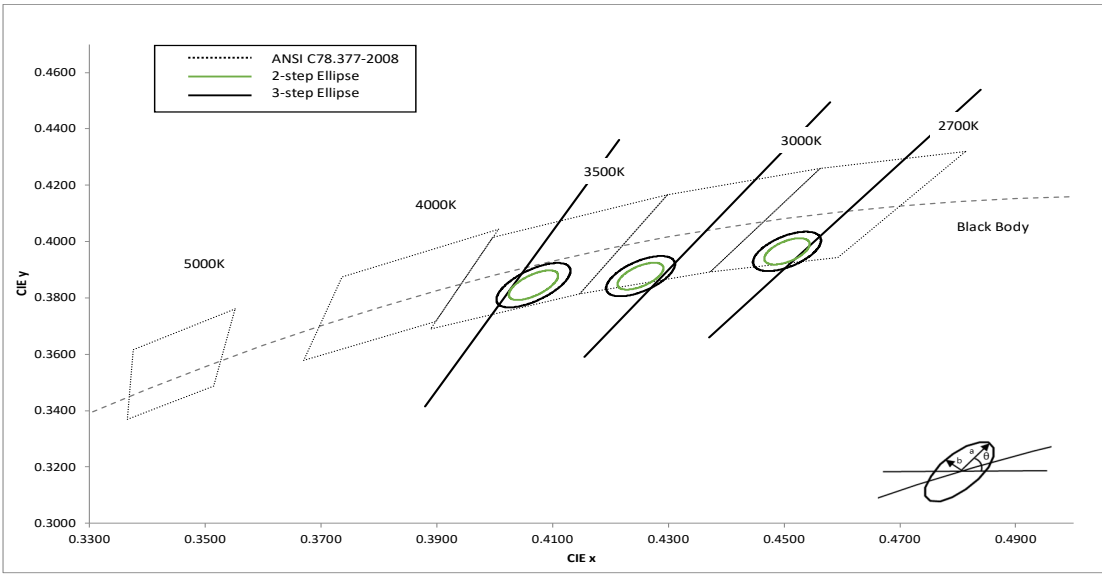

This table defines the chromaticity bin center points, the orientation angle for the MacAdam ellipse (θ°), and the maximum radii for the ellipses. The ANSI Bin is provided in the above graph for reference.

CCT	Center Point		Angle	3-step Bin		2-step Bin	
	CIE _x	CIE _y		a	b	a	b
2700K	0.4505	0.3965	53.7	0.0081	0.0042	0.0054	0.0028
3000K	0.4252	0.3877	53.6	0.0083	0.0041	0.0056	0.0027
3500K	0.4067	0.3845	54.0	0.0093	0.0041	0.0062	0.0028

Ordering Part Numbers - TC62 Sensus (BBBL)

The following tables describe products with typical flux and minimum flux measured at 1050mA and specified at $T_j = 85^\circ\text{C}$. The values at 25°C are calculated and shown for reference only.

CCT	Output Flux (lm)			Color Rendering Index (min.)	Ordering Part Number	
	Typ. (85°C)	Min. (85°C)	Calculated Typ. (25°C)		3-step MacAdam Ellipse	2-step MacAdam Ellipse
2700K	5035	4680	5535	90	CLM-22-27-90-36-TC62-F7-3	CLM-22-27-90-36-TC62-F7-2
3000K	5340	4965	5875	90	CLM-22-30-90-36-TC62-F7-3	CLM-22-30-90-36-TC62-F7-2
3500K	5485	5105	6035	90	CLM-22-35-90-36-TC62-F7-3	CLM-22-35-90-36-TC62-F7-2

Note: Luminus maintains a +/- 6% tolerance on flux measurements.
Luminus maintains a +/- 2% tolerance on CRI measurements.
Luminus maintains a +/- 0.005 tolerance on chromaticity (CIE_x and CIE_y) measurements

Chromaticity Bin Structure - Custom Color Points Below the Black Body Locus (BBBL)

Chromaticity Bins: 1931 CIE Color Space

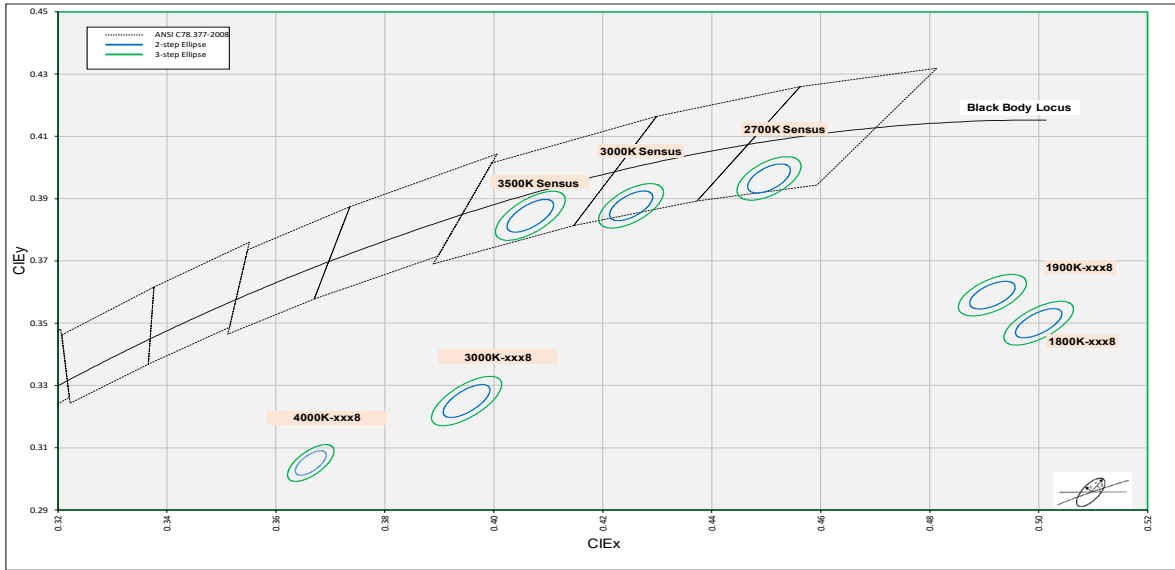

This table defines the chromaticity bin center points, the orientation angle for the MacAdam ellipse (θ°), and the maximum radii for the ellipses. The ANSI Bin is provided in the above graph for reference.

CCT	Center Point		Angle θ°	3-step Bin		2-step Bin	
	CIE _x	CIE _y		a	b	a	b
1800K	0.5000	0.3500	49.3	0.0086	0.0040	0.0058	0.0027
1900K	0.4915	0.3590	48.2	0.00810	0.0042	0.0054	0.0028
3000K	0.3950	0.3250	53.7	0.00939	0.00402	0.0063	0.0027
4000K	0.3664	0.3051	58.6	0.00669	0.00285	0.0045	0.0019

Ordering Part Numbers - TC68 Custom Colors (BBBL)

The following tables describe products with typical flux and minimum flux measured at 1050mA and specified at $T_j = 85^\circ\text{C}$. The values at 25°C are calculated and shown for reference only.

CCT	Output Flux (lm)			Color Rendering Index (min.)	Ordering Part Number	
	Typ. (85°C)	Min. (85°C)	Calculated Typ. (25°C)		3-step MacAdam Ellipse	2-step MacAdam Ellipse
1800K	2830	2630	3115	70	CLM-22-18-70-36-TC68-F7-3	CLM-22-18-70-36-TC68-F7-2
1900K	3680	3420	4050	70	CLM-22-19-70-36-TC68-F7-3	CLM-22-19-70-36-TC68-F7-2
3000K	3775	3510	4155	70	CLM-22-30-70-36-TC68-F7-3	CLM-22-30-70-36-TC68-F7-2
4000K	3445	3205	3790	70	CLM-22-40-70-36-TC68-F7-3	CLM-22-40-70-36-TC68-F7-2

Note: Luminus maintains a $\pm 6\%$ tolerance on flux measurements.

Luminus maintains a $\pm 2\%$ tolerance on CRI measurements.

Luminus maintains a ± 0.005 tolerance on chromaticity (CIE_x and CIE_y) measurements



Operating Characteristics¹

Parameter	Symbol	Minimum	Typical	Maximum	Unit
Forward Current ^{1,2}	I _f		1,050	3200	mA
Forward Voltage ³	V _f	31.6	32.9	36.5	V
Power			34.5	117	W
Operating Case Temperature	T _c			120	°C
Light Emitting Surface Diameter	LES		22.0		mm
Thermal Resistance (junction-to-case)	Q _{jc}		0.14		°C/W
Junction Temperature	T _j			140	°C
Viewing Angle			120		Degree

Notes:

- 1. Device measurements are at Tj =85°C.
- 2. To prevent damage refer to operating conditions and derating curves for appropriate maximum operating conditions
- 3. Voltage is rated at typical forward current. For voltage at higher drive current, refer to performance graphs.
- 4. Thermal resistance is measured from LED junction-to-Tc (thermal contact point), at typical current using JESD51-14.
- 5. Device operation not recommended at drive currents less than 10% of the typical value
- 6. Caution must be taken not to stare at the light emitted from these LEDs. Under special circumstances, the high intensity could damage the eye.



Optical & Electrical Characteristics

Relative Output Flux vs. Forward Current @ 85°C

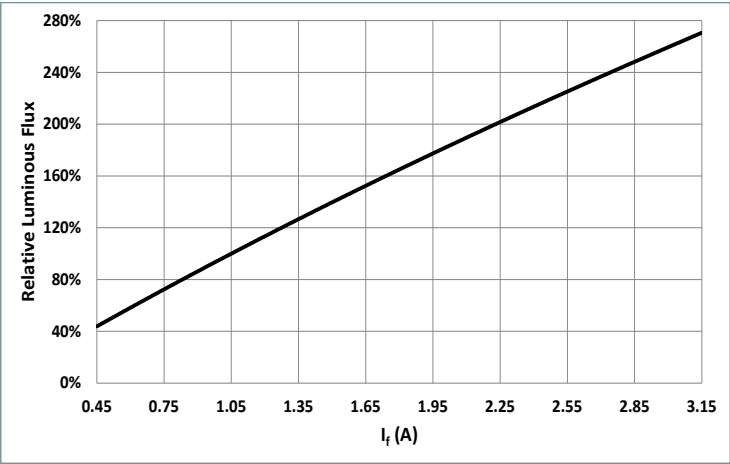

Forward Current vs. Forward Voltage @ 85°C

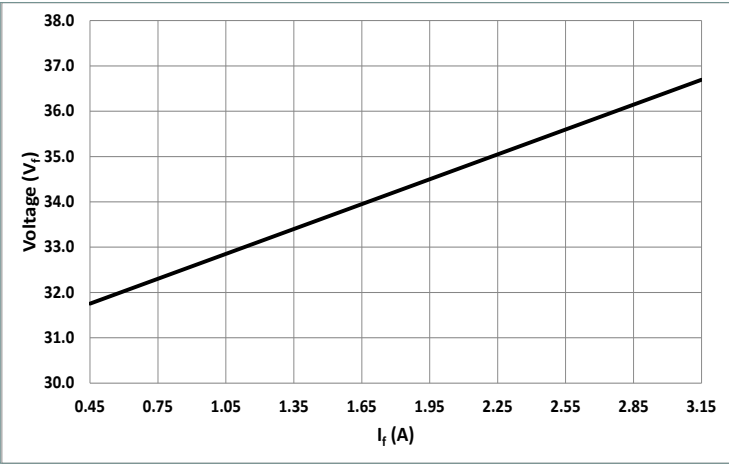

Relative Output Flux vs. Junction Temperature

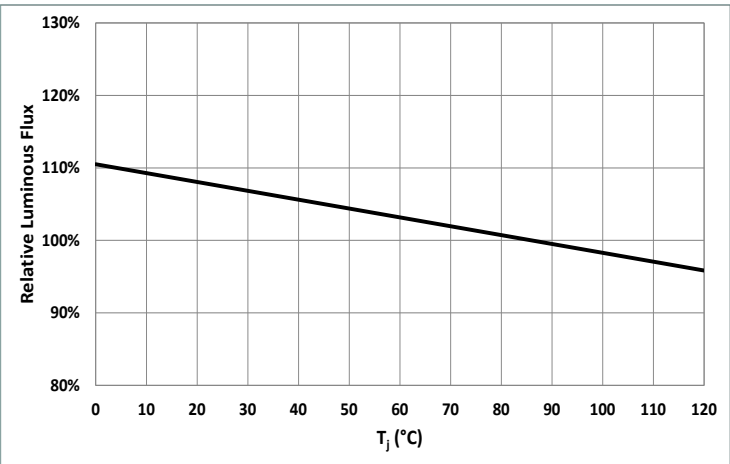

Change in Voltage vs. Junction Temperature

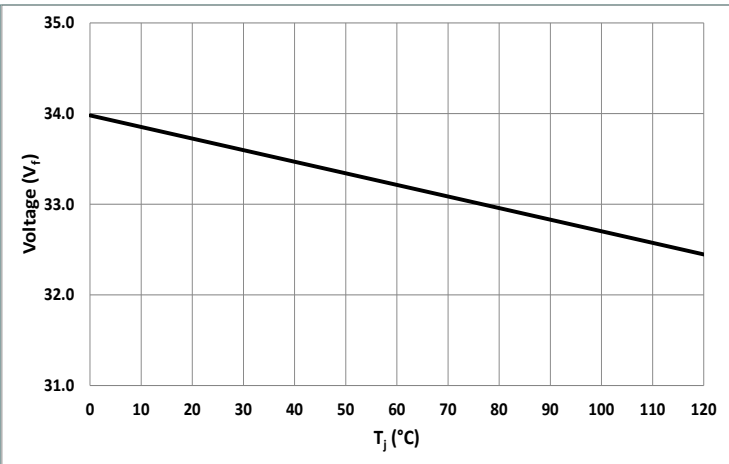

Change in CIE_x/y vs. Junction Temp. (3000K, 90CRI)

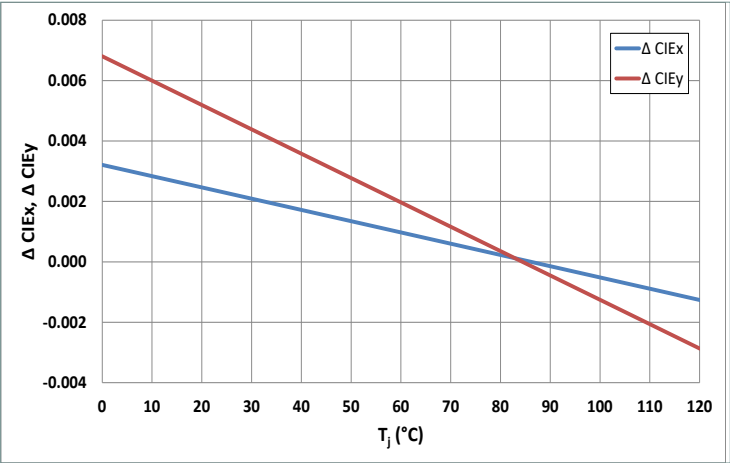

Change in CIE_x/y vs. Forward Current (3000K, 90CRI)

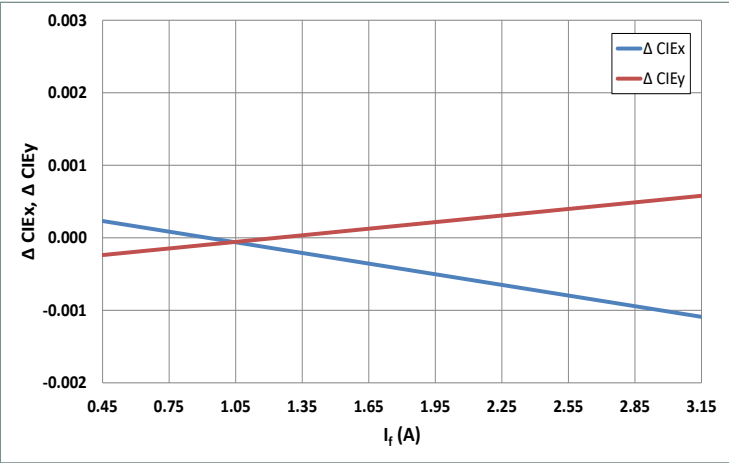



Typical Spectrum

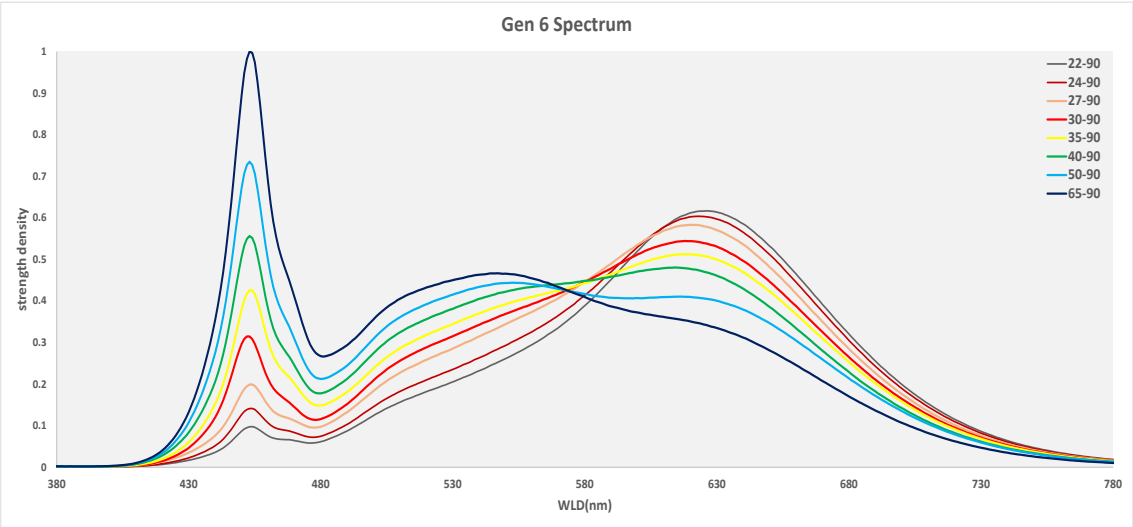

Radiation Pattern

Typical Polar Radiation Pattern

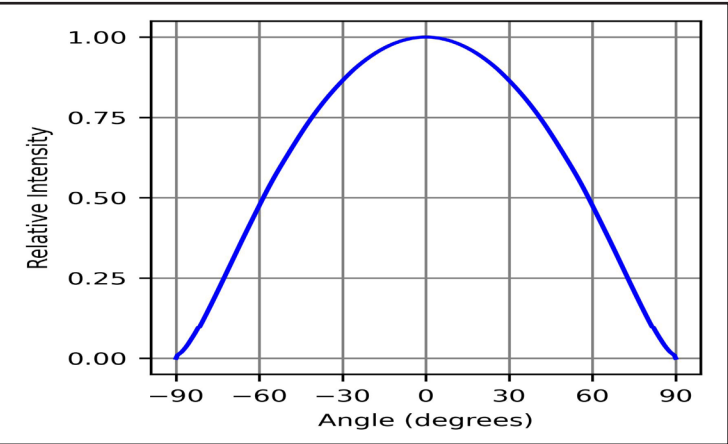

Typical Angular Radiation Pattern

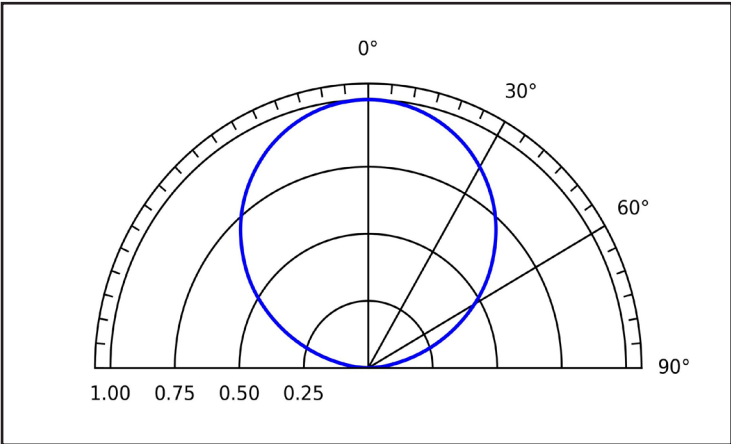

Derating Curve

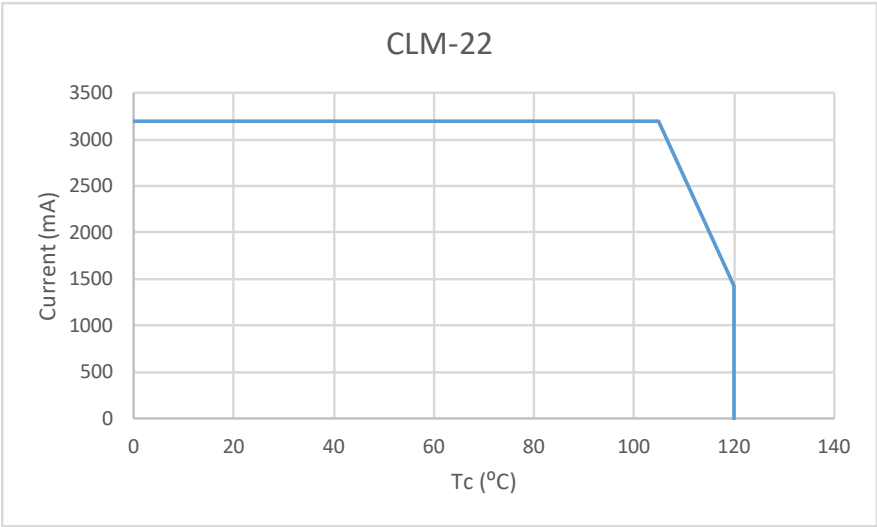



Mechanical Dimensions

Note: Unless otherwise specified, tolerance is $\pm 0.3\text{mm}$

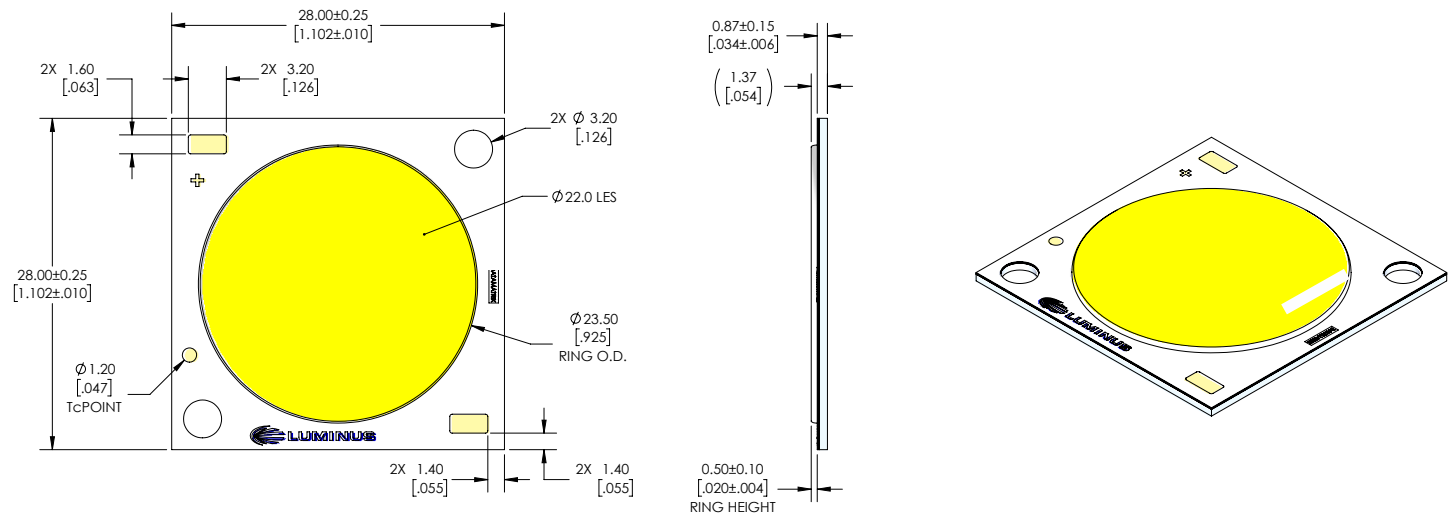

Shipping Container



Package model -- for illumination

Note: 20 pcs per tray and 5 trays are stacked together to be sealed in an anti-static bag.



Note: The anti-static bag is boxed for easier storage, 100 pcs per box.

Label Information

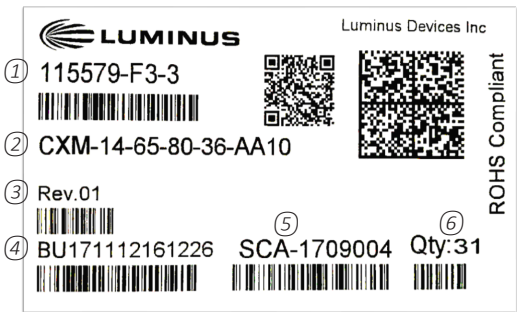

Label model -- for illustration only

Notes:

- ① Manufacture part number, flux bin and chromaticity bin
- ② Customer part number
- ③ Rev.01 indicates a fully released product
- ④ Box ID
- ⑤ Production ID
- ⑥ Total number of units in a box



Technology Overview

Luminus Chip-on-Board (COB) LED series have consistently delivered the highest lumen performance with the best color quality of any COB supplier. Driving performance enhancements through more than 5 generations of COB products has provided Luminus a comprehensive understanding of the lighting market for directional sources positioning Luminus as the COB manufacturer of choice for the most discriminating lighting manufacturers.

Reliability

Designed from the ground up, the Luminus COB LED is one of the most reliable light sources in the world today.

UL and IEC Recognized Compliance

Luminus COB arrays are tested in accordance with ANSI/UL 8750 to ensure safe operation for their intended applications. Further, Luminus maintains IEC-62031 safety ratings on all COB products.

REACH & RoHS Compliance

All LED products manufactured by Luminus are REACH and RoHS compliant and free of hazardous materials, including lead and mercury.

Test Specifications

Every Luminus LED is fully tested to ensure it meets the high quality standards customers have come to expect from Luminus' products.

Traceability

Each Luminus COB LED is marked with a 2D bar code that contains a unique serial number. With this serial number, Luminus has the ability to provide customers with actual test data measurements for a specific LED. In addition, the 2D bar code is linked to manufacturing date codes that enables traceability of production processes and materials.

Testing Temperature

Luminus COB products are measured at temperatures typical for the LED operating in the fixture. Each device is tested at 85°C junction temperature eliminating the need to scale data sheet specifications to real world situations.

Chromaticity Bin Range

Chromaticity binning delivers color consistency for every order. Standard products are delivered with a 3-step MacAdam ellipse. This ensures color performance matching in the application. For the most demanding application, Luminus is one of only a few companies that can provide a 2 SDCM bin distribution. These tightly controlled, small distribution bins provide customers predictable, repeatable colors.



Handling Notes

Luminus products are designed for robust performance in general lighting application. However, care must be taken when handling and assembling the LEDs into their fixtures. To avoid damaging Luminus COBs please follow these guidelines.

The following is an overview of the application notes detailing some of the practices to follow when working with these devices. More detailed information is available on the Luminus web site at www.luminus.com.

General Handling

Devices are made to be lifted or carried with tweezers on two adjacent corners opposite the contact pads. At no time should the devices be handled by or should anything come in contact with the light emitting surface (LES) area. This area includes the yellow colored circular area and the ring surrounding it. There are electrical connections under the LES which if damaged will cause the device to fail. In addition, the ring frame itself should not be used for moving, lifting or carrying the device. Also do not attach any optics or mechanical holders to the ring as it is not capable to handle the mechanical stress.

Storage Condition

Please follow the conditions below.

Before opened	Temperature 5~30°C, relative humidity less than 60%.
After opened	Temperature 5~30°C, relative humidity less than 60%. After opening, LED should be kept in an aluminum moisture proof bag with a moisture absorbent material
Avoid Corrosive gas	Avoid exposing to air with corrosive gas. If exposed, electrode surface would be damaged, which may affect soldering. More detailed information is available on the Luminus Applications Resources web pages.

Static Electricity

Luminus COBs are electronic devices which can be damaged by electrostatic discharge (ESD). Please use appropriate measures to assure the devices do not experience ESD during their handling and or storage. ESD protection guidelines should be used at all time when working with Luminus COBs.

Storage	Luminus products are delivered in ESD shielded bags and should be stored in these bags until used
Transporting	When transporting the devices from one assembly area to another, ESD shielded carts and carriers should be used
Assembly	Individuals handling Luminus COBs during assembly should be trained in ESD protection practices. Assemblers should maintain constant conductive contact with a path to ground by means of a wrist strap, ankle straps, mat or other ESD protection system



Chemical Compatibility

The resin material used to form the LES can get hydrocarbons from the surrounding environment. As a result, certain chemical compounds (H_2SO_4 , H_2S , SO_2 , NH_3 , H_3PO_4 , etc.) are not recommended for use with the Luminus products. Use of these compounds can cause damage to the light output of the device and may permanently damage the device. Please refer to the table below for a list of the compounds not recommended for use with the Luminus COB products.

Common Chemicals Known to Adversely Affect Luminus Devices		
Acetates	Ethers	Potassium hydroxide
Acetic acid	Cl, F or Br containing compounds	Siloxanes
Acrylates	Liquid hydrocarbons	Sodium Hydroxide
Aldehydes	Hydrochloric Acid	Sulfur compounds
Aldehydes	Ketones	Sulfuric Acid
Amines	Nitric Acid	Toluene
Benzene	Phosphoric acid	Xylenes
Dienes		

Thermal Interface Material (TIM)

Proper thermal management is critical for successful operation of any LED system. Excess operating temperature can reduce the light output of the device. And excessive heating can cause permanent damage to the device. Proper TIM material is a crucial component for effective heat transfer away from the LED during normal operation. Please refer to www.luminus.com for specific recommendations for TIM solutions.

Please refer to <https://www.luminus.com/resource/application-notes> for more application note information.