



Image for illustrative purpose only

## Summary

[Request a quote](#)

[Catalog](#)

|                                    |  |
|------------------------------------|--|
| Number of contacts Low Voltage     | 4  |
| Wire Size/AWG                      | 28 - 20  |
| Gender                             | Standard                                       |
| Socket / Receptacle                | Socket / Receptacle - Fixed Panel Rear Mounted |
| Locking system                     | Push-pull                                      |
| Jacket cable outside diameter [mm] | 2.00 - 13.60 mm                                |
| Size                               | 2B   |
| Suggested matching part            | <a href="#">FGG.2B.304.CLAD52</a>              |
| Series                             | B - Indoor keyed                               |

[https://www.lemo.com/int\\_en/solutions/originals/b-indoor-keyed/heg-2b-304-cllpv.html](https://www.lemo.com/int_en/solutions/originals/b-indoor-keyed/heg-2b-304-cllpv.html)

LEMO products and services are provided "as is". LEMO makes no warranties or representations with regard to LEMO product & services or use of them, express, implied or statutory, including for accuracy, completeness, or security. The user is fully responsible for his products and applications using LEMO components.

# Technical details

## Electrical Configuration

|                                 |                              |
|---------------------------------|------------------------------|
| Contact Termination Low voltage | Solder                       |
| R (max)                         | 3.6 mOhm                     |
| Insert configuration value      | 2B.304 - 4 Low Voltage       |
| Insulator                       | L: PEEK (UL 94 / V-0/1.5)    |
| Rated current                   | 15 A                         |
| Vtest (contact-contact)         | 1850 V (AC), 2600 V (DC)     |
| Vtest (contact-shell)           | 1850 V (AC), 2600 V (DC)     |
| Contact Type                    | Solder                       |
| Max. Solid Conductor            | 0.5 mm <sup>2</sup> (AWG 20) |
| Max. Stranded Conductor         | 0.5 mm <sup>2</sup> (AWG 20) |
| Bucket Dia.                     | 1 mm (0.039in)               |
| Contact Dia.                    | 1.3 mm (0.051in)             |
| Number of contacts Low Voltage  | 4                            |
| Wire Size/AWG                   | 28 - 20                      |
| Gender                          | Standard                     |

## Form & Material

|                        |   |
|------------------------|---|
| Shell style / Model id | HE - Fixed receptacle, nut fixing, watertight or vacuum-tight (back panel mounting)   |
| Socket / Receptacle    | Fixed Panel Rear Mounted  |
| Housing material       | Brass (chrome plated [SAE AMS 2460]) shell and collet nut, nickel plated [SAE AMS QQ N 290] brass latch sleeve and mid pieces |
| Locking system         | Push-pull   |
| Keying                 | 1 key (alpha=0, plug: male contacts, receptacle: female contacts)   |
| Colour                 | Grey  |
| Variant                | Watertight / Vacuum-tested unmated (connector to device)  |
| Weight                 | 22.31 g   |

[https://www.lemo.com/int\\_en/solutions/originals/b-indoor-keyed/heg-2b-304-cllpv.html](https://www.lemo.com/int_en/solutions/originals/b-indoor-keyed/heg-2b-304-cllpv.html)

LEMO products and services are provided "as is". LEMO makes no warranties or representations with regard to LEMO product & services or use of them, express, implied or statutory, including for accuracy, completeness, or security. The user is fully responsible for his products and applications using LEMO components.

## Environment

|                                   |  |
|-----------------------------------|--|
| Technical domain                  | Audio Video, Energy and Industrial, Medical, Semiconductor, Specialties and Other, Test and Measurement, Transportation, Aerospace and UAV |
| Environmental sealing (IP rating) | Hermetic unmated   |
| Endurance                         | 5000 mating cycles   |
| Temperature range                 | -20°C / +80°C  |
| Climatical Category               | 20/80/21   |
| Humidity (max)                    | <=95% [at 60 deg C /140 F]   |
| Shielding (min)                   | 75 dB (10 MHz)   |
| Shielding (min)                   | 40 dB (1 GHz)  |
| Shock Resistance                  | 100 g [ 6 ms]  |
| Vibration                         | 15 g [10 Hz - 2000 Hz]   |
| Pressure                          | 40 bars  |
| R leak (He) (max)                 | 0.0000001 mbar*l/s (if vacuum-tested)  |
| Salt Spray Corrosion              | >1000 hr   |

## Cable fixation

|                                    |                 |
|------------------------------------|-----------------|
| Jacket cable outside diameter [mm] | 2.00 - 13.60 mm |
|------------------------------------|-----------------|

## Drawings

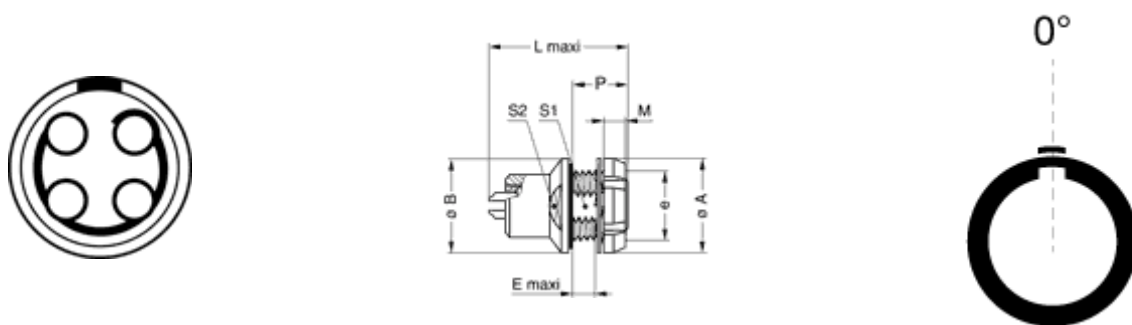

## Dimensions

|     | A    | B    | L    | M    | P    | S1   | S2   | e       | E   |
|-----|------|------|------|------|------|------|------|---------|-----|
| mm. | 20   | 20   | 31.6 | 3.5  | 9.6  | 13.5 | 15   | M15x1.0 | 5   |
| in. | 0.79 | 0.79 | 1.24 | 0.14 | 0.38 | 0.53 | 0.59 |         | 0.2 |

[https://www.lemo.com/int\\_en/solutions/originals/b-indoor-keyed/heg-2b-304-cllpv.html](https://www.lemo.com/int_en/solutions/originals/b-indoor-keyed/heg-2b-304-cllpv.html)

LEMO products and services are provided "as is". LEMO makes no warranties or representations with regard to LEMO product & services or use of them, express, implied or statutory, including for accuracy, completeness, or security. The user is fully responsible for his products and applications using LEMO components.

# Recommended By Lemo

| Accessories    |   |
|----------------|---|
| Tools          |   |
| Spanner        | <a href="#">DCH.91.201.PA</a>                         |
| Spanner wrench | <a href="#">Socket for torque wrench DCM.2S.M15.6</a> |

# Cables

| Cable PartNumber   | Material      | Colour | Cable image  |
|--------------------|---------------|--------|--|
| CMN.04.T20.053PGZE |               | grey   |     |
| CMN.04.T20.053PNZE |               |        |     |
| CMN.04.T20.053QGZE | TPR (medical) | Grey   |     |
| CMN.04.T22.047QGC  | TPR           | Grey   |  |
| CMN.04.T22.048QGZE | TPR (medical) | Grey   |     |
| CMN.04.T28.031PGCE | PVC           | GREY   |     |
| CMN.04.T28.031PGZE |               | grey   |     |
| CMN.04.T28.031PNCE | PVC           | Black  |     |
| CMN.04.T28.031PNZE |               |        |     |
| CMN.04.T28.031QGC  | TPR           | Grey   |  |
| 140240             | PVC           | Black  |     |
| 140250             | PVC           | Grey   |     |
| 240500             | PVC           | Grey   |     |
| 240750             | PVC           | Grey   |   |
| 40080              | PVC           | Black  |  |
| 40086              | PVC           | Blue   |  |
| 40140              | PVC           | Black  |   |
| 40240              | PTFE          | White  |   |
| 40260              | PVC           | Black  |   |
| 4041               | PVC           | Grey   |  |
| 4050               | PVC           | Black  |   |
| 4080               | PVC           | Grey   |  |
| 417920             | PVC           | Grey   |  |
| 4220               | PVC           | Black  |   |
| 4221               | PVC           | Black  |   |
| 4260               | PTFE          | White  |   |
| 4280               | PVC           | Black  |   |
| 80080              | PVC           | Grey   |  |
| 80082              | PVC           | Red    |  |
| 80084              | PVC           | Black  |  |
| CTR.75.030.121870G | PVC           | Grey   |   |

[https://www.lemo.com/int\\_en/solutions/originals/b-indoor-keyed/heg-2b-304-cllpv.html](https://www.lemo.com/int_en/solutions/originals/b-indoor-keyed/heg-2b-304-cllpv.html)

LEMO products and services are provided "as is". LEMO makes no warranties or representations with regard to LEMO product & services or use of them, express, implied or statutory, including for accuracy, completeness, or security. The user is fully responsible for his products and applications using LEMO components.