

*Image for illustrative purpose only*

## Summary

[Request a quote](#)

[Catalog](#)

Nb of contacts Thermocouple	8
Gender	Standard
Locking system	Push-pull
Size	2K
Series	K - Outdoor keyed

[https://www.lemo.com/int\\_en/solutions/originals/k-outdoor-keyed/ftg-2k-308-clf.html](https://www.lemo.com/int_en/solutions/originals/k-outdoor-keyed/ftg-2k-308-clf.html)

LEMO products and services are provided "as is". LEMO makes no warranties or representations with regard to LEMO product & services or use of them, express, implied or statutory, including for accuracy, completeness, or security. The user is fully responsible for his products and applications using LEMO components.

# Technical details

## Electrical Configuration

Nb of contacts Thermocouple	8
Insert configuration value	2K.308 - 4 Thermocouple Pairs
Insulator	L: PEEK (UL 94 / V-0/1.5)
Rated current	10 A
Contact Dia.	0.9 mm (0.035in)
Gender	Standard

## Form & Material

Shell style / Model id	FT - T-plug with receptacles (straight & elbow)
Housing material	Brass (chrome plated [SAE AMS 2460]) shell, collet nut and latch sleeve, nickel plated [SAE AMS QQ N 290] brass mid pieces
Locking system	Push-pull
Keying	1 key (alpha=0, plug: male contacts, receptacle: female contacts)
Colour	Grey
Weight	115.14 g

## Environment

Technical domain	Audio Video, Energy and Industrial, Medical, Test and Measurement
Environmental sealing (IP rating)	IP68
Endurance	5000 mating cycles
Temperature range	-55°C / +200°C
Climatical Category	50/175/21
Humidity (max)	<=95% [at 60 deg C /140 F]
Shielding (min)	95 dB (10 MHz)
Shielding (min)	80 dB (1 GHz)
Shock Resistance	100 g [ 6 ms]
Vibration	15 g [10 Hz - 2000 Hz]
Salt Spray Corrosion	>1000 hr

[https://www.lemo.com/int\\_en/solutions/originals/k-outdoor-keyed/ftg-2k-308-clf.html](https://www.lemo.com/int_en/solutions/originals/k-outdoor-keyed/ftg-2k-308-clf.html)

LEMO products and services are provided "as is". LEMO makes no warranties or representations with regard to LEMO product & services or use of them, express, implied or statutory, including for accuracy, completeness, or security. The user is fully responsible for his products and applications using LEMO components.

# Drawings

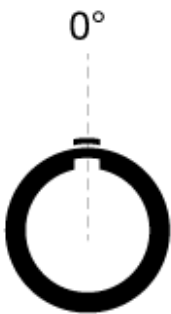
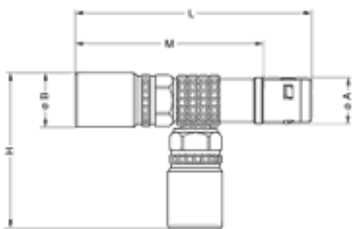

## Dimensions

	L	M	A	B	H
mm.	77	60	16	19	48
in.	3.03	2.36	0.63	0.75	1.89