

RM3R88P106P106P-3304 (201)

✓ ACTIVE

AMP | AMP ARINC 404 Series

TE Part # 1996220-3

TE Internal #: 1996220-3

[View on TE.com >](#)



Connectors > PCB Connectors > Backplane Connectors > Rack & Panel Backplane > Rack & Panel Connectors



Connector Style: **Receptacle**

Number of Inserts: **3**

Sealable: **Yes**

Clinch Nuts: **With**

Features

Product Type Features

Shell Mounting Modification	33
Product Type	Connector
Connector Style	Receptacle
Sealable	Yes

Configuration Features

Keying	4
Number of Inserts	3

Contact Features

Contact Arrangement (Module C)	106
Contact Arrangement (Module B)	106
Signal Contacts	Without
Contact Arrangement (Module A)	88

Mechanical Attachment

Clinch Nut Size	14702
Hardware Type	Bushing
Clinch Nuts	With

Other

Custom Order Code	201
-------------------	-----

Product Compliance



For compliance documentation, visit the product page on TE.com>

EU RoHS Directive 2011/65/EU	Not Compliant
EU ELV Directive 2000/53/EC	Not Compliant
China RoHS 2 Directive MIIT Order No 32, 2016	Restricted Materials Above Threshold
EU REACH Regulation (EC) No. 1907/2006	Current ECHA Candidate List: JAN 2019 (197) Candidate List Declared Against: JUL 2017 (174)
Halogen Content	Not Yet Reviewed for halogen content
Solder Process Capability	Not applicable for solder process capability

Product Compliance Disclaimer

This information is provided based on reasonable inquiry of our suppliers and represents our current actual knowledge based on the information they provided. This information is subject to change. The part numbers that TE has identified as EU RoHS compliant have a maximum concentration of 0.1% by weight in homogenous materials for lead, hexavalent chromium, mercury, PBB, PBDE, DBP, BBP, DEHP, DIBP, and 0.01% for cadmium, or qualify for an exemption to these limits as defined in the Annexes of Directive 2011/65/EU (RoHS2). Finished electrical and electronic equipment products will be CE marked as required by Directive 2011/65/EU. Components may not be CE marked. Additionally, the part numbers that TE has identified as EU ELV compliant have a maximum concentration of 0.1% by weight in homogenous materials for lead, hexavalent chromium, and mercury, and 0.01% for cadmium, or qualify for an exemption to these limits as defined in the Annexes of Directive 2000/53/EC (ELV). Regarding the REACH Regulations, TE’s information on SVHC in articles for this part number is still based on the European Chemical Agency (ECHA) ‘Guidance on requirements for substances in articles’(Version: 2, April 2011), applying the 0.1% weight on weight concentration threshold at the finished product level. TE is aware of the European Court of Justice ruling of September 10th, 2015 also known as O5A (Once An Article Always An Article) stating that, in case of ‘complex object’, the threshold for a SVHC must be applied to both the product as a whole and simultaneously to each of the articles forming part of its composition. TE has evaluated this ruling based on the new ECHA “Guidance on requirements for substances in articles” (June 2017, version 4.0) and will be updating its statements accordingly.

Also in the Series | AMP ARINC 404 Series



Rack & Panel Connectors  
(28)



Rack & Panel Contacts(1)

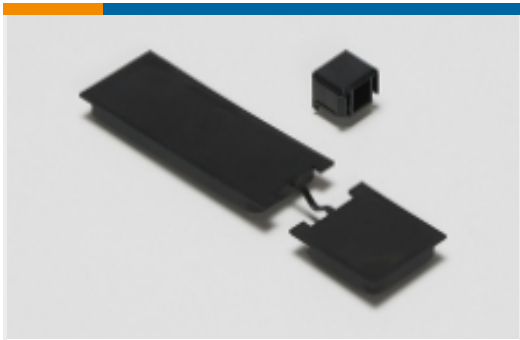

Rack & Panel Covers & Plugs(1)

Customers Also Bought

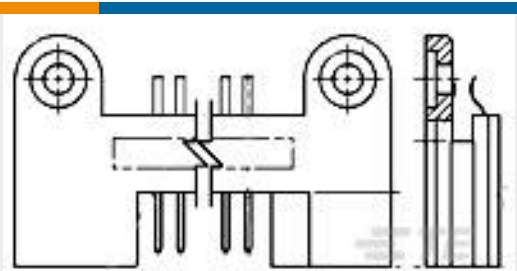

TE Part #1-530785-1  
BOX PIN 60 POS 075 C/L



TE Part #5-794682-2  
22P MICRO MNL ASSY,  
VRT,THRU,L

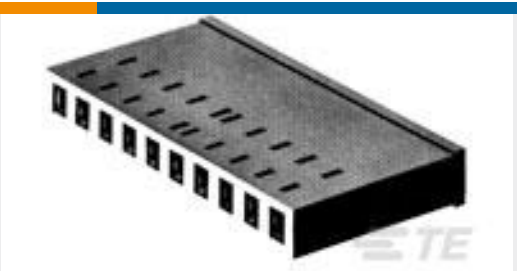

TE Part #1-87270-0  
4/05 LOCK CLIP HSG SR .  
156CL

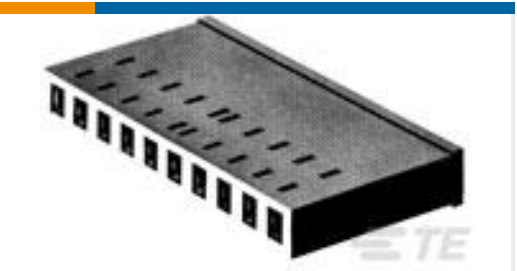

TE Part #1-87270-2  
05/06 LOCK CLIP HSG SR .  
156CL



TE Part #2-323199-1  
DG 22-16COM 22-18MIL  
HR R6TAPE

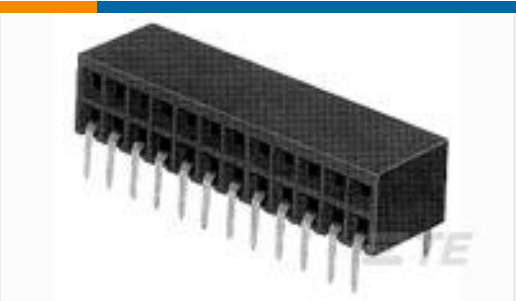

TE Part #3-87962-9  
80 MODII HORZ DR CE  
100CL/115

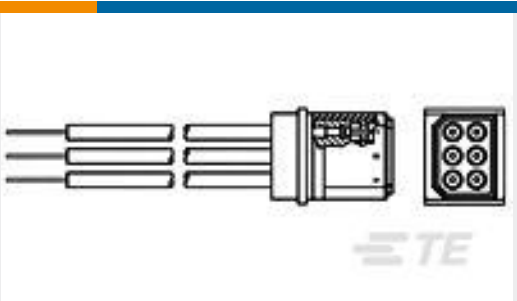

TE Part #449810-1  
PLUG ASSY WITH .25  
POSTS,LGH

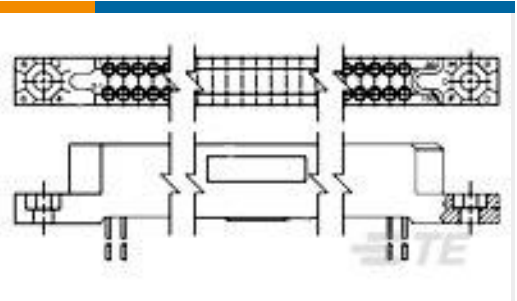

TE Part #531146-1  
2 ROW BOX RECP 120  
POS STAG

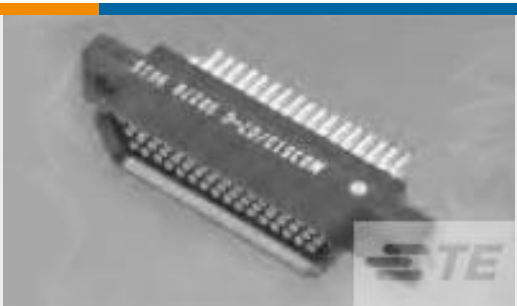

TE Part #8-1532020-7  
095-0604-2037=MCDR3-B-  
9S5L5-0.5



TE Part #85829-1  
01 MODI HDR SRST .156CL

Documents

Product Drawings

RM3R88P106P106P-3304 (201)

English

CAD Files

3D PDF

3D

Customer View Model

ENG\_CVM\_CVM\_1996220-3\_C.2d\_dxf.zip

English

Customer View Model

ENG\_CVM\_CVM\_1996220-3\_C.3d\_igs.zip

English

Customer View Model

ENG\_CVM\_CVM\_1996220-3\_C.3d\_stp.zip

English

Datasheets & Catalog Pages

ARINC 600 Next Generation Receptacle Connector



English