



Terminals & Splices > Terminal Housings, Insulation Sleeves & Blocks > Crimp Terminal Housings



Connector & Housing Type: **Receptacle**

Number of Positions: **1**

Terminal Orientation: **Straight**

UL Flammability Rating: **UL 94V-2**

Primary Product Color: **Natural**

Features

Product Type Features

| | |
|--------------------------|------------|
| Sealable | No |
| Connector & Housing Type | Receptacle |

Configuration Features

| | |
|---------------------|---|
| Number of Positions | 1 |
|---------------------|---|

Body Features

| | |
|-----------------------|---------|
| Primary Product Color | Natural |
|-----------------------|---------|

Contact Features

| | |
|--------------------------|----------|
| Terminal Orientation | Straight |
| Contact Mating Retention | Without |

Mechanical Attachment

| | |
|------------------|---------|
| Mating Alignment | Without |
|------------------|---------|

Housing Features

| | |
|------------------|--------------|
| Housing Material | Polyethylene |
|------------------|--------------|

Dimensions

| | |
|--|--|
| | |
|--|--|



| | |
|----------------|------------------|
| Product Length | 24.4 mm[.961 in] |
|----------------|------------------|

Usage Conditions

| | |
|-----------------------------|----------------------------|
| Operating Temperature Range | -40 – 105 °C[-40 – 221 °F] |
|-----------------------------|----------------------------|

Industry Standards

| | |
|------------------------|----------|
| UL Flammability Rating | UL 94V-2 |
|------------------------|----------|

Product Compliance

For compliance documentation, visit the product page on [TE.com](#)>

| | |
|---|--|
| EU RoHS Directive 2011/65/EU | Compliant |
| EU ELV Directive 2000/53/EC | Compliant |
| China RoHS 2 Directive MIIT Order No 32, 2016 | No Restricted Materials Above Threshold |
| EU REACH Regulation (EC) No. 1907/2006 | Current ECHA Candidate List: JUNE 2024 (241) Candidate List Declared Against: JAN 2022 (223) Does not contain REACH SVHC |
| Halogen Content | Low Halogen - Br, Cl, F, I < 900 ppm per homogenous material. Also BFR/CFR/PVC Free |
| Solder Process Capability | Not applicable for solder process capability |

Product Compliance Disclaimer

This information is provided based on reasonable inquiry of our suppliers and represents our current actual knowledge based on the information they provided. This information is subject to change. The part numbers that TE has identified as EU RoHS compliant have a maximum concentration of 0.1% by weight in homogenous materials for lead, hexavalent chromium, mercury, PBB, PBDE, DBP, BBP, DEHP, DIBP, and 0.01% for cadmium, or qualify for an exemption to these limits as defined in the Annexes of Directive 2011/65/EU (RoHS2). Finished electrical and electronic equipment products will be CE marked as required by Directive 2011/65/EU. Components may not be CE marked. Additionally, the part numbers that TE has identified as EU ELV compliant have a maximum concentration of 0.1% by weight in homogenous materials for lead, hexavalent chromium, and mercury, and 0.01% for cadmium, or qualify for an exemption to these limits as defined in the Annexes of Directive 2000/53/EC (ELV). Regarding the REACH Regulation, the information TE provides on SVHC in articles for this part number is based on the latest European Chemicals Agency (ECHA) ‘Guidance on requirements for substances in articles’ posted at this URL: <https://echa.europa.eu/guidance-documents/guidance-on-reach>

Also in the Series | [FASTON 110](#)



Crimp Terminal Housings(13)



Insertion & Extraction Tools(1)



PCB Terminals(22)



Quick Disconnects(168)

Customers Also Bought



TE Part #2-1419104-1
T9AS1D22-24



TE Part #521384-4
ASSY PL R/A RAST5 HEADER 04-A



TE Part #150346-2
110 MINI FASTON,REC.,24-20 AWG, TPBR

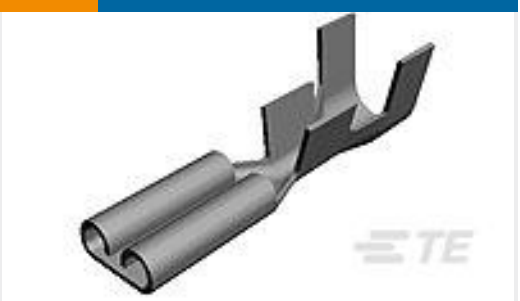

TE Part #41969-2
250 FASTON REC 22-18 AWG BR

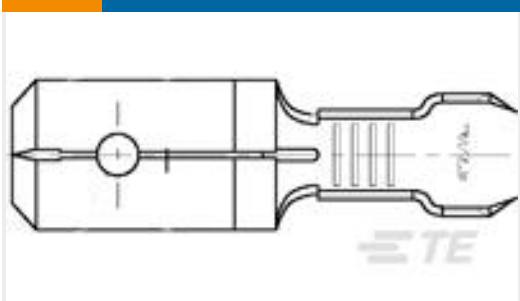

TE Part #60006-2
250 FASTON TAB 18-14 AWG TPBR



TE Part #2176093-6
RP 2A 0.25W 10K2 0.1% 25PPM 1K RL

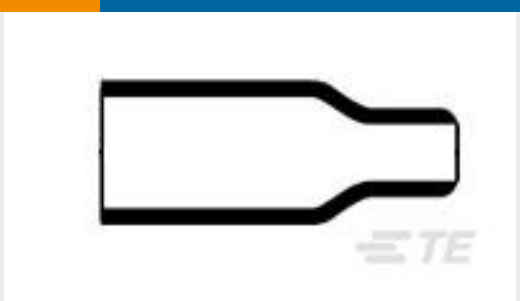

TE Part #814777-000
202A111-3/42-0



TE Part #316390-7
CAVITY PLUG FOR MINI M/LOCK

Documents

CAD Files

3D PDF

3D

Customer View Model

ENG_CVM_CVM_735052_M.2d_dxf.zip

English

Customer View Model

ENG_CVM_CVM_735052_M.3d_igs.zip

English

Customer View Model

ENG_CVM_CVM_735052_M.3d_stp.zip

English

By downloading the CAD file I accept and agree to the [Terms and Conditions](#) of use.