

# SUBCON-PLUS M2 - D-SUB bus connector



2761839

<https://www.phoenixcontact.com/us/products/2761839>

Please be informed that the data shown in this PDF document is generated from our online catalog. Please find the complete data in the user documentation. Our general terms of use for downloads are valid.



D-SUB connector, 9-pos., male connector, two 35° cable entries, bus system: CAN, SUCONET K1, K2 (MOELLER), S-BUS (Saia), J-BUS (Merlin Gerin), pin assignment: 2, 3, 4, 5, 7, 9 to two screw connection terminal blocks

## Product description

Two cable infeeds are often required on the D-SUB plugs used in order to build fieldbus systems with RS-485 interfaces. The SUBCON-PLUS plugs range fulfills this requirement and routes the connection to screw terminal blocks – however, duplicated – for two cables. This means clarity during wiring and it simplifies every startup. These plugs are of course also shielded against EMC influences with a metallized housing. In addition, by placing the connection block in either the upper or lower shell, it is possible to select the cable infeed on site from the right or left .

## Your advantages

- Separate terminal blocks for each cable
- Assembly under field conditions
- High transmission speed
- Easy assembly thanks to knurled screws
- High level of EMC
- Flexibility in terms of cable entry selection
- Can be used universally
- Change to the D-SUB orientation through a reversible connection block

## Commercial data

Item number	2761839
Packing unit	1 pc
Minimum order quantity	1 pc
Sales key	DN10
Product key	DNC521
Catalog page	Page 450 (C-6-2019)
GTIN	4017918131814
Weight per piece (including packing)	75.025 g
Weight per piece (excluding packing)	15.24 g
Customs tariff number	85366990
Country of origin	DE

# SUBCON-PLUS M2 - D-SUB bus connector



2761839  
<https://www.phoenixcontact.com/us/products/2761839>

## Technical data

### Notes

Utilization restriction	
CCCex note	Use in potentially explosive areas is not permitted in China.

### Product properties

Product type	Data plug
MTTF	6706 Years (SN 29500 standard, temperature 25°C, operating cycle 21%)
	1817 Years (SN 29500 standard, temperature 40°C, operating cycle 34.25%)
	155 Years (SN 29500 standard, temperature 40°C, operating cycle 100%)
Pin assignment	2, 3, 4, 5, 7, 9 on two terminal blocks

### Electrical properties

Nominal voltage $U_N$	50 V DC
Nominal current $I_N$	100 mA
Transmission medium	Copper

### Connection data

D-SUB connection	
Connection method	D-SUB connector

PCB connection	
Connection method	Screw connection
Stripping length	5 mm
Conductor cross section, rigid min.	0.14 mm²
Conductor cross section, rigid max.	1.5 mm²
Conductor cross section flexible min.	0.14 mm²
Conductor cross section flexible max.	1 mm²
Single-wire/terminal point, rigid AWG min.	26
Single-wire/terminal point, rigid AWG max.	16
Min. AWG conductor cross section, flexible	26
Max. AWG conductor cross section, flexible	18

### Interfaces

Bus system	CAN, SOCUNET K1, K2 (Moeller), S-BUS (Saia), J-BUS (Merlin Gerin)
Signal	RS-485

### Dimensions

# SUBCON-PLUS M2 - D-SUB bus connector



2761839

<https://www.phoenixcontact.com/us/products/2761839>

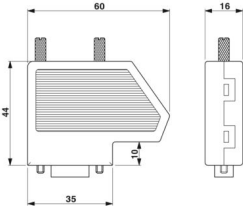
Dimensional drawing	
	
Width	16 mm
Height	44 mm
Length	60 mm

## Material specifications

Material (Housing)	ABS (metal-plated)
--------------------	--------------------

## Cable/line

External cable diameter	6 mm ... 10 mm (Incoming bus line)
-------------------------	------------------------------------

## Mechanical properties

Mechanical data	
Insertion/withdrawal cycles	> 200

## Environmental and real-life conditions

Ambient conditions	
Degree of protection	IP40
Ambient temperature (operation)	-20 °C ... 75 °C
Ambient temperature (storage/transport)	-25 °C ... 80 °C
Altitude	≤ 5000 m (For restrictions, see the manufacturer's declaration for altitude operation)
Permissible humidity (operation)	10 % ... 95 % (non-condensing)
Permissible humidity (storage/transport)	5 % ... 95 % (non-condensing)

## Approvals

ATEX	
Identification	Ex II 3 G Ex nA IIC T4 Gc X
Note	Please follow the special installation instructions in the documentation!

Corrosive gas test	
Identification	ISA-S71.04-1985 G3 Harsh Group A

## Standards and regulations

Free from substances that could impair the application of coating	in accordance with VW-AUDI-Seat central standard P-VW 3.10.7 57 65 0
---	--

# SUBCON-PLUS M2 - D-SUB bus connector

2761839

<https://www.phoenixcontact.com/us/products/2761839>



## Drawings

Schematic diagram

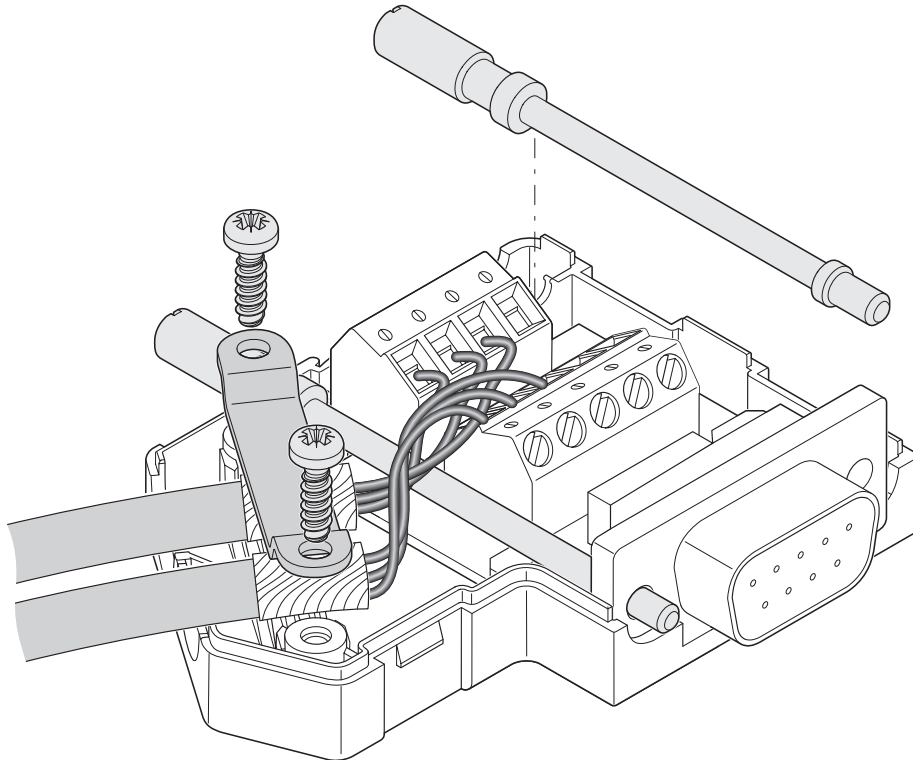

Left-hand side cable entry

# SUBCON-PLUS M2 - D-SUB bus connector



2761839

<https://www.phoenixcontact.com/us/products/2761839>

Schematic diagram

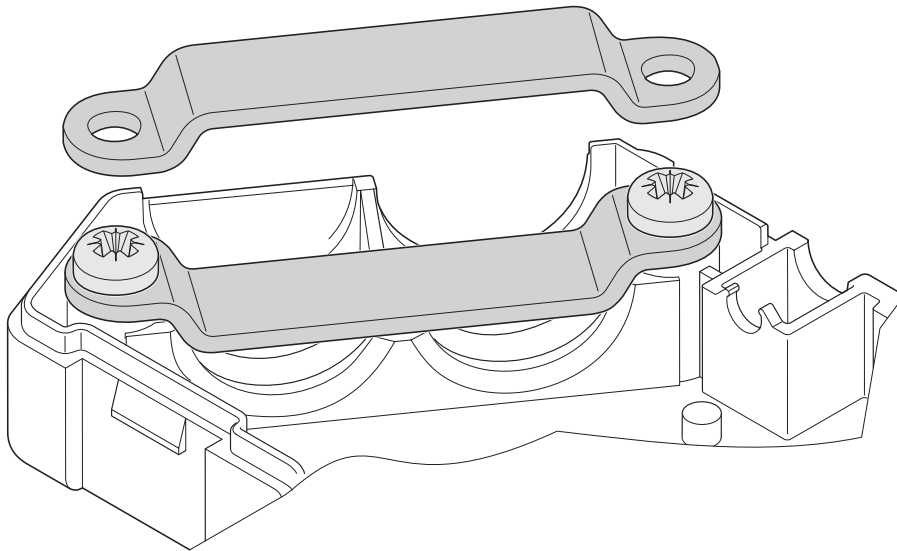

Clip bracket

Schematic diagram

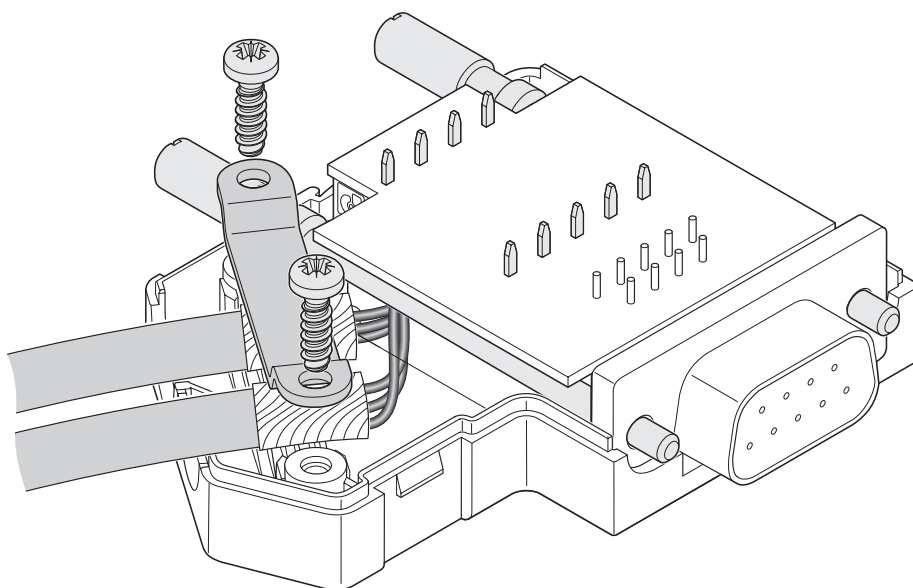

Right-hand side cable entry

# SUBCON-PLUS M2 - D-SUB bus connector



2761839

<https://www.phoenixcontact.com/us/products/2761839>

Schematic diagram

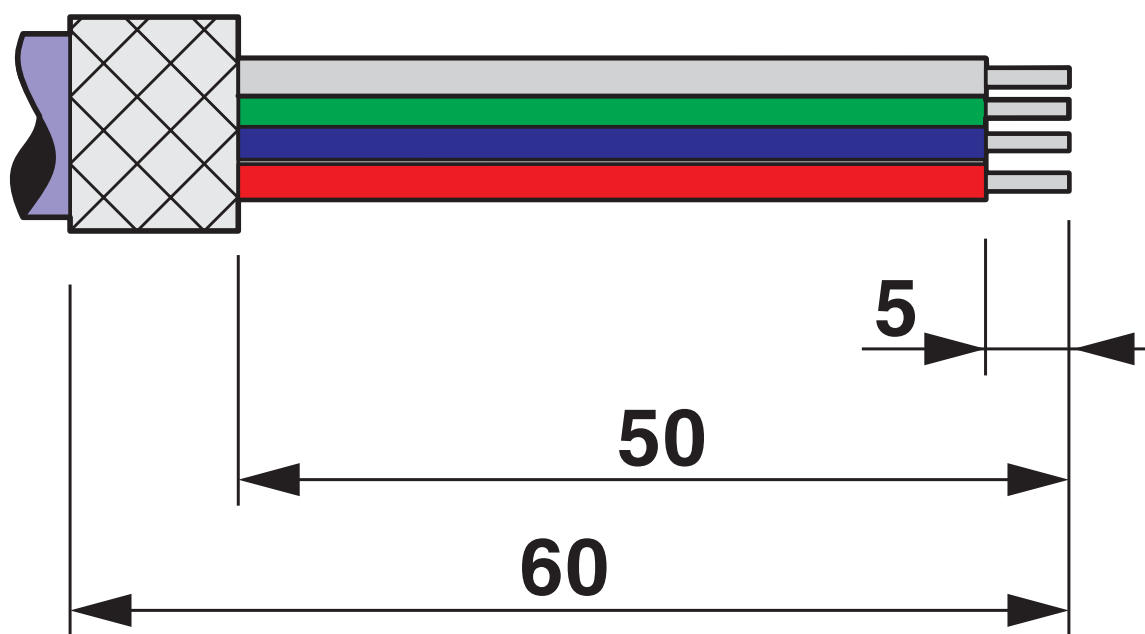

Stripping specifications

# SUBCON-PLUS M2 - D-SUB bus connector

2761839

<https://www.phoenixcontact.com/us/products/2761839>



Schematic diagram

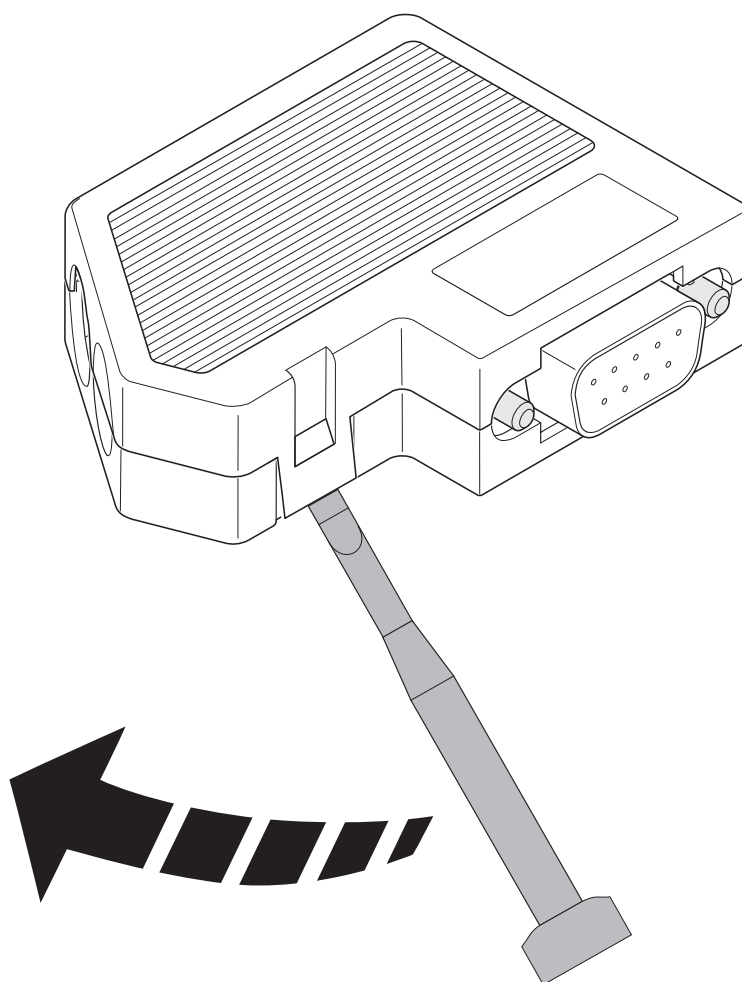

Opening the housing

# SUBCON-PLUS M2 - D-SUB bus connector

2761839

<https://www.phoenixcontact.com/us/products/2761839>



Dimensional drawing

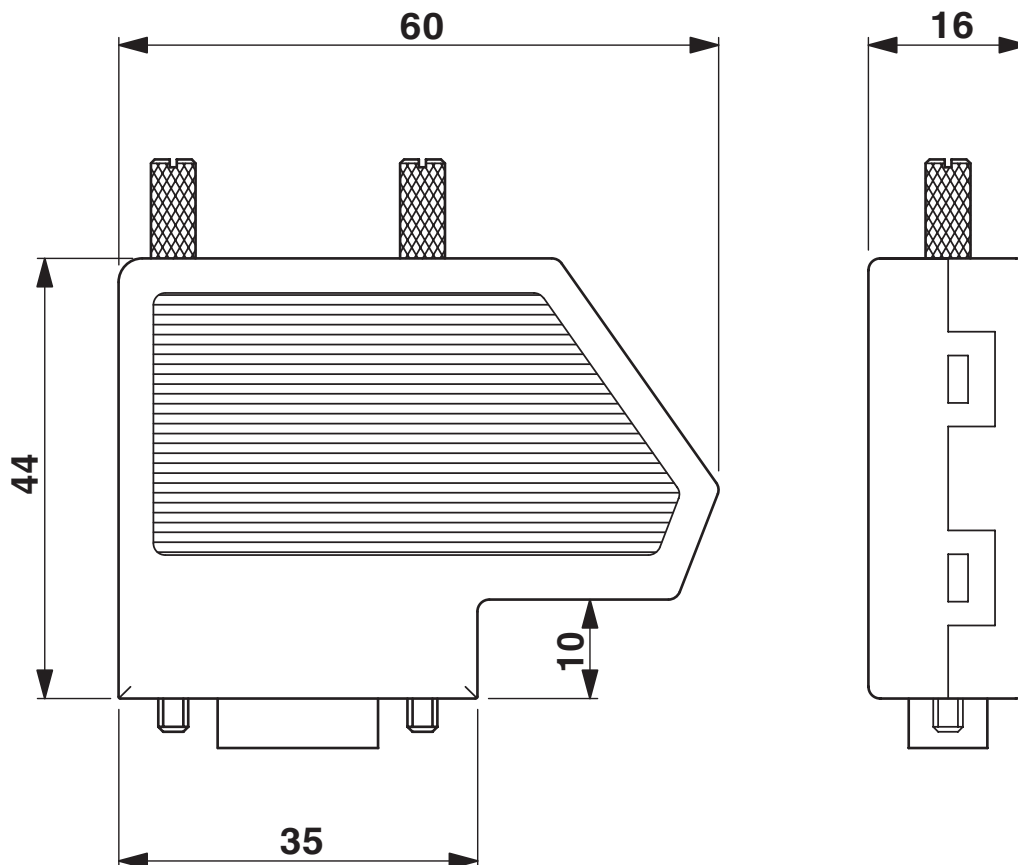

Dimensional drawing SUBCON-PLUS...



# SUBCON-PLUS M2 - D-SUB bus connector

2761839

<https://www.phoenixcontact.com/us/products/2761839>

Schematic diagram

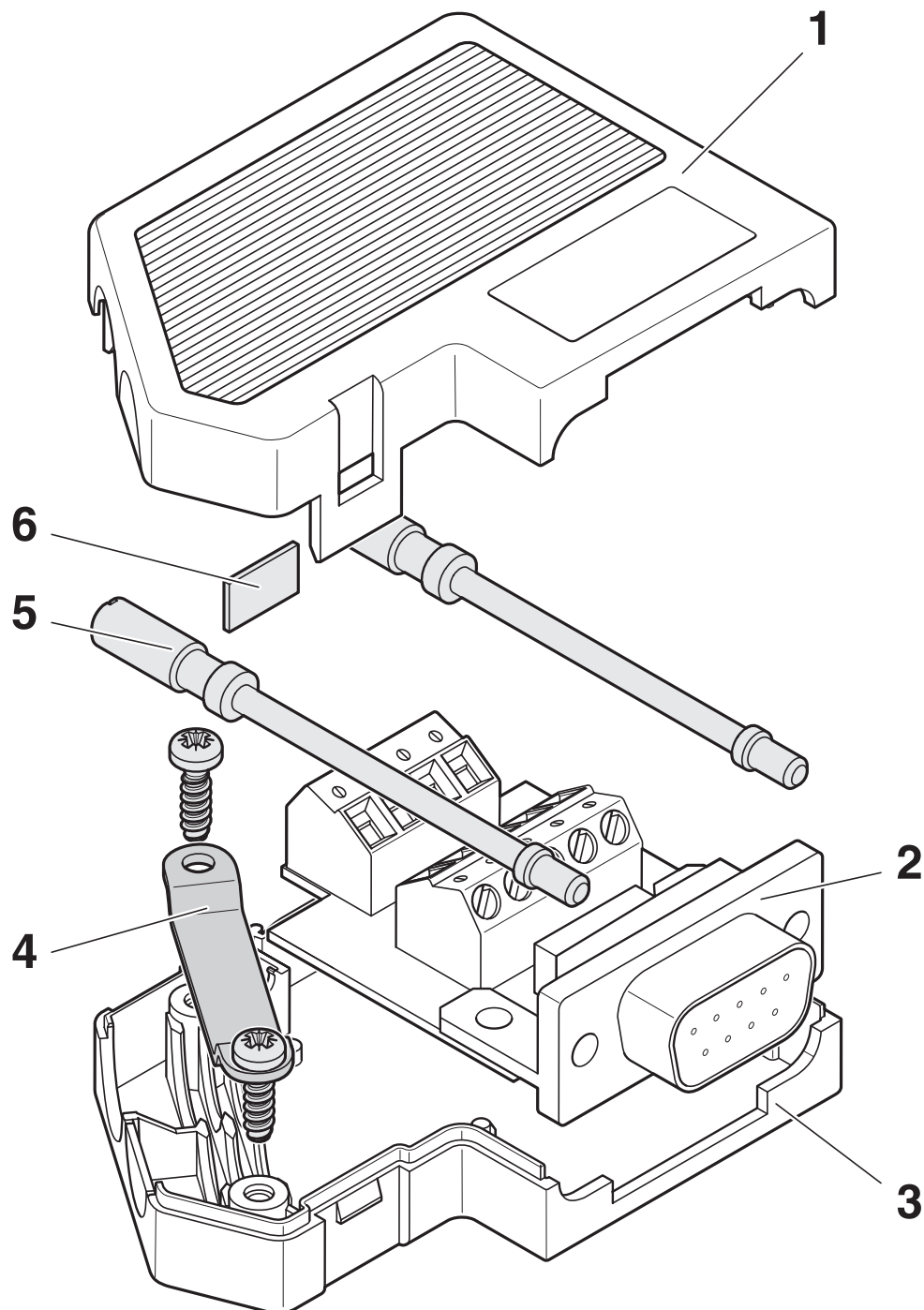

Function elements

# SUBCON-PLUS M2 - D-SUB bus connector



2761839

<https://www.phoenixcontact.com/us/products/2761839>

## Approvals

To download certificates, visit the product detail page: <https://www.phoenixcontact.com/us/products/2761839>



**cUL Recognized**  
Approval ID: FILE E 238705



**UL Recognized**  
Approval ID: FILE E 238705



**ATEX**  
Approval ID: PxCIF14ATEX2744267X

**cULus Recognized**

# SUBCON-PLUS M2 - D-SUB bus connector



2761839

<https://www.phoenixcontact.com/us/products/2761839>

## Classifications

### ECLASS

ECLASS-11.0	27440302
ECLASS-12.0	27440302
ECLASS-13.0	27440302

### ETIM

ETIM 9.0	EC001132
----------	----------

### UNSPSC

UNSPSC 21.0	39121400
-------------	----------

# SUBCON-PLUS M2 - D-SUB bus connector



2761839

<https://www.phoenixcontact.com/us/products/2761839>

## Environmental product compliance

EU RoHS	
Fulfills EU RoHS substance requirements	Yes, No exemptions
China RoHS	
Environment friendly use period (EFUP)	EFUP-E
	No hazardous substances above the limits
EU REACH SVHC	
REACH candidate substance (CAS No.)	No substance above 0.1 wt%

# SUBCON-PLUS M2 - D-SUB bus connector



2761839

<https://www.phoenixcontact.com/us/products/2761839>

## Accessories

### SUBCON-SHORT-SCREW - Screw

2799694

<https://www.phoenixcontact.com/us/products/2799694>



Optional mounting screw, without knurl for narrow installation conditions, slotted head, length: 40 mm, UNC 4-40 thread Supplied as standard: 1 bag of 20 screws

---

### SZF 0-0,4X2,5 - Screwdriver

1204504

<https://www.phoenixcontact.com/us/products/1204504>



Actuation tool, for ST terminal blocks, also suitable for use as a bladed screwdriver, size: 0.4 x 2.5 x 75 mm, 2-component grip, with non-slip grip

# SUBCON-PLUS M2 - D-SUB bus connector

2761839

<https://www.phoenixcontact.com/us/products/2761839>



## VS-09-GC-BU/BU - D-SUB gender changer

1688722

<https://www.phoenixcontact.com/us/products/1688722>

D-SUB gender changer, degree of protection: IP20, number of positions: 9, material: Metal, connection method: Coupling, cable outlet: angled, housing size: 1, Universal



---

Phoenix Contact 2024 © - all rights reserved

<https://www.phoenixcontact.com>

Phoenix Contact USA  
586 Fulling Mill Road  
Middletown, PA 17057, United States  
(+717) 944-1300  
[info@phoenixcon.com](mailto:info@phoenixcon.com)