

# HC-HPR-B06-HHWH-1TTM20-EM-BK - Housing



1411879

<https://www.phoenixcontact.com/us/products/1411879>

Please be informed that the data shown in this PDF document is generated from our online catalog. Please find the complete data in the user documentation. Our general terms of use for downloads are valid.



HEAVYCON B6 sleeve housing, HPR series, with screw locking, with M20 thread, straight outlet, for increased environmental and EMC requirements

## Your advantages

- Vibration and shock: IEC 61373/EN 50155, category 1, class 1B

## Commercial data

Item number	1411879
Packing unit	1 pc
Minimum order quantity	1 pc
Sales key	BF60
Product key	BF7AAI
Catalog page	Page 626 (C-4-2015)
GTIN	4046356944267
Weight per piece (including packing)	507 g
Weight per piece (excluding packing)	500 g
Customs tariff number	85389099
Country of origin	CN

## Technical data

### Notes

General	For contact inserts HC-B6, BB10, DD24, M Tall housings for extra large wiring space
---------	---

### Product properties

Product type	Housing with screw locking
Housing type	Sleeve housing
Product family	HC-HPR-B
Series	HPR-B6
Application	Railway applications
Type	B6
No. of cable outlets	1
Type of the screw connection	1x M20
Type	Tall design
Protective cover	no
Cable outlet	straight
Pg screw connection	none

### Dimensions

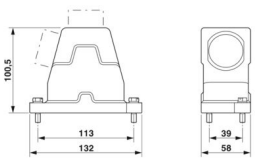
Dimensional drawing	
Width	58 mm
Height	100.5 mm
Length	132 mm

### Material specifications

Housing material	die-cast aluminum
Housing surface material	Powder-coated, black
Locking latch material	Stainless steel

### Environmental and real-life conditions

#### Ambient conditions

Degree of protection	IP66
	IP68 (0.5 bar / 24 h)
	IP69 (ISO 20653:2013-02)
Impact strength	IK09
Ambient temperature (operation)	-40 °C ... 125 °C

# HC-HPR-B06-HHWH-1TTM20-EM-BK - Housing



1411879

<https://www.phoenixcontact.com/us/products/1411879>

## Mechanical properties

Mechanical data	
Type of the screw connection	1x M20
Locking type	Screw

## Mounting

Assembly note	M6 locking screw, slotted hexagon head screw (SW10), tightening torque: 4 Nm
---------------	---

# HC-HPR-B06-HHWH-1TTM20-EM-BK - Housing

1411879

<https://www.phoenixcontact.com/us/products/1411879>



## Drawings

Dimensional drawing

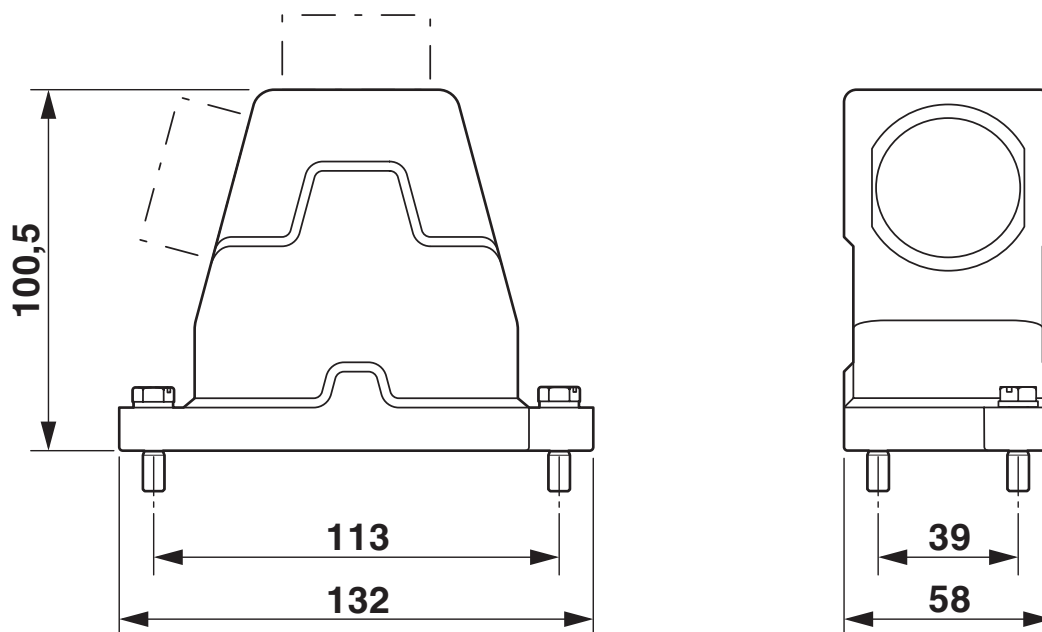

Dimensional drawing

1411879

<https://www.phoenixcontact.com/us/products/1411879>

## Approvals

🔗 To download certificates, visit the product detail page: <https://www.phoenixcontact.com/us/products/1411879>

### DNV

Approval ID: TAE000037S



### EAC

Approval ID: RU C-DE.AI30.B.01102



### EAC

Approval ID: RU C-DE.BL08.B.00511

Classifications

ECLASS

ECLASS-11.0	27440202
ECLASS-12.0	27440202
ECLASS-13.0	27440202

ETIM

ETIM 9.0	EC000437
----------	----------

UNSPSC

UNSPSC 21.0	31261500
-------------	----------

Environmental product compliance

EU RoHS	
Fulfills EU RoHS substance requirements	Yes, No exemptions
China RoHS	
Environment friendly use period (EFUP)	EFUP-E
	No hazardous substances above the limits
EU REACH SVHC	
REACH candidate substance (CAS No.)	No substance above 0.1 wt%

# HC-HPR-B06-HHWH-1TTM20-EM-BK - Housing



1411879

<https://www.phoenixcontact.com/us/products/1411879>

## Accessories

### G-INS-M20-S68N-PNES-GY - Cable gland

1411125

<https://www.phoenixcontact.com/us/products/1411125>



Cable gland, material for screw connection: PA, application: Standard, external cable diameter 6 mm ... 12 mm, shielding: no, connecting thread: M20 x 1.5, color: silver-grey RAL 7001

---

### G-INS-M20-S68N-PNES-BK - Cable gland

1411133

<https://www.phoenixcontact.com/us/products/1411133>



Cable gland, material for screw connection: PA, application: Standard, external cable diameter 6 mm ... 12 mm, shielding: no, connecting thread: M20 x 1.5, color: jet black RAL 9005



# HC-HPR-B06-HHWH-1TTM20-EM-BK - Housing

1411879

<https://www.phoenixcontact.com/us/products/1411879>



## G-INS-M20-S68N-NNES-S - Cable gland

1411163

<https://www.phoenixcontact.com/us/products/1411163>



Cable gland, material for screw connection: Brass, nickel-plated, application: Standard, external cable diameter 6 mm ... 12 mm, shielding: no, connecting thread: M20 x 1.5, color: silver, with O-ring

---

## HC-M-KV-M20(11-16) - Cable gland

1645998

<https://www.phoenixcontact.com/us/products/1645998>



Metal screw connection up to 5 bar, thread length: 6 mm, cable diameter: 11 - 16 mm, WAF 27, screw connection: M20

# HC-HPR-B06-HHWH-1TTM20-EM-BK - Housing



1411879

<https://www.phoenixcontact.com/us/products/1411879>

## G-INSEC-M20-S68N-NCRS-S - Cable gland

1411189

<https://www.phoenixcontact.com/us/products/1411189>



Cable gland, material for screw connection: Brass, nickel-plated, application: EMC, external cable diameter 9 mm ... 13 mm, shielding: yes, connecting thread: M20 x 1.5, color: silver, with O-ring

---

## G-INESR-M20-S68N-NEPDS-S - Cable gland

1415192

<https://www.phoenixcontact.com/us/products/1415192>



Cable gland, material for screw connection: Brass, nickel-plated, application: Standard, external cable diameter 6 mm ... 13 mm, shielding: no, connecting thread: M20 x 1.5, color: silver, with external strain relief, with O-ring

# HC-HPR-B06-HHWH-1TTM20-EM-BK - Housing



1411879

<https://www.phoenixcontact.com/us/products/1411879>

## HC-M-KV-T-M20 - Cable gland

1646188

<https://www.phoenixcontact.com/us/products/1646188>

Metal screw connection with cable bend protection and strain relief, thread length: 6 mm, cable sealing area: 7.5 - 15 mm, clamping area: 10 - 16 mm, SW 24, screw connection: M20



---

## REDUC-M-KV-M20/M16 - Reducing adapter

1647611

<https://www.phoenixcontact.com/us/products/1647611>

Reducing adapter, connecting thread: M20 x 1.5, color: silver, with O-ring



# HC-HPR-B06-HHWH-1TTM20-EM-BK - Housing



1411879

<https://www.phoenixcontact.com/us/products/1411879>

## ENLAR-M-KV-M20/M25 - Extension adapter

1647666

<https://www.phoenixcontact.com/us/products/1647666>

Extension adapter, connecting thread: M20 x 1.5, color: silver, with O-ring



---

## HC-M-BS-M20 - Screw plug

1645846

<https://www.phoenixcontact.com/us/products/1645846>

Screw plug, material for screw connection: Brass, nickel-plated, connecting thread: M20 x 1.5, color: silver



# HC-HPR-B06-HHWH-1TTM20-EM-BK - Housing



1411879

<https://www.phoenixcontact.com/us/products/1411879>

## US-EMLP-HA (20X9) - Plastic label

0830989

<https://www.phoenixcontact.com/us/products/0830989>



Plastic label, Card, white, unlabeled, can be labeled with: BLUEMARK ID COLOR, BLUEMARK ID, THERMOMARK PRIME, THERMOMARK CARD 2.0, THERMOMARK CARD, mounting type: adhesive, lettering field size: 20 x 9 mm, Number of individual labels: 70

---

## US-EMLP-HA (20X9) CUS - Plastic label

0830995

<https://www.phoenixcontact.com/us/products/0830995>



Plastic label, Card, white, labeled, can be labeled with: THERMOMARK CARD, mounting type: adhesive, lettering field size: 20 x 9 mm, Number of individual labels: 70

# HC-HPR-B06-HHWH-1TTM20-EM-BK - Housing

1411879

<https://www.phoenixcontact.com/us/products/1411879>



## WP-G HF IP66 M20 BK - Screw connection

3240898

<https://www.phoenixcontact.com/us/products/3240898>



Cable gland, metric thread, IP66 protection, straight

---

## WP-G HF IP69K M20 BK - Screw connection

3240884

<https://www.phoenixcontact.com/us/products/3240884>



Cable gland, metric thread, IP68/69k protection, straight

# HC-HPR-B06-HHWH-1TTM20-EM-BK - Housing

1411879

<https://www.phoenixcontact.com/us/products/1411879>



## WP-GA HF IP66 M20 BK - Screw connection

3240926

<https://www.phoenixcontact.com/us/products/3240926>

Cable gland, metric thread, IP66 protection, angled



---

## WP-GA HF IP69K M20 BK - Screw connection

3240912

<https://www.phoenixcontact.com/us/products/3240912>

Cable gland, metric thread, IP68/69k protection, angled



# HC-HPR-B06-HHWH-1TTM20-EM-BK - Housing

1411879

<https://www.phoenixcontact.com/us/products/1411879>



## WP-GR HF IP66 M20 BK - Screw connection

3240954

<https://www.phoenixcontact.com/us/products/3240954>



Cable gland, metric thread, IP66 protection, with strain relief

---

## WP-GR HF IP69K M20 BK - Screw connection

3240940

<https://www.phoenixcontact.com/us/products/3240940>



Cable gland, metric thread, IP68/69k protection, with strain relief



# HC-HPR-B06-HHWH-1TTM20-EM-BK - Housing



1411879

<https://www.phoenixcontact.com/us/products/1411879>

## WP-G PP HF M20 - Screw connection

3240998

<https://www.phoenixcontact.com/us/products/3240998>

Cable gland made from PP with metric thread, IP65 protection



---

## WP-GT PP HF M20 - Screw connection

3241012

<https://www.phoenixcontact.com/us/products/3241012>

Cable gland made from PP with metric thread, rotatable, IP54 protection



# HC-HPR-B06-HHWH-1TTM20-EM-BK - Housing



1411879

<https://www.phoenixcontact.com/us/products/1411879>

## WP-G BRASS IP40 M20 - Screw connection

3241047

<https://www.phoenixcontact.com/us/products/3241047>

Cable gland made from brass with metric thread, IP40 protection



---

## WP-GT BRASS M20 - Screw connection

3241033

<https://www.phoenixcontact.com/us/products/3241033>

Cable gland made from brass with metric thread, rotatable, IP40 protection



# HC-HPR-B06-HHWH-1TTM20-EM-BK - Housing

1411879

<https://www.phoenixcontact.com/us/products/1411879>



## WP-G BRASS IP65 M20 - Screw connection

3241061

<https://www.phoenixcontact.com/us/products/3241061>



Cable gland made from brass with metric thread, IP65 protection

---

Phoenix Contact 2024 © - all rights reserved

<https://www.phoenixcontact.com>

Phoenix Contact USA  
586 Fulling Mill Road  
Middletown, PA 17057, United States  
(+717) 944-1300  
[info@phoenixcon.com](mailto:info@phoenixcon.com)