



Summary

[Request a quote](#)

[Catalog](#)

Number of contacts Low Voltage	5
Wire Size/AWG	26 - 22
Gender	Standard
Socket / Receptacle	Socket / Receptacle - Free
Locking system	Push-pull
Jacket cable outside diameter [mm]	3.80 - 9.00 mm
Size	0F
Series	F - Rugged Push-Pull

Technical details

https://www.lemo.com/int_en/solutions/optima/f-rugged-push-pull/php-0f-305-nlm.html

LEMO products and services are provided "as is". LEMO makes no warranties or representations with regard to LEMO product & services or use of them, express, implied or statutory, including for accuracy, completeness, or security. The user is fully responsible for his products and applications using LEMO components.

Electrical Configuration

Contact Termination Low voltage	Crimp
R (max)	6.1 mOhm
Insert configuration value	0F.305 - 5 Low Voltage
Insulator	L: PEEK (UL 94 / V-0/1.5)
Rated current	6.5 Amps
Vtest (contact-contact)	1250 V (AC), 1770 V (DC)
Vtest (contact-shell)	1200 V (AC), 1700 V (DC)
Contact retention	22 N
Contact Type	Crimp
Max. Conductor	0.34 mm ² (AWG 22)
Min. Conductor	0.14 mm ² (AWG 26)
Bucket Dia.	0.8 mm (0.031in)
Contact Dia.	0.7 mm (0.028in)
Number of contacts Low Voltage	5
Wire Size/AWG	26 - 22
Gender	Standard

Form & Material

Shell style / Model id	PH - Straight receptacle
Socket / Receptacle	Free
Locking system	Push-pull
Keying	3 keys (beta=150, gamma=60, plug: male contacts, receptacle: female contacts)
Weight	11.09 g

Environment

Technical domain	Motorsport, Security and Defence
Environmental sealing (IP rating)	IP67
Salt Spray Corrosion	>144 hr

Cable fixation

Cable termination protection	Standard back nut (no additional protection)
Fixation type	Cable collet
Jacket cable outside diameter [mm]	3.80 - 9.00 mm

https://www.lemo.com/int_en/solutions/optima/f-rugged-push-pull/php-0f-305-nlm.html

LEMO products and services are provided "as is". LEMO makes no warranties or representations with regard to LEMO product & services or use of them, express, implied or statutory, including for accuracy, completeness, or security. The user is fully responsible for his products and applications using LEMO components.

Drawings

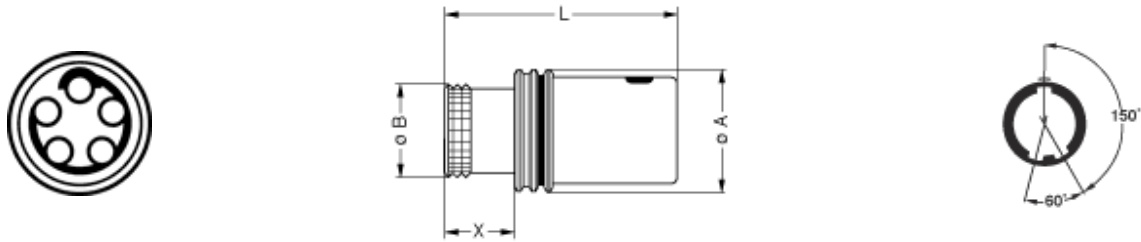

Dimensions

	B	A	L	X
mm.	9	12	26.7	8
in.	0.35	0.47	1.05	0.31

Recommended By Lemo

Accessories

Replacement contact [EGG.0B.655.ZZM](#)

Tools

Positionner [DCE.91.070.BVM](#)

Extraction tool [DCF.93.070.4LT](#)

Crimp tool [DPC.91.701.V](#)

Cables

Cable PartNumber	Material	Colour	Cable image
CMN.05.T22.051QGZE	TPR (medical)	Grey	
150250	PVC	Grey	
50090	PVC	Black	
50140	PVC	Grey	

https://www.lemo.com/int_en/solutions/optima/f-rugged-push-pull/php-0f-305-nlm.html

LEMO products and services are provided "as is". LEMO makes no warranties or representations with regard to LEMO product & services or use of them, express, implied or statutory, including for accuracy, completeness, or security. The user is fully responsible for his products and applications using LEMO components.