

GlobTek, Inc. www.globtek.com 186 Veterans Drive, Northvale, NJ 07647 Tel. (201) 784-1000 Fax (201) 784-0111	Drawing Title: Low voltage cable, , Efficiency Level: , Case Color/Style: GlobTek Black, , , Input Rating: , , Output Rating: W, 0.0V@0.0A, Output Configuration: mm, / Cond, , , Ferrite: , , GT Cord #, Pin Out: , Blades/Input Cord: , Approvals: to , GT Cable #:	
	Model No. Low voltage cable	
	Part No./Ordering No. T-S-S-11(R)	Rev A1

In Addition to GlobTek Inc.'s renewed ISO9001:2008 - Quality Management System Certification, GlobTek Inc. is now certified to:

ISO13485:2003 - Medical Devices Quality Management System Certification
ISO14001:2004 - Environmental Management System Certification

ISO Certificates are available online at <http://www.globtek.com/iso-certificates/>

The acceptance of this specification and use of the product described in this document indicates the acceptance and binding of the customer to Globtek TERMS AND CONDITIONS (attached to the end of this document), which supersede all other agreements, terms, and conditions (<http://www.globtek.com/terms-and-conditions/>).

Prop 65 Statement:<https://www.globtek.com/prop-65-statement.pdf>

Footnote:

GlobTek Inc. will not be liable for the safety and performance of these power supplies if unauthorized access and repair occurs. End user should consult applicable UL, CSA or EN standards for proper installation instruction.

Limitation of Use:

GlobTek products are intended for use with commercial, medical, and/or industrial equipment only. GlobTek product are not authorized for use as mission critical components in life support hazardous environment, nuclear or aircraft applications without prior written approval from the CEO of GlobTek Inc.

Contents of this document are subject to change without prior notice.

Customer Approval of Specification:

Please approve, sign and send back to GlobTek so we can complete order processing.
A delay in receipt of this form will delay delivery schedule.

Company Name:	Customer P/N:
Quote Number:	Date:
Authorized Representative Name:	Authorized Representative Signature:

GlobTek, Inc. www.globtek.com 186 Veterans Drive, Northvale, NJ 07647 Tel. (201) 784-1000 Fax (201) 784-0111	Drawing Title: Low voltage cable, , Efficiency Level: , Case Color/Style: GlobTek Black, , , Input Rating: , , Output Rating: W, 0.0V@0.0A, Output Configuration: mm, / Cond, , , Ferrite: , , GT Cord #, Pin Out: , Blades/Input Cord: , Approvals: to , GT Cable #:			
	Model No. Low voltage cable			
	Part No./Ordering No. T-S-S-11(R)			Rev A1

REVISION HISTORY

REV	DESCRIPTION	SUB	DATE	APPROVED
A1	Recover drawing	QA	07/07/2021	QA
A	Initial release	DR	07/21/2020	DAVID

AGENCY ONLINE DOCUMENTS

RoHS/RoHS3 Declaration	https://www.globtek.com/pdf/rohs_cert/01t3a000004vbfNAAQ
REACH Declaration	https://www.globtek.com/r2/eM2co8
Conflict Minerals Declaration	https://www.globtek.com/r2/SNw6P3
Prop 65 Statement	https://www.globtek.com/r2/VMPRnr

IPXY rating is based on 3rd party testing and customers should check suitability and test system level IPXY rating before ordering.

<p>GlobTek, Inc. www.globtek.com 186 Veterans Drive, Northvale, NJ 07647 Tel. (201) 784-1000 Fax (201) 784-0111</p>	<p>Drawing Title: Low voltage cable, , Efficiency Level: , Case Color/Style: GlobTek Black, , Input Rating: , , Output Rating: W, 0.0V@0.0A, Output Configuration: mm, / Cond, , Ferrite: , , GT Cord #, Pin Out: , Blades/Input Cord: , Approvals: to , GT Cable #:</p>		
	<p>Model No. Low voltage cable</p>		
	<table> <tr> <td data-bbox="305 170 1310 270"> <p>Part No./Ordering No. T-S-S-11(R)</p> </td><td data-bbox="1310 170 1546 270"> <p>Rev A1</p> </td></tr> </table>	<p>Part No./Ordering No. T-S-S-11(R)</p>	<p>Rev A1</p>
<p>Part No./Ordering No. T-S-S-11(R)</p>	<p>Rev A1</p>		

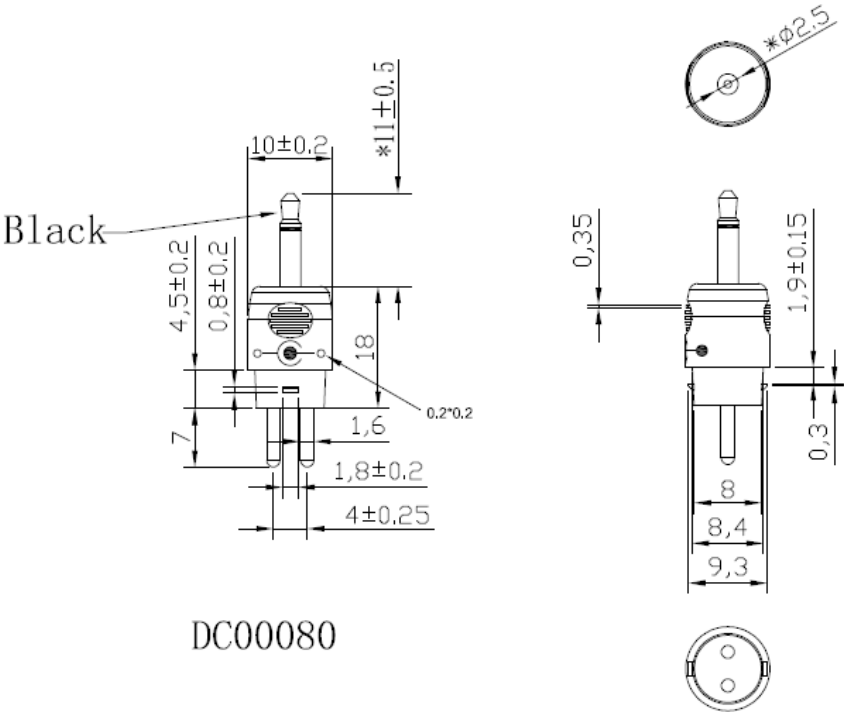

Packaging:

- 1.Qty: 50 pcs per PE Vacuum Sealed bag.
- 2.Bag Dimensions: 200*110 mm

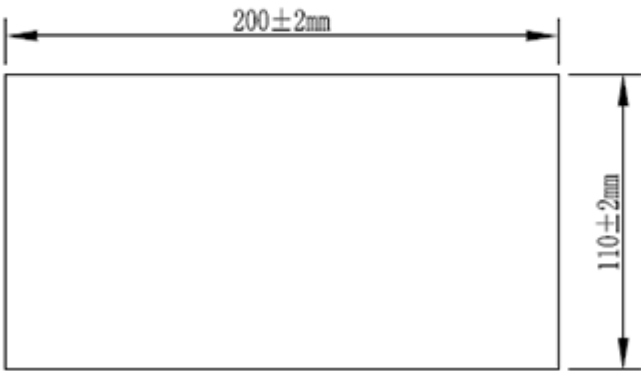

Mates with: MJ1-2503A, MJ-2523-SMT-TR, MJ-2523-SMT-TR, MJ-2523-SMT-TR, MJ1-2510-SMT-TR, MJ1-2510-SMT-TR, MJ1-2510-SMT-TR, MJ-2506N, MJ-2509N, 4831.22, RH1041OR-MFPGNL, 50-00033, MJ-2508, J2-25102B-SMT-TR, SJ2-25102B-SMT-TR, MR-2501, MJ-2507, MJ1-2533-SMT-TR, MJ1-2533-SMT-TR, SJ2-25102B-SMT-TR, 4831.223, MJ-2508N, MJ-2506, MJ1-2502, 4831.32

GlobTek, Inc. www.globtek.com 186 Veterans Drive, Northvale, NJ 07647 Tel. (201) 784-1000 Fax (201) 784-0111	Drawing Title: Low voltage cable, Efficiency Level: , Case Color/Style: GlobTek Black, , Input Rating: , , Output Rating: W, 0.0V@0.0A, Output Configuration: mm, / Cond, , , Ferrite: , , GT Cord #, Pin Out: , Blades/Input Cord: , Approvals: to , GT Cable #:	
	Model No. Low voltage cable	
	Part No./Ordering No. T-S-S-11(R)	Rev A1

PACKAGING

Packing Spec P/N:	
Box Qty:	1000
Gift Box Size (mm):	
Gift Box Color:	White
Master Carton Size (mm):	TBD
Master Carton Cubic Volume (m³): 0.00	
Master GW (Kg):	kg
wt Ea. (Kg):	kg
wt Ea. (Kg):	kg
LABEL SPECS: ,	
PACK SPEC:	