

(*=NOT TOOLED)

No. POS PER ROW	"B" (REF)		"C" (REF)		"D"	"E"+/- .0050	
-01	0.328	[8.32]	0.228	[5.78]	N/A	N/A	N/A
-02	0.485	[12.32]	0.385	[9.78]	1	0.1575	[4.001]
-04	0.800	[20.32]	0.700	[17.78]	3	0.4725	[12.002]
-06	1.115	[28.32]	1.015	[25.78]	5	0.7875	[20.003]
-08	1.430	[36.32]	1.330	[33.78]	7	1.1025	[28.004]
-10	1.745	[44.32]	1.645	[41.78]	9	1.4175	[36.005]

(* = NOT TOOLED)

-TAIL OPTION	"F"	
-1	0.060	[1.52]
*-2	0.090	[2.29]

(* = NOT TOOL FD)

1.  REPRESENTS A CRITICAL DIMENSION.
2. MINIMUM PUSH OUT FORCE .5 LBS. [0.23 Kg.]
3. FOR QUANTITIES UP TO 49 PCS., NO LEADER, TRAILER OR REEL WILL BE SUPPLIED,
FOR QUANTITIES OF 50 TO 124 PCS., NO LEADER OR TRAILER WILL BE SUPPLIED.
4. -01 POSITION NOT AVAILABLE WITH -D ROW OPTION
5. -L: CABLE LATCH OPTION ONLY AVAILABLE IN -.05.0 LEAD STYLE & -S ROW OPTION.
6. LOAD WELD TAB WITH LANCES FACING INWARD.

-S: SELECTIVE, 30 Au / 50 Ni MIN ON CONTACT, MATTE TIN TAIL
-L: LIGHT SELECTIVE, 10 Au / 50 Ni MIN ON CONTACT, MATTE TIN TAIL

	IJ5-XX-05.0-X-X-X-GP 5.0MM [0.196]
IP5 LEAD STYLE	STACK HEIGHT
*IP5-XX-03.0-X-X-X-X	8.0MM [0.315]
*IP5-XX-04.0-X-X-X-X	9.0MM [0.354]
IP5-XX-05.0-X-X-X-X	10.0MM [0.394]
*IP5-XX-06.0-X-X-X-X	11.0MM [0.433]
*IP5-XX-07.0-X-X-X-X	12.0MM [0.472]
*IP5-XX-08.0-X-X-X-X	13.0MM [0.512]
*IP5-XX-09.0-X-X-X-X	14.0MM [0.551]
*IP5-XX-10.0-X-X-X-X	15.0MM [0.591]
*IP5-XX-11.0-X-X-X-X	16.0MM [0.630]

(* = NOT TOOLED)

BY: PIERCE	11/10/2007	SHEET 1 OF 3
------------	------------	--------------

F:\DWG\MISC\Mktg\IP5-XX-XX.X-X-X-X-X-TR-MKT.SLDDRW

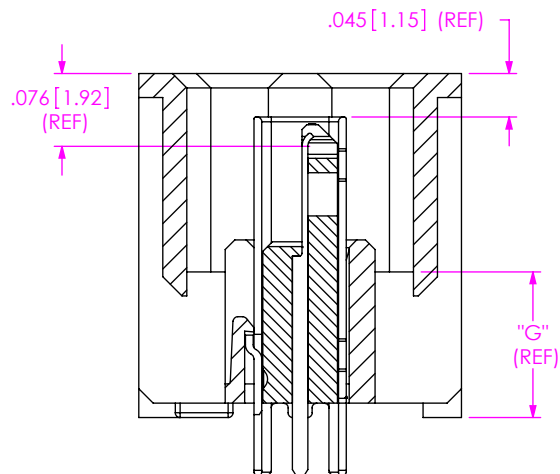

SECTION "A"-"A"
SCALE 5:1

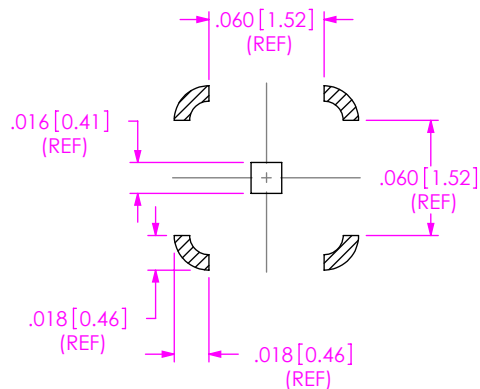

SECTION "B"-"B"
SCALE 10:1

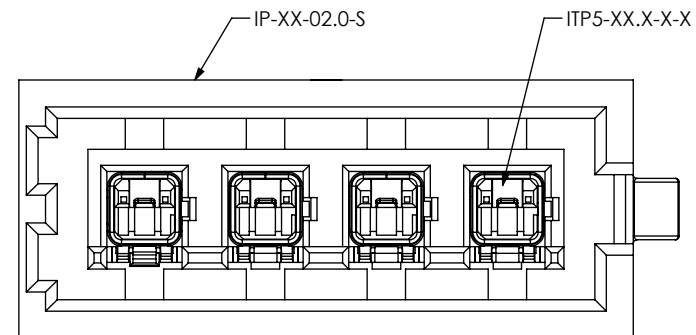

FIG.3
(IP5-04-02.0-L-S-X SHOWN)
(SAME AS FIG. 1, EXCEPT AS SHOWN)

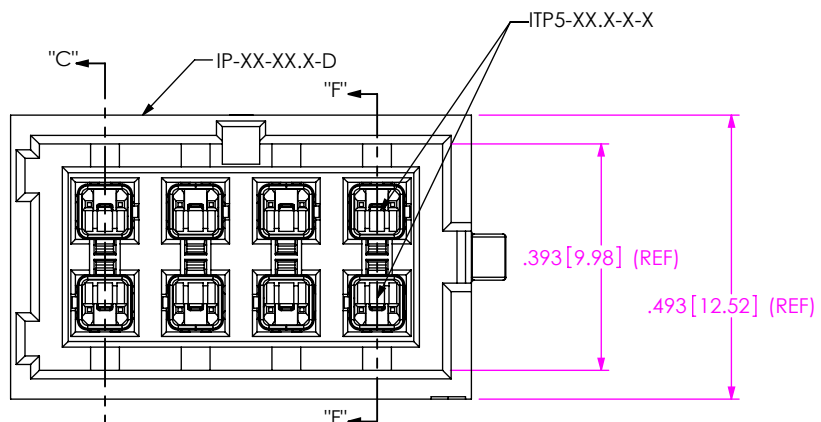
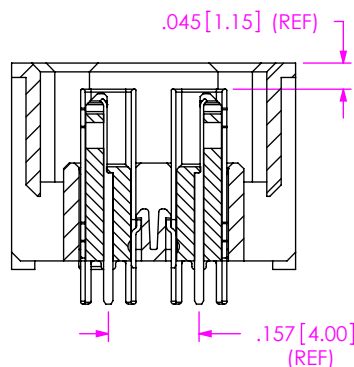
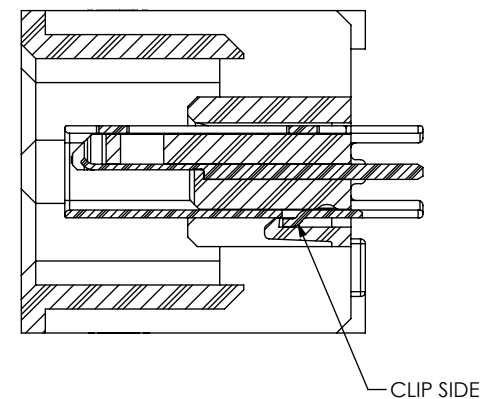

FIG.2
(IP5-04-XX.X-L-D-X SHOWN)
(SAME AS FIG. 1, EXCEPT AS SHOWN)



SECTION "C"-"C"
SCALE 3:1



SECTION "G"-"G"
SCALE 5:1

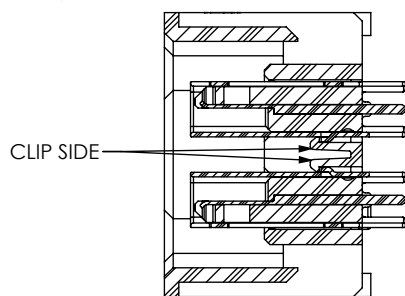

SECTION "F"-"F"
SCALE 3:1

PROPRIETARY NOTE
THIS DOCUMENT CONTAINS INFORMATION
CONFIDENTIAL AND PROPRIETARY TO
SAMTEC, INC. AND SHALL NOT BE REPRODUCED
OR TRANSFERRED TO OTHER DOCUMENTS OR
DISCLOSED TO OTHERS OR USED FOR ANY
PURPOSE OTHER THAN THAT WHICH IT WAS
OBTAINED WITHOUT THE EXPRESSED WRITTEN
CONSENT OF SAMTEC, INC.

DO NOT SCALE DRAWING

SHEET SCALE: 4:1

samtec

520 PARK EAST BLVD, NEW ALBANY, IN 47150
PHONE: 812-944-6733 FAX: 812-948-5047
e-Mail: info@SAMTEC.com code: 55322

DESCRIPTION:
TERMINAL ARRAY ASSEMBLY, IP5 CONNECTOR

DWG. NO. IP5-XX-XX.X-X-X-X-X-TR

BY: PIERCE 11/10/2007 SHEET 2 OF 3

