

TABLE 2					
POSITION	"A"	"B"	"C"	"D"	"E"
-005	16.00 [.630]	8.32 [.328]	3.20 [.126]	3.20 [.126]	13.00 [.512]
-010	20.00 [.787]	12.32 [.485]	7.20 [.284]	7.20 [.284]	17.00 [.765]
-013	22.40 [.882]	14.72 [.580]	9.60 [.378]	9.60 [.378]	19.40 [.669]
-020	28.00 [1.102]	20.32 [.800]	15.20 [.598]	15.20 [.598]	25.00 [.984]
-025	32.00 [1.260]	24.32 [.960]	19.20 [.760]	19.20 [.760]	29.00 [1.142]
-030	36.00 [1.417]	28.32 [1.115]	23.20 [.913]	23.20 [.913]	33.00 [1.299]
-037	39.20 [1.543]	31.52 [1.241]	26.40 [1.039]	26.40 [1.039]	36.20 [1.425]
-040	44.00 [1.732]	36.32 [1.430]	31.20 [1.228]	31.20 [1.228]	41.00 [1.614]
-049	51.20 [2.016]	43.52 [1.713]	38.40 [1.512]	38.40 [1.512]	48.20 [1.898]
-050	52.00 [2.047]	44.32 [1.745]	39.20 [1.543]	39.20 [1.543]	49.00 [1.929]
-060	60.00 [2.362]	52.32 [2.060]	47.20 [1.858]	47.20 [1.858]	57.00 [2.244]
-070	68.00 [2.677]	60.32 [2.375]	55.20 [2.173]	55.20 [2.173]	65.00 [2.559]
-075	72.00 [2.835]	64.32 [2.532]	59.20 [2.331]	59.20 [2.331]	69.00 [2.717]

TABLE 3		
-DV P/N	-EM P/N	"F"
ERM8-XXX-02.0-X-DV	ERF8-XXX-X-D-EMX	8.800
ERM8-XXX-05.0-X-DV	ERF8-XXX-X-D-EMX	11.800
ERM8-XXX-08.0-X-DV	ERF8-XXX-X-D-EMX	14.800
ERM8-XXX-09.0-X-DV	ERF8-XXX-X-D-EMX	15.800
*ERM8-XXX-15.0-X-DV	ERF8-XXX-X-D-EMX	21.800

(* = NOT TOOLED)

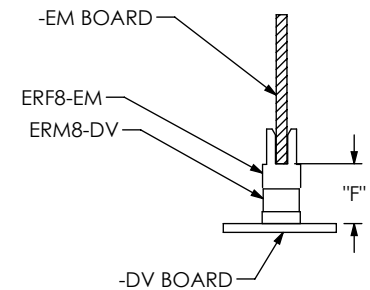

FIG 2
(ERF8-EM TO ERM8-DV)
(SHOWING CIRCUIT BOARD SEPARATION)

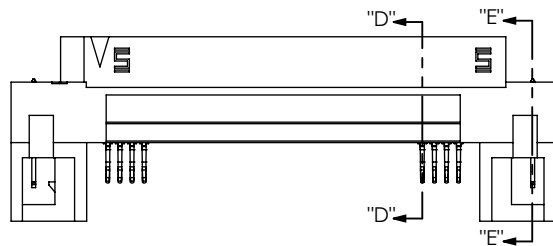
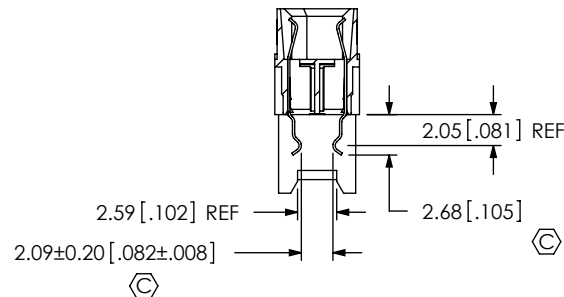
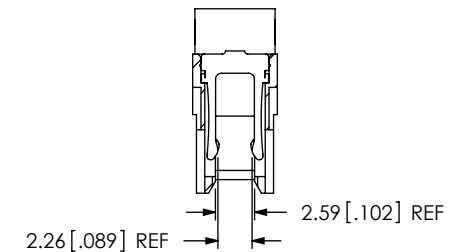

FIG 4
(ERF8-XXX-01-X-D-EM3-XX)
(SAME AS FIG 1, EXCEPT AS SHOWN)
(*NOT TOOLED)



SECTION "D"-"D"
SCALE 2:1



SECTION "E"-"E"
SCALE 2:1

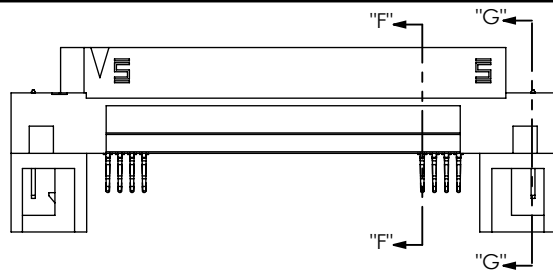
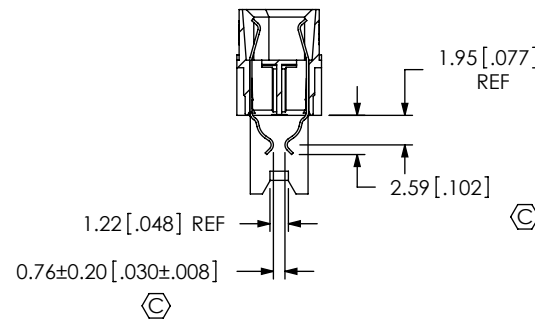
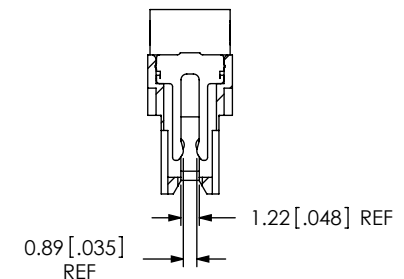

FIG 5
(ERF8-XXX-01-X-D-EM4-XX)
(SAME AS FIG 1, EXCEPT AS SHOWN)
(-005 POSITION NOT TOOLED)



SECTION "F"-"F"
SCALE 2:1



SECTION "G"-"G"
SCALE 2:1

PROPRIETARY NOTE

THIS DOCUMENT CONTAINS INFORMATION
CONFIDENTIAL AND PROPRIETARY TO
SAMTEC, INC. AND SHALL NOT BE REPRODUCED
OR TRANSFERRED TO OTHER DOCUMENTS OR
DISCLOSED TO OTHERS OR USED FOR ANY
PURPOSE OTHER THAN THAT WHICH IT WAS
OBTAINED WITHOUT THE EXPRESSED WRITTEN
CONSENT OF SAMTEC, INC.

DO NOT SCALE DRAWING

SHEET SCALE: 1:1

samtec

520 PARK EAST BLVD, NEW ALBANY, IN 47150
PHONE: 812-944-6733 FAX: 812-948-5047
e-Mail: info@SAMTEC.com code 55322

DESCRIPTION:

.8MM EDGE RATE-EM SOCKET ASSEMBLY

DWG. NO.

ERF8-XXX-01-X-D-EMX-XXXX-TR

BY: KNOWLDEN 09/26/2006 SHEET 2 OF 3

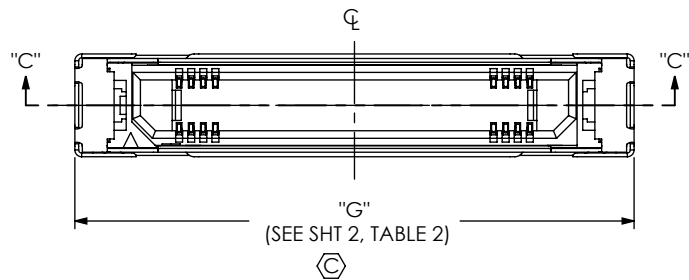

ERF8-XXX-D-EMX-XX
(SEE SHT 1, TABLE 1)

SH29-XX-05-X

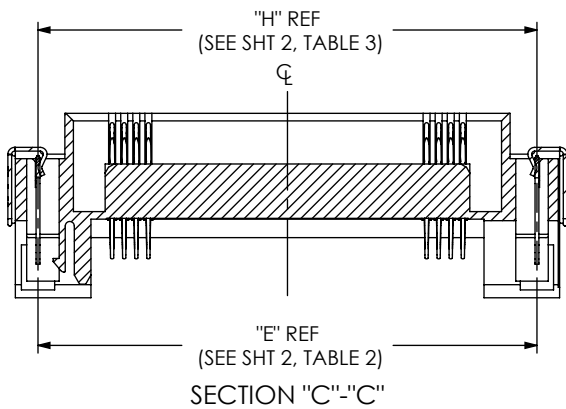
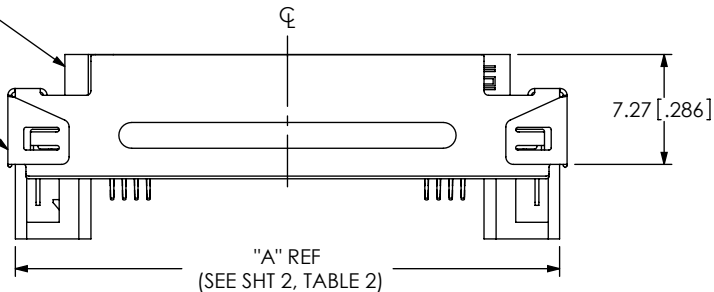
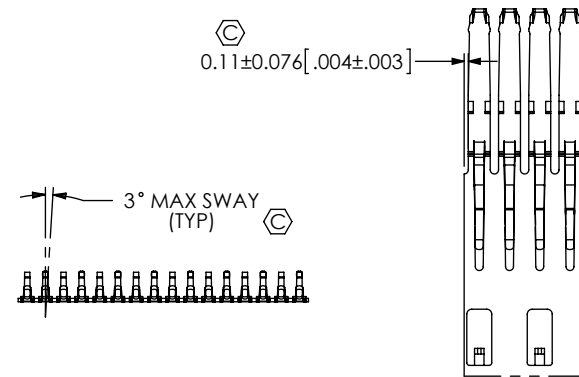

FIG 3
(ERF8-030-01-X-D-EM2-EGPS SHOWN)
(SAME AS FIG 1, EXCEPT AS SHOWN)



C-221-XX.X-X IN-PROCESS VIEW

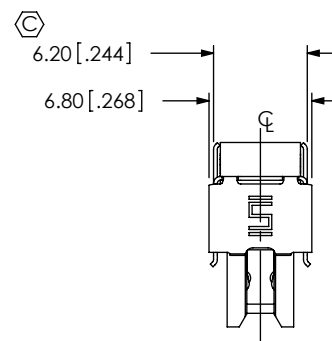

TABLE 4				
No. OF POS.	"G"		"H"	
-10	21.0	[0.83]	17.00	[0.669]
-20	29.0	[1.14]	25.00	[0.984]
-25	33.0	[1.30]	29.00	[1.142]
-30	37.0	[1.46]	33.00	[1.299]

PROPRIETARY NOTE

THIS DOCUMENT CONTAINS INFORMATION
CONFIDENTIAL AND PROPRIETARY TO
SAMTEC, INC. AND SHALL NOT BE REPRODUCED
OR TRANSFERRED TO OTHER DOCUMENTS OR
DISCLOSED TO OTHERS OR USED FOR ANY
PURPOSE OTHER THAN THAT WHICH IT WAS
OBTAINED WITHOUT THE EXPRESSED WRITTEN
CONSENT OF SAMTEC, INC.

DO NOT SCALE DRAWING

SHEET SCALE: 2:1

samtec

520 PARK EAST BLVD, NEW ALBANY, IN 47150
PHONE: 812-944-6733 FAX: 812-948-5047
e-Mail info@SAMTEC.com code 55322

DESCRIPTION:

.8MM EDGE RATE-EM SOCKET ASSEMBLY

DWG. NO.

ERF8-XXX-01-X-D-EMX-XXXX-TR

BY: KNOWLDEN09/26/2006

SHEET 3 OF 3