

E SERIES PART NUMBERING SYSTEM

CONNECTOR PART NUMBER SCHEME

Series	Pins/ Contacts	Gender	Fas-disconnect Option	Termination Style	Housing Finish	Terminal Finish	Mounting Hole Options
E	3-5 pins	F: Female M: Male	D: Fas-disconnect Blank: Standard locking	ST: Straight PC terminals RA: Right angle PC terminals SC: Solder cups Blank: Conical springs*	B: Black Blank: Nickel	AU: Gold Blank: Silver	M3: M3 x 0.5 thread 440: #4-40 thread Blank: Counter- sunk hole

HOUSING ONLY PART NUMBER SCHEME

Series	Pins/ Contacts	Housing Finish	Mounting Hole Options
E	F: Female M: Male	B: Black Blank: Nickel	M3: M3 x 0.5 thread 440: #4-40 thread Blank: Counter-sunk hole

INSERT ONLY PART NUMBER SCHEME

Series	Pins/ Contacts	Gender	Fas-disconnect Option	Termination Style	Housing Finish	Terminal Finish
E	3-5 pins	F: Female M: Male	D: Fas-disconnect Blank: Standard locking	ST: Straight PC terminals RA: Right angle PC terminals SC: Solder cups Blank: Conical springs*		AU: Gold Blank: Silver

*3-pin only

DIMENSIONS ARE FOR REFERENCE ONLY $\frac{\text{Inch}}{(\text{mm})}$

Switchcraft, Inc.

E Series

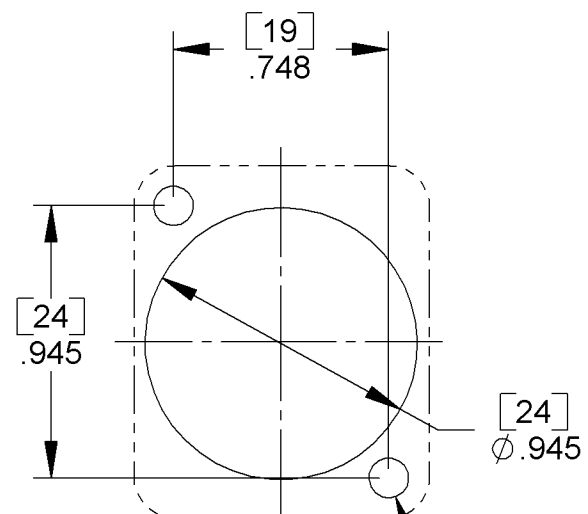

PANEL CUT-OUT
FRONT OR REAR MOUNT

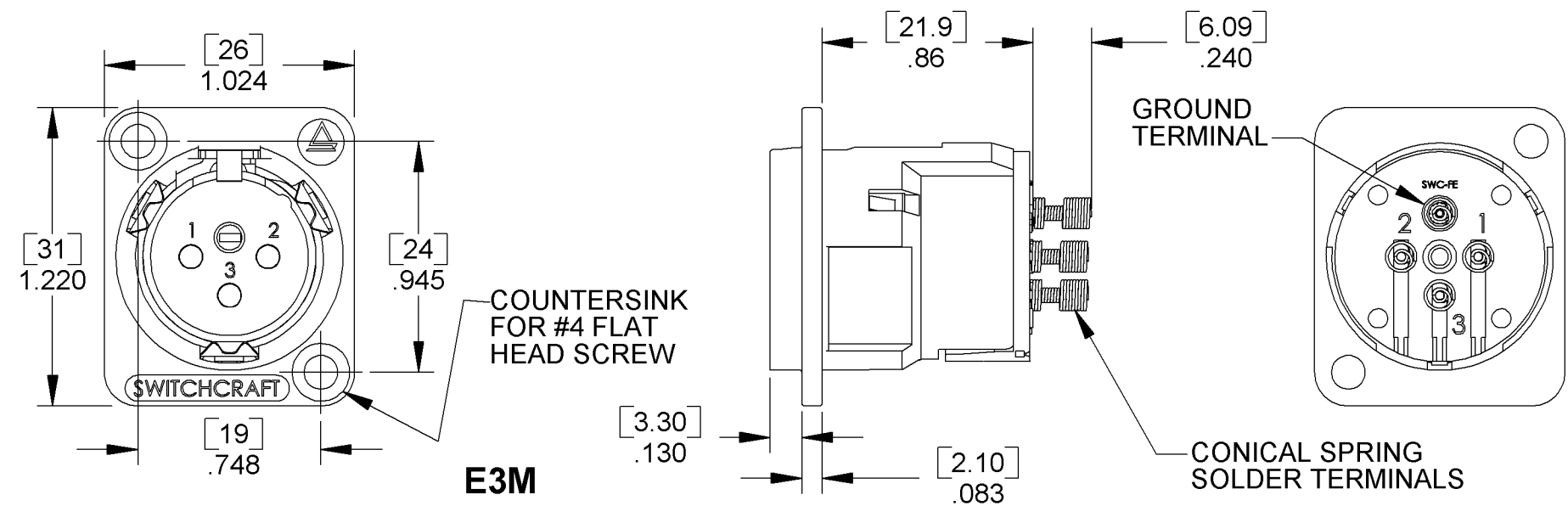

E3M

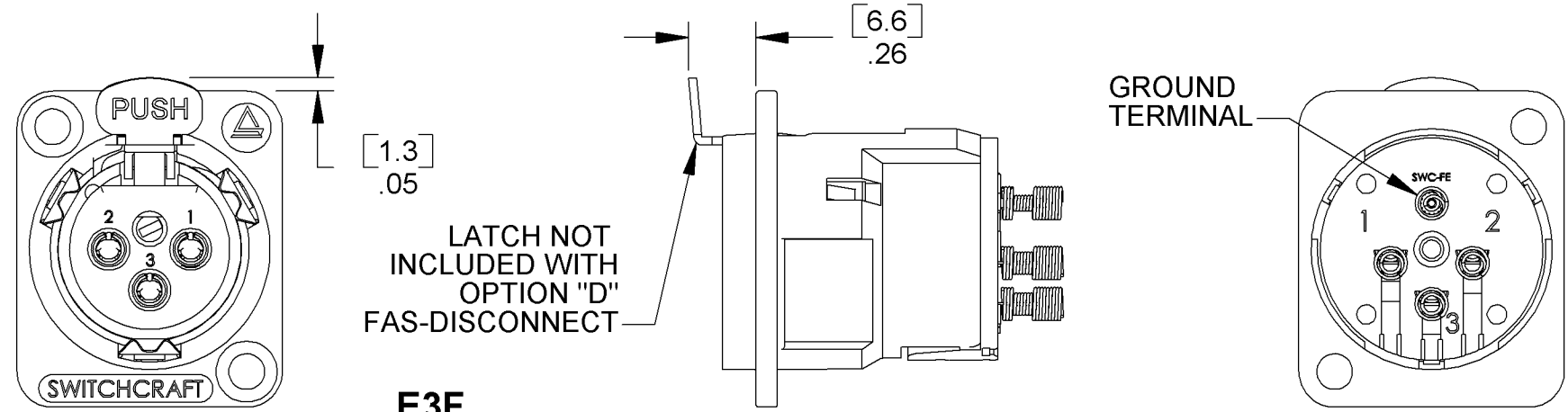

E3F

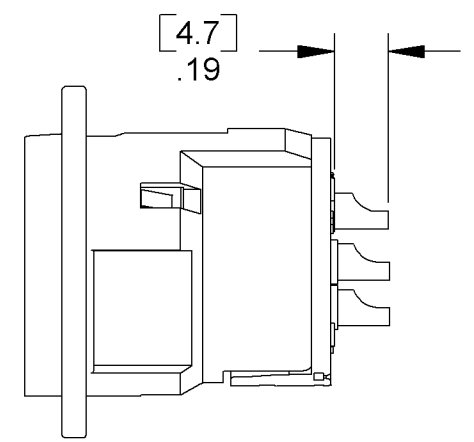

MALE SOLDER CUP
OPTION "SC"

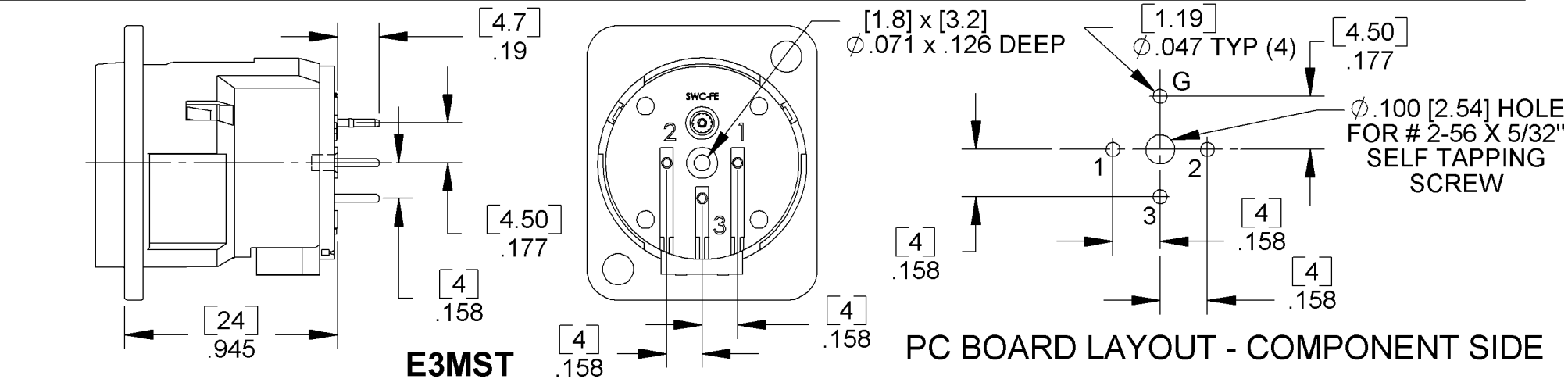

E3MST

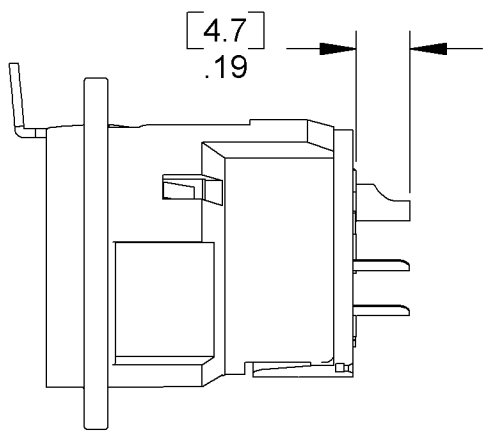

FEMALE SOLDER CUP
OPTION "SC"

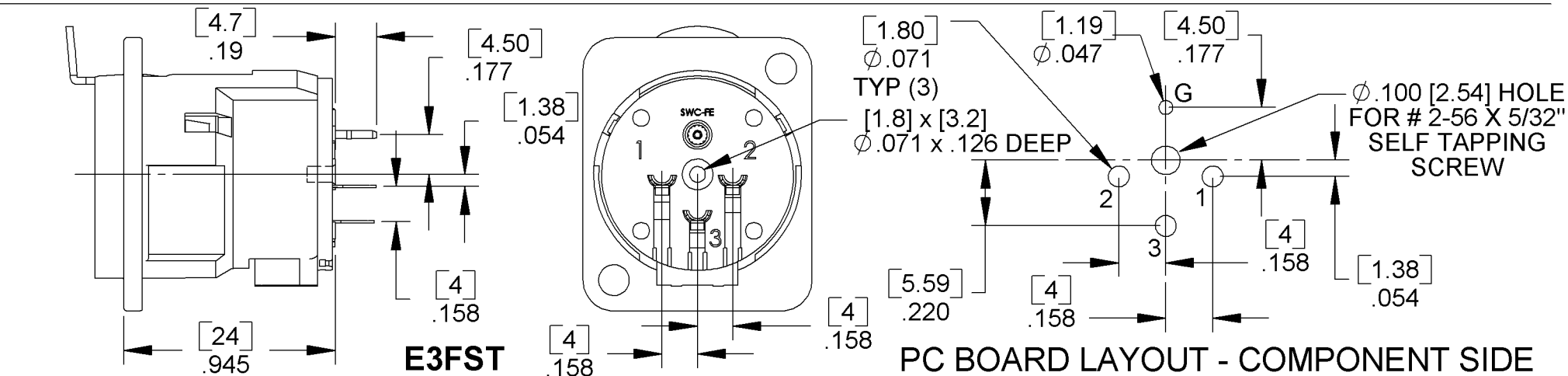

E3FST

REAR MOUNT OPTIONS

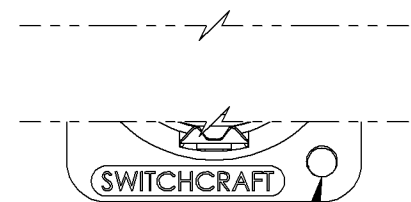

MOUNTING
HOLE TYP (2)

OPTION "M3"
M3 x 0.5 THREADED HOLES

OPTION "440"
#4-40 THREADED HOLES

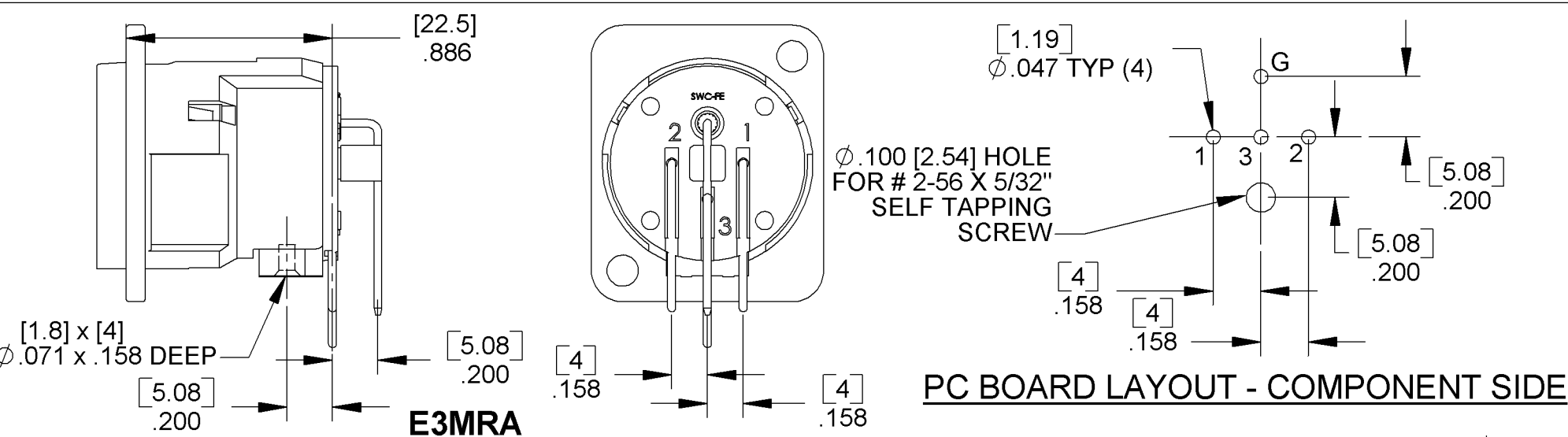

E3MRA

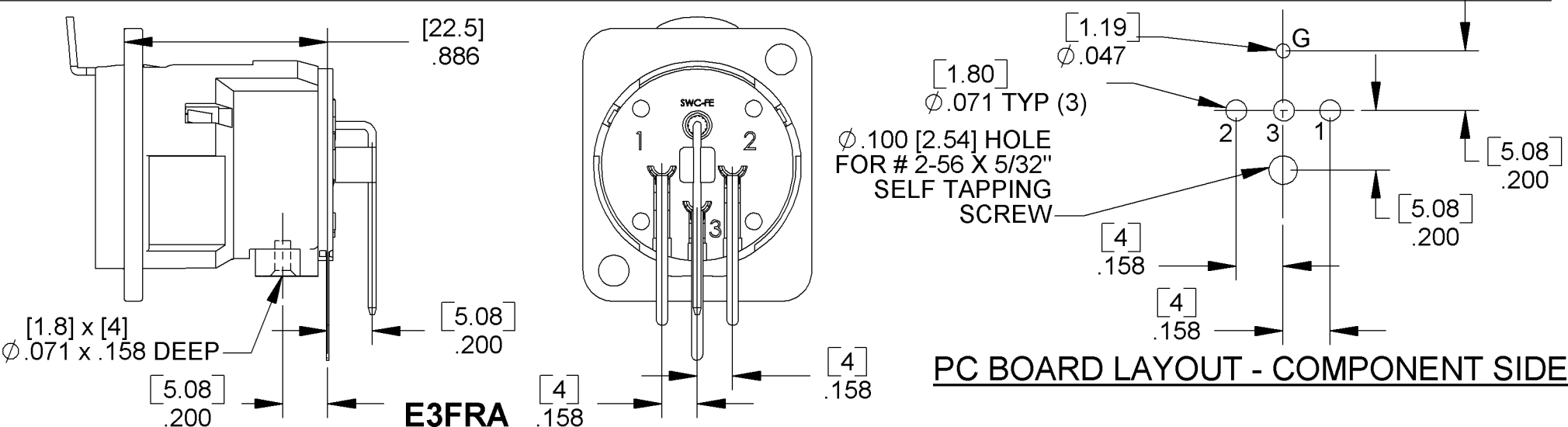

E3FRA

Switchcraft, Inc. □ E Series

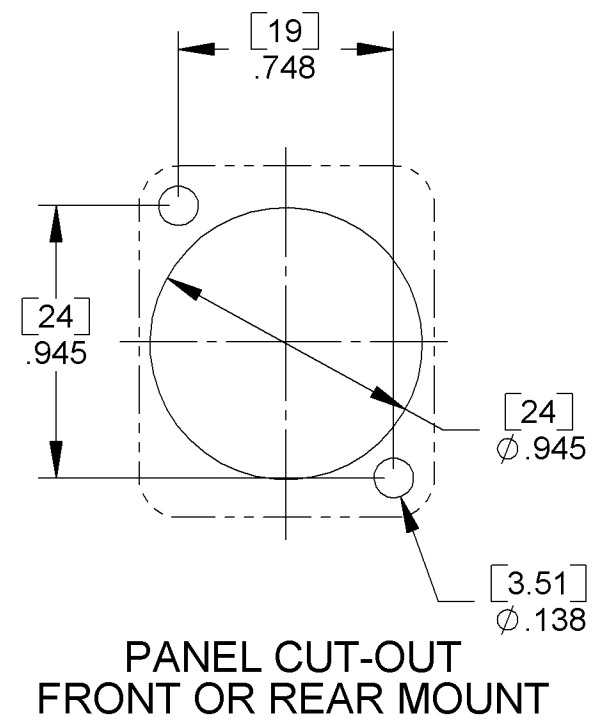

MALE CONNECTOR
GROUND TO PIN #1
OPTION "G1"

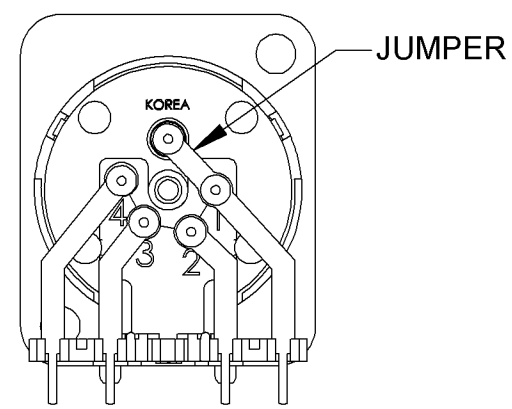

FEMALE CONNECTOR
GROUND TO PIN #1
OPTION "G1"

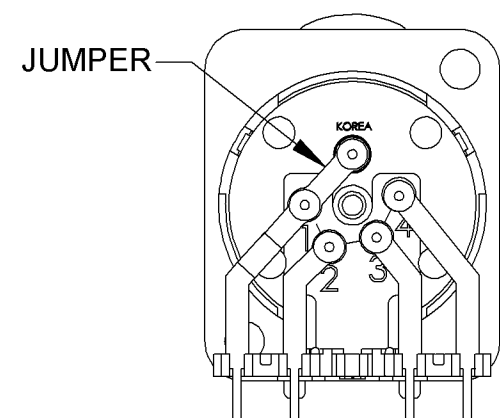

REAR MOUNT OPTIONS

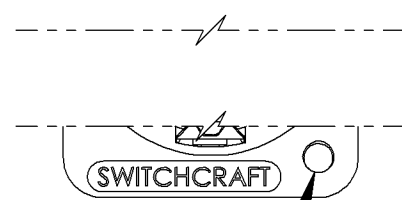

MOUNTING
HOLE TYP (2)

OPTION "M3"
M3 x 0.5 THREADED HOLES

OPTION "440"
#4-40 THREADED HOLES

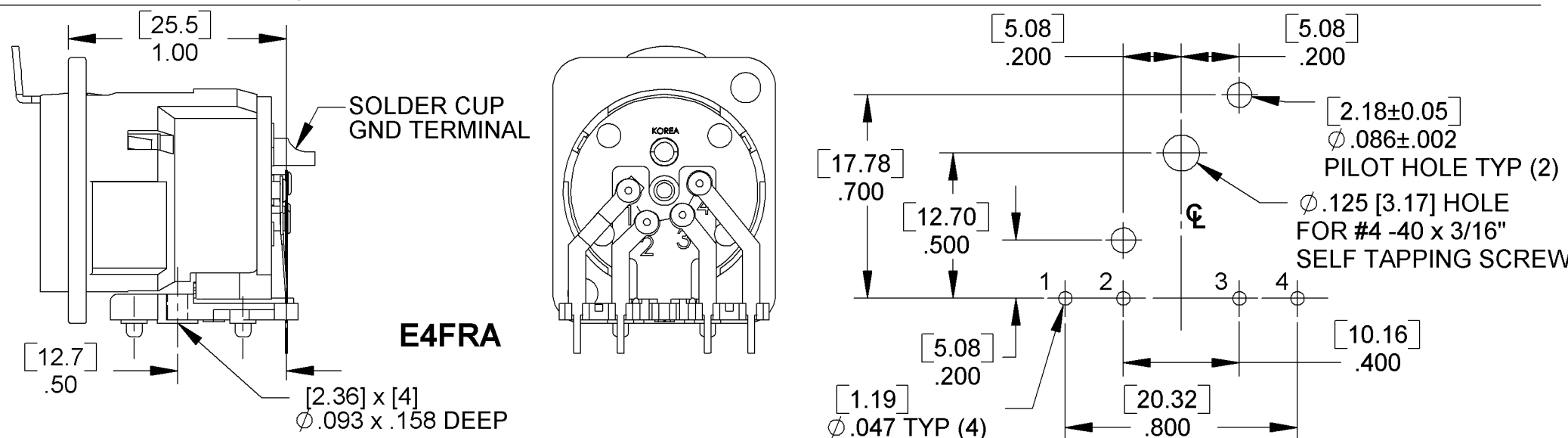
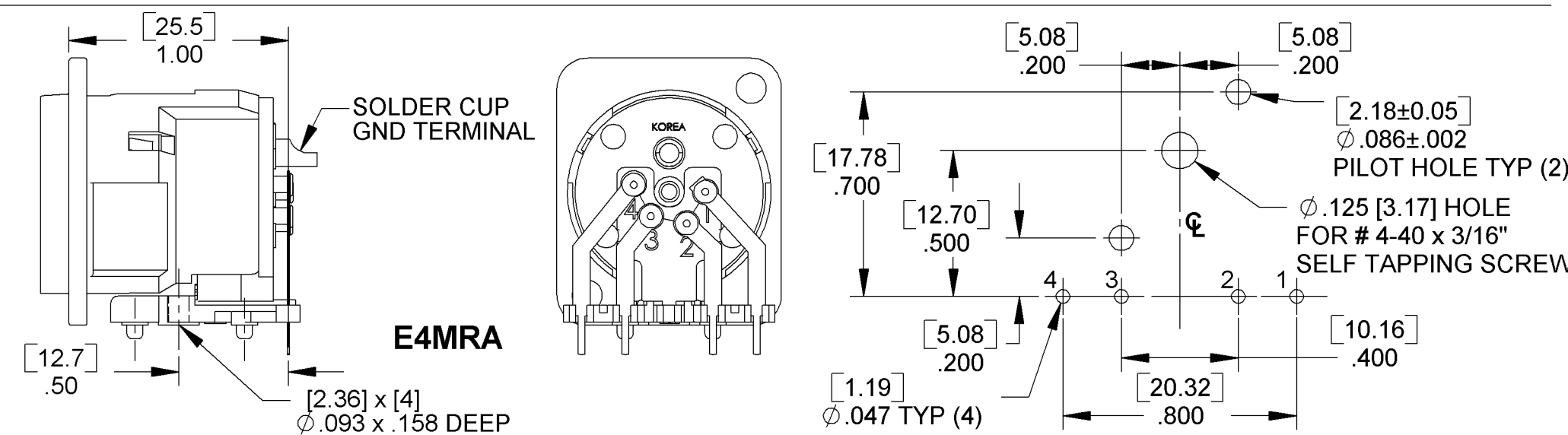
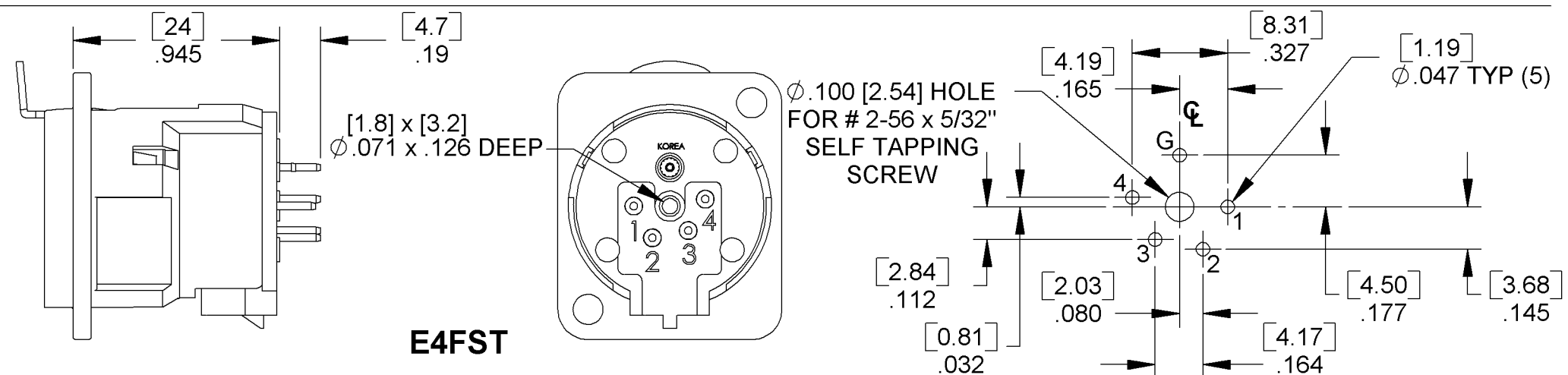
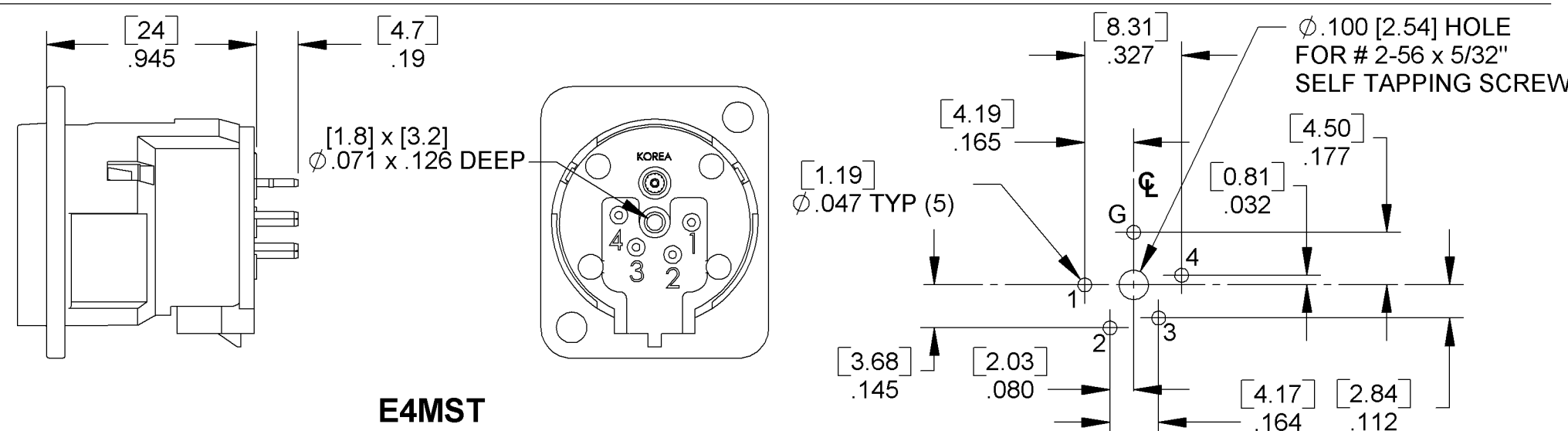
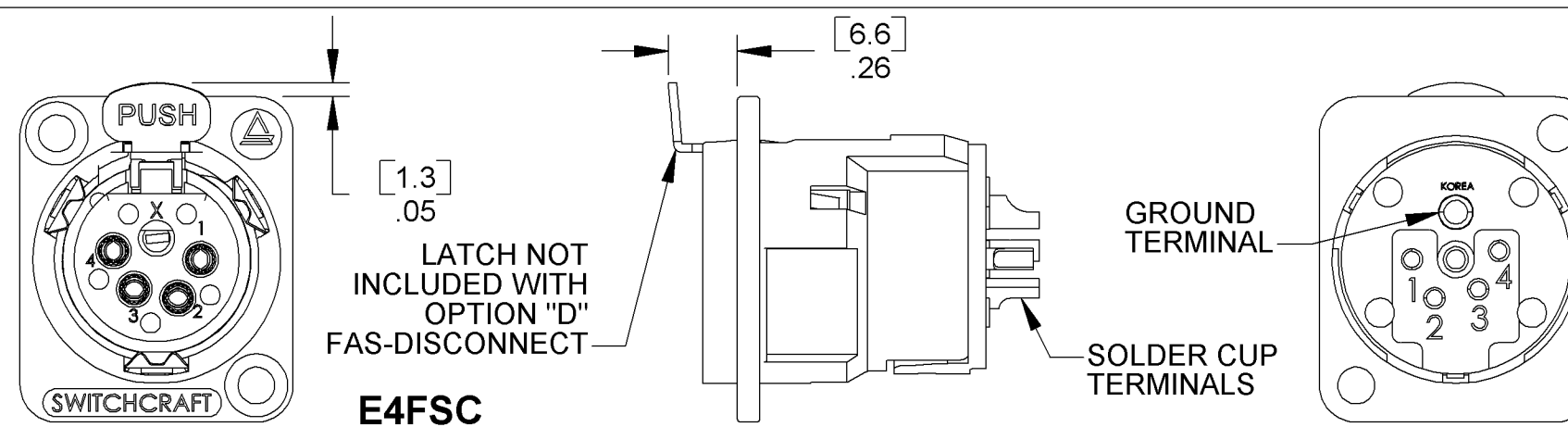
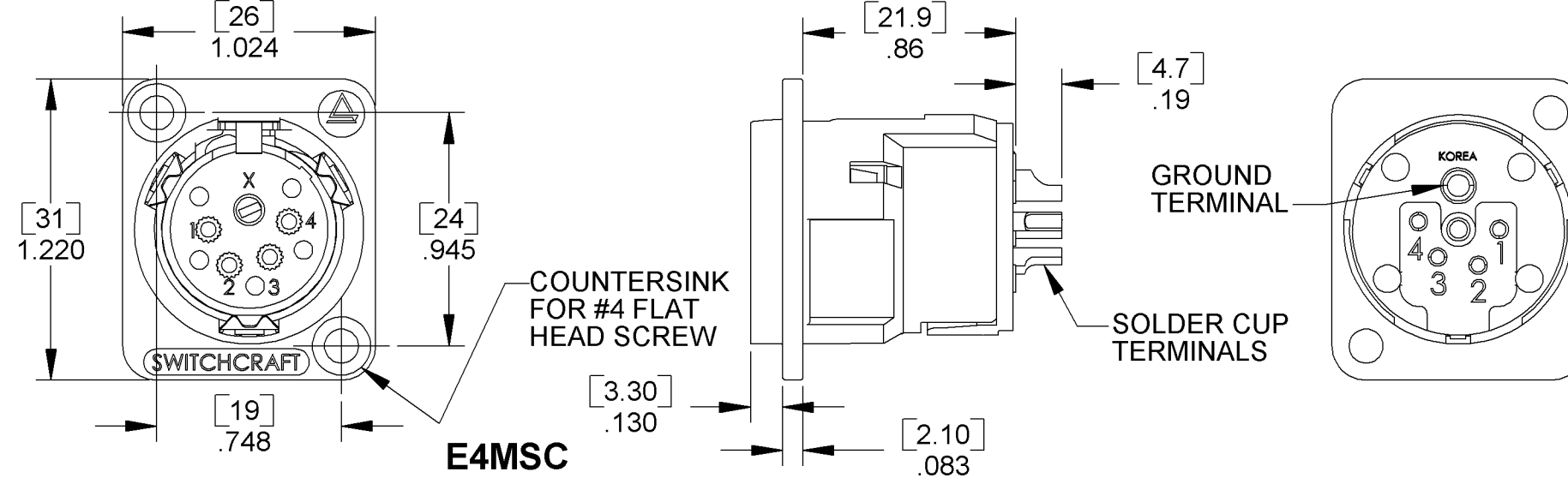

Switchcraft, Inc. E Series

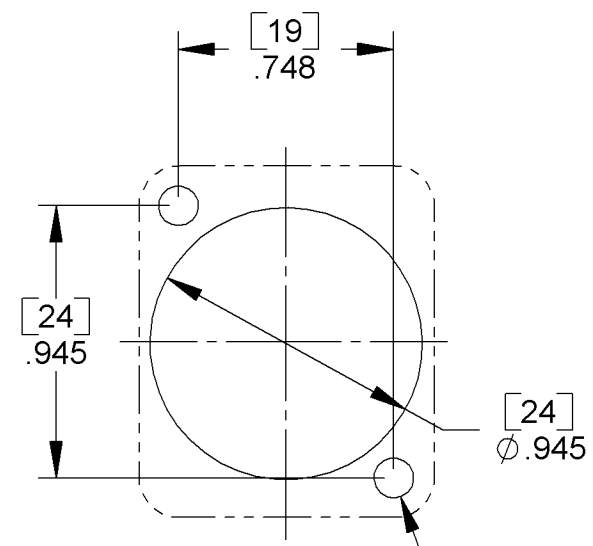

PANEL CUT-OUT
FRONT OR REAR MOUNT

MALE CONNECTOR
GROUND TO PIN # 1
OPTION "G1"

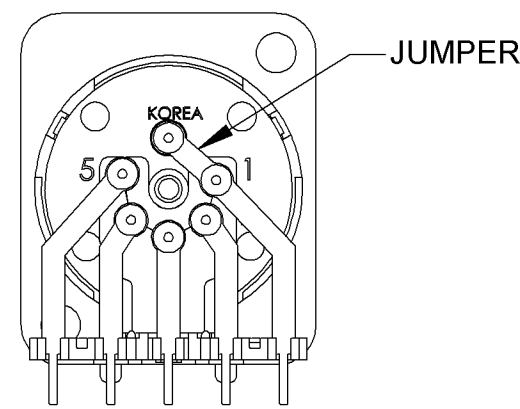

FEMALE CONNECTOR
GROUND TO PIN #1
OPTION "G1"

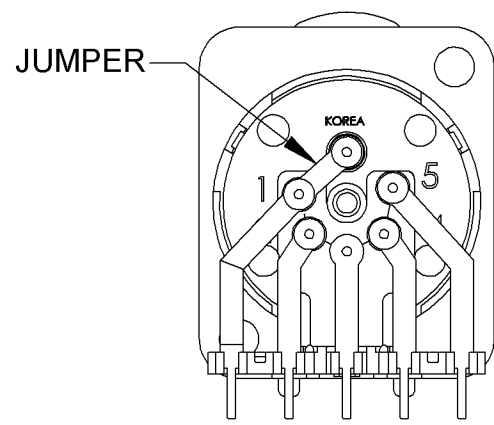

REAR MOUNT OPTIONS

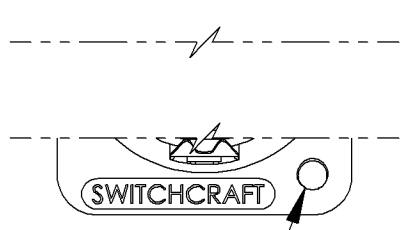

MOUNTING
HOLE TYP (2)

OPTION "M3"
M3 x 0.5 THREADED HOLES

OPTION "440"
#4-40 THREADED HOLES

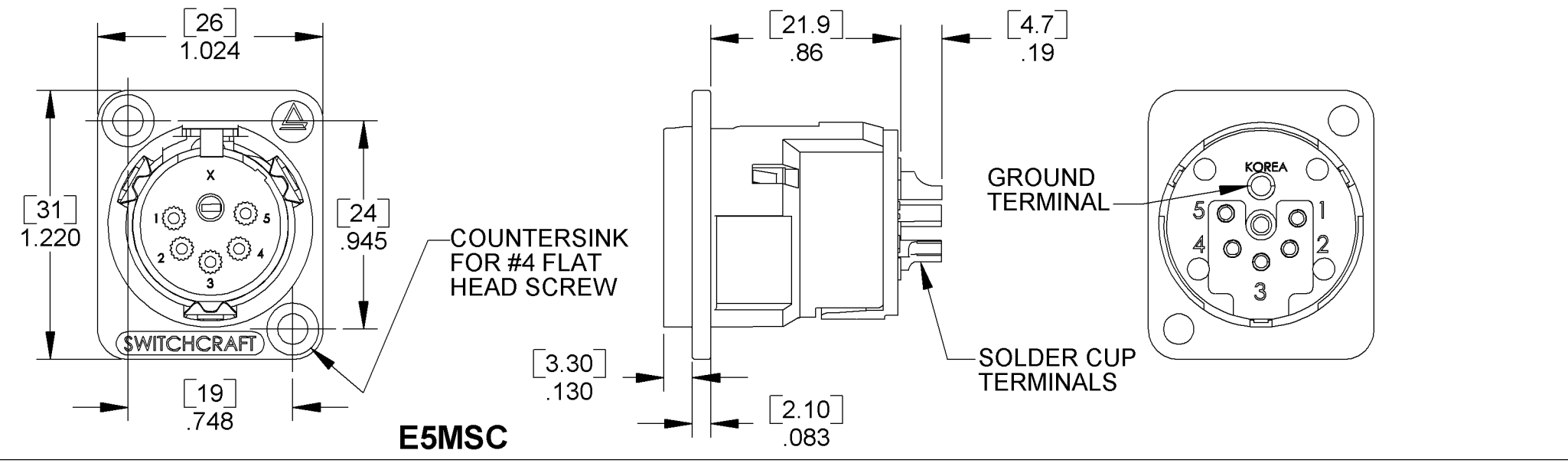

E5MSC

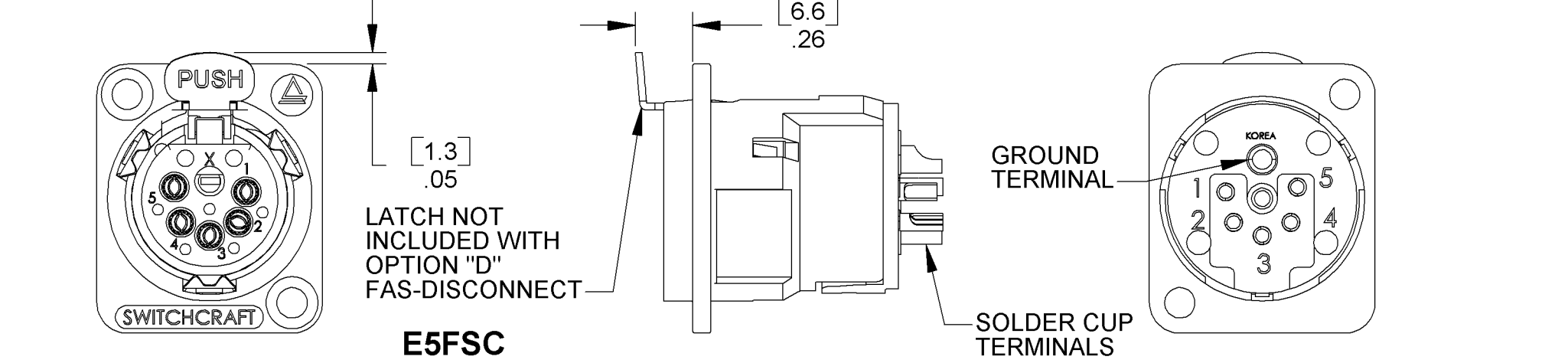

E5FSC

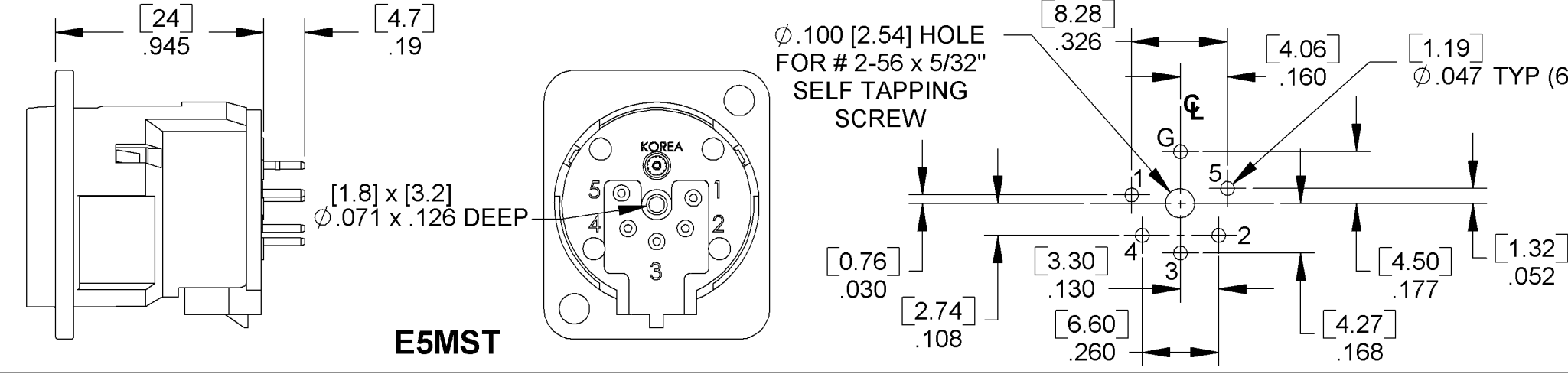

E5MST

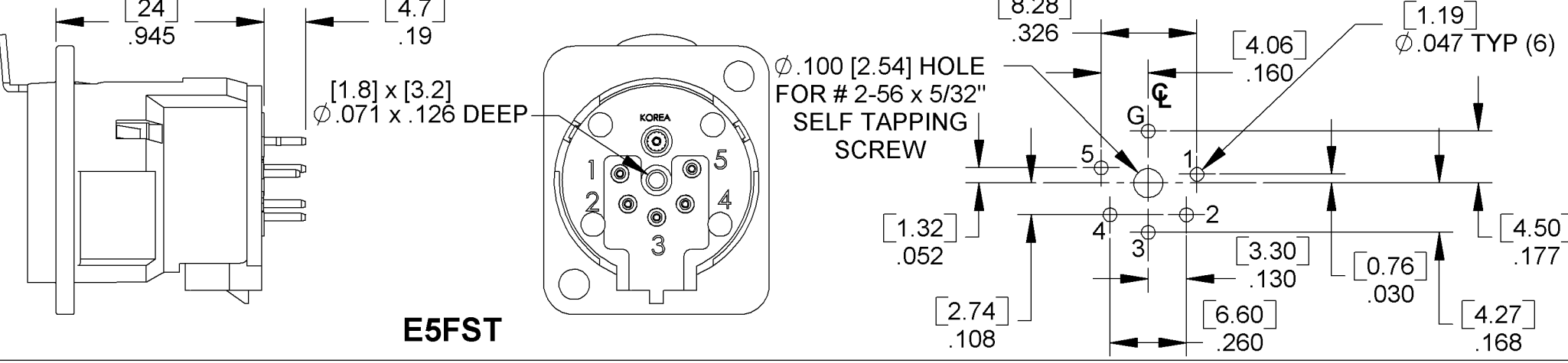

E5FST

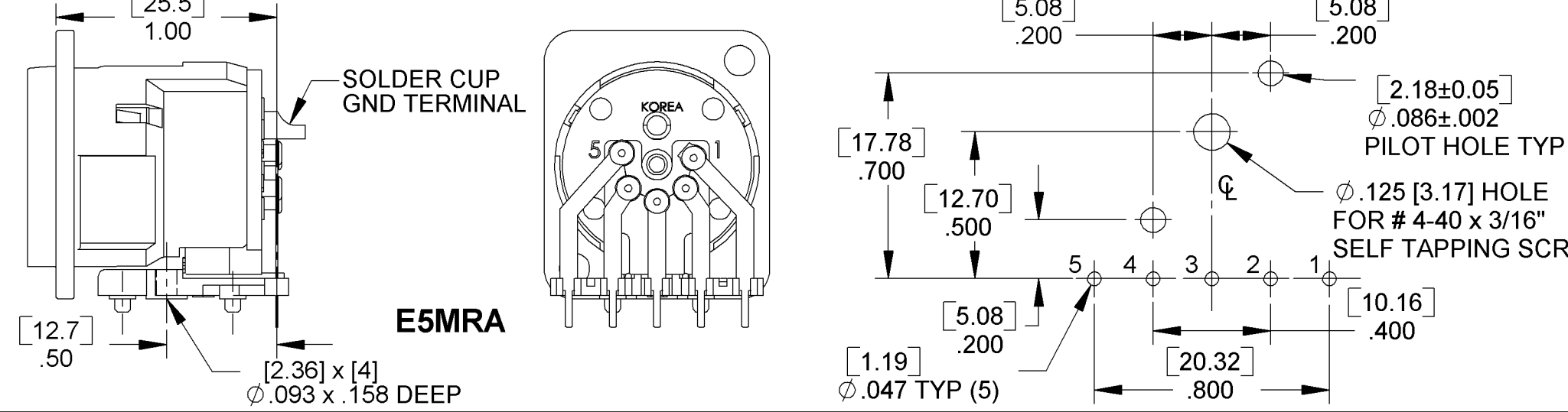

E5MRA

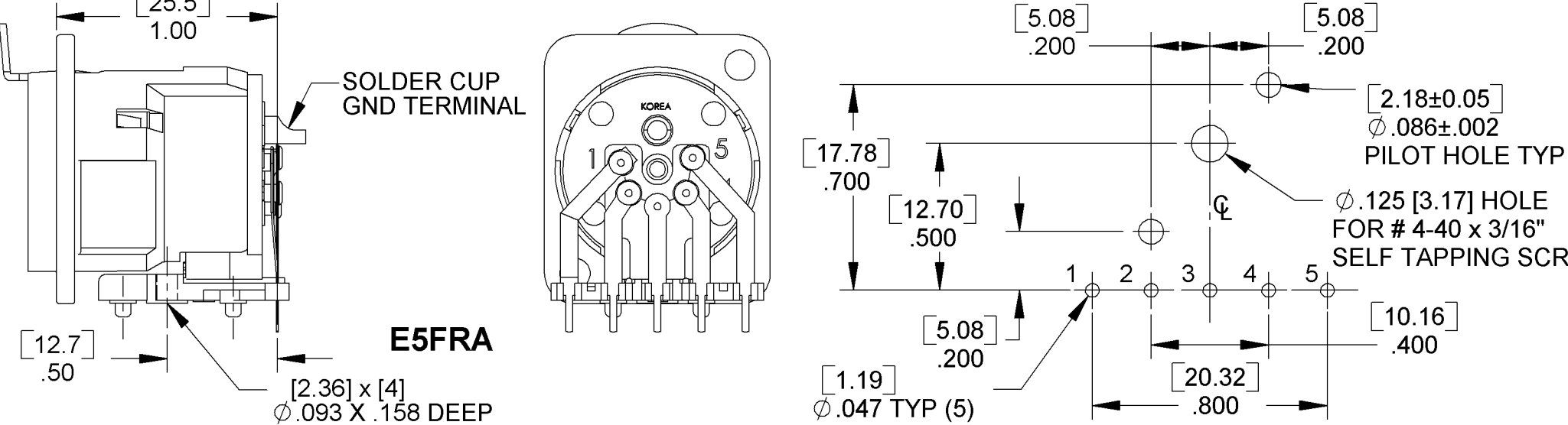

E5FRA

Mouser Electronics

Authorized Distributor

Click to View Pricing, Inventory, Delivery & Lifecycle Information:

Switchcraft:

[E3MRA](#) [E3FRA](#) [E3F](#) [E3FAU](#) [E3FAUQG](#) [E3FB](#) [E3FBAU](#) [E3FD](#) [E3FDAU](#) [E3FDB](#) [E3FDBAU](#) [E3FDRA](#)
[E3FDRAAU](#) [E3FDRAB](#) [E3FDRABAU](#) [E3FDSC](#) [E3FDSCB](#) [E3FDST](#) [E3FDSTAU](#) [E3FDSTBAU](#) [E3FQG](#) [E3FRAAU](#)
[E3FRAAUQG](#) [E3FRAB](#) [E3FRABAU](#) [E3FRAQG](#) [E3FSC](#) [E3FSCB](#) [E3FSCBAU](#) [E3FSCQG](#) [E3FST](#) [E3FSTAU](#)
[E3FSTAUQG](#) [E3FSTB](#) [E3FSTBAU](#) [E3FSTQG](#) [E3M](#) [E3MAU](#) [E3MAUQG](#) [E3MB](#) [E3MBAU](#) [E3MQG](#) [E3MRAAU](#)
[E3MRAAUQG](#) [E3MRABAU](#) [E3MRAQG](#) [E3MSC](#) [E3MSCB](#) [E3MSCBAU](#) [E3MSCQG](#) [E3MST](#) [E3MSTAU](#)
[E3MSTAUQG](#) [E3MSTBAU](#) [E3MSTQG](#) [E4FSC](#) [E4FSCB](#) [E4FSCBAU](#) [E4MSC](#) [E4MSCB](#) [E4MSCBAU](#) [E5FSC](#)
[E5FSCB](#) [E5FSCBAU](#) [E5MSC](#) [E5MSCB](#) [E5MSCBAU](#) [E5FSTBAU](#) [E5FRAB](#) [E5FRABAU](#) [E4FRAB](#) [E4MRAB](#)
[E4FSTB](#) [E5MRA](#) [E5MRAB440](#) [E5FST](#) [E4FRABAU](#) [E4FSTBAU](#) [E4MSTB](#) [E4FRA](#) [E5MSTB](#) [E5FRA](#) [E4FST](#)
[E4MRA](#) [E5MST](#) [E5MRABAU](#) [E5FRAB440](#) [E4MST](#) [E4MRABAU](#) [E4MSTBAU](#) [E5MSTBAU](#) [E5FSTB](#) [E5MRAB](#)
[E3MRAB](#)